

WATER CONTROL STRUCTURE NOTE:  
 WATER CONTROL STRUCTURES 1-12 ARE DUCKS UNLIMITED ENGINEERED WATER CONTROL STRUCTURES DIMENSIONED AS SHOWN. THEY ARE USED TO CONTROL THE AREA (PLACE OF USE) RECEIVING WATER IN ANY ONE YEAR. THAT AREA DOES NOT EXCEED 365.15 ACRES IN ANY ONE YEAR. SEE BENEFICIAL USE REPORT FOR CAPACITY CALCULATIONS.

1" = 400'  
 SECTIONS 9, 10, & 16  
 T. 8 S., R. 40 E., W.M.  
 BAKER COUNTY, OREGON

**NEW PLACE OF USE**

SECTION 9  
 NE 1/4  
 NE 1/4, SE 1/4  
 S 1/2, SE 1/4

SECTION 10  
 S 1/2, NW 1/4  
 SW 1/4  
 SW 1/4, SE 1/4

SECTION 16  
 NE 1/4

T. 8 S., R. 40 E., W.M.  
 BAKER COUNTY, OREGON

NOTE:  
 THIS MAP IS FOR THE PURPOSE OF LOCATING A WATER RIGHT ONLY AND IS NOT INTENDED TO PROVIDE LEGAL DIMENSIONS OR LOCATIONS OF PROPERTY LINES.

SOURCES:  
 1 - THE POWDER RIVER, A TRIBUTARY OF THE SNAKE RIVER AND MASON RESERVOIR.  
 2 - A SLUMP (POND C), A TRIBUTARY OF BALDOCK SLOUGH.

**LEGEND**

PLACE OF USE - 448.10 ACRES (TOTAL)  
 LANDS RECEIVING WATER NOT TO EXCEED 365.15 ACRES IN ANY ONE YEAR

DUCKS UNLIMITED DIVERSION STRUCTURE

POINT OF DIVERSION

SECTION LINE

1/4 1/4 SECTION LINE

BOUNDARY LINE OF BALDOCK SLOUGH WETLANDS PRESERVE AREA

ENGINEERED SWALE (SEE SWALE NOTE)

CL CHANNEL IN POND AREAS



EXPIRATION DATE: 2-31-06  
 DATED: 09-05-06

DIVERSION POINT LOCATIONS:  
 POD 1 IS AT PERKINS EAST TWO DITCH - BAKER VALLEY IRRIGATION DISTRICT DIVERSION NUMBER 31 OF THE POWDER RIVER. LOCATED 2660 FEET SOUTH AND 140 FEET WEST FROM THE NE CORNER OF SECTION 20, AS SHOWN (SEE DETAIL "A").

POD 2 IS AT THE SLUMP (POND C) AND IS 1415' WEST AND 340' SOUTH FROM THE NE CORNER OF SECTION 16 AS SHOWN.

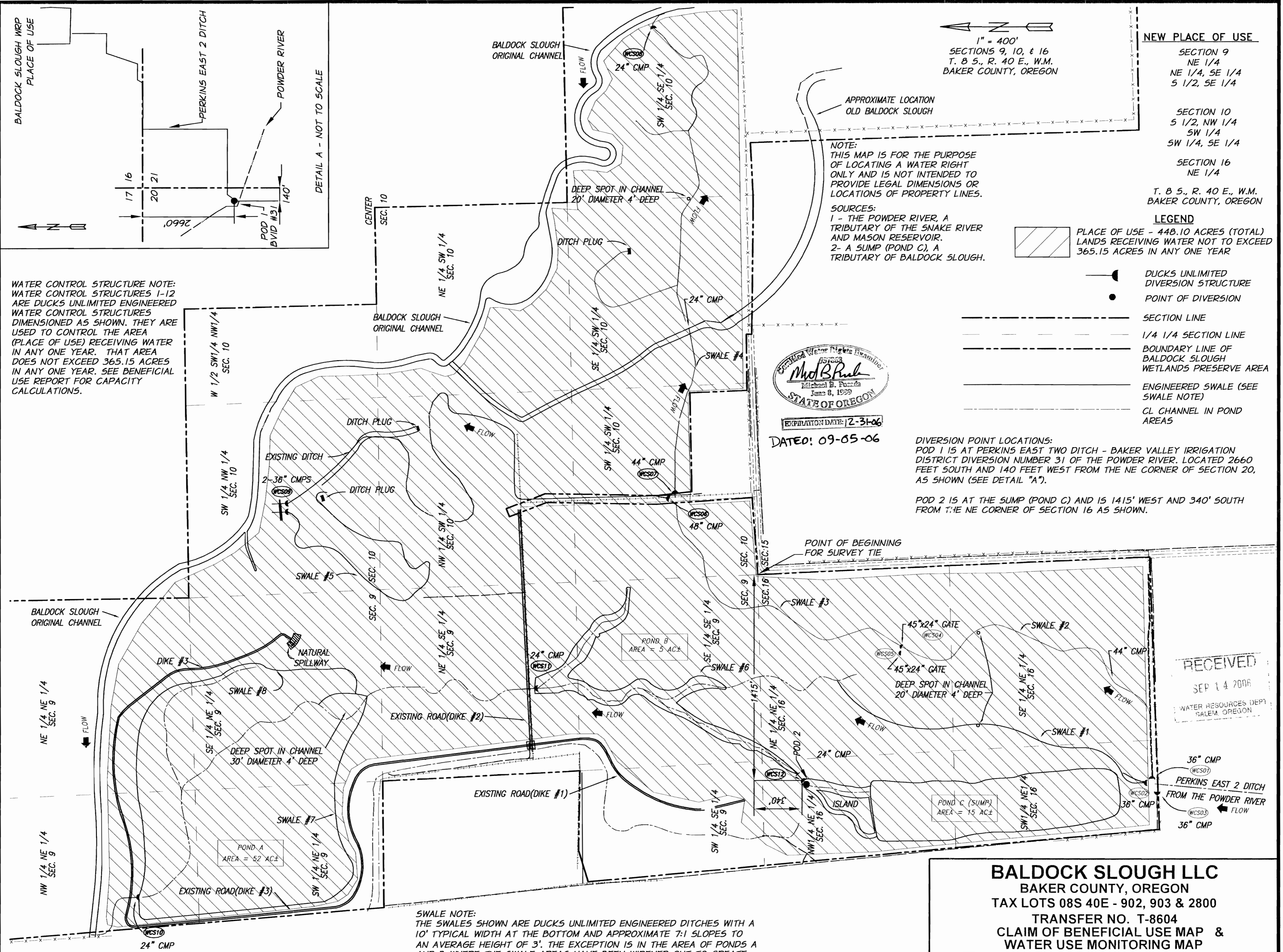

RECEIVED  
 SEP 14 2006  
 WATER RESOURCES DEPT  
 SALEM, OREGON

SWALE NOTE:  
 THE SWALES SHOWN ARE DUCKS UNLIMITED ENGINEERED DITCHES WITH A 10' TYPICAL WIDTH AT THE BOTTOM AND APPROXIMATE 7:1 SLOPES TO AN AVERAGE HEIGHT OF 3'. THE EXCEPTION IS IN THE AREA OF PONDS A AND B WHERE THE SWALE AREAS HAVE BEEN WIDENED OUT TO CREATE POND AREAS AS SHOWN.

**BALDOCK SLOUGH LLC**  
 BAKER COUNTY, OREGON  
 TAX LOTS 08S 40E - 902, 903 & 2800  
 TRANSFER NO. T-8604  
 CLAIM OF BENEFICIAL USE MAP &  
 WATER USE MONITORING MAP

SCALE:  
 1" = 400'

DATE:  
 08-28-06

JOB NO.  
 2731-44

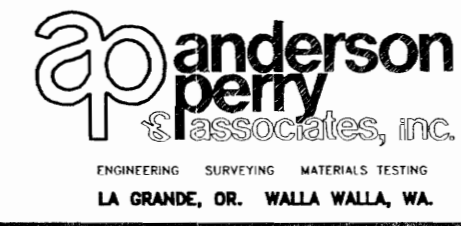

SHEET  
 1 OF 1

COPY MAP # 0218

DATE OF SURVEY: 04/24/06  
 LAST UPDATED: 08/28/06