

**SOUTHERN PORTION of SECTION 2, T3S, R1W**  
**Willamette Meridian**  
**WASHINGTON COUNTY, OREGON**

*Sections*

	3	2	1	6	5
T 3 S	10	11	12	7	8
	15	14	13	18	17
	22	23	24	19	20
	R 1 W			R 1 E	

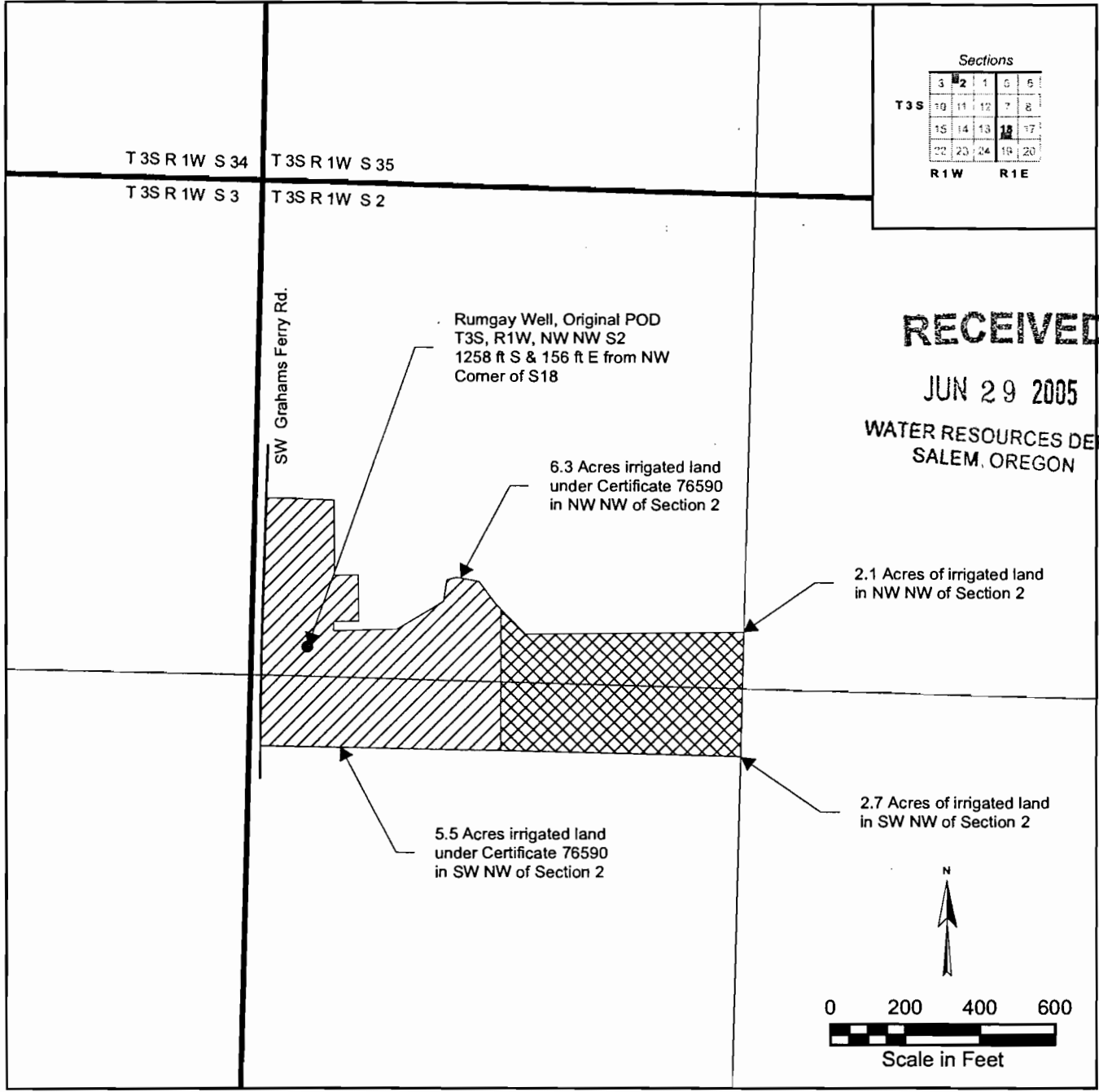

**RECEIVED**  
**JUN 29 2005**

WATER RESOURCES DEPT  
 SALEM, OREGON

**Legend**

- Property Boundary  
T3S, R1W, S2
- Irrigated Land and 1/4 1/4 section  
irrigated acreage under Certificate 76590
- Acreage proposed for temporary transfer
- Paved Road

**TEMPORARY TRANSFER NO: #T-9982**  
**IN THE NAME OF: Linda Rumgay**  
**24450 SW Grahams Ferry Rd.**  
**Sherwood, OR 97140**

**Transfer Map, 1 of 2**  
**Rumgay Property**  
**April 2005**

THIS MAP WAS PREPARED FOR THE PURPOSE OF IDENTIFYING THE LOCATION OF THE WATER RIGHTS ONLY, AND NOT INTENDED TO PROVIDE LEGAL DIMENSIONS OR THE LOCATION OF PROPERTY OWNERSHIP LINES.

SOUTHERN PORTION of SECTION 18, T3S, R1E  
 Willamette Meridian  
 CLACKAMAS COUNTY, OREGON

Sections				
3	2	1	6	5
10	11	12	7	8
15	14	13	18	17
22	23	24	19	20
R1W		R1E		

**RECEIVED**

JUN 29 2005

WATER RESOURCES DEPT  
 SALEM OREGON

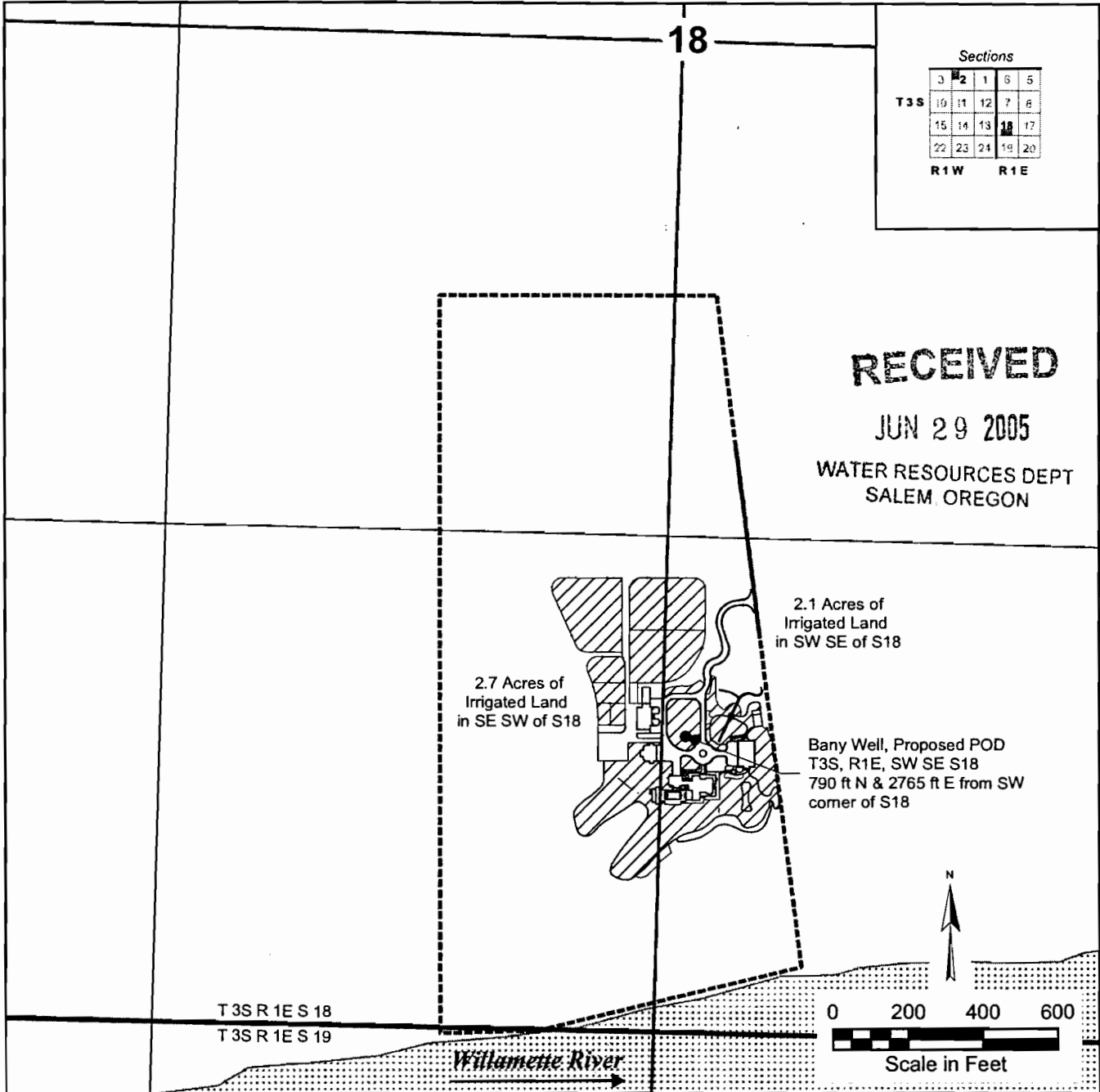

**Legend**

- Property Boundary  
T3S, R1E, S18, Taxlot 03100
- Irrigated Land and 1/4 1/4 section irrigated acreage
- Willamette River
- Paved Road

TEMPORARY TRANSFER NO: #T-9982  
 IN THE NAME OF: Dave Bany  
 5442 SW Kruse Way  
 Wilsonville, OR 97070

Transfer Map, 2 of 2  
 Bany Property  
 Feb. 2005

THIS MAP WAS PREPARED FOR THE PURPOSE OF IDENTIFYING THE LOCATION OF THE WATER RIGHTS ONLY, AND NOT INTENDED TO PROVIDE LEGAL DIMENSIONS OR THE LOCATION OF PROPERTY OWNERSHIP LINES.

Golder Associates Inc