

Section 9, T.4S. R.1E. W.M.

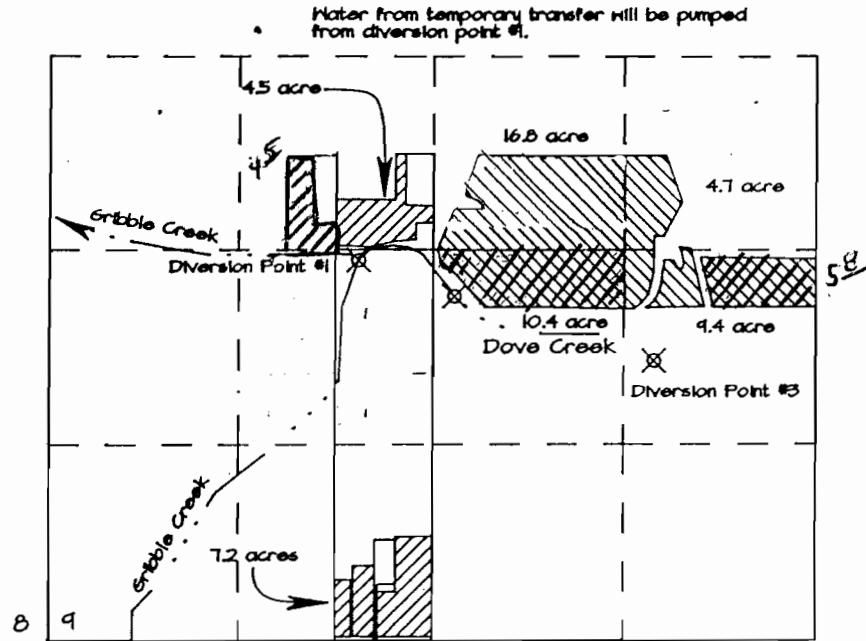

CLACKAMAS COUNTY



17 16

Scale 1" = 1320'

- ⊗ Diversion point 1 is 2,568 feet North and 2,137 feet East of the S.W. corner of Section 9.
- ⊗ Diversion point 2 is 2,323 feet North and 2,785 feet East of the S.W. corner of Section 9.
- ⊗ Diversion Point 3 is 1,887 feet North and 4,171 feet East of the S.W. corner of Section 9.

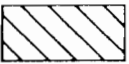
-  Portion of Permit 26682 proposed for Transfer
-  Proposed Area of Use
-  Portion of Permit 26682 Not Subject to Transfer

APPLICATION MAP FOR TEMPORARY WATER RIGHT TRANSFER FOR Ramon DeMartini

APPLIC. NO. _____ PERMIT NO. _____

RECEIVED
JAN 29 2002
WATER RESOURCES DEPT
SALEM, OREGON



THE PREPARATION OF THIS MAP IS FOR THE PURPOSE OF IDENTIFYING THE LOCATION OF THE WATER RIGHT ONLY AND HAS NO INTENT TO PROVIDE DIMENSIONS OR LOCATION OF PROPERTY OWNERSHIP LINES.

RECEIVED

APR 29 2005

WATER RESOURCES DEPT
SALEM, OREGON

T 9920 T 9015

Section 9, T.4S. R.1E. W.M.

CLACKAMAS COUNTY

RECEIVED

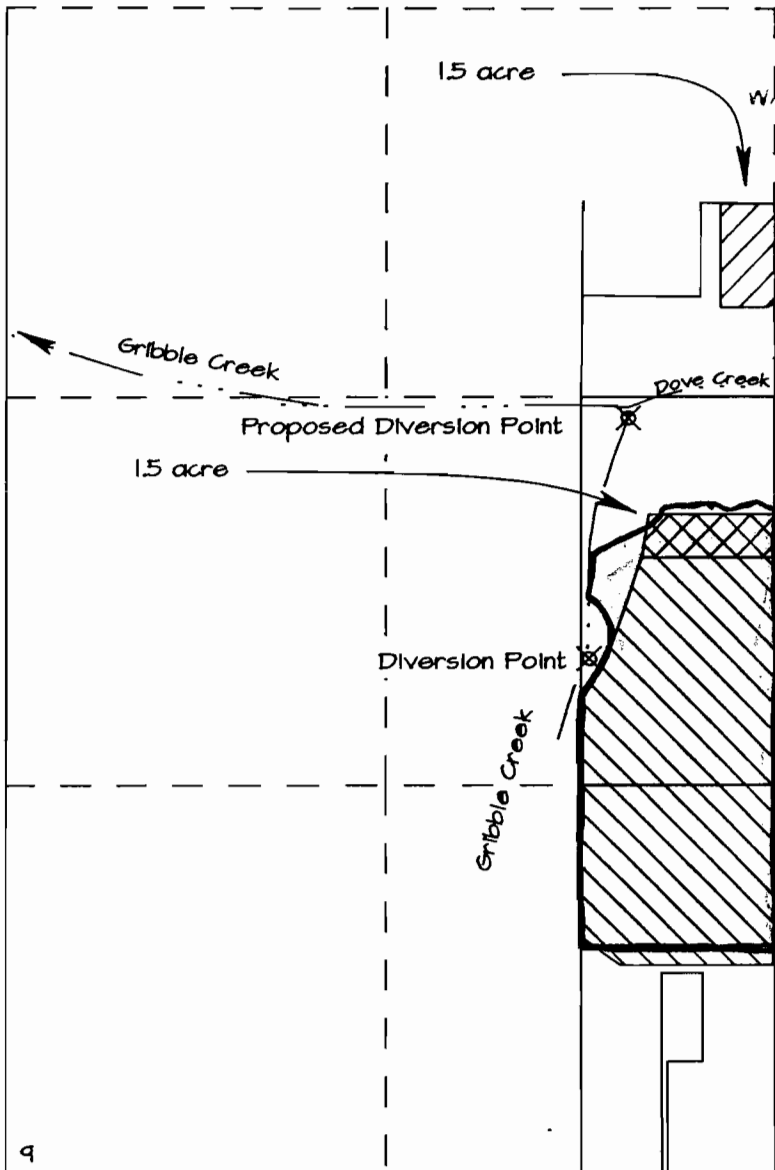

JUN 08 1998

WATER RESOURCES DEPT.
SALEM, OREGON

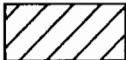

Diversion is 1,749 feet north and 634 feet west of the south quarter corner of Section 9.

Proposed diversion is 2,568 feet north and 503 feet west of the south quarter corner of Section 9.

-  Portion of Permit 14771 proposed for Transfer
-  Proposed Area of Use
-  Portion of Permit 14771 Not Subject to Transfer

8 9

17 16

Scale 1" = 660'

APPLICATION MAP FOR WATER
RIGHT TRANSFER AND CHANGE
IN POINT OF DIVERSION.

Ramon Demartini
8441 S. Lone Elder Road
Canby, Oregon 97013

RECEIVED

MAY 27 1998

WATER RESOURCES DEPT.
SALEM, OREGON

RECEIVED

APR 29 2005

WATER RESOURCES DEPT.
SALEM, OREGON

- Sketch Map -
T 8008 Authorized POU in
green outlined in red.

Areas not authorized under
Permit 14771 in yellow.

THE PREPARATION OF THIS MAP IS FOR THE PURPOSE OF
IDENTIFYING THE LOCATION OF THE WATER RIGHT ONLY
AND HAS NO INTENT TO PROVIDE DIMENSIONS OR
LOCATION OF PROPERTY OWNERSHIP LINES.

J-9920