

T.4S. R.1W. Section 36 & T.4S. R.1E. Section 31

RECEIVED

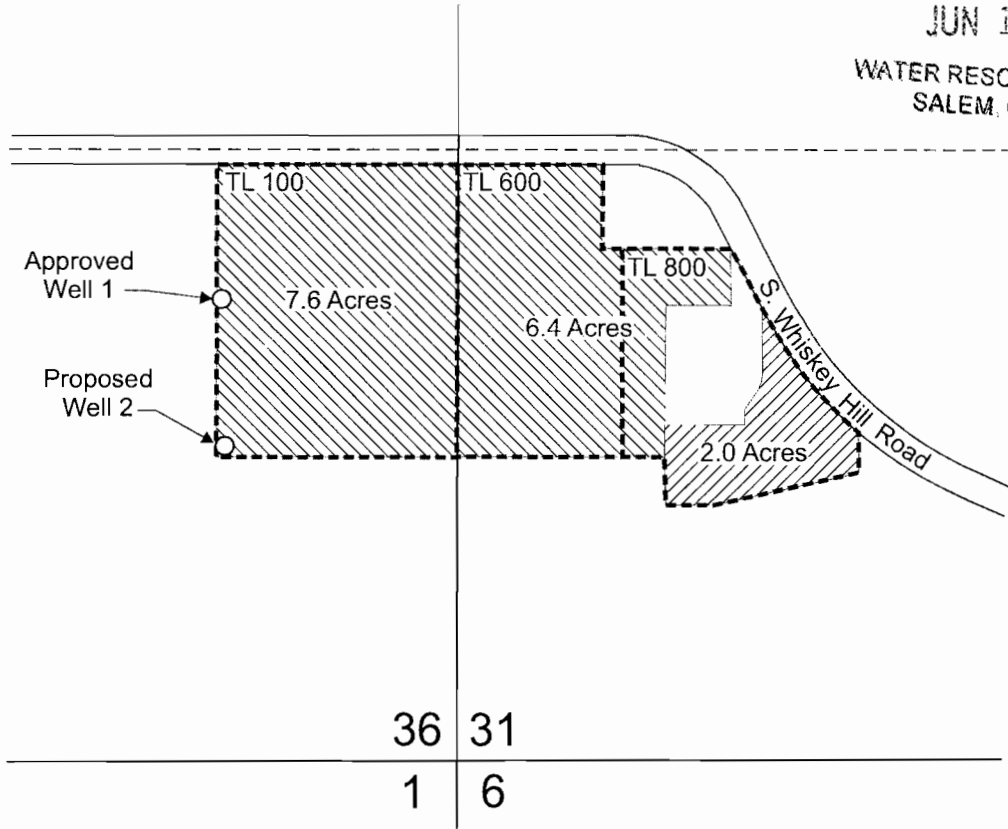

JUN 15 2005

WATER RESOURCES DEPT
SALEM, OREGON



Approved Well 1 is located 1,000 feet north and 510 feet west from the SE corner of Section 36.

Proposed Well 2 is located 700 feet north and 510 feet west from the SE corner of Section 36.

-  Area (14.0 Acres) for nursery operations.
-  Area (2.0 Acres) of cemetery grounds and church lawn and landscaping to be irrigated.
-  Tax lot boundaries

Scale: 1" = 400'



EXPIRATION DATE: 6/30/05
This map was prepared for the purpose of identifying the location of a water right only and is not intended to provide legal dimensions or location of property ownership lines.

Permit Amendment Map

Zion Properties LLC
T.4S. R.1W. Section 36DD, Tax Lot 100,
T.4S. R.1E. Section 31C, Tax Lots 600 & 800

Pacific Hydro-Geology Inc.

6/2005

Zion.cdr

T-9952