

RECEIVED

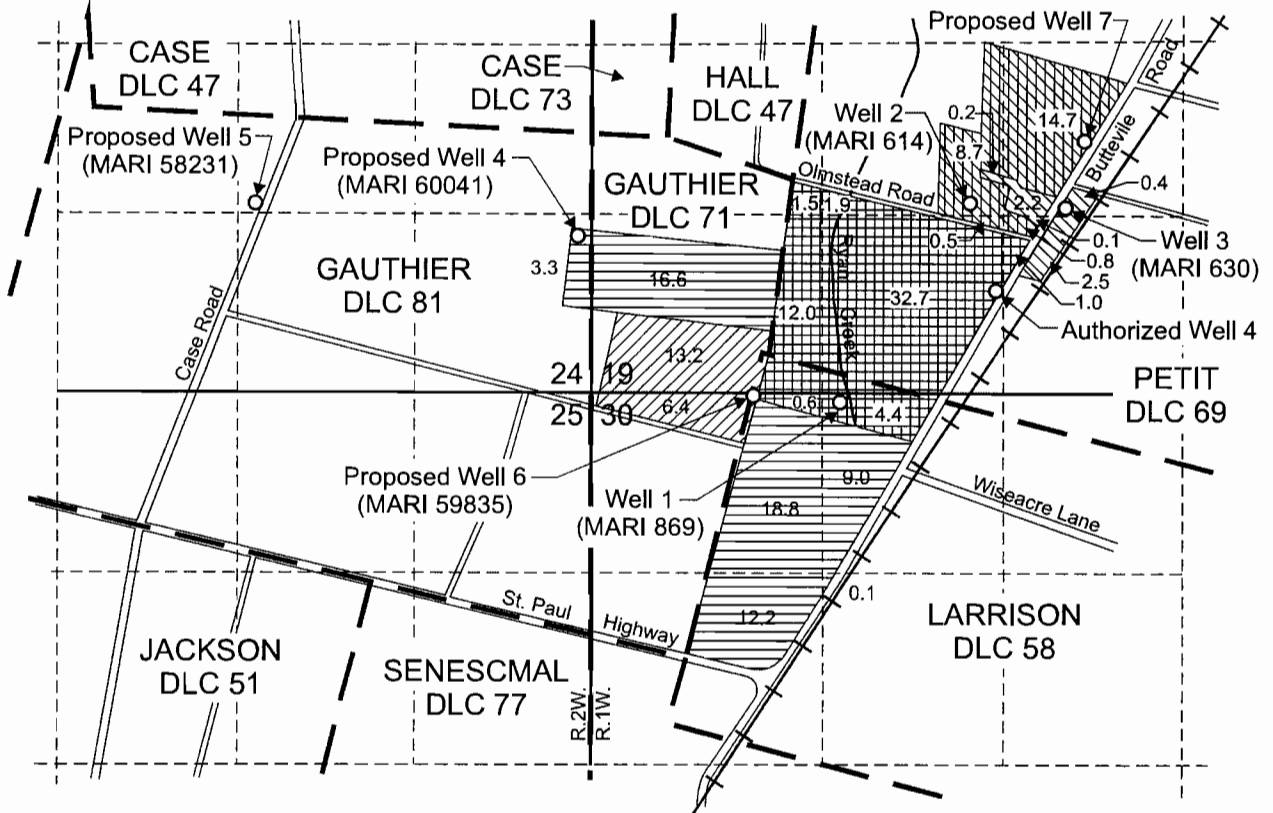

MAR 09 2007

WATER RESOURCES DEPT
SALEM, OREGON

T.4S. R.1W. Sec. 19 & 30 & T.4S. R.2W. Sec. 24, W.M.



Well 1 (MARI 869) is located 1,880 feet north and 1,120 feet east from the SE corner, DLC 71
 Well 2 (MARI 614) is located 3,360 feet north and 2,040 feet east from the SE corner, DLC 71
 Well 3 (MARI 630) is located 3,340 feet north and 2,730 feet east from the SE corner, DLC 71
 Authorized Well 4 is located 2,720 feet north and 2,250 feet east from the SE corner, DLC 71
 Proposed Well 4 (MARI 60041) is located 1,230 feet north and 100 feet west from the SE corner, Section 24
 Proposed Well 5 (MARI 58231) is located 800 feet south and 1190 feet east from the SW corner, DLC 47
 Proposed Well 6 (MARI 59835) is located 20 feet south and 1,180 feet east from the NW corner, Section 30
 Proposed Well 7 is located 1,860 feet north and 3,580 feet east from the SW corner, Section 19

-  Portion of Application G-14605, Permit G-13570 Assigned to Brian Rissberger.
-  Portion of Application G-14605, Permit G-13570 Assigned to the Mary Spada Living Trust.
-  Portion of Application G-14605, Permit G-13570 Retained by Rogers Associates - Oregon.
-  Existing Irrigation Rights Under GR-626 and Certificate 56530

Scale: 1" = 1,320'



This map was prepared for the purpose of identifying the location of a water right only and is not intended to provide legal dimensions or location of property ownership lines.



Map to Accompany a Permit Amendment

Application G-14605, Permit G-13570
 T.4S. R.1W. Sec. 19 and 30 &
 T.4S. R.1W. Sec. 24, W.M.

Pacific Hydro-Geology Inc.

Rvsd 3/2007

PermitAmendMapRvsdVer3G14605.cdr