

COPY

T -

MAP OF ADDITIONAL
POINTS OF DIVERSION
T.15S., R.16E., W.M., SECTION 8

✓ D.I.D. 5 - SW1/4 NW1/4
(GOV. LOT 4) SECTION 8,
T.15S., R.16E., W.M.
NORTH 1291 FT. & EAST 700
FT. FROM WEST 1/4 COR.
SECTION 8.

PREPARED FOR

OCHOCO IRRIGATION DISTRICT
1001 NW DEET STREET
PRINEVILLE, OR 97754
(541) 447-6449

PREPARED BY

ARMSTRONG SURVEYING
& ENGINEERING, INC.
378 NE SECOND ST.
PRINEVILLE, OR 97754
(541) 447-7791
DAVID B. ARMSTRONG,
CWRE 145

NOTE

THE PREPARATION OF THIS
MAP IS FOR THE PURPOSE
OF IDENTIFYING THE
LOCATION OF THE WATER
RIGHT ONLY AND HAS NO
INTENT TO PROVIDE
DIMENSIONS OR LOCATIONS
OF PROPERTY OWNERSHIP
LINES.

DRG. NO. 05-3112C
W.O. 05-3112

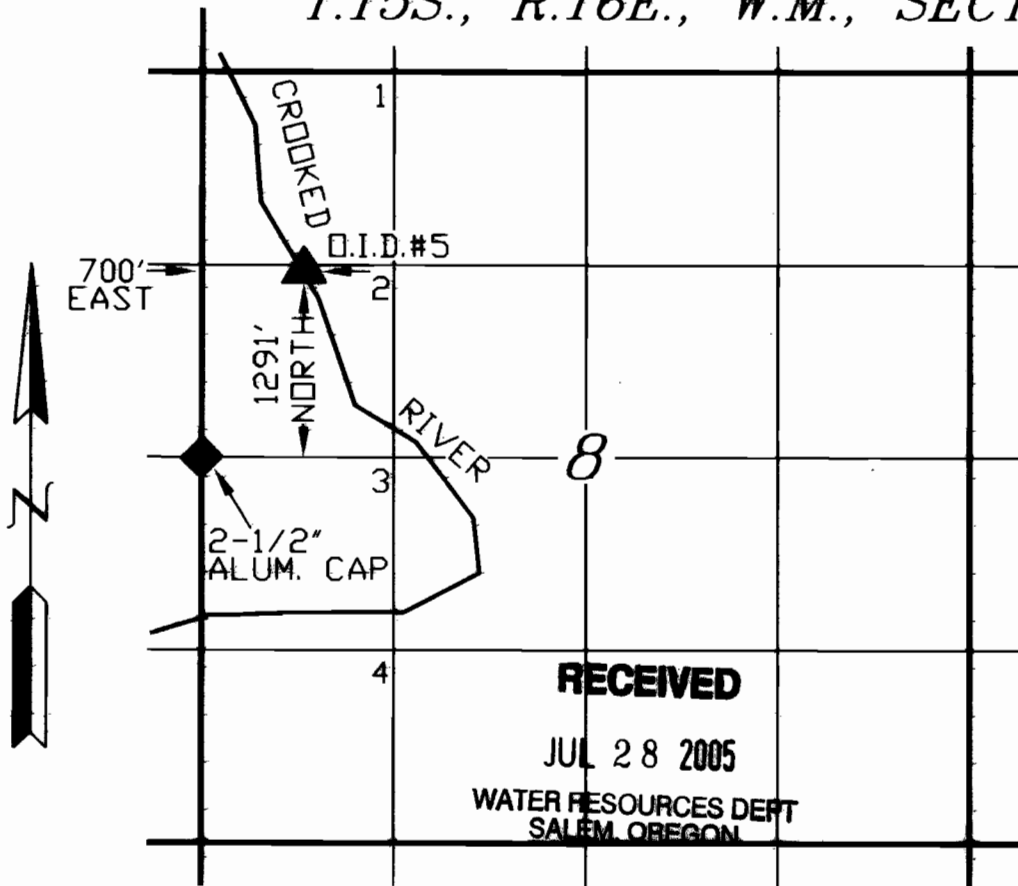

700'
EAST

1291'
NORTH

2-1/2"
ALUM. CAP

RECEIVED

JUL 28 2005

WATER RESOURCES DEPT
SALEM, OREGON

SCALE

1" = 1320'

JULY 25, 2005



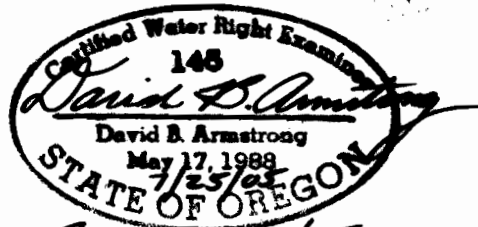

COPY

T -

MAP OF ADDITIONAL POINTS OF DIVERSION

Q.I.D. 1 - SE1/4 SE1/4 SEC. 6,
T.15S., R.16E., W.M.
SOUTH 1674 FT. & WEST 268 FT.
FROM EAST 1/4 COR. SECTION 6.

Q.I.D. 2 - NW1/4 SE1/4 SEC. 6,
T.15S., R.16E., W.M.
SOUTH 191 FT. & WEST 1732 FT.
FROM EAST 1/4 COR. SECTION 6.

Renewed 12/31/05 T.15S., R.16E., W.M., SECTION 6

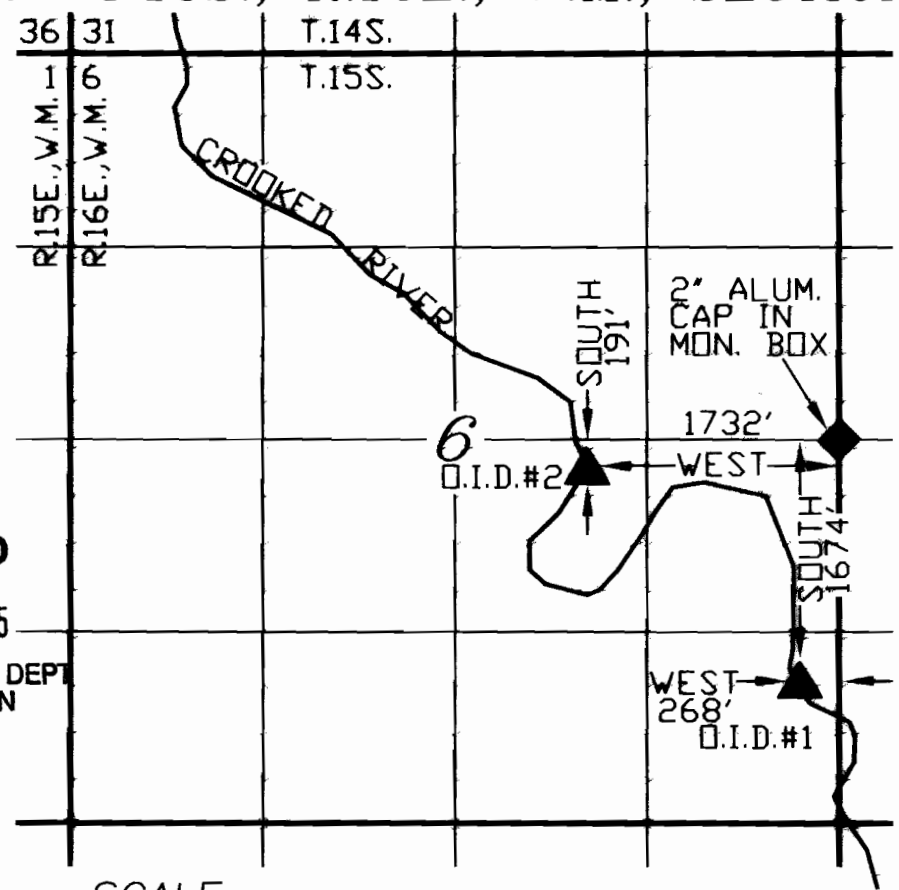

PREPARED FOR

OCHOCO IRRIGATION DISTRICT
1001 NW DEET STREET
PRINEVILLE, OR 97754
(541) 447-6449

PREPARED BY

ARMSTRONG SURVEYING
& ENGINEERING, INC.
378 NE SECOND ST.
PRINEVILLE, OR 97754
(541) 447-7791
DAVID B. ARMSTRONG,
CWRE 145

NOTE

THE PREPARATION OF THIS MAP IS FOR THE PURPOSE OF IDENTIFYING THE LOCATION OF THE WATER RIGHT ONLY AND HAS NO INTENT TO PROVIDE DIMENSIONS OR LOCATIONS OF PROPERTY OWNERSHIP LINES.

RECEIVED
JUL 28 2005
WATER RESOURCES DEPT
SALEM OREGON

SCALE
1" = 1320'



JULY 25, 2005

DRG. NO. 05-3112B
W.O. 05-3112

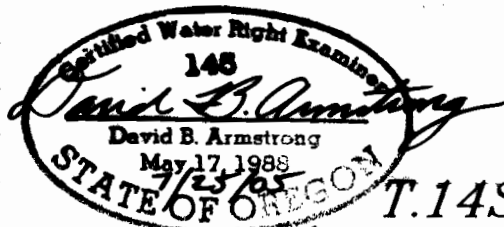

COPY

MAP OF ADDITIONAL
POINTS OF DIVERSION

T.14S., R.15E., W.M., SECTION 36

T.14S., R.16E., W.M., SECTION 31

Revised 12/31/05

D.I.D. #4 - NE1/4 NW1/4 SEC.36,
T.14S., R.15E., W.M.-NORTH 4679
FT. & WEST 3750 FT. FROM SE
COR. SECTION 36.

D.I.D. #3 - SW1/4 SW1/4 (GOV.
LOT 4 SEC. 31, T.14S., R.16E., W.M.
NORTH 1049 FT. & EAST 33 FT.
FROM SW COR. SECTION 31.

PREPARED FOR

OCHOCO IRRIGATION DISTRICT
1001 NW DEER STREET
PRINEVILLE, OR 97754
(541) 447-6449

PREPARED BY

ARMSTRONG SURVEYING
& AND ENGINEERING, INC.
378 NE SECOND ST.
PRINEVILLE, OR 97754
(541) 447-7791
DAVID B. ARMSTRONG,
CWRE 145

NOTE

THE PREPARATION OF THIS
MAP IS FOR THE PURPOSE
OF IDENTIFYING THE
LOCATION OF THE WATER
RIGHT ONLY AND HAS NO
INTENT TO PROVIDE
DIMENSIONS OR LOCATIONS
OF PROPERTY OWNERSHIP
LINES.

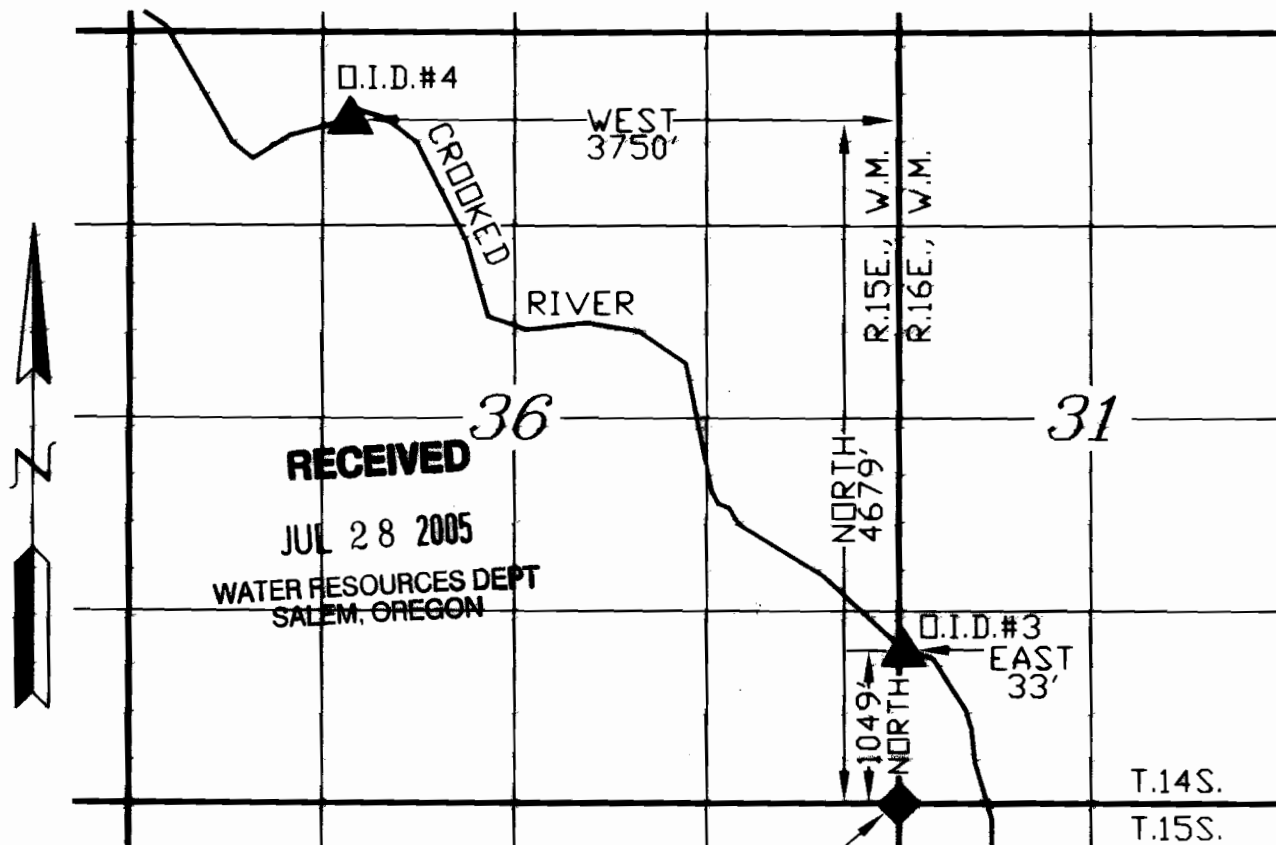

RECEIVED

JUL 28 2005

WATER RESOURCES DEPT
SALEM, OREGON

SCALE

1" = 1320'

2-1/2" BRASS CAP

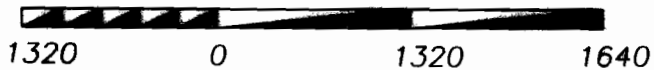

JULY 25, 2005

DRG. NO. 05-3112A
W.O. 05-3112