

T. 1 & 2 S., R 25 E., W.M.

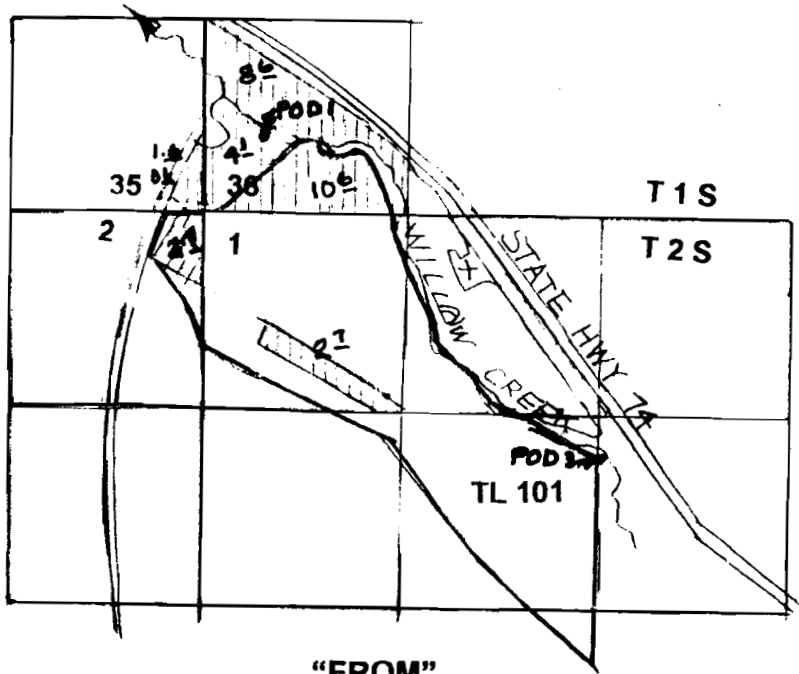

DIV PT 1 - LOC 560' N & 450' E FROM SW CORNER SECTION 36. AUTHORIZED POD
 DIV PT 3 - LOC 910' N & 140' E FROM CENTER SECTION 1. AUTHORIZED POD

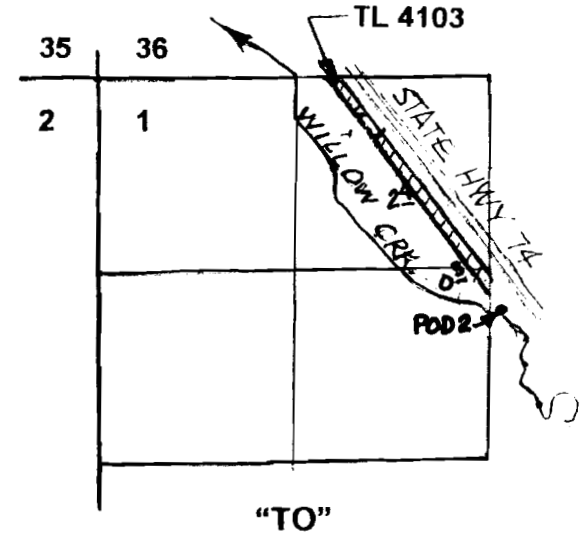
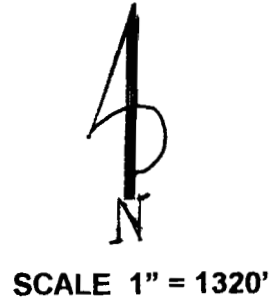

DIV PT 2 - LOC 920' N & 160' E FROM CENTER SECTION 1. PROPOSED POD

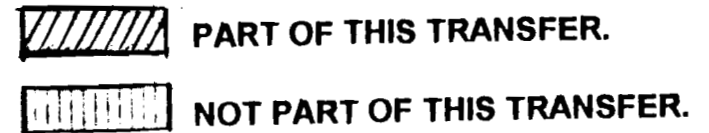

T-8627

TRANSFER APPLICATION - CHANGE IN PLACE OF USE & POD

UNDER

CERTIFICATE No. 64311 RECEIVED

IN NAME OF

HAROLD S. HUBER

NOV 08 2000

WATER RESOURCES DEPT.
 SALEM, OREGON

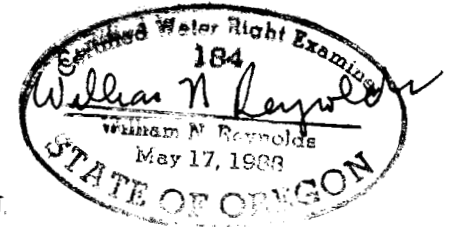

The preparation of this map is for the purpose of identifying the location of water rights only, and has no intent to provide dimensions or locations of property ownership lines.