



T-8634

RECEIVED



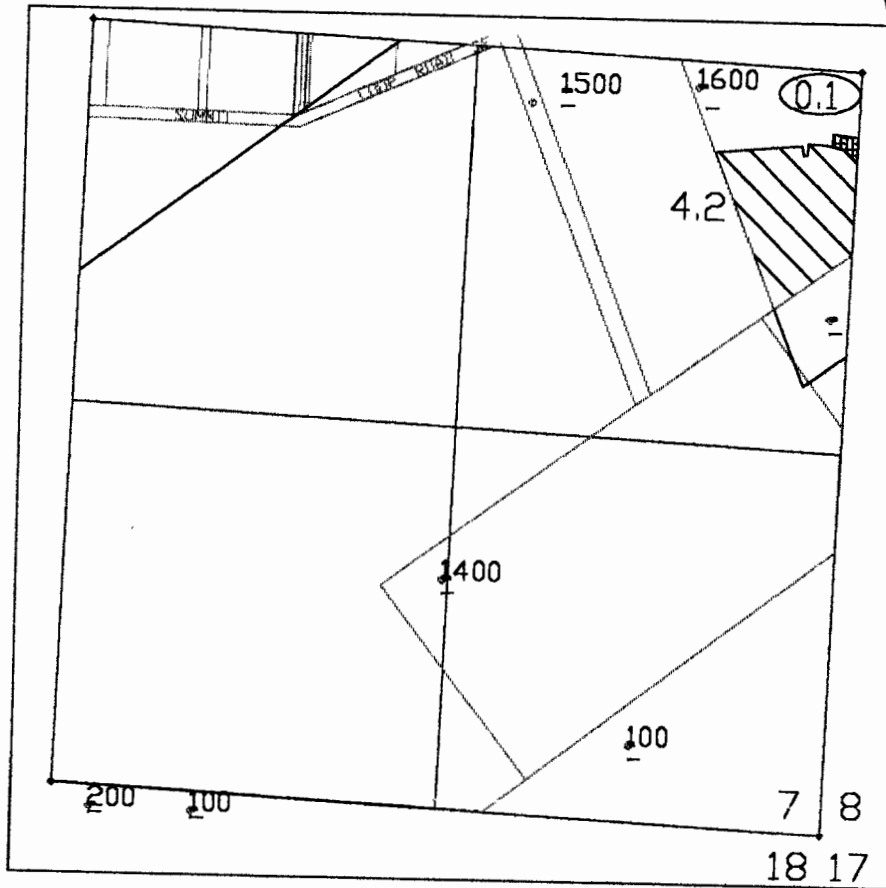

NOV 22 2001

WATER RESOURCES DIVISION
SALEM, OREGON



TRANSFER APPLICATION MAP FOR S.W.C.D.
 09S, 2W, SECTION 7 SE QTR.
 SCALE: 1" = 660'

LEGEND

6.2 = E-82 WATER RIGHT (1909) ACREAGE	 = E-82 WATER RIGHT (1909)
 = E-82 W.R. TRANSFER FROM ACREAGE	
 = E-82 WR TRANSFER TO ACREAGE	 = E-82 WR TRANSFER TO

This map is for the purpose of
 locating a water right only
 and has no intent to provide
 legal dimensions or the location
 of property lines.

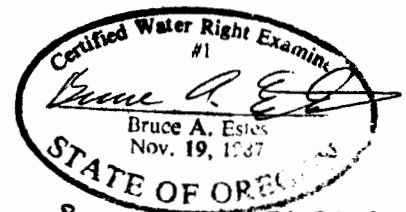

Renewal Dec 31, 2001
 sheet 2 of 2

ESTES SURVEYS

PO Box 17519 60382 Arnold Rd
 Salem, OR 97305-7519 Bend, OR 97702
 (503) 585-7593 (541) 382-7391

