

**No Final Proof Map
Available**

**Unable to locate
Transfer Folder**

N ↑ T 8635 part 1

RECEIVED

NOV 27 2000



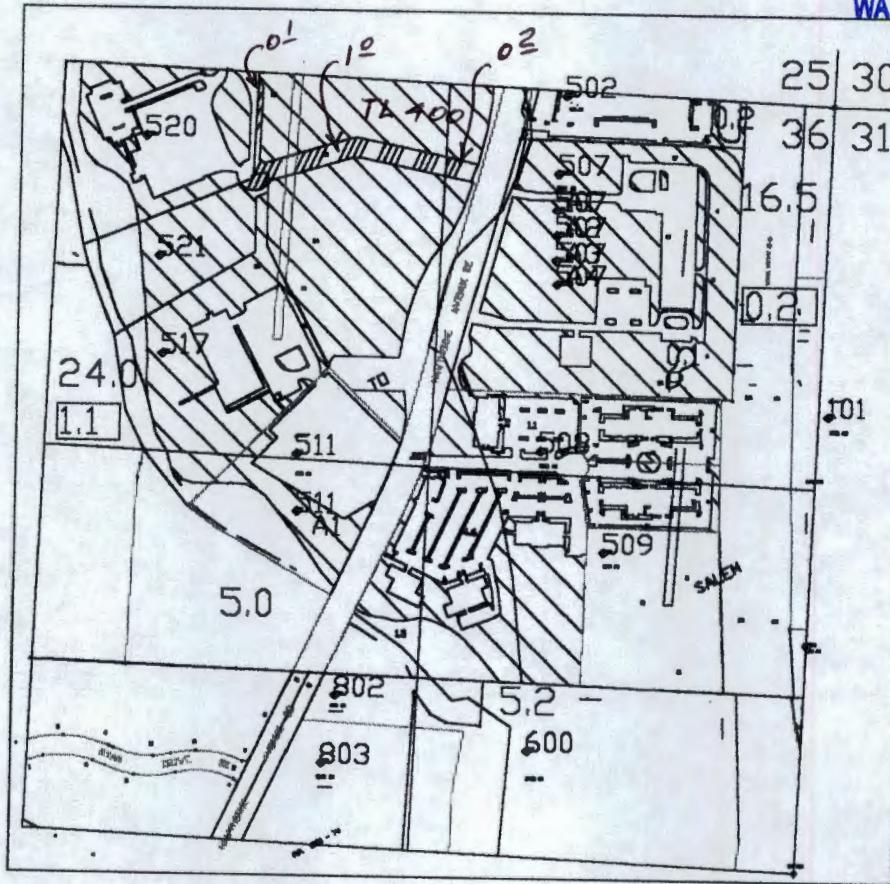

WATER RESOURCES DEPT.
SALEM, OREGON



TRANSFER APPLICATION MAP FOR S.W.C.D.
07S, 3W, SECTION 36 NE QTR.

SCALE: 1" = 660'

LEGEND

- | | | |
|---|---|---|
| 6.2 = E-82 WATER RIGHT (1909) ACREAGE |  | = E-82 WATER RIGHT (1909) |
|  = E-82 W.R. TRANSFER FROM ACREAGE |  | = E-82 W.R. TRANSFER FROM CERTIFICATE # 54286 |
|  = E-82 WR TRANSFER TO ACREAGE | | |

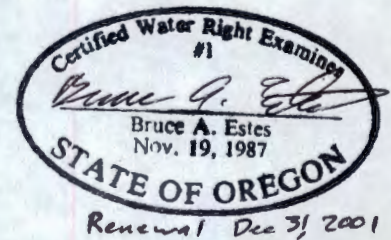

Sheet 2 of 6

This map is for the purpose of locating a water right only and has no intent to provide legal dimensions or the location of property lines.

ESTES SURVEYS

PO Box 17519	60382 Arnold Rd
Salem, OR 97305-7519	Bend, OR 97702
(503) 585-7593	(541) 382-7391



T 8635
Part 1

RECEIVED

NOV 27 2000

WATER RESOURCES DEPT.
SALEM, OREGON

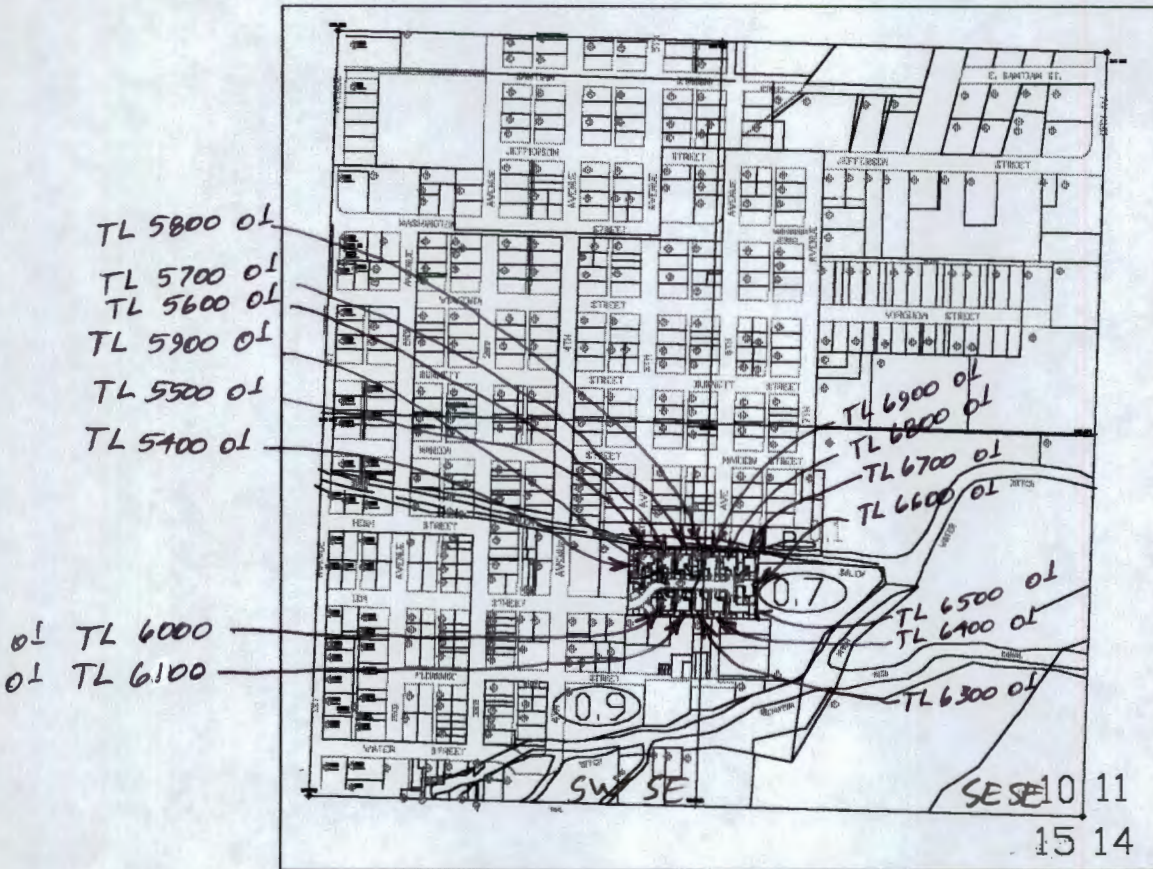





TRANSFER APPLICATION MAP FOR S.W.C.D.

09S, 1W, SECTION 15 NE QTR.

SCALE: 1" = 660'

LEGEND

6.2 = E-82 WATER RIGHT (1909) ACREAGE	 = E-82 WATER RIGHT (1909)
 = E-82 W.R. TRANSFER FROM ACREAGE	
 = E-82 WR TRANSFER TO ACREAGE	 = E-82 WR TRANSFER TO

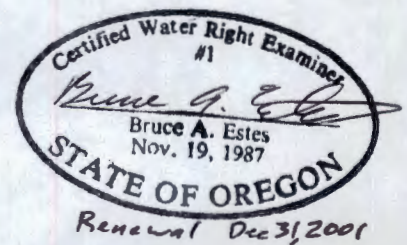

Sheet 3 of 6

ESTES SURVEYS

PO Box 17519 60382 Arnold Rd
 Salem, OR 97305-7519 Bend, OR 97702
 (503) 585-7593 (541) 382-7391

This map is for the purpose of locating a water right only and has no intent to provide legal dimensions or the location of property lines.

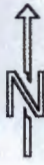

T 8635
Part 1

RECEIVED

NOV 27 2000

WATER RESOURCES DEPT.
SALEM, OREGON



TRANSFER APPLICATION MAP FOR S.W.C.D.
 07S, 3W, SECTION 36 NW QTR.
 SCALE: 1" = 660'

LEGEND

6.2 = E-82 WATER RIGHT (1909) ACREAGE

6.2 = E-82 W.R. TRANSFER FROM ACREAGE

6.2 = E-82 WR TRANSFER TO ACREAGE



= E-82 WATER RIGHT (1909)
CERTIFICATE # 54286



= E-82 WR TRANSFER TO

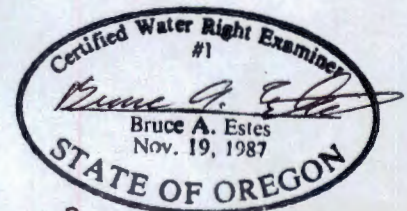

Sheet 4 of 6

ESTES SURVEYS

PO Box 17519
Salem, OR 97305-7519
(503) 585-7593

60382 Arnold Rd
Bend, OR 97702
(541) 382-7391

This map is for the purpose of
locating a water right only
and has no intent to provide
legal dimensions or the location
of property lines.



T 8635
part 1

RECEIVED



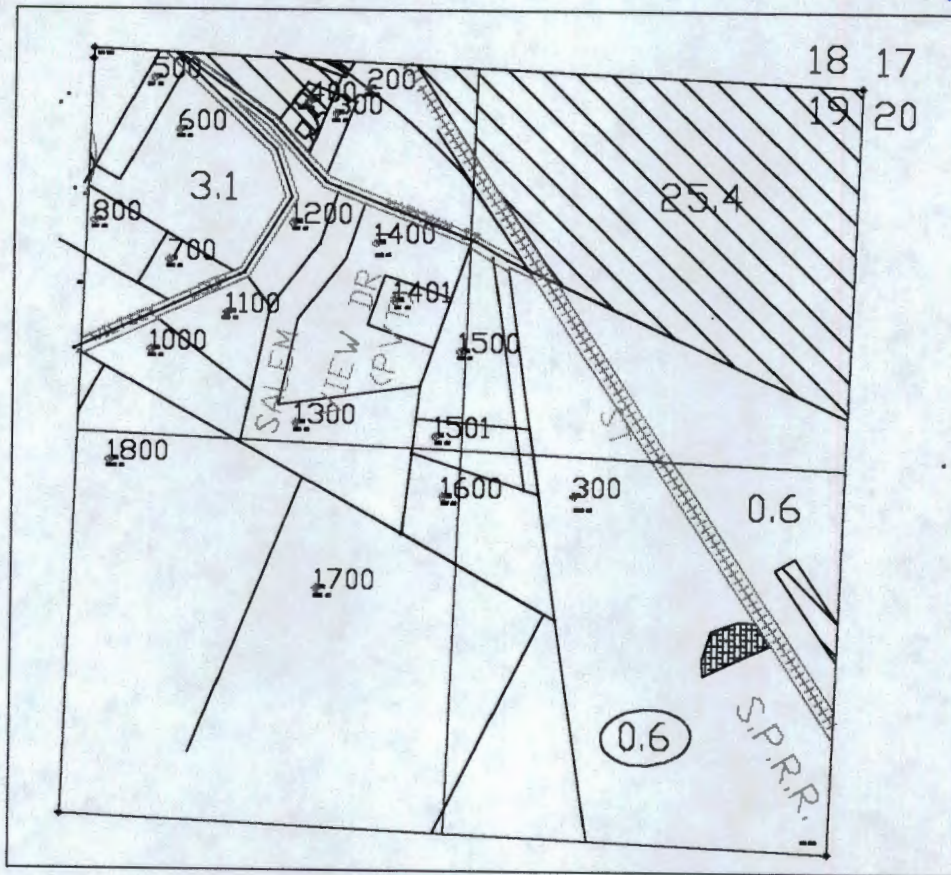

NOV 27 2000

WATER RESOURCES DEPT.
SALEM, OREGON



TRANSFER APPLICATION MAP FOR S.W.C.D.
08S, 2W, SECTION 19 NE QTR.
SCALE: 1" = 660'

LEGEND

- | | |
|---|---|
| 6.2 = E-82 WATER RIGHT (1909) ACREAGE |  = E-82 WATER RIGHT (1909) |
|  = E-82 W.R. TRANSFER FROM ACREAGE |  = E-82 WR TRANSFER TO |
|  = E-82 WR TRANSFER TO ACREAGE | |

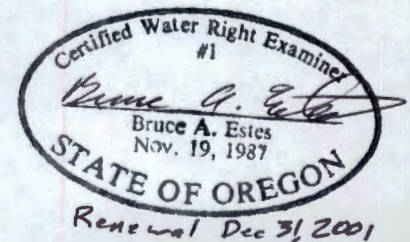

Sheet 5 of 6

This map is for the purpose of
locating a water right only
and has no intent to provide
legal dimensions or the location
of property lines.

ESTES SURVEYS

PO Box 17519	60382 Arnold Rd
Salem, OR 97305-7519	Bend, OR 97702
(503) 585-7593	(541) 382-7391



T 8635
part 2

RECEIVED



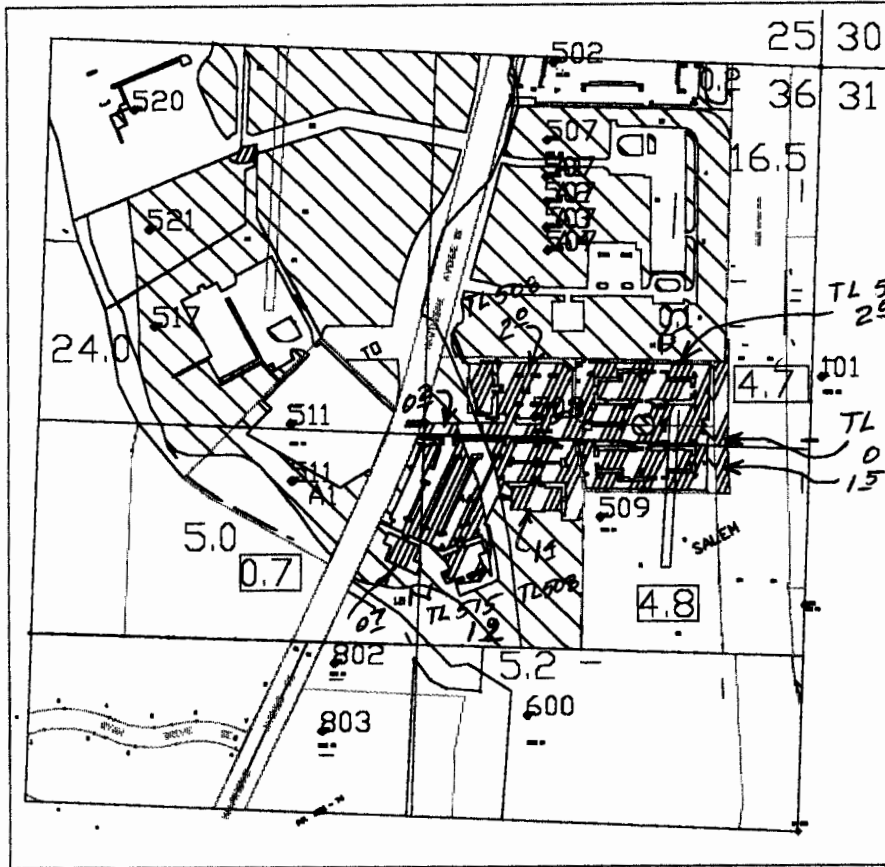

NOV 27 2000

WATER RESOURCES DEPT.
SALEM, OREGON



TRANSFER APPLICATION MAP FOR S.W.C.D.
 07S, 3W, SECTION 36 NE QTR.
 SCALE: 1" = 660'

LEGEND

6.2 = E-82 WATER RIGHT (1909) ACREAGE	 = E-82 WATER RIGHT (1909)
 = E-82 W.R. TRANSFER FROM ACREAGE	 = E-82 W.R. TRANSFER FROM CERTIFICATE # 54286
 = E-82 WR TRANSFER TO ACREAGE	

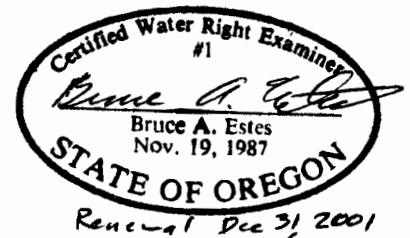

Sheet 1 of 3

This map is for the purpose of
 locating a water right only
 and has no intent to provide
 legal dimensions or the location
 of property lines.

ESTES SURVEYS

PO Box 17519 60382 Arnold Rd
 Salem, OR 97305-7519 Bend, OR 97702
 (503) 585-7593 (541) 382-7391



T 8635
part 2

RECEIVED

NOV 27 2000



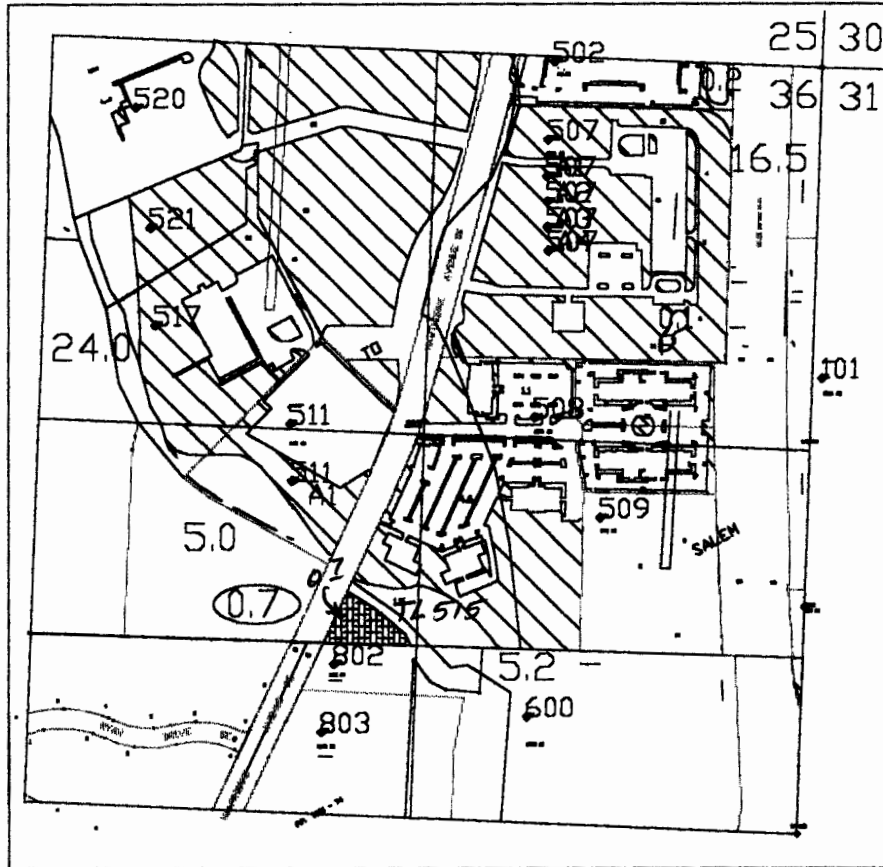

WATER RESOURCES DEPT.
SALEM, OREGON



TRANSFER APPLICATION MAP FOR S.W.C.D.
07S, 3W, SECTION 36 NE QTR.

SCALE: 1" = 660'

LEGEND

6.2 = E-82 WATER RIGHT (1909) ACREAGE	 = E-82 WATER RIGHT (1909)
 = E-82 W.R. TRANSFER FROM ACREAGE	 = E-82 WR TRANSFER TO
 = E-82 WR TRANSFER TO ACREAGE	

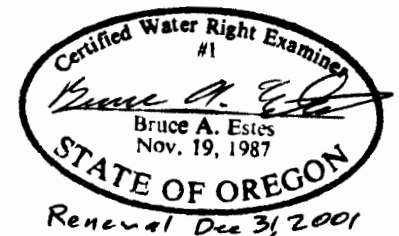

Sheet 2 of 3

This map is for the purpose of
locating a water right only
and has no intent to provide
legal dimensions or the location
of property lines.

ESTES SURVEYS

PO Box 17519	60382 Arnold Rd
Salem, OR 97305-7519	Bend, OR 97702
(503) 585-7593	(541) 382-7391



T 8635
part 2

RECEIVED



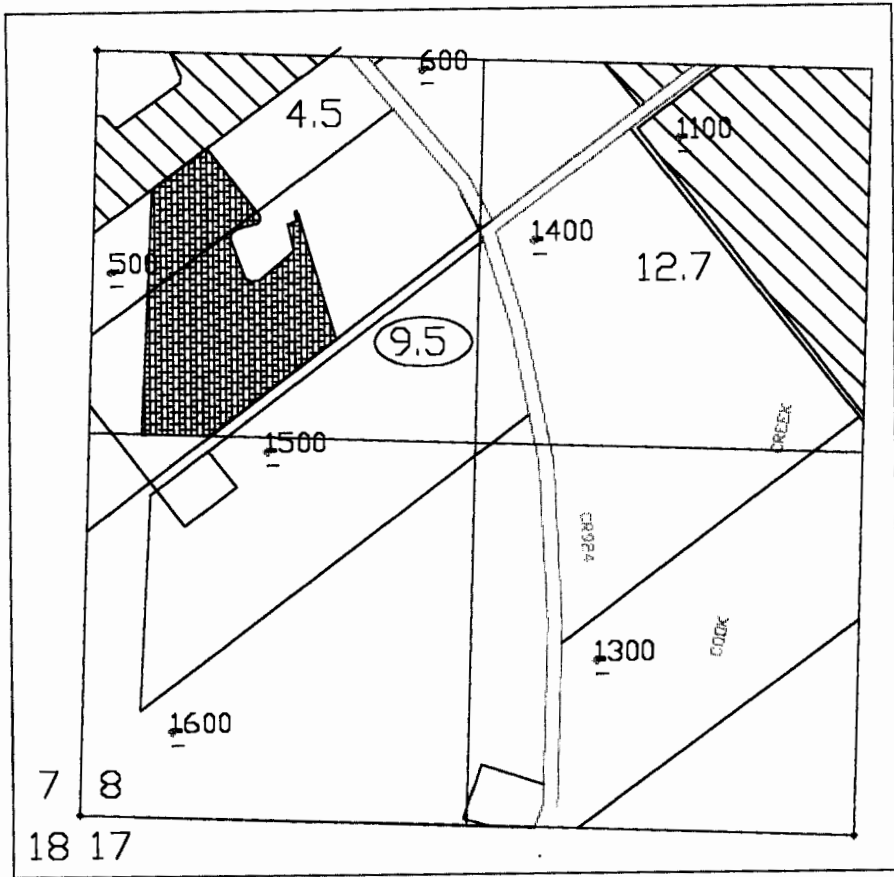

NOV 27 2000

WATER RESOURCES DEPT.
SALEM, OREGON



TRANSFER APPLICATION MAP FOR S.W.C.D.
 09S, 2W, SECTION 8 SW QTR.
 SCALE: 1" = 660'

LEGEND

6.2 = E-82 WATER RIGHT (1909) ACREAGE	 = E-82 WATER RIGHT (1909)
 = E-82 W.R. TRANSFER FROM ACREAGE	 = E-82 WR TRANSFER TO
 = E-82 WR TRANSFER TO ACREAGE	

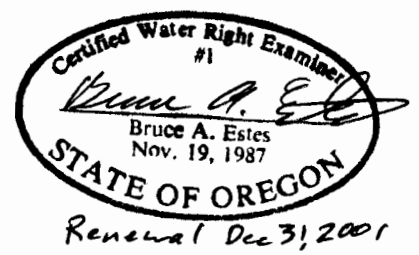

Sheet 3 of 3

This map is for the purpose of
 locating a water right only
 and has no intent to provide
 legal dimensions or the location
 of property lines.

ESTES SURVEYS
 PO Box 17519 60382 Arnold Rd
 Salem, OR 97305-7519 Bend, OR 97702
 (503) 585-7593 (541) 382-7391

T 8635
Part 3

RECEIVED

NOV 27 2000

WATER RESOURCES DEPT.
SALEM, OREGON

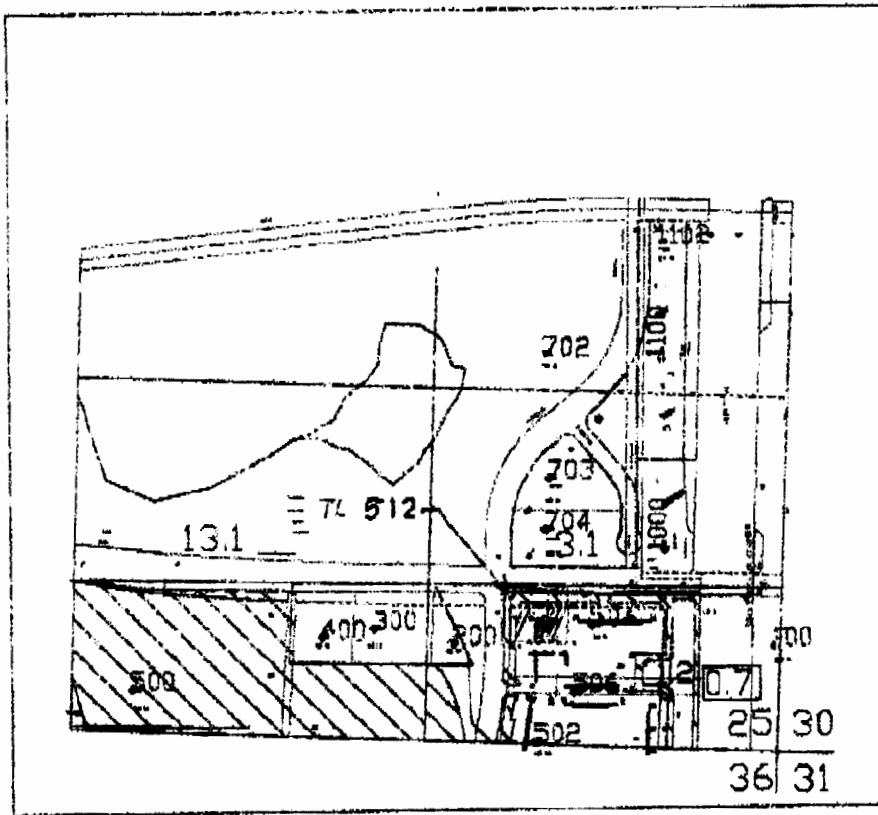

TRANSFER APPLICATION MAP FOR S.W.C.D.
 07S, 3W, SECTION 25 SE QTR.
 SCALE: 1" = 660'

LEGEND

6.2 = E-82 WATER RIGHT (1909) ACREAGE		= E-82 WATER RIGHT (1909)
6.2 = E-82 W.R. TRANSFER FROM ACREAGE		
6.2 = E-82 WR TRANSFER TO ACREAGE		= E-82 W.R. TRANSFER FROM CERTIFICATE # 54286

This map is for the purpose of locating a water right only and has no intent to provide legal dimensions or the location of property lines.

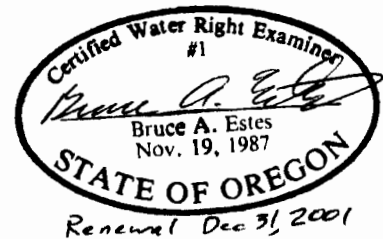

SHEET 2 of 2

ESTES SURVEYS

PO Box 17519
 Salem, OR 97305-7519
 (503) 585-7593

60382 Arnold Rd
 Bend, OR 97702
 (541) 382-7391



T 8635
part 3

RECEIVED

NOV 27 2000

WATER RESOURCES DEPT.
SALEM, OREGON

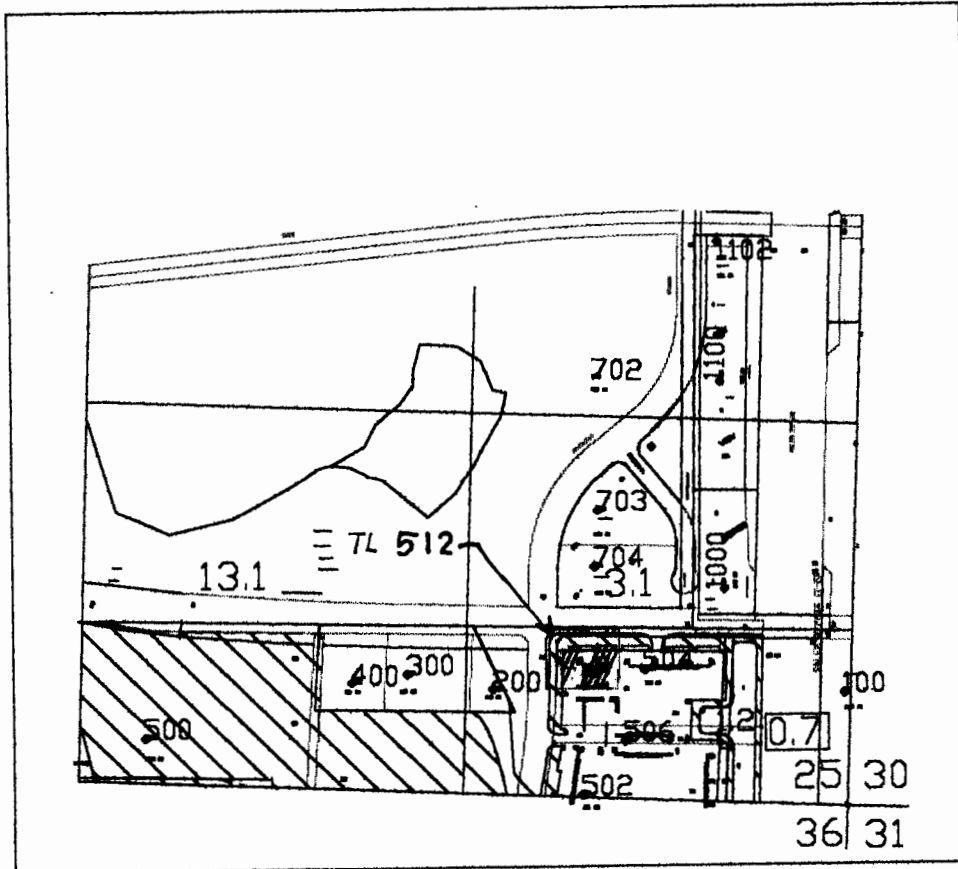





TRANSFER APPLICATION MAP FOR S.W.C.D.

07S, 3W, SECTION 25 SE QTR.

SCALE: 1" = 660'

LEGEND

- | | |
|---|---|
| 6.2 = E-82 WATER RIGHT (1909) ACREAGE |  = E-82 WATER RIGHT (1909) |
|  = E-82 W.R. TRANSFER FROM ACREAGE | |
|  = E-82 WR TRANSFER TO ACREAGE |  = E-82 W.R. TRANSFER FROM CERTIFICATE # 54286 |

Part 3



RECEIVED

NOV 27 2000

**WATER RESOURCES DEPT.
SALEM, OREGON**

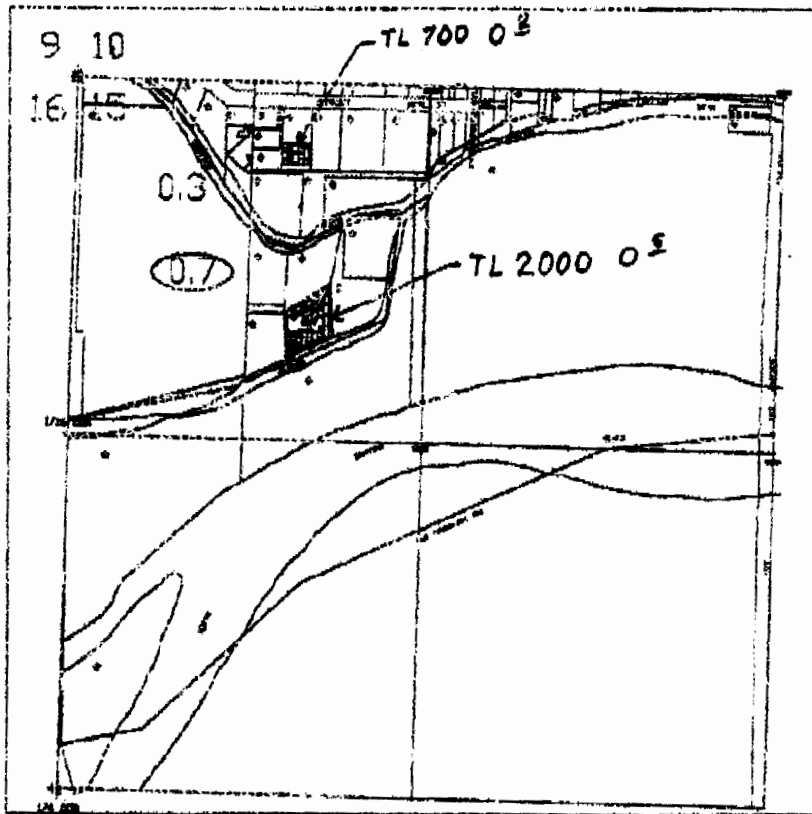

TRANSFER APPLICATION MAP FOR S.W.C.D.
09S, 1W, SECTION 15 NW QTR.
SCALE: 1" = 660'

LEGEND

6.2 = E-92 WATER RIGHT (1909) ACREAGE		= 1401 WATER RIGHT (1911)
= W.R. TRANSFER FROM ACREAGE		
= W.R. TRANSFER TO ACREAGE		= E-92 WR TRANSFER TO

This map is for the purpose of locating a water right only and has no intent to provide legal dimensions or the location of property lines.

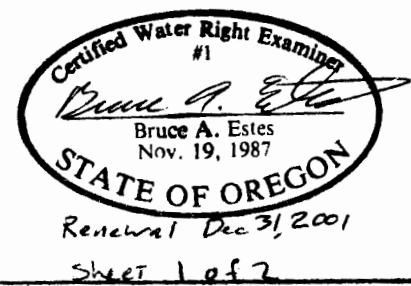

ESTES SURVEYS

PO Box 17519 60382 Arnold Rd
Salem, OR 97305-7519 Bend, OR 97702
(503) 585-7593 (541) 382-7391

T 8635
N part 4

RECEIVED

NOV 27 2000

WATER RESOURCES DEPT.
SALEM, OREGON

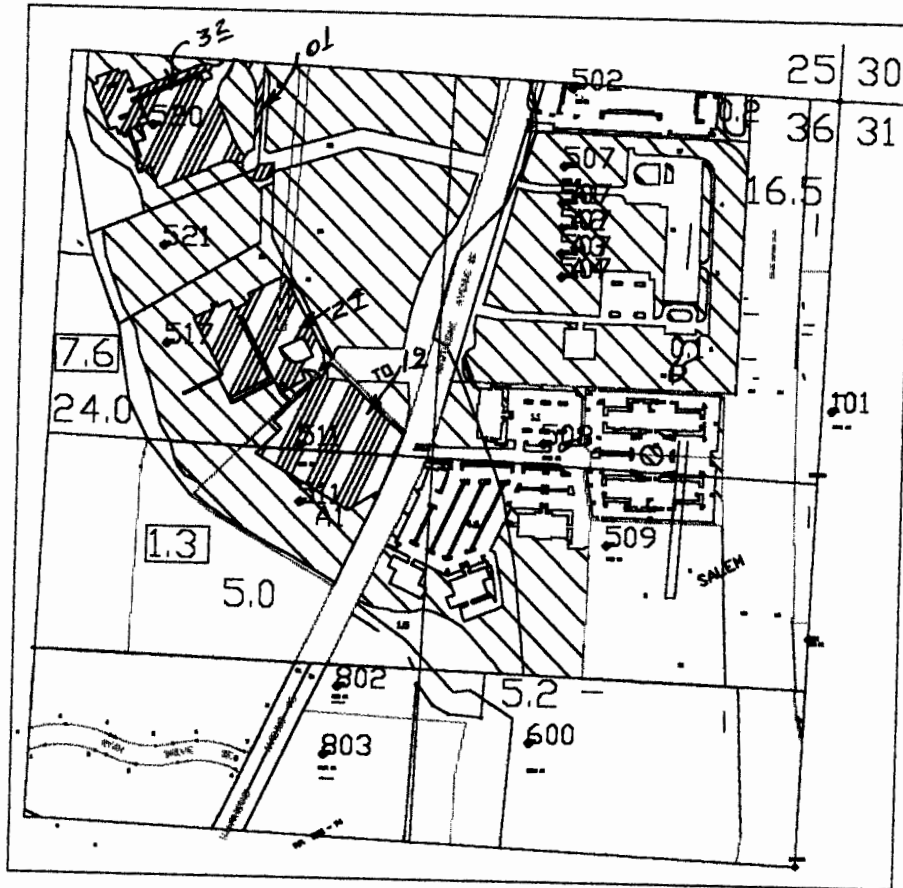

TRANSFER APPLICATION MAP FOR S.W.C.D.
07S, 3W, SECTION 36 NE QTR.

SCALE: 1" = 660'

LEGEND

6.2 = E-82 WATER RIGHT (1909) ACREAGE	= E-82 WATER RIGHT (1909)
= E-82 W.R. TRANSFER FROM ACREAGE	= E-82 W.R. TRANSFER FROM CERTIFICATE # 54286
= E-82 WR TRANSFER TO ACREAGE	

This map is for the purpose of locating a water right only and has no intent to provide legal dimensions or the location of property lines.

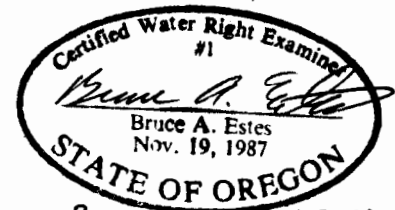

Renewal Dec 31, 2001
Sheet 1 of 5

ESTES SURVEYS

PO Box 17519 60382 Arnold Rd
Salem, OR 97305-7519 Bend, OR 97702
(503) 585-7593 (541) 382-7391

T 8635
part 4

RECEIVED

NOV 27 2000



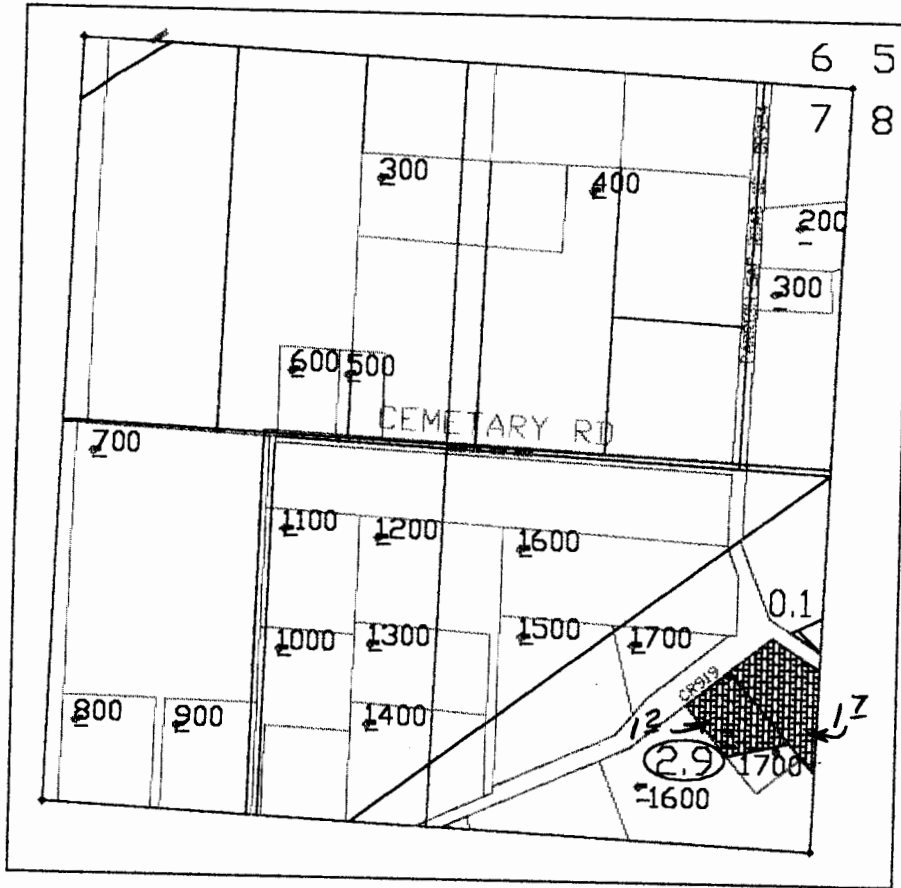

WATER RESOURCES DEPT.
SALEM, OREGON



TRANSFER APPLICATION MAP FOR S.W.C.D.
09S, 2W, SECTION 7 NE QTR.

SCALE: 1" = 660'

LEGEND

6.2 = E-82 WATER RIGHT (1909) ACREAGE	 = E-82 WATER RIGHT (1909)
 = E-82 W.R. TRANSFER FROM ACREAGE	
 = E-82 WR TRANSFER TO ACREAGE	 = E-82 WR TRANSFER TO

This map is for the purpose of locating a water right only and has no intent to provide legal dimensions or the location of property lines.

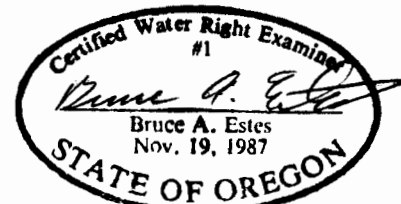

Renewal Dec 31, 2001
Sheet 2 of 5

ESTES SURVEYS

PO Box 17519 60382 Arnold Rd
Salem, OR 97305-7519 Bend, OR 97702
(503) 585-7593 (541) 382-7391



RECEIVED

NOV 27 2000

WATER RESOURCES DEPT.
SALEM, OREGON

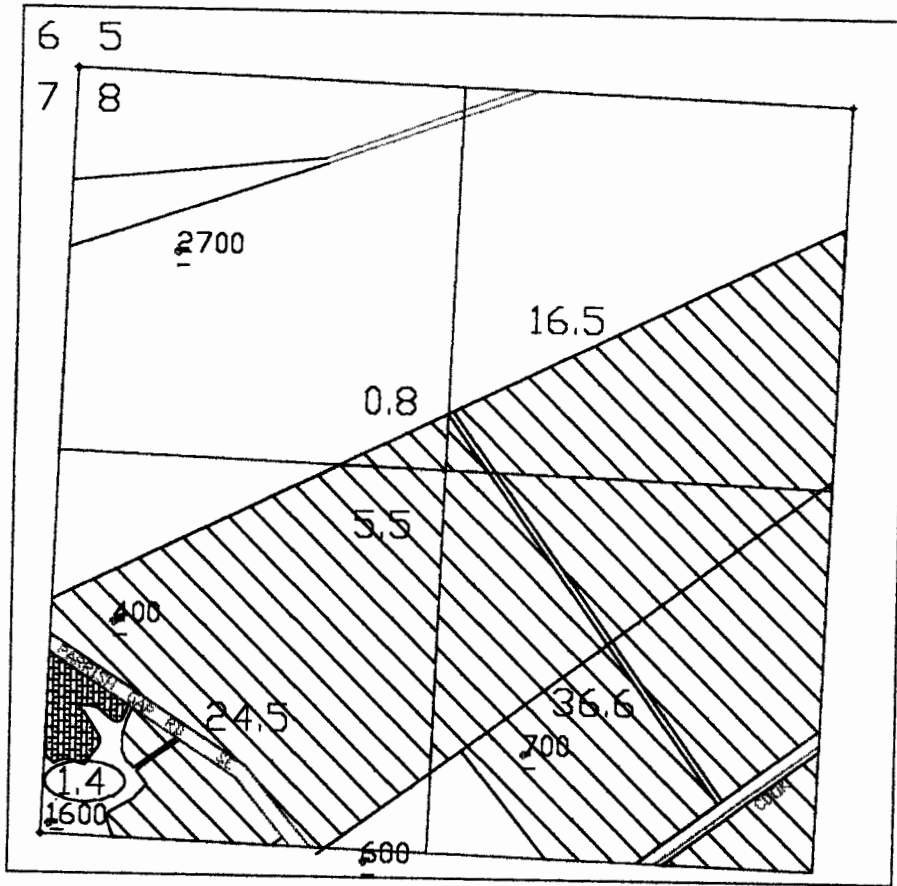

TRANSFER APPLICATION MAP FOR S.W.C.D.
09S, 2W, SECTION 8 NW QTR.

SCALE: 1" = 660'

LEGEND

6.2 = E-82 WATER RIGHT (1909) ACREAGE

 = E-82 WATER RIGHT (1909)

 = E-82 W.R. TRANSFER FROM ACREAGE

 = E-82 VR TRANSFER TO ACREAGE

 = E-82 VR TRANSFER TO

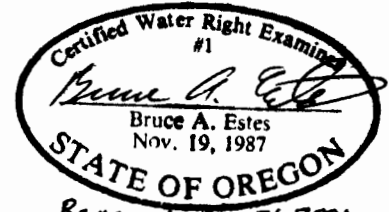

Renewal Dec 31, 2001
Sheet 5 of 5

This map is for the purpose of
locating a water right only
and has no intent to provide
legal dimensions or the location
of property lines.

ESTES SURVEYS

PO Box 17519 60382 Arnold Rd
Salem, OR 97305-7519 Bend, OR 97702
(503) 585-7593 (541) 382-7391



T 8635
part 4

RECEIVED

NOV 27 2000

WATER RESOURCES DEPT.
SALEM, OREGON

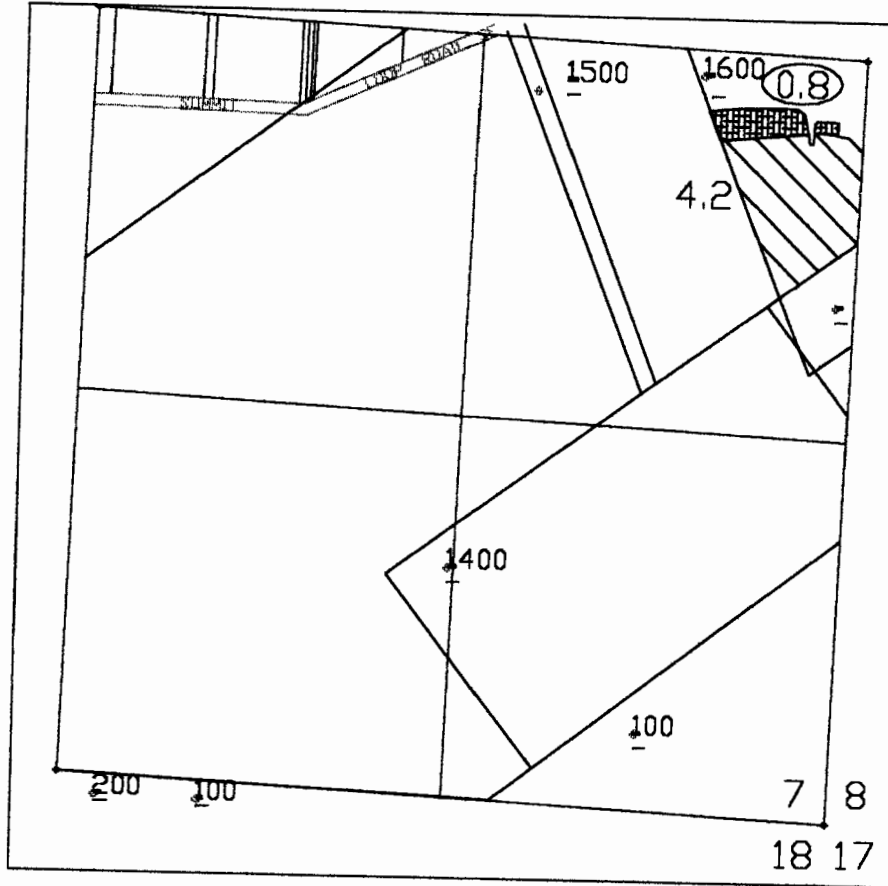

TRANSFER APPLICATION MAP FOR S.W.C.D.
09S, 2W, SECTION 7 SE QTR.

SCALE: 1" = 660'

LEGEND

6.2 = E-82 WATER RIGHT (1909) ACREAGE

 = E-82 WATER RIGHT (1909)

 = E-82 W.R. TRANSFER FROM ACREAGE

 = E-82 WR TRANSFER TO

 = E-82 WR TRANSFER TO ACREAGE

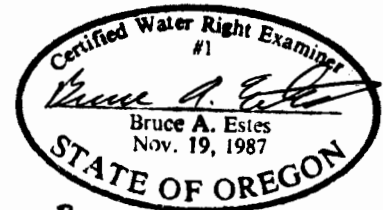

Renewal Dec 31, 2001
Sheet 4 of 5

This map is for the purpose of
locating a water right only
and has no intent to provide
legal dimensions or the location
of property lines.

ESTES SURVEYS

PO Box 17519 60382 Arnold Rd
Salem, OR 97305-7519 Bend, OR 97702
(503) 585-7593 (541) 382-7391

T 8635
 N
 part 4

RECEIVED

NOV 27 2000

WATER RESOURCES DEPT.
 SALEM, OREGON

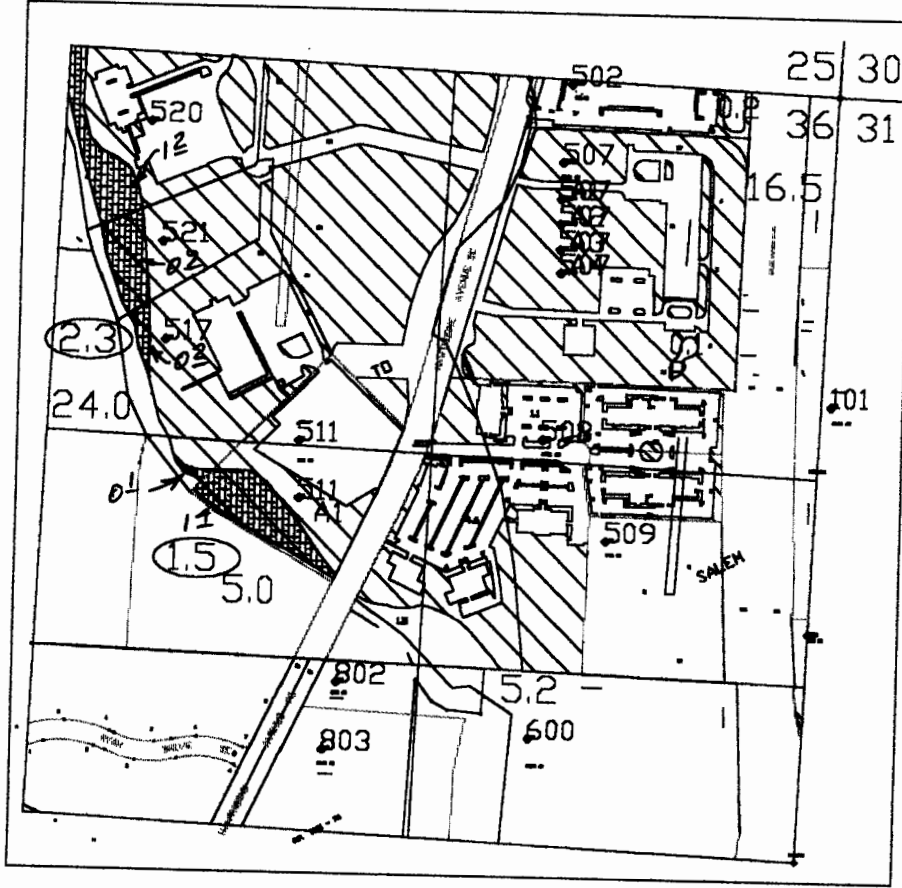

TRANSFER APPLICATION MAP FOR S.W.C.D.
 07S, 3W, SECTION 36 NE QTR.
 SCALE: 1" = 660'

LEGEND	
6.2 = E-82 WATER RIGHT (1909) ACREAGE	= E-82 WATER RIGHT (1909)
= E-82 W.R. TRANSFER FROM ACREAGE	= E-82 WR TRANSFER TO
= E-82 WR TRANSFER TO ACREAGE	

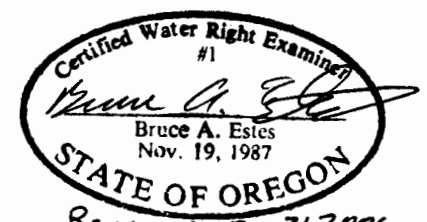

Renewal Dec 31, 2001
 Sheet 3 of 5

This map is for the purpose of locating a water right only and has no intent to provide legal dimensions or the location of property lines.

ESTES SURVEYS
 PO Box 17519 60382 Arnold Rd
 Salem, OR 97305-7519 Bend, OR 97702
 (503) 585-7593 (541) 382-7391