

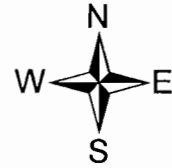

T1N, R32E, WM  
 Sections 10, 15 & 22  
 Umatilla County



1 inch = 1320 feet

**LEGEND**

- **Authorized POD**  
 Transfer FROM Authorized POD located 700 feet S and 1800 feet W from the East Quarter-Corner of Section 22
- **Proposed POD**  
 Proposed POD 1 located 2121 feet S and 2351 feet E from NW Corner of Section 15  
  
 Proposed POD 2 located 2310 feet N and 2124 feet E from SW Corner of Section 15  
  
 Proposed POD 3 located 1300 feet N and 2590 feet W from SE Corner of Section 15

-  **POU Included in Transfer**  
 4.0 ac in SW/NE S15  
 5.0 ac in SE/NW S15  
 3.0 ac in NE/SW S15  
 26.0 ac in NW/SE S15  
 9.0 ac in SW/SE S15

Place of Use for various priority dates clarified on separate map.

-  **POU Not Included**  
 18.0 ac in SW/SW S10  
 0.5 ac in SE/SW S10  
 12.0 ac in NE/NW S15  
 0.5 ac in NW/NW S15  
 20.0 ac in SW/SE S15  
 18.0 ac in NW/NE S22

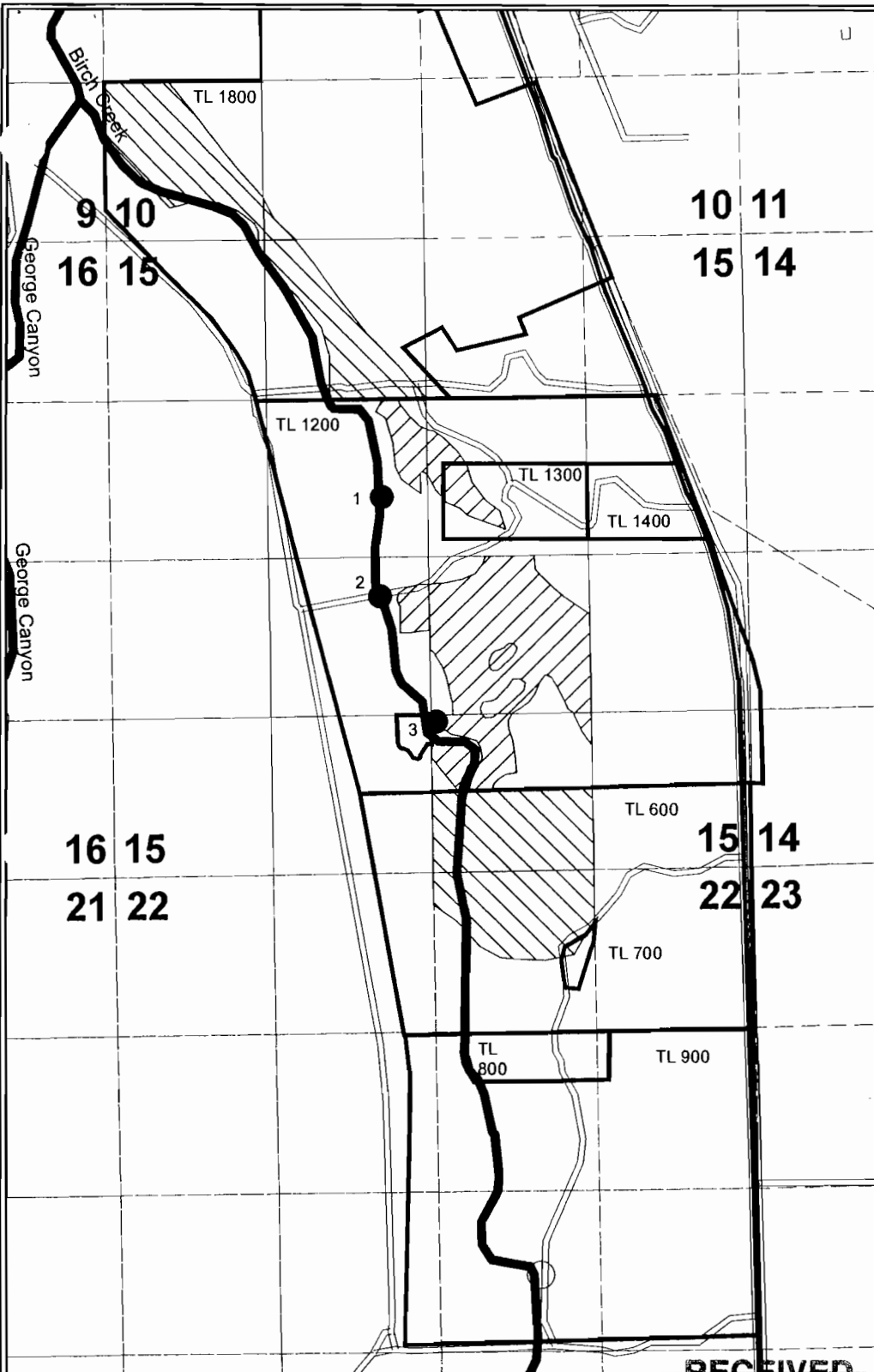

**RECEIVED**

FEB 01 2007

T 10311

WATER RESOURCES DEPT  
 SALEM, OREGON

The purpose of this map is to identify the location of a water right. It is not intended to provide information regarding the location of property ownership boundary lines.

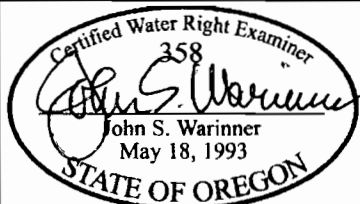

**FOUNTAINHEAD**  
 1860 Blue Creek Road  
 Walla Walla, WA 99362  
 509.529.2646 phone

**TRANSFER MAP**  
**Change in POD**  
**Certificate 56171**  
 in the name of  
**PENDLETON COUNTRY CLUB**  
 Revised 31 DEC 2006

T1N, R32E, WM  
Section 15  
Umatilla County

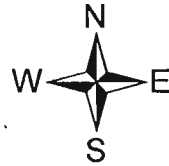

1 inch = 400 feet

**LEGEND**

○ **Authorized POD**  
See main Transfer Map

⊕ **Proposed POD**  
See main Transfer Map

□ **POU Included in Transfer**

■ **1873 Priority Date**

▨ **1889 Priority Date**

□ **WHITE 1900 Priority Date**

**SW/NE S15 (4.0 acres)**

1.3 ac of 1873 (T1, FW1, FW9)  
2.6 ac of 1889 (OB)  
0.1 ac of 1900 (OB)

**SE/NW S15 (5.0 acres)**

1.0 ac of 1873 (G1, AP1, FW1)  
4.0 ac of 1900 (OB)

**NE/SW S15 (3.0 acres)**

0.4 ac of 1873 (AP10, FW10)  
2.6 ac of 1900 (OB)

**NW/SE S15 (26.0 acres)**

4.2 ac of 1873 (G13, G15, G17-18,  
T14, T16, T18, AP13, AP15, AP17-  
18, FW10, FW13, FW14)  
5.1 ac of 1889 (FW 15-18)  
16.7 ac of 1900 (OB)

**SW/SE S15 (9.0 acres)**

1.1 ac of 1873 (T12, T13, T17, G12,  
G16, AP12, AP16, FW12)  
7.9 ac of 1900 (OB)

**POU Not Included**

See main Transfer Map

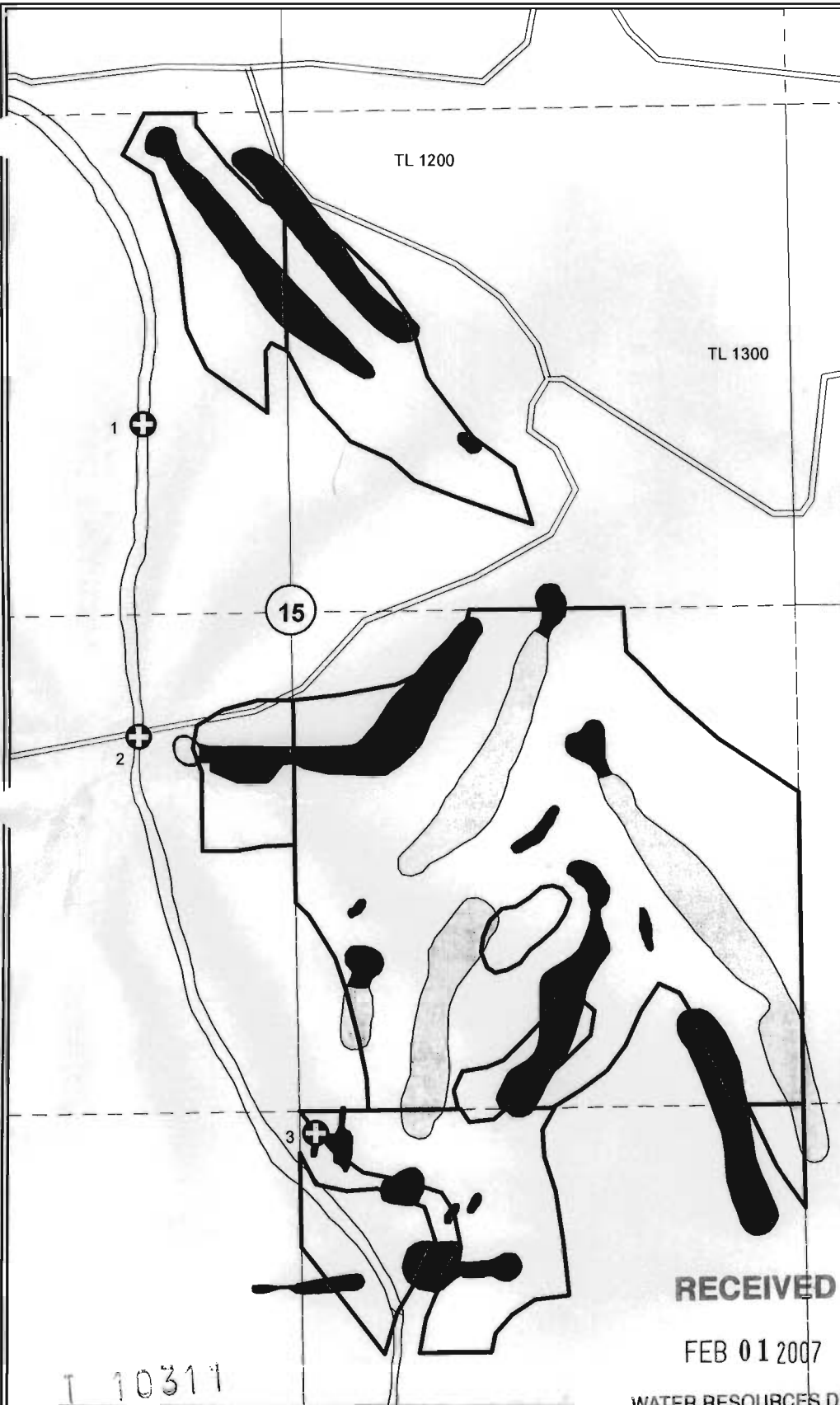

RECEIVED

FEB 01 2007

WATER RESOURCES DEPT  
SALEM, OREGON

The purpose of this map is to identify the location of a water right. It is not intended to provide information regarding the location of property ownership boundary lines.

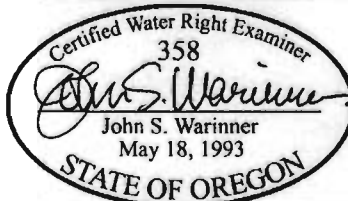

FOUNTAINHEAD  
1860 Blue Creek Road  
Walla Walla, WA 99362  
509.529.2646 phone

**DETAIL MAP**  
Clarifying Priority Dates  
For Transfer Involving  
Certificate 56171

in the name of  
PENDLETON COUNTRY CLUB

Revised 31 DEC 2006