

WATERS RIGHTS APPLICATION MAP
MARTHA JACKSON, LLC
 LOCATED IN THE SW 1/4 OF SECTION 3, T. 14 S.,
 R. 13 E., W.M., DESCHUTES COUNTY, OREGON

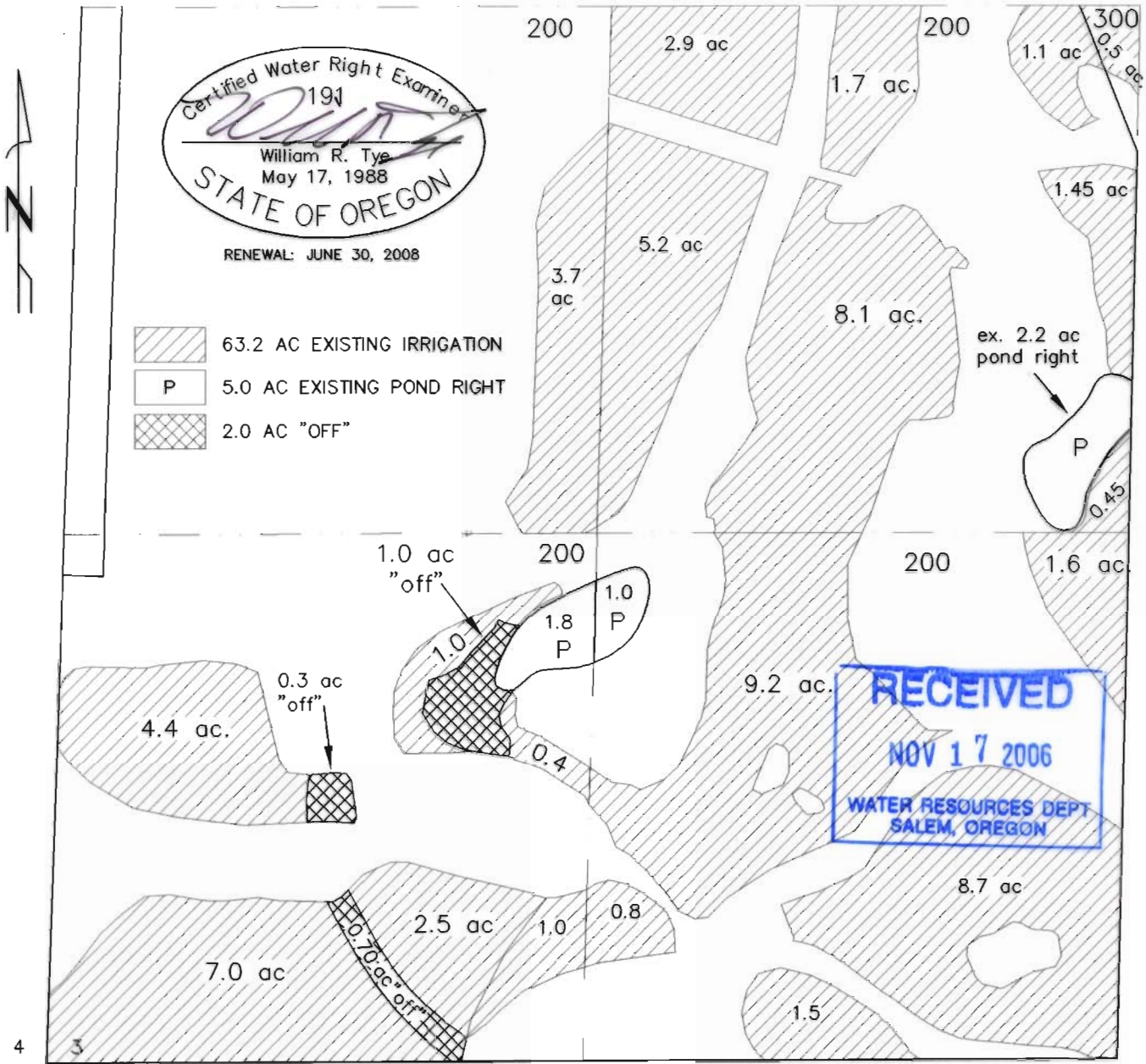



9 10 I, WILLIAM R. TYE, CERTIFIED WATER RIGHT EXAMINER IN THE STATE OF OREGON, HEREBY CERTIFY THE ABOVE APPLICATION MAP WAS PREPARED UNDER MY DIRECT SUPERVISION. THE PREPARATION OF THIS MAP IS FOR THE PURPOSE OF IDENTIFYING THE LOCATION OF THE WATER RIGHT ONLY AND HAS NO INTENT TO PROVIDE DIMENSIONS OR LOCATIONS OF PROPERTY OWNERSHIP LINES.

TYE ENGINEERING, INC.

725 NW HILL, BEND, OREGON 97701 (541) 389-6959

10267

-  76.7 AC EXISTING IRRIGATION
-  3.58 AC EXISTING POND RIGHT
-  13.0 AC "ON" POND RIGHT

WATERS RIGHTS APPLICATION MAP
CANYONS LAND AND CATTLE COMPANY, LLC
 LOCATED IN THE NW 1/4 OF SECTION 10, T. 14 S.,
 R. 13 E., W.M., DESCHUTES COUNTY, OREGON

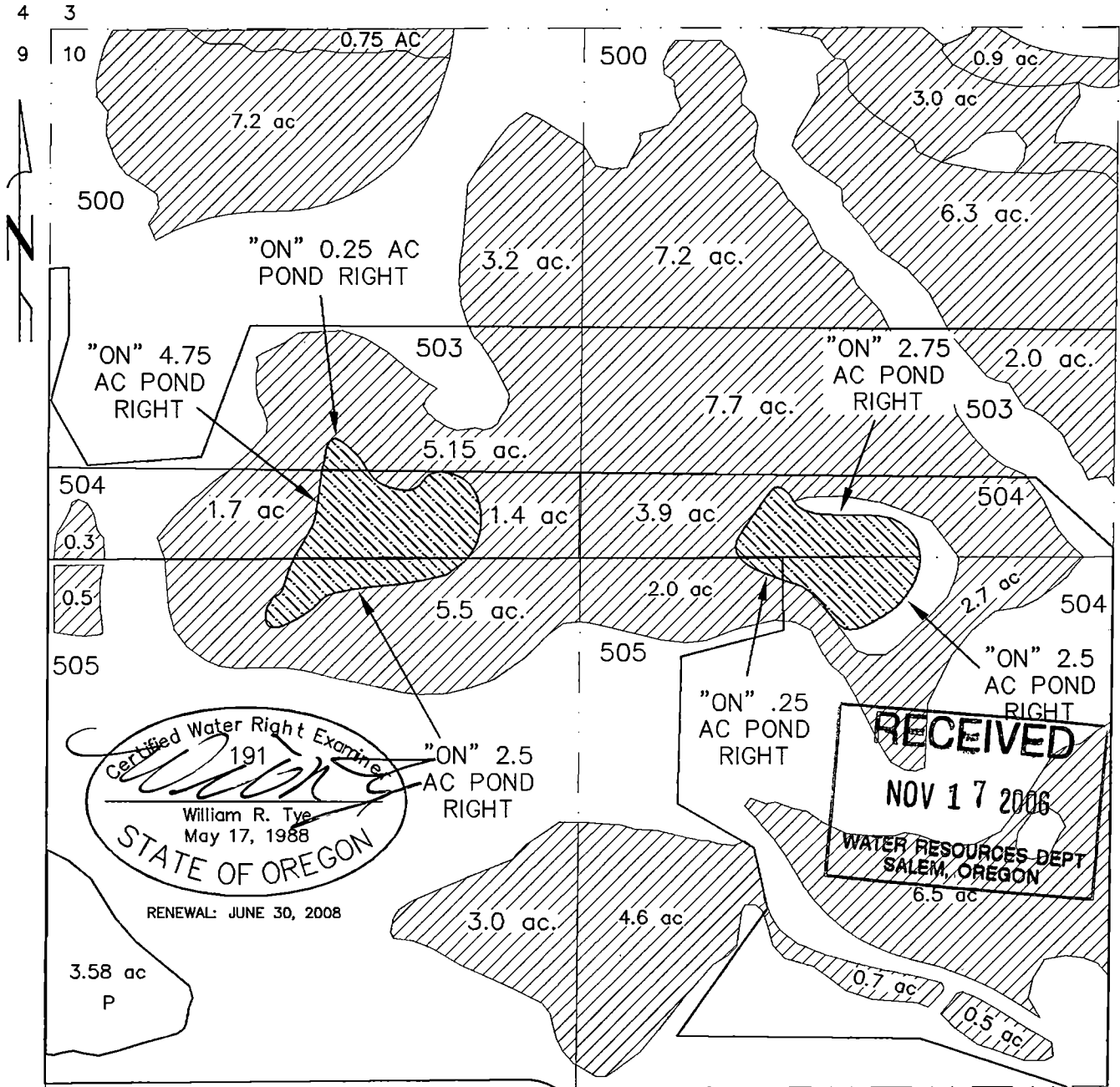



I, WILLIAM R. TYE, CERTIFIED WATER RIGHT EXAMINER IN THE STATE OF OREGON, HEREBY CERTIFY THE ABOVE APPLICATION MAP WAS PREPARED UNDER MY DIRECT SUPERVISION. THE PREPARATION OF THIS MAP IS FOR THE PURPOSE OF IDENTIFYING THE LOCATION OF THE WATER RIGHT ONLY AND HAS NO INTENT TO PROVIDE DIMENSIONS OR LOCATIONS OF PROPERTY OWNERSHIP LINES.

T 10267

TYE ENGINEERING, INC.

725 NW HILL, BEND, OREGON 97701 (541) 389-6959

-  57.13 AC EXISTING IRRIGATION
-  16.38 AC EXISTING POND RIGHT
-  3.8 AC "OFF"

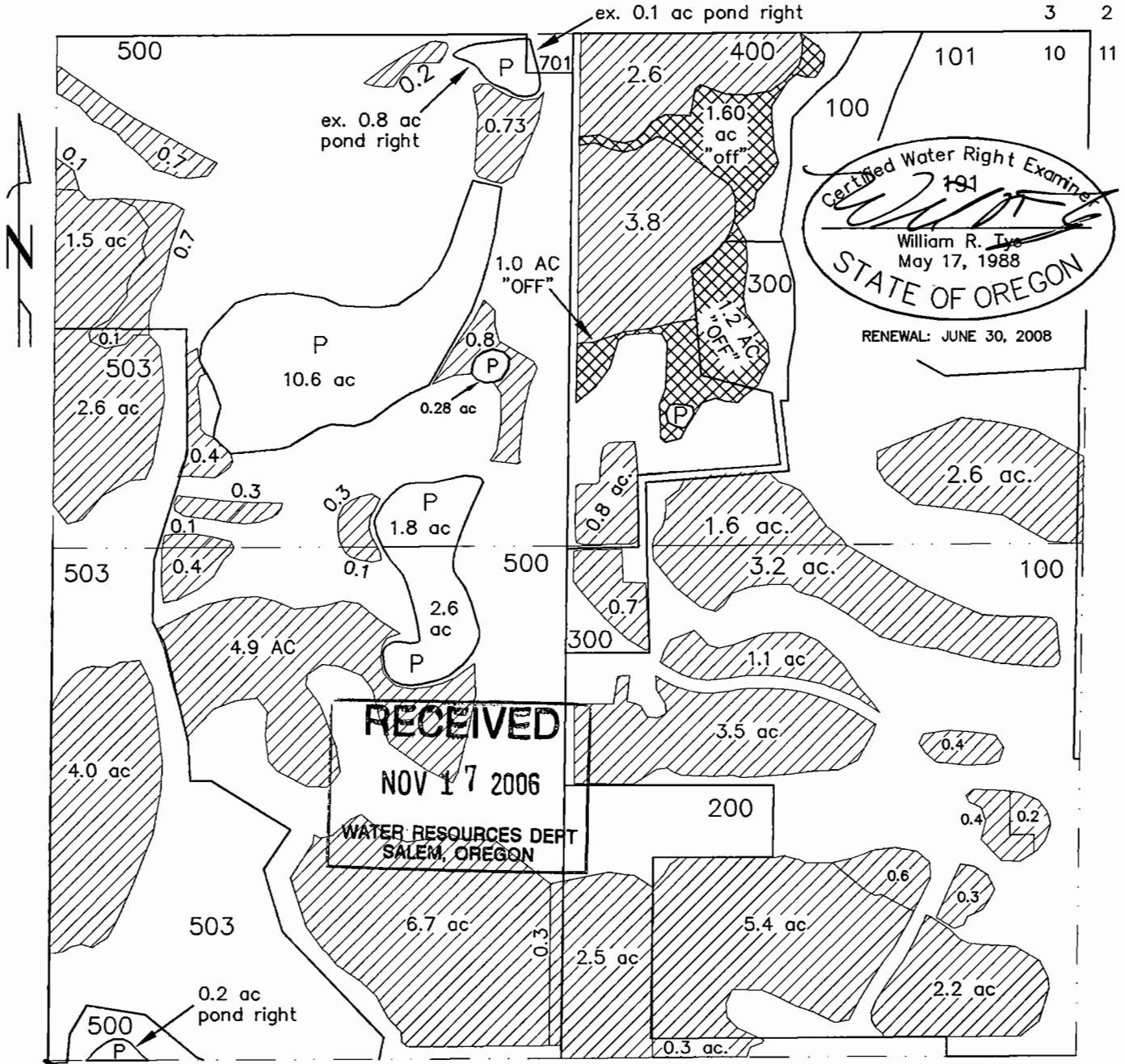

WATERS RIGHTS APPLICATION MAP
CANYONS LAND AND CATTLE COMPANY, LLC
 LOCATED IN THE NE 1/4 OF SECTION 10, T. 14 S.,
 R. 13 E., W.M., DESCHUTES COUNTY, OREGON



I, WILLIAM R. TYE, CERTIFIED WATER RIGHT EXAMINER IN THE STATE OF OREGON, HEREBY CERTIFY THE ABOVE APPLICATION MAP WAS PREPARED UNDER MY DIRECT SUPERVISION. THE PREPARATION OF THIS MAP IS FOR THE PURPOSE OF IDENTIFYING THE LOCATION OF THE WATER RIGHT ONLY AND HAS NO INTENT TO PROVIDE DIMENSIONS OR LOCATIONS OF PROPERTY OWNERSHIP LINES.

TYE ENGINEERING, INC.

725 NW HILL, BEND, OREGON 97701 (541) 389-6959

-  24.06 AC EXISTING IRRIGATION
-  2.08 AC EXISTING POND RIGHT
-  1.9 AC "OFF"

WATERS RIGHTS APPLICATION MAP
CANYONS LAND AND CATTLE COMPANY, LLC
 LOCATED IN THE SW 1/4 OF SECTION 10, T. 14 S.,
 R. 13 E., W.M., DESCHUTES COUNTY, OREGON

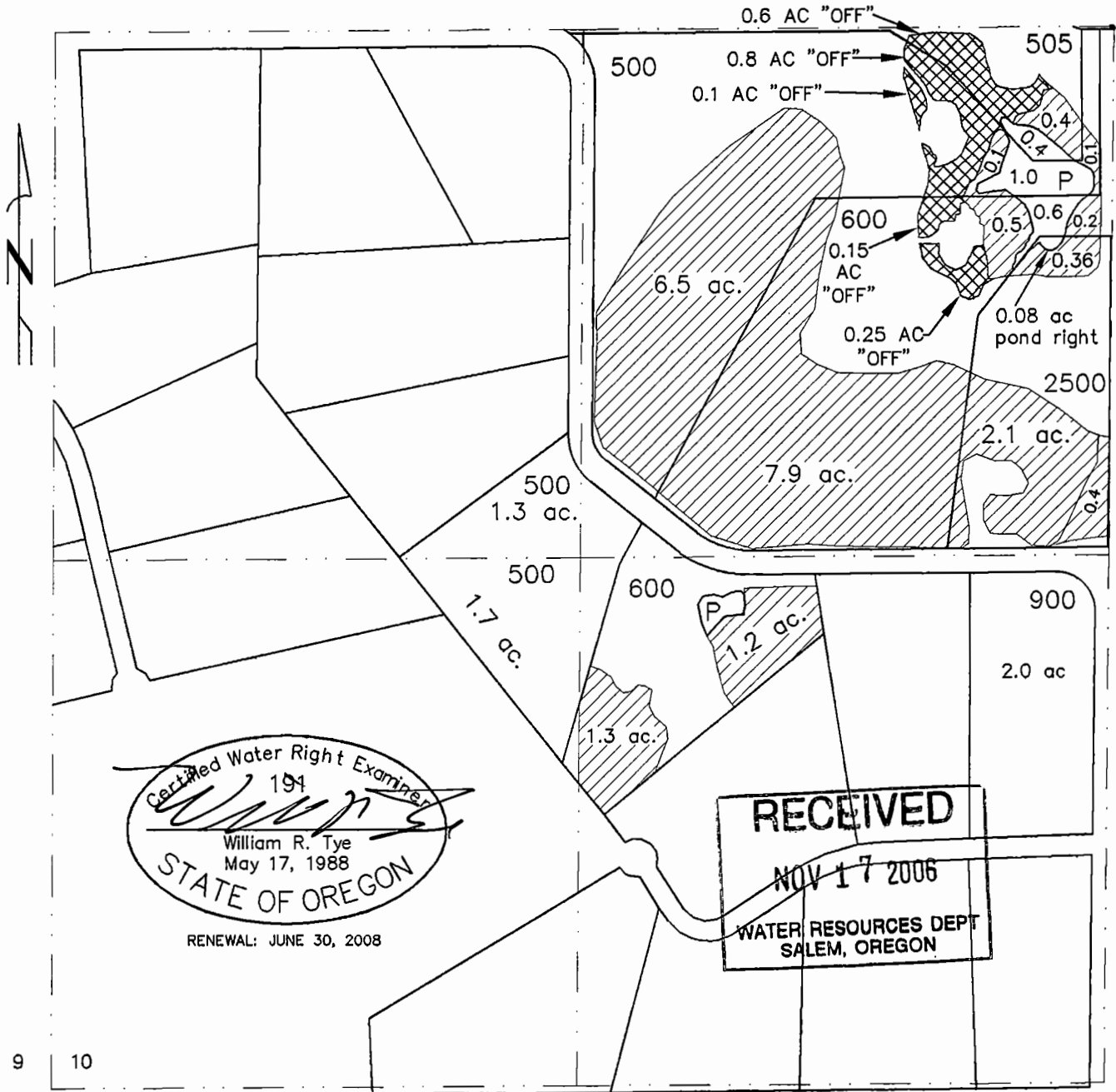

I, WILLIAM R. TYE, CERTIFIED WATER RIGHT EXAMINER IN THE STATE OF OREGON, HEREBY CERTIFY THE ABOVE APPLICATION MAP WAS PREPARED UNDER MY DIRECT SUPERVISION. THE PREPARATION OF THIS MAP IS FOR THE PURPOSE OF IDENTIFYING THE LOCATION OF THE WATER RIGHT ONLY AND HAS NO INTENT TO PROVIDE DIMENSIONS OR LOCATIONS OF PROPERTY OWNERSHIP LINES.

TYE ENGINEERING, INC.

725 NW HILL, BEND, OREGON 97701 (541) 389-6959

DATE: JUNE 29, 2006	SCALE: 1"=400'	DRAWN BY: P.A.T.	DWG #: canyons-July-2006
---------------------	----------------	------------------	--------------------------

WATERS RIGHTS APPLICATION MAP
MARTHA JACKSON, LLC
 LOCATED IN THE SW 1/4 OF SECTION 3, T. 14 S.,
 R. 13 E., W.M., DESCHUTES COUNTY, OREGON

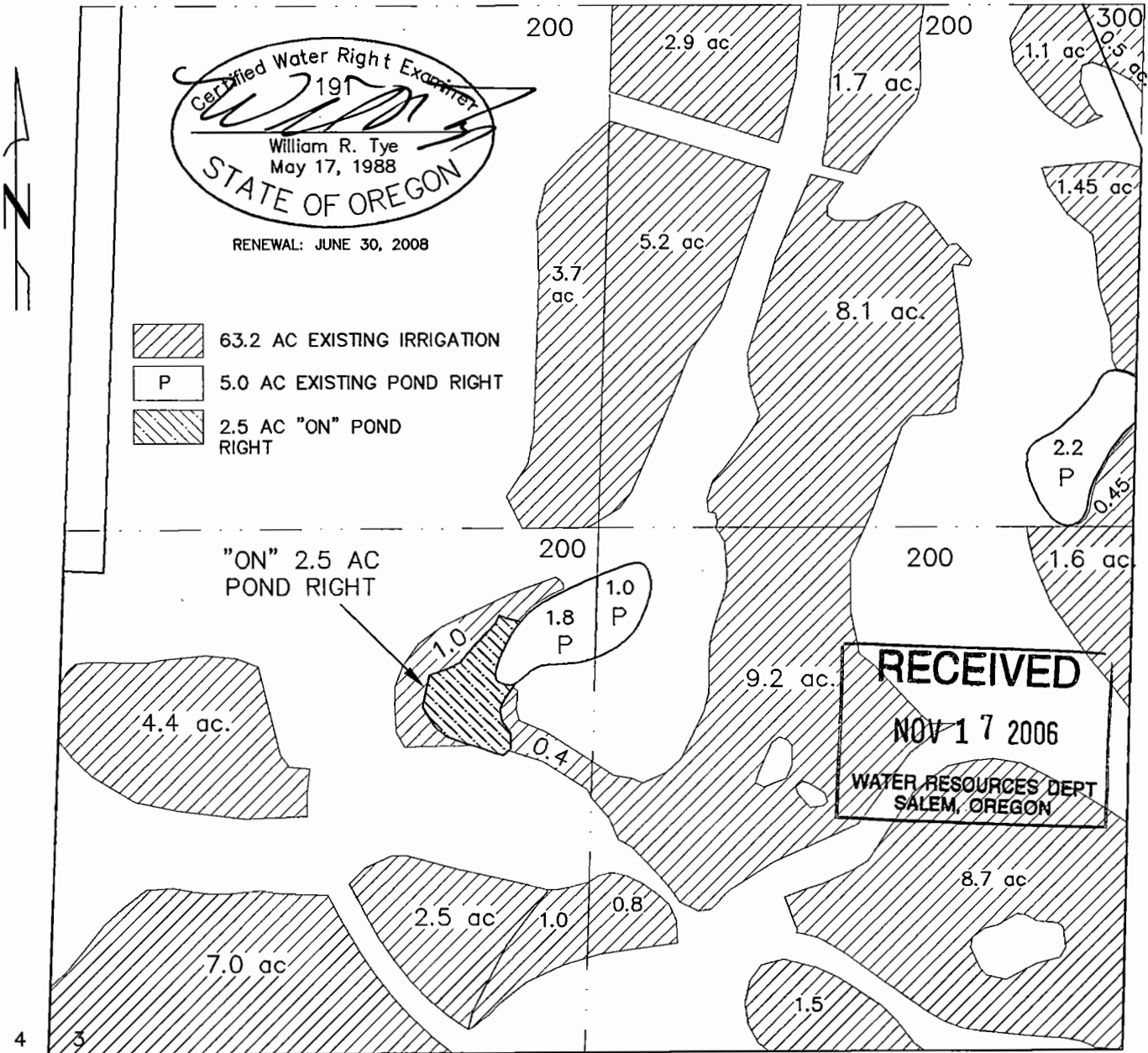



9 10 I, WILLIAM R. TYE, CERTIFIED WATER RIGHT EXAMINER IN THE STATE OF OREGON, HEREBY CERTIFY THE ABOVE APPLICATION MAP WAS PREPARED UNDER MY DIRECT SUPERVISION. THE PREPARATION OF THIS MAP IS FOR THE PURPOSE OF IDENTIFYING THE LOCATION OF THE WATER RIGHT ONLY AND HAS NO INTENT TO PROVIDE DIMENSIONS OR LOCATIONS OF PROPERTY OWNERSHIP LINES.

10267

TYE ENGINEERING, INC.

725 NW HILL, BEND, OREGON 97701 (541) 389-6959

**WATERS RIGHTS APPLICATION MAP
CANYONS LAND AND CATTLE CO., LLC
LOCATED IN THE SE 1/4 OF SECTION 3, T. 14 S.,
R. 13 E., W.M., DESCHUTES COUNTY, OREGON**

-  55.22 AC EXISTING IRRIGATION
-  9.3 AC EXISTING POND RIGHT
-  2.85 AC "OFF"

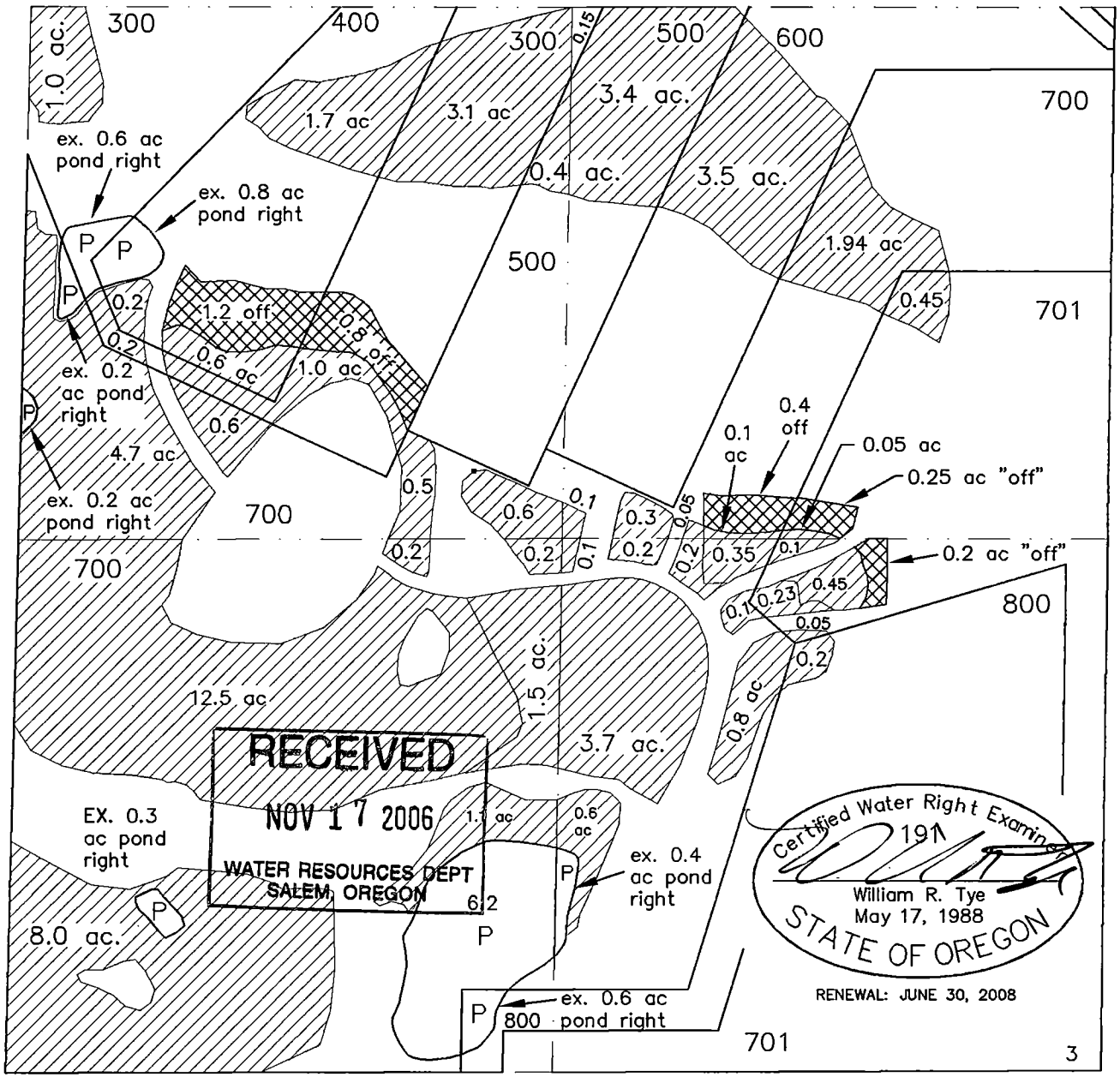

I, WILLIAM R. TYE, CERTIFIED WATER RIGHT EXAMINER IN THE STATE OF OREGON, HEREBY CERTIFY THE ABOVE APPLICATION MAP WAS PREPARED UNDER MY DIRECT SUPERVISION. THE PREPARATION OF THIS MAP IS FOR THE PURPOSE OF IDENTIFYING THE LOCATION OF THE WATER RIGHT ONLY AND HAS NO INTENT TO PROVIDE DIMENSIONS OR LOCATIONS OF PROPERTY OWNERSHIP LINES.

TYE ENGINEERING, INC.

1:02:67 725 NW HILL, BEND, OREGON 97701 (541) 389-6959

DATE: JUNE 29, 2006	SCALE: 1"=400'	DRAWN BY: P.A.T.	DWG #: canyons-July-2006
---------------------	----------------	------------------	--------------------------

**WATERS RIGHTS APPLICATION MAP
 CANYONS LAND AND CATTLE, CO., LLC
 LOCATED IN THE S 1/2 SE 1/4 OF SECTION 4, T.
 14 S., R. 13 E., W.M., DESCHUTES COUNTY, OREGON**

 35.7 AC EXISTING IRRIGATION

 1.0 AC "OFF"



RENEWAL: JUNE 30, 2008

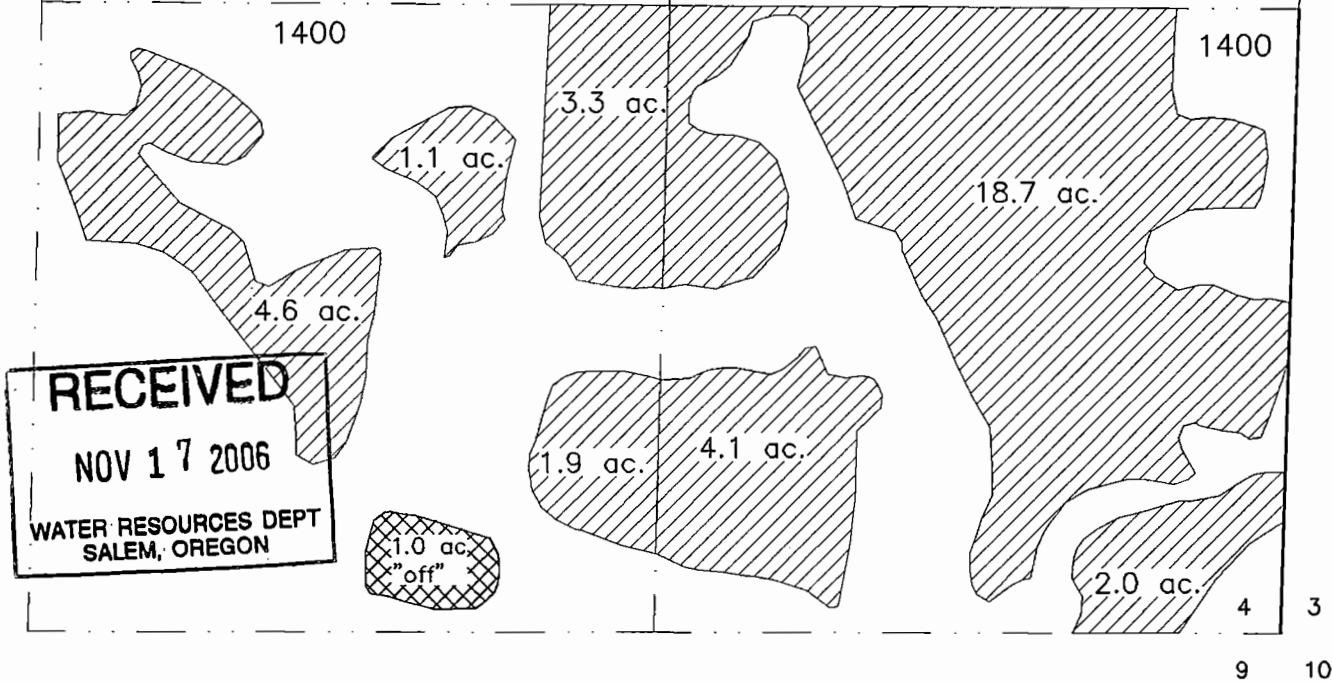



RECEIVED
 NOV 17 2006
 WATER RESOURCES DEPT
 SALEM, OREGON

I, WILLIAM R. TYE, CERTIFIED WATER RIGHT EXAMINER IN THE STATE OF OREGON, HEREBY CERTIFY THE ABOVE APPLICATION MAP WAS PREPARED UNDER MY DIRECT SUPERVISION. THE PREPARATION OF THIS MAP IS FOR THE PURPOSE OF IDENTIFYING THE LOCATION OF THE WATER RIGHT ONLY AND HAS NO INTENT TO PROVIDE DIMENSIONS OR LOCATIONS OF PROPERTY OWNERSHIP LINES.

TYE ENGINEERING, INC.

725 NW HILL, BEND, OREGON 97701 (541) 389-6959

10267

-  76.7 AC EXISTING IRRIGATION
-  3.58 AC EXISTING POND RIGHT
-  3.95 AC "OFF"

WATERS RIGHTS APPLICATION MAP
CANYONS LAND AND CATTLE COMPANY, LLC
 LOCATED IN THE NW 1/4 OF SECTION 10, T. 14 S.,
 R. 13 E., W.M., DESCHUTES COUNTY, OREGON

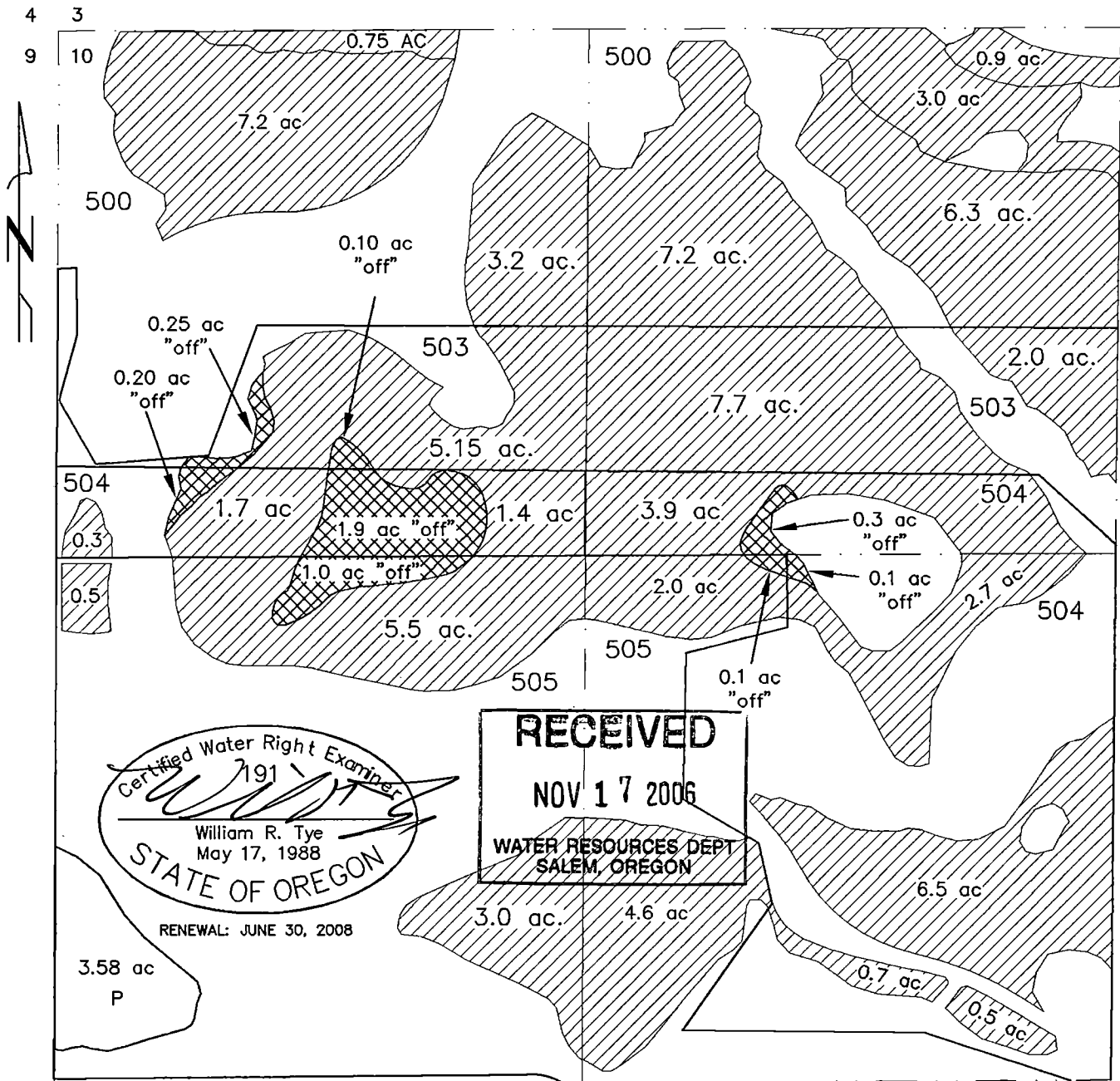

I, WILLIAM R. TYE, CERTIFIED WATER RIGHT EXAMINER IN THE STATE OF OREGON, HEREBY CERTIFY THE ABOVE APPLICATION MAP WAS PREPARED UNDER MY DIRECT SUPERVISION. THE PREPARATION OF THIS MAP IS FOR THE PURPOSE OF IDENTIFYING THE LOCATION OF THE WATER RIGHT ONLY AND HAS NO INTENT TO PROVIDE DIMENSIONS OR LOCATIONS OF PROPERTY OWNERSHIP LINES.

TYE ENGINEERING, INC.

10267

725 NW HILL, BEND, OREGON 97701 (541) 389-6959

DATE: JUNE 29, 2006	SCALE: 1"=400'	DRAWN BY: P.A.T.	DWG #: canyons-July-2006
---------------------	----------------	------------------	--------------------------