

Richard Stephens Transfer "FROM" Map

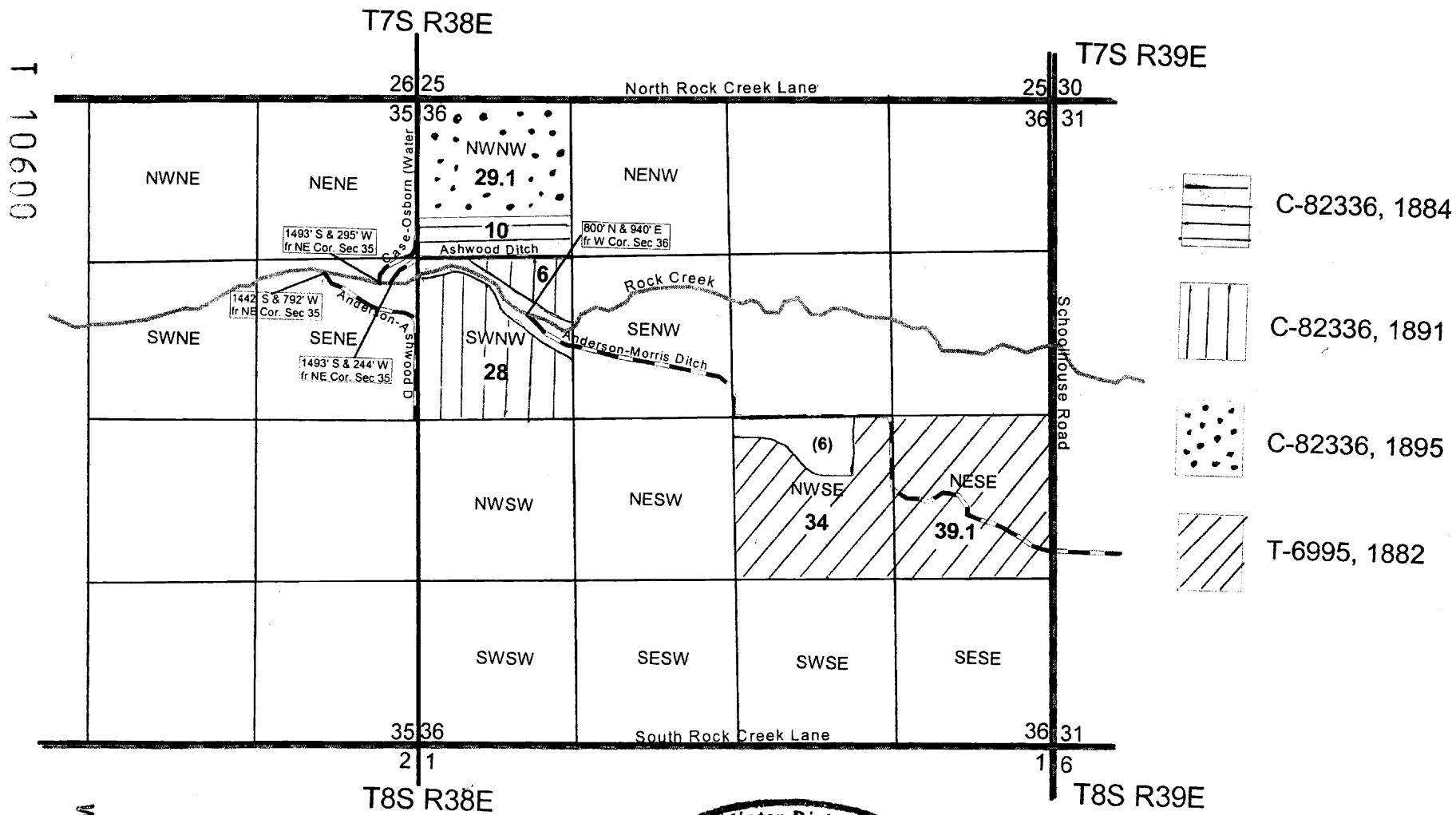

T 10600

RECEIVED
 APR 14 2008
 WATER RESOURCES DEPT
 SALEM, OREGON

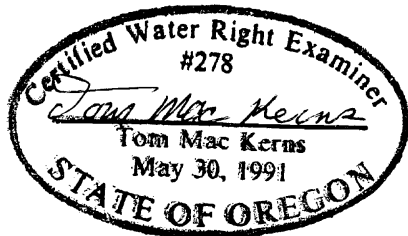



1320 0 1320 Feet

Richard Stephens Transfer "TO" Map

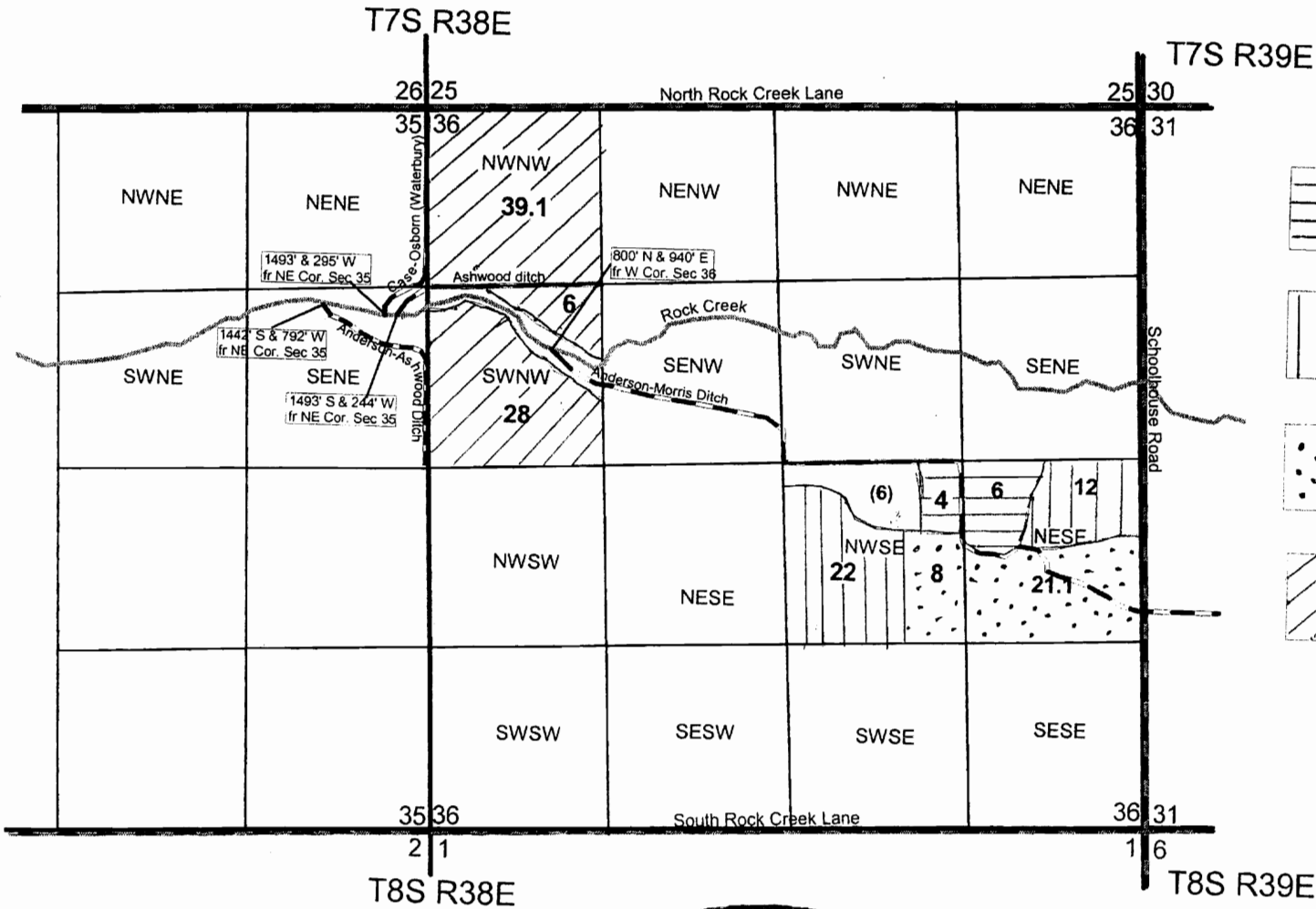
T 10600

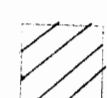

-  C-82336, 1884
-  C-82336, 1891
-  C-82336, 1895
-  T-6995, 1882

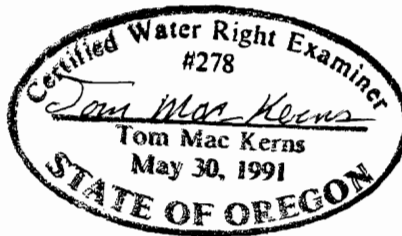



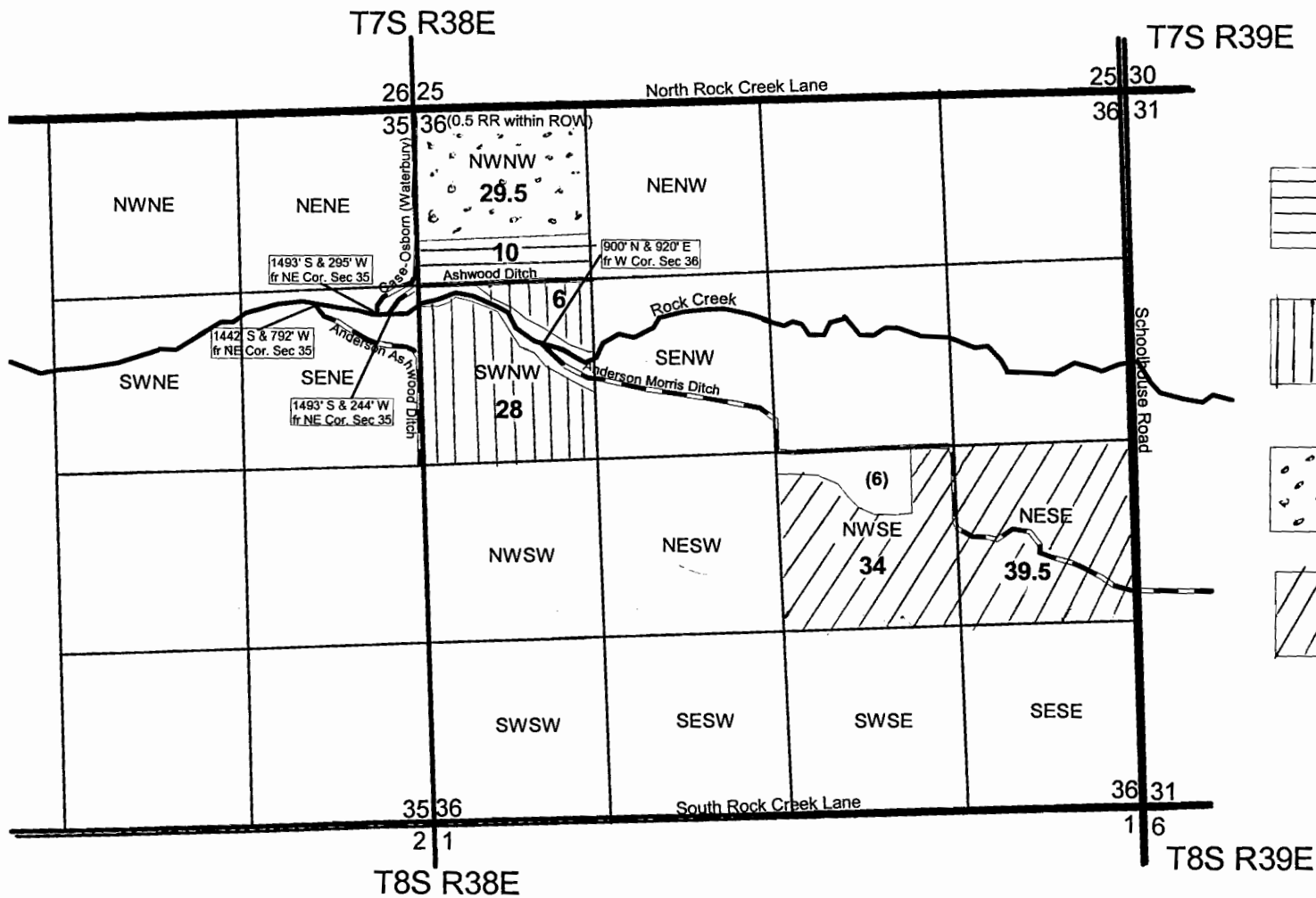

RECEIVED
 APR 14 2008
 WATER RESOURCES DEPT
 SALEM, OREGON

Richard Stephens Transfer "FROM" Map

This map is for the purpose of identifying the water right location only and is not intended to provide legal dimensions or location of property ownership lines.



-  C-82336, 4/26/1884
Ashwood Ditch
10 acres
-  C-82336, 4/1891
Anderson Ashwood Ditch
34 acres
-  C-82336, 5/1895
Case-Osborn Ditch
29.5 acres
-  C-84857, 1882
Anderson Morris Ditch
73.5 acres

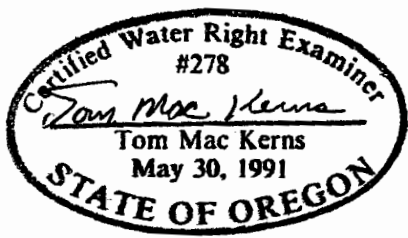

RECEIVED
FEB 25 2009
WATER RESOURCE DEPT.
EASTERN REGION

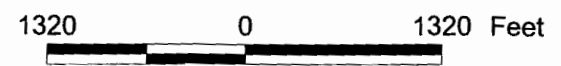

JEM: 2/25/09
Map Revision #1