

T.6S. R.3W. Sec. 1, 2, 11 & 12, W.M.

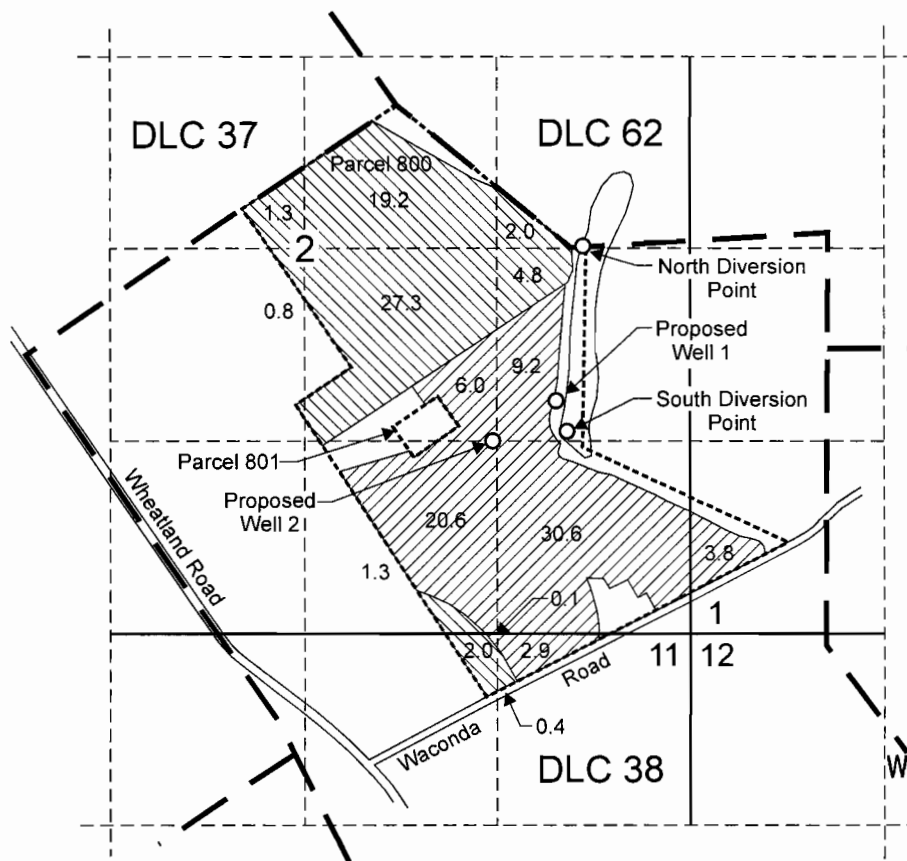



RECEIVED

JAN 08 2009

WATER RESOURCES DEPT
SALEM, OREGON

Proposed Well 1 is located 2,030 feet south and 1,100 feet east from the most northerly corner, DLC 38.
 Proposed Well 2 is located 2,310 feet south and 660 feet east from the most northerly corner, DLC 38.
 North Diversion Point is located 970 feet south and 1,280 feet east from the most northerly corner, DLC 38.
 South Diversion Point is located 2,240 feet south and 1,170 feet east from the most northerly corner, DLC 38.

-  Portion of Certificate 47856 (59.1 Acres) affected by this transfer.
-  Area under Certificate 61435 (73.2 Acres) affected by this transfer.
-  Tax lot boundary

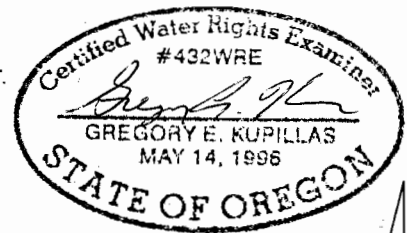

EXPIRATION DATE: 6/20/09

Scale: 1" = 1,320'



This map was prepared for the purpose of identifying the location of a water right only and is not intended to provide legal dimensions or location of property ownership lines.

Water Right Transfer Application Map

Arrowhead Farms, Inc.; Westwood Farms, Inc.;
 And Echo Ridge Farms, Inc.
 Tax Map 6 3W 02, Parcels 800 and 801

Pacific Hydro-Geology Inc.

Rvsd 10/2008

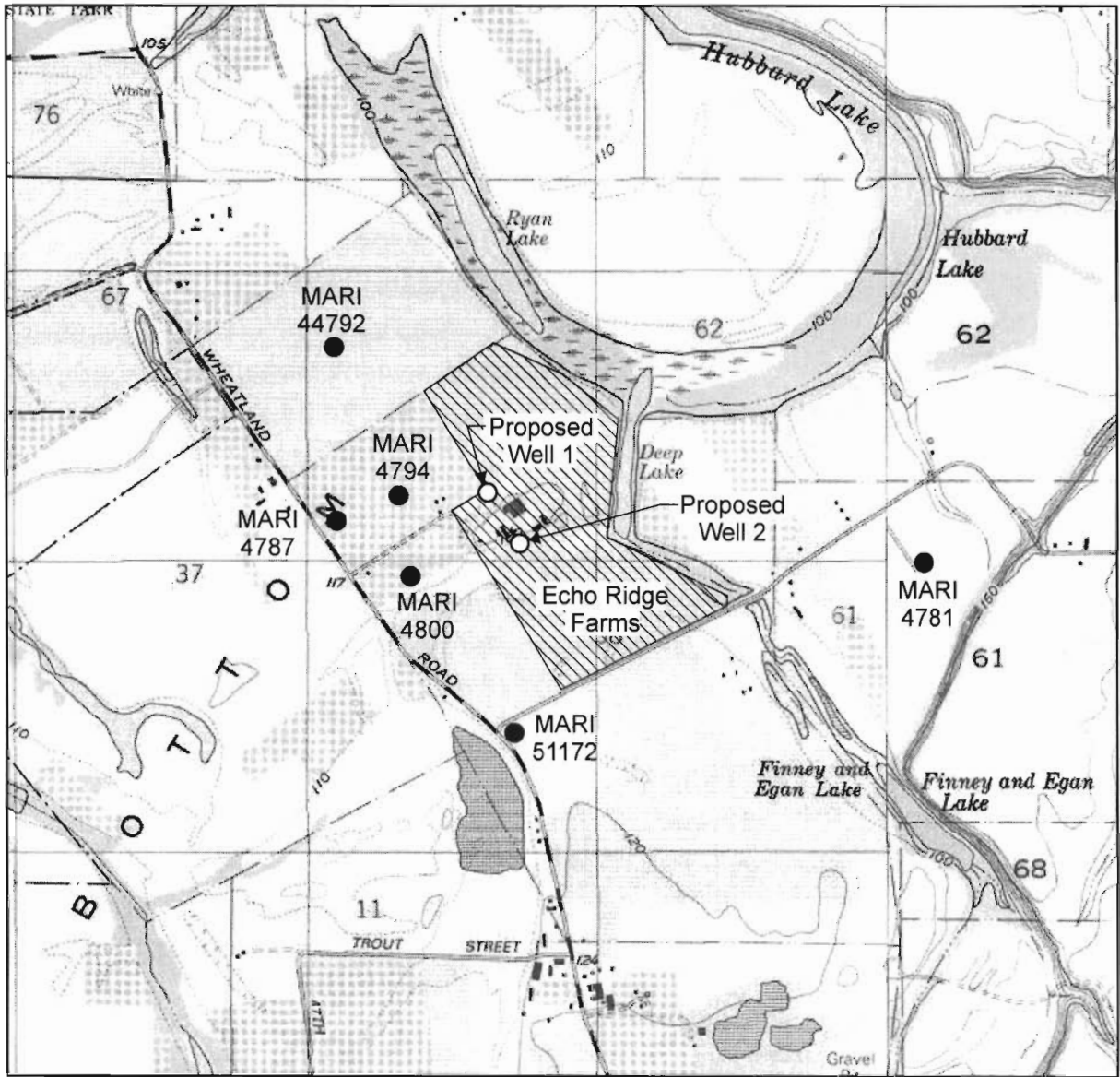

Scale: 1:24000



RECEIVED

APR 25 2008

WATER RESOURCES DEPT
SALEM, OREGON



Source: Seamless USGS Topographic Maps
on CD-ROM, National Geographic

Figure A-1. Well Locations

Arrowhead Farms, Inc.; Westwood Farms, Inc.;
and Echo Ridge Farms, Inc.
Stream Depletion Modeling
Surface to Ground Water Transfer Application

Pacific Hydro-Geology Inc.

4/2008

ColemanFigA-1.cdr

T 10602