

T.33S.,R.2E.,W.M.

SHEET 1 OF 2

Jackson County, Oregon

Tax Lot No. 332E 9-502

ROGUE RIVER BASIN

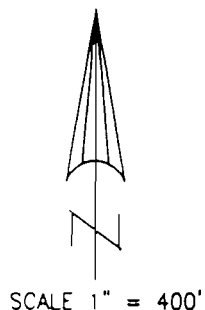

SCALE 1" = 400'

3.0
= PORTION OF
PRIMARY IRR.
CERT. 13972, APL.
7371 BEING
TRANSFERRED (THE
2.0 AC.
SUPPLEMENTAL IRR.
MENTIONED ON
CERT. 13972
LOCATED IN THE
SW 1/4 SEC. 9
COULD NOT BE
LOCATED)

12.1
= PORTION OF
PRIMARY IRR.
CERT. 13972,
APL. 7371 NO
CHANGE

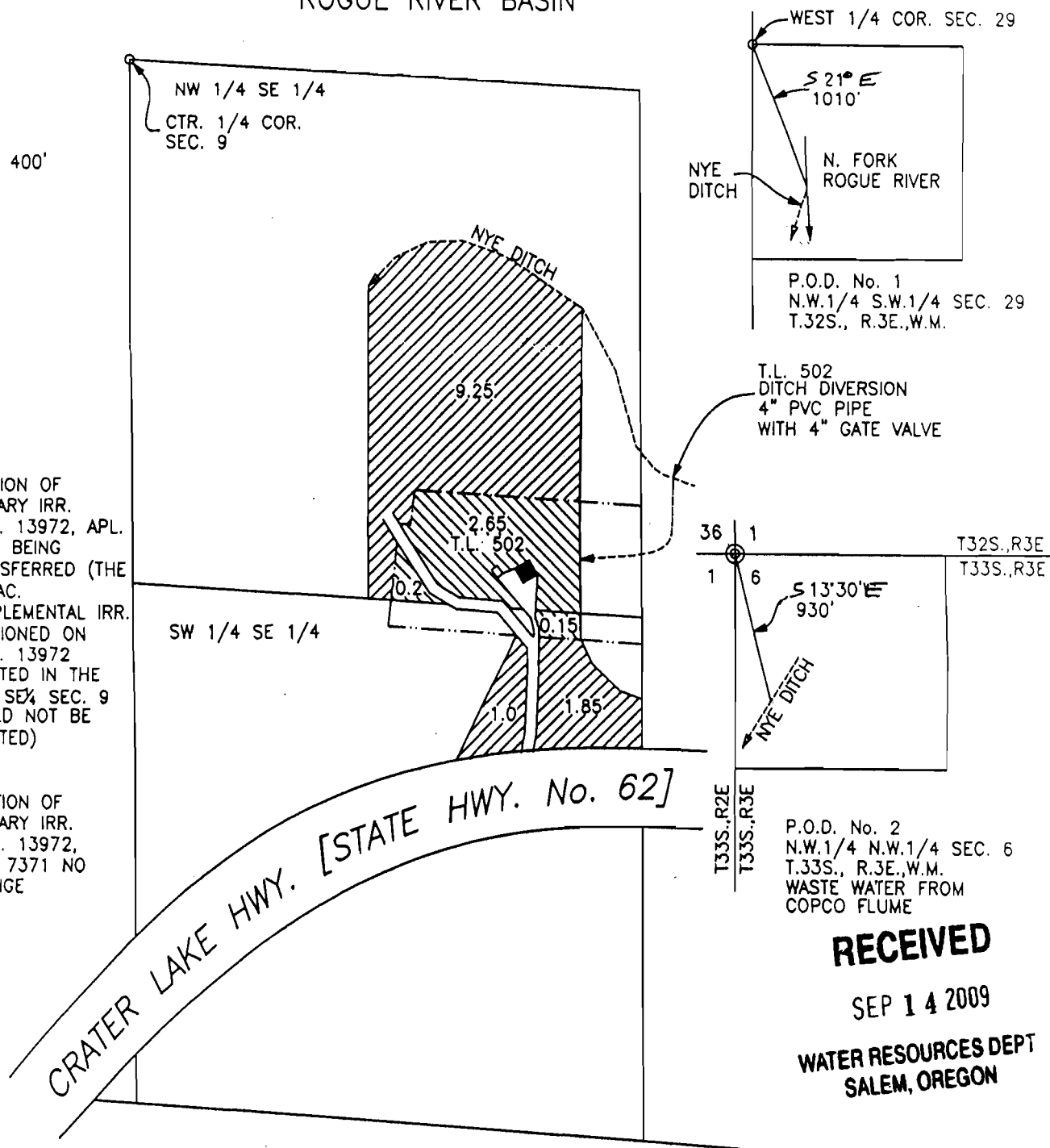

P.O.D. No. 2
N.W.1/4 N.W.1/4 SEC. 6
T.33S., R.3E.,W.M.
WASTE WATER FROM
COPCO FLUME

RECEIVED

SEP 14 2009

WATER RESOURCES DEPT
SALEM, OREGON

MAP TO ACCOMPANY AN APPLICATION FOR A
WATER RIGHT TRANSFER CHANGE IN PLACE OF
USE (THE "FROM" PROPERTY)

NOTE: MAP PREPARED FOR
WATER RIGHT PURPOSES ONLY,
NOT FOR PROPERTY BOUNDARY
LOCATIONS.

FOR: BRIAN AND RENELDA BOOTHBY
759 MATHER ROAD
PROSPECT, OREGON 97536

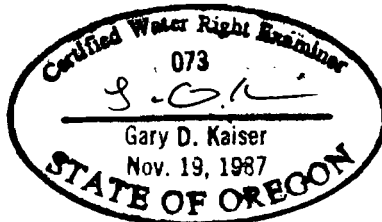

PREPARED BY:
GARY D. KAISER
19440 HWY. 62
EAGLE POINT, OR. 97524

July 7, 2008

REvised 9-11-09 GPK