

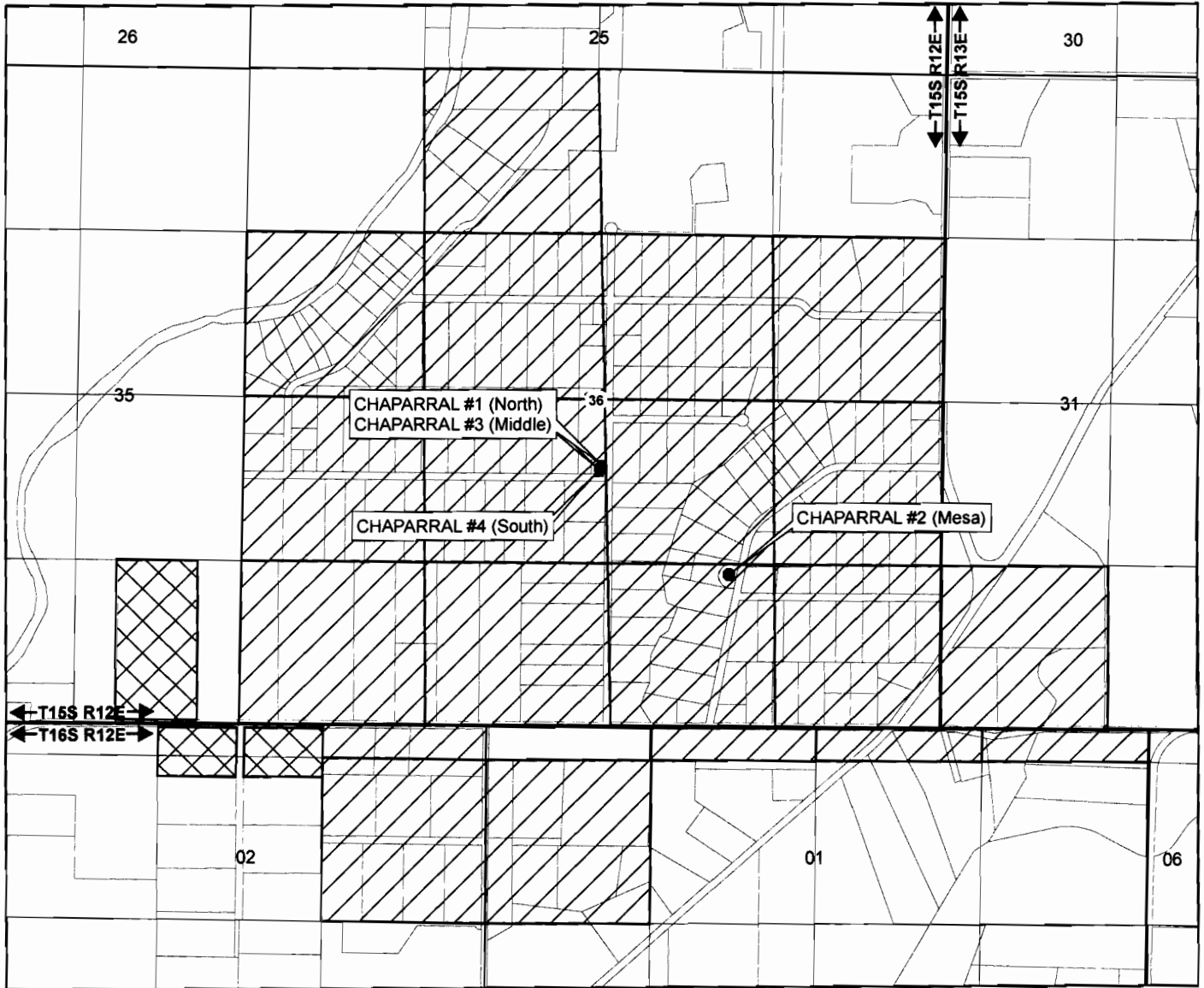

AVION WATER CO, INC.

CHANGED AND PROPOSED ADDITIONAL POINTS OF APPROPRIATION
AND PROPOSED PLACE OF USE
PERMIT G-10019
APPLICATION G-10466

1 of 1



1 inch equals 1,320 feet

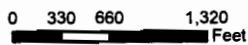

DRAWN BY: TANNER LEMMON
AVION WATER GIS DEPARTMENT
DECEMBER, 2008

DISCLAIMER:
This map was prepared for the purpose
of identifying the location of water rights
only and is not intended to provide legal
dimensions or locations of property
ownership lines.

- CHANGED POINTS OF APPROPRIATION
- ▲ ADDITIONAL POINT OF APPROPRIATION
- ▨ AUTHORIZED PLACE OF USE
- ▩ ADDITIONAL TAXLOTS(2)

CHANGED

CHAPARRAL WELL #1 (North) -
NE 1/4, SW 1/4 of
Section 36, T 15 S, R 12 E,
WM - 2097' North and 68'
West from the S 1/4 corner of
Section 36
151236C000101

CHAPARRAL WELL #2 (Mesa)-
SW 1/4, SE 1/4 of
Section 36, T 15 S, R 12 E,
WM - 1230' North and 955'
East from the S 1/4 corner of
Section 36
151236D001202

CHAPARRAL WELL #3 (Middle) -
NE 1/4, SW 1/4 of
Section 36, T 15 S, R 12 E,
WM - 2089' North and 78'
West from the S 1/4 corner of
Section 36
151236C000101

T 10828

WELL DESCRIPTIONS

ADDITIONAL

CHAPARRAL WELL #4 (South)-
NE 1/4, SW 1/4 of
Section 36, T 15 S, R 12 E,
WM - 2072' North and 90'
West from the S 1/4 corner of
Section 36
151236C000101

RECEIVED

MAR 18 2009

WATER RESOURCES DEPT
SALEM, OREGON