

**LEGEND**

POINT OF DIVERSION	
IRRIGATION PIPE (2")	
PROPERTY LINE	
SECTION LINE	
1/4 1/4 LINE	
EXISTING RESERVOIR (NO.)	
TRANSFER FROM LANDS	
TRANSFER TO LANDS	

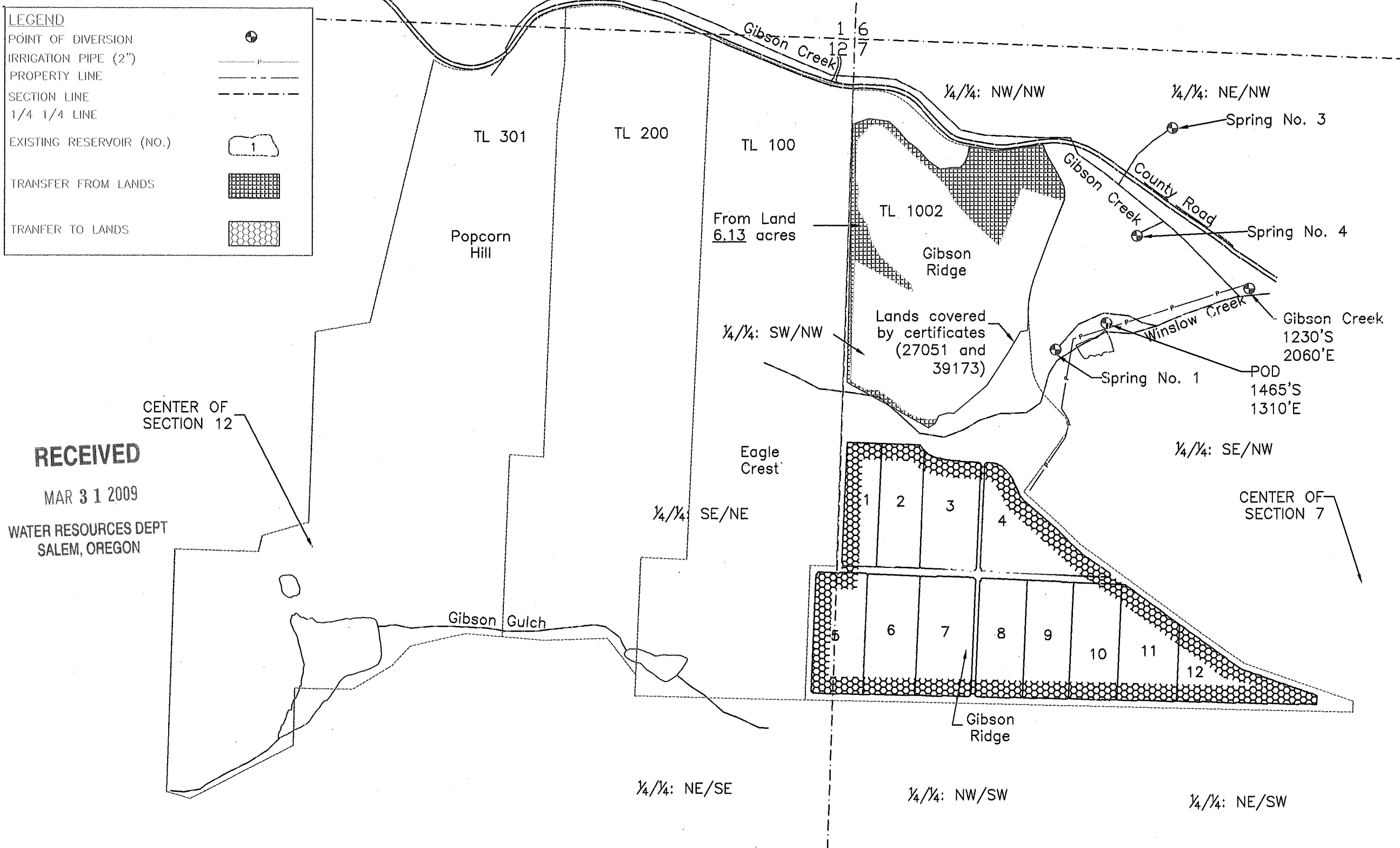
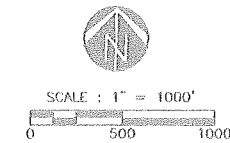

**RECEIVED**  
MAR 31 2009  
WATER RESOURCES DEPT  
SALEM, OREGON

- NOTES:**
1. Point of Diversion (POD) coordinates are identified from the NW corner Section 7 / NE corner Section 12 to the POD.
  2. This map is for the purpose of identifying the location of the water right only and is not intended to provide legal dimensions or locations of property lines.
  3. Reservoir locations represent water surface areas and do not include the reservoir embankments.
  4. See Sheet 1 for vineyard vine and row spacing detail. Rows are consistently spaced at 5.25' and vine spacing is 3.25'. Wetted area per vine is 2.58 sq.ft.

PLACE OF USE BY 1/4, 1/4 SECTION FOR  
POU TRANSFER ON GIBSON RIDGE VINEYARD, LLC

SEC	1/4.1/4	PRIMARY		FROM LAND	TO VINES	TO LANDS
		CERT 27051	SUPPLEMENTAL CERT 39173			
12	NE/SE	0.00	0.00	0.00	3863	0.23
7	NW/NW	18.46	18.46	5.64	0	0
	SW/NW	9.17	9.17	0.49	34070	2.03
	SE/NW	0.00	0.00	0.00	95	0.01
	NE/SW	0.00	0.00	0.00	19856	1.18
	NW/SW	0.00	0.00	0.00	45484	2.68
	SW/SW	0.00	0.00	0.00	0	0
	SE/SW	0.00	0.00	0.00	0	0
<b>TOTAL</b>		<b>27.63</b>	<b>27.63</b>	<b>6.13</b>	<b>103368</b>	<b>6.13</b>

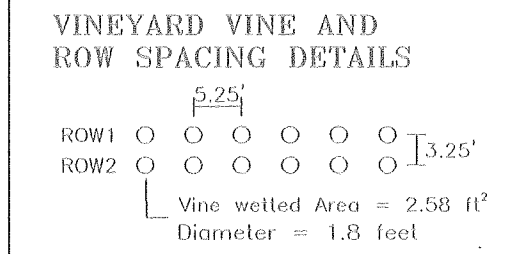

SHEET 1 OF 4

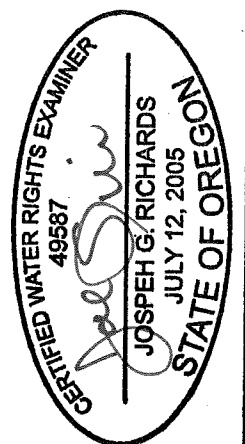

EXPIRATION DATE: 12/13/10

**PERMANENT WATER  
RIGHT TRANSFER  
APPLICATION MAP**  
IN THE NAME OF:  
GIBSON RIDGE VINEYARD, LLC  
APRIL 2008  
T.7S, R.3W, W.M. SECTION 7  
AND T.7S, R.4W, W.M.  
SECTION 12