

Attachment 2
Transfer Maps
Application for a Water Right Transfer
Cert. 29301, 45237, 50465, and 65701

T 11127

RECEIVED

SEP - 1 2010

WATER RESOURCES DEPT
SALEM, OREGON

Ted Ressler

From: Dorothy Pedersen [pedersdi@wrdd.state.or.us]
Sent: Friday, July 23, 2010 12:30 PM
To: Ted Ressler
Subject: RE: Use of final proof survey maps for showing "From" lands as part of a transfer

Ted,

As long as the transfer includes the entirety of the four rights and changes the POAs and places of use, you may substitute the Final Proof maps for the transfer "from" maps.

You will need to clarify whether there are actually just two wells currently authorized or more than two. There are actually 5 sets of coordinates stated in the certificates. In some cases the points are within 2-5 feet from each other, but in other cases they are 20-25 feet distant.

Dorothy

From: Ted Ressler [mailto:TReessler@gsiws.com]
Sent: Wednesday, July 21, 2010 2:41 PM
To: dorothy.i.pedersen@state.or.us
Subject: Use of final proof survey maps for showing "From" lands as part of a transfer

Some files have been sent to you via the **YouSendIt** File Delivery Service.

Download the file - [Cert65701_map.pdf](#); [Cert29301_map.pdf](#); [Cert45237_map.pdf](#);
[Cert50465_map.pdf](#)

Your files will expire after 14 days.

Dorothy

I'm working on a transfer application that will involve the entire portion of 4 irrigation and nursery water rights. The transfer will be proposing to change both the points of appropriation, the place of use, and the type of use. I've attached the final proof survey maps on-file for these water rights.

Feel free to give me a call with questions.

Thank you.
Ted

Theodore R. Ressler, RG, CWRE
Project Hydrogeologist

GSI Water Solutions, Inc.
55 SW Yamhill Street, Suite 400

T 11127

RECEIVED

SEP - 1 2010

WATER RESOURCES DEPT
SALEM, OREGON

T.2S.R. 2E.W.M.

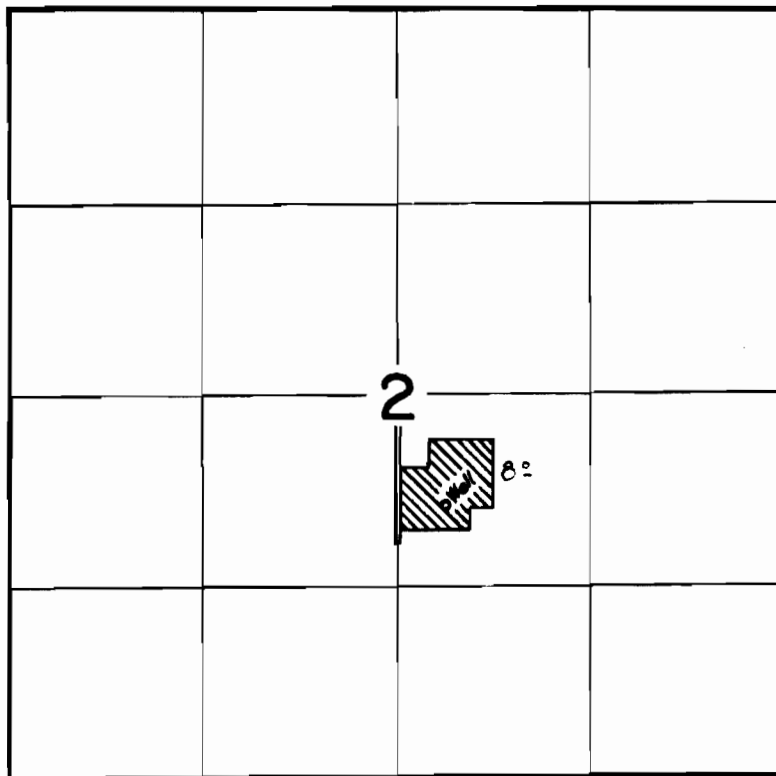

T 11127

FINAL PROOF SURVEY
UNDER

Application No. **G-1262**. Permit No. **G-1084**.
IN NAME OF

GLENN N. SAVAGE, DBA RHODODENDRON NURSERY

Surveyed April 5, 1961, by

[Signature]

RECEIVED

SEP - 1 2010

WATER RESOURCES DEPT
SALEM, OREGON

T.2S.R. 2 E.W.M.

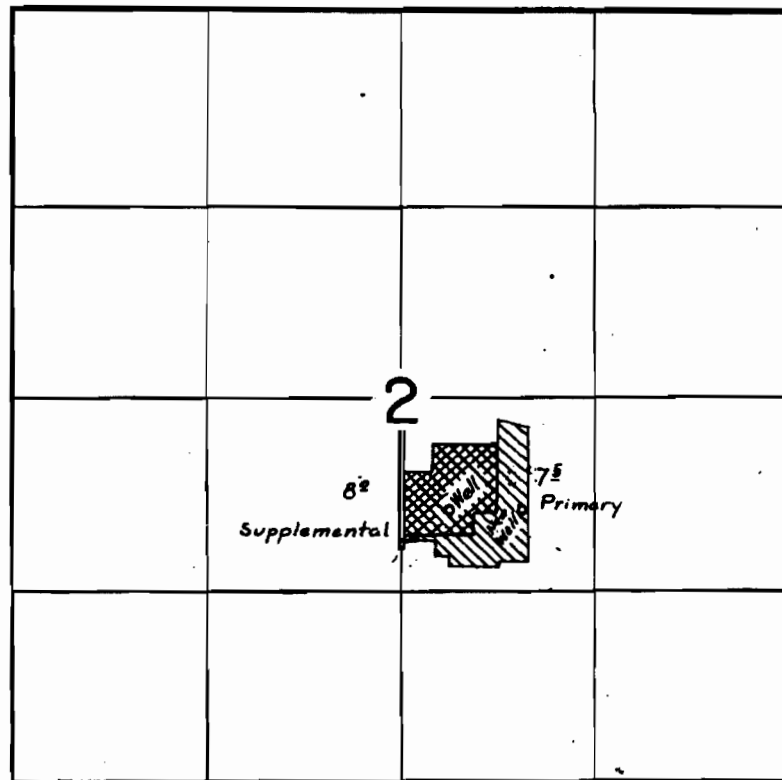

 Supplemental

 Primary

T 11127

FINAL PROOF SURVEY

UNDER

Application No. G-5593

Permit No. G 5448

Application No. G-1262. Permit No. G-1084.
IN NAME OF

RECEIVED

GLENN N. SAVAGE, DBA RHODODENDRON NURSERY SEP - 1 2010

Surveyed April 5, 1961, by *L. Jackson*

WATER RESOURCES DEPT
SALEM, OREGON

T.2S. R.2E. W.M.

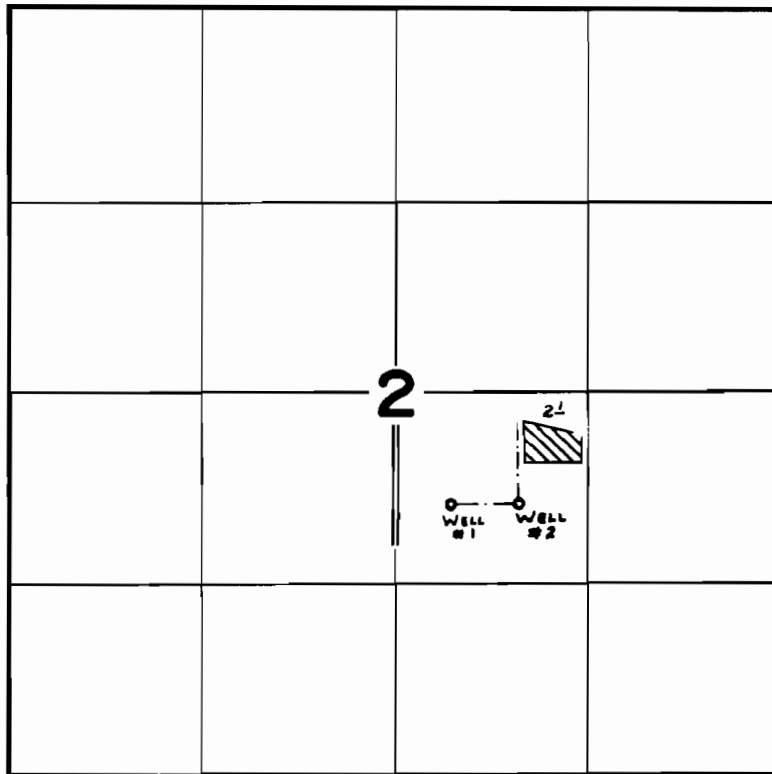

WELLS LOC : #1- 770' S. 1 370' E. } BOTH fr. C. & COR. SEC. 2.
#2- 770' S. 1 850' E. }

FINAL PROOF SURVEY
UNDER

T 11127

Application No. G-7413 Permit No. G-6917
IN NAME OF

RHODODENDRON NURSERY INC.

Surveyed OCT. 3 1978, by C. L. HUGHES.

RECEIVED

SEP - 1 2010

WATER RESOURCES DEPT
SALEM, OREGON

**NW 1/4 OF SE 1/4
SECTION 2
T.2 S R.2 E. W.M.**

ACREAGE BY USE:

CONTAINERIZED
NURSERY STOCK
= 13.35 AC.

GREENHOUSES
= 2.8 AC.

RELATED NURSERY
= 0.40 AC.

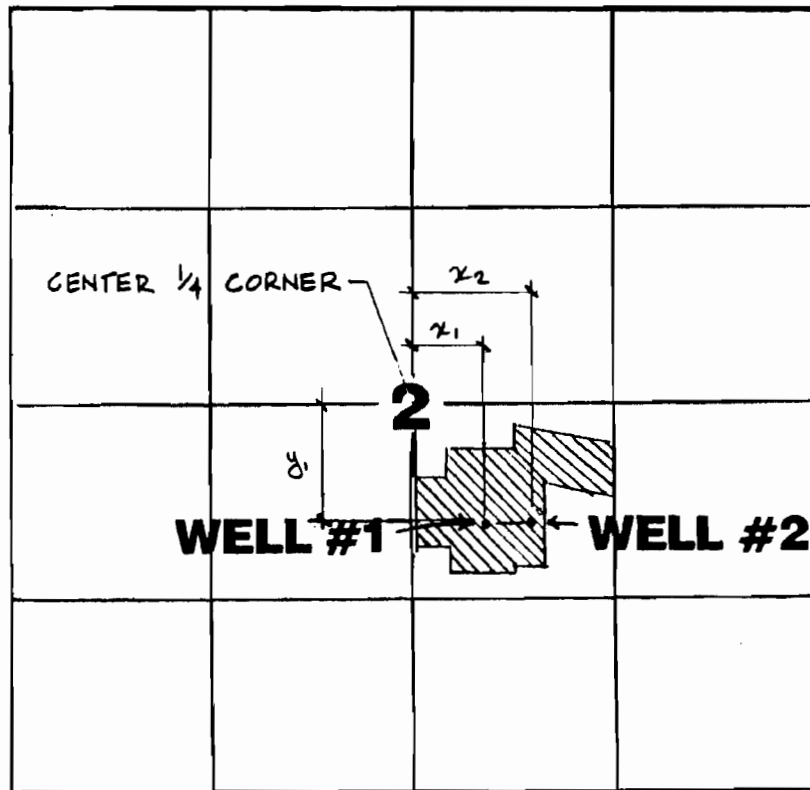

$$\begin{aligned} y_1 &= 776.96' \\ x_1 &= 372.00' \\ x_2 &= 847.00' \end{aligned}$$

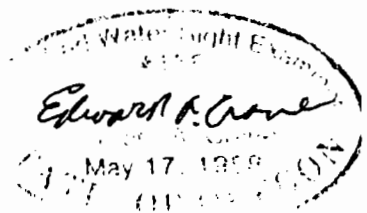
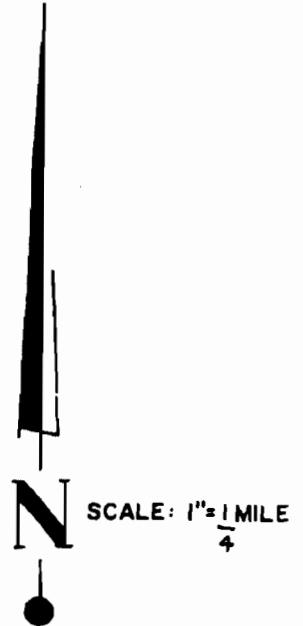

FINAL PROOF SURVEY
UNDER

T 11127

APPLICATION NO. G11739. PERMIT NO. G-10868
IN THE NAME OF

RHODODENDRON NURSERY INC
STEPHEN G. SAVAGE, PRESIDENT

SURVEYED JUNE 14, 1989 BY *Edward P. Crane*

RECEIVED

SEP - 1 2010

WATER RESOURCES DE
SALEM, OREGON

POA Detail Map
for Water Right Transfer of
Certificates 29301, 45237, 50465, 67501
Townships 1 & 2 South, Ranges 2, & 3 East (W.M.)

11127

LEGEND

- ▲ Proposed Point of Appropriation (POA)
- Current Point of Appropriation (POA)
- + taxlots
- ~ Freeways and Highways
- ~ Major Roads
- ~ Watercourses
- ~ Waterbodies

CURRENT POA DESCRIPTIONS:

Well 1: Located 776.96 feet South and 372 feet East from the Center of Section 2, Township 2 South, Range 2 East (W.M.)
Well 2: Located 776.96 feet South and 847 feet East from the Center of Section 2, Township 2 South, Range 2 East (W.M.)

PROPOSED POA DESCRIPTIONS:

Gramor: Located 1430 feet South and 175 feet West from the NE corner of Section 1, Township 2 South, Range 2 East (W.M.)
Well 5: Located 2220 feet South and 2930 feet West from the NE corner of Section 6, Township 2 South, Range 3 East (W.M.)
Well 5A: Located 2290 feet South and 2463 feet East from the NW corner of Section 6, Township 2 South, Range 3 East (W.M.)
New Well 1: Located 2468 feet North and 850 feet West from the SE corner of Section 1, Township 2 South, Range 2 East (W.M.)
New Well 2: Located 1880 feet North and 1936 feet West from the SE corner of Section 1, Township 2 South, Range 2 East (W.M.)

DISCLAIMER:

This map was prepared for the purpose of identifying the location of a water right only and it is not intended to provide legal dimensions or location of property ownership lines.

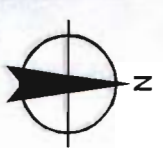

0 440 880 1,320
1 inch equals 1320 feet

MAP NOTES:

Projection: Oregon State Plane North Zone
Datum: North American Datum of 1983
Date: August 30, 2010
Data Sources: OWRD, METRO RLIS, Oregon Geospatial Data Clearinghouse

Certified Water Rights Examiner
#78185WRE
Theodore R. Ressler
Theodore R. Ressler
June 29, 2007
STATE OF OREGON
EXPIRES: 12-31-2010

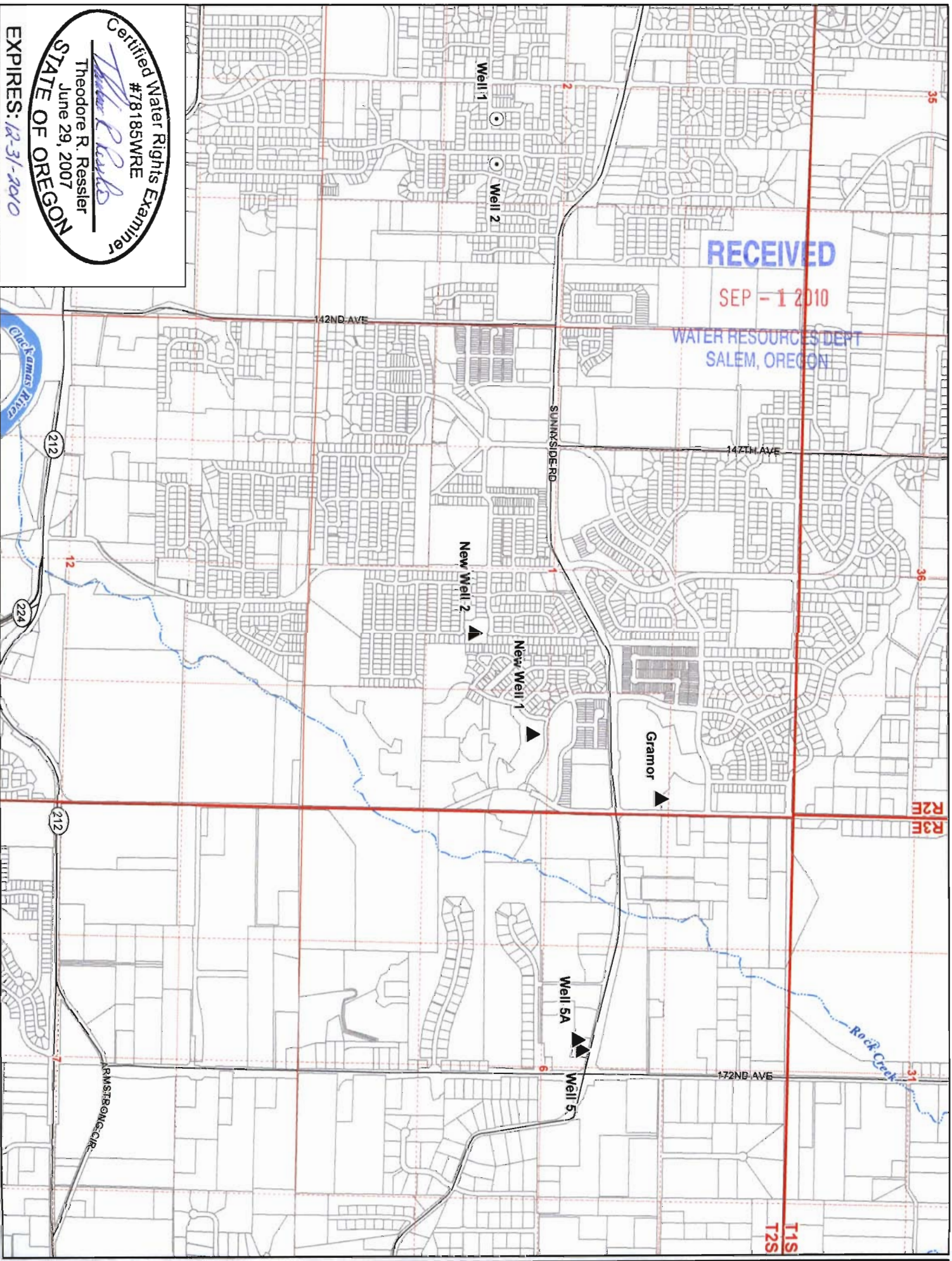

Application Map for a Water Right Transfer Certificate 29301 (Permit G-1084)

Townships 1 & 2 South, Ranges 2, & 3 East (W.M.)

LEGEND

- ▲ Proposed Point of Appropriation (POA)
- Current Point of Appropriation (POA)
- ▨ Proposed Place of Use (POU)
- ▨ Freeways and Highways
- ▨ Major Roads
- ▨ Railroads
- ▨ Watercourses
- ▨ Waterbodies

CURRENT POA DESCRIPTIONS:

Well 1: Located 776.96 feet South and 372 feet East from the Center of Section 2, Township 2 South, Range 2 East (W.M.)

PROPOSED POA DESCRIPTIONS:

Gramor: Located 1430 feet South and 175 feet West from the NE corner of Section 1, Township 2 South, Range 2 East (W.M.)
Well 5: Located 2220 feet South and 2950 feet West from the NE corner of Section 6, Township 2 South, Range 3 East (W.M.)
Well 5A: Located 2290 feet South and 2463 feet East from the NW corner of Section 6, Township 2 South, Range 3 East (W.M.)
New Well 1: Located 2468 feet North and 850 feet West from the SE corner of Section 1, Township 2 South, Range 2 East (W.M.)
New Well 2: Located 1880 feet North and 1936 feet West from the SE corner of Section 1, Township 2 South, Range 2 East (W.M.)

CURRENT POU:
See Final Proof Map on file

DISCLAIMER:
This map was prepared for the purpose of identifying the location of a water right only and it is not intended to provide legal dimensions or location of property ownership lines.

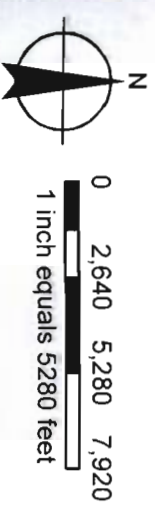

MAP NOTES:
Projection: Oregon State Plane North Zone
Datum: North American Datum of 1983
Date: August 30, 2010
Data Sources: OWRD, METRO RLIS,
Oregon Geospatial Data Clearinghouse

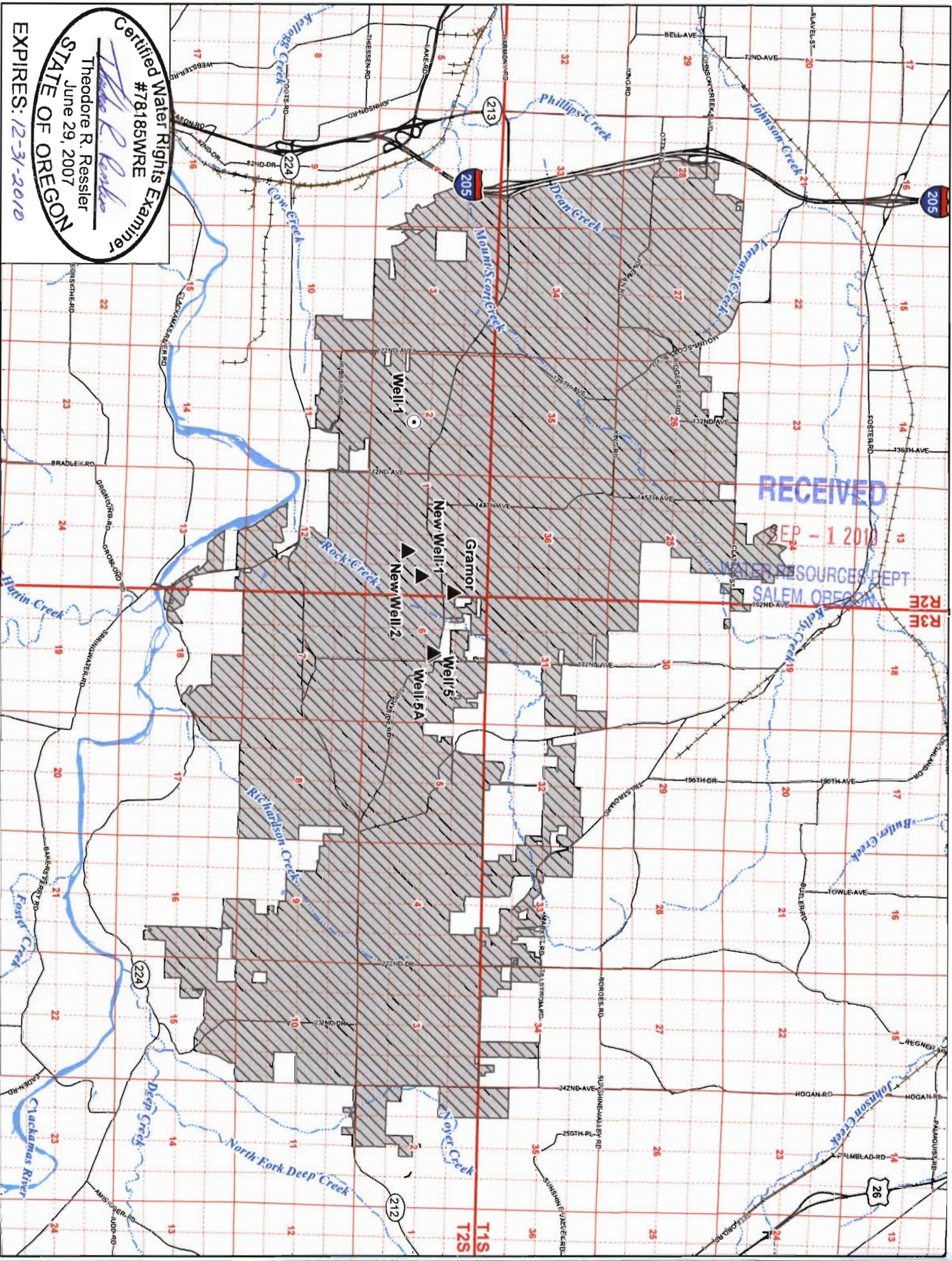

RECEIVED
SEP - 1 2010
WATER RESOURCES DEPT
CLATSOP CO., OREGON

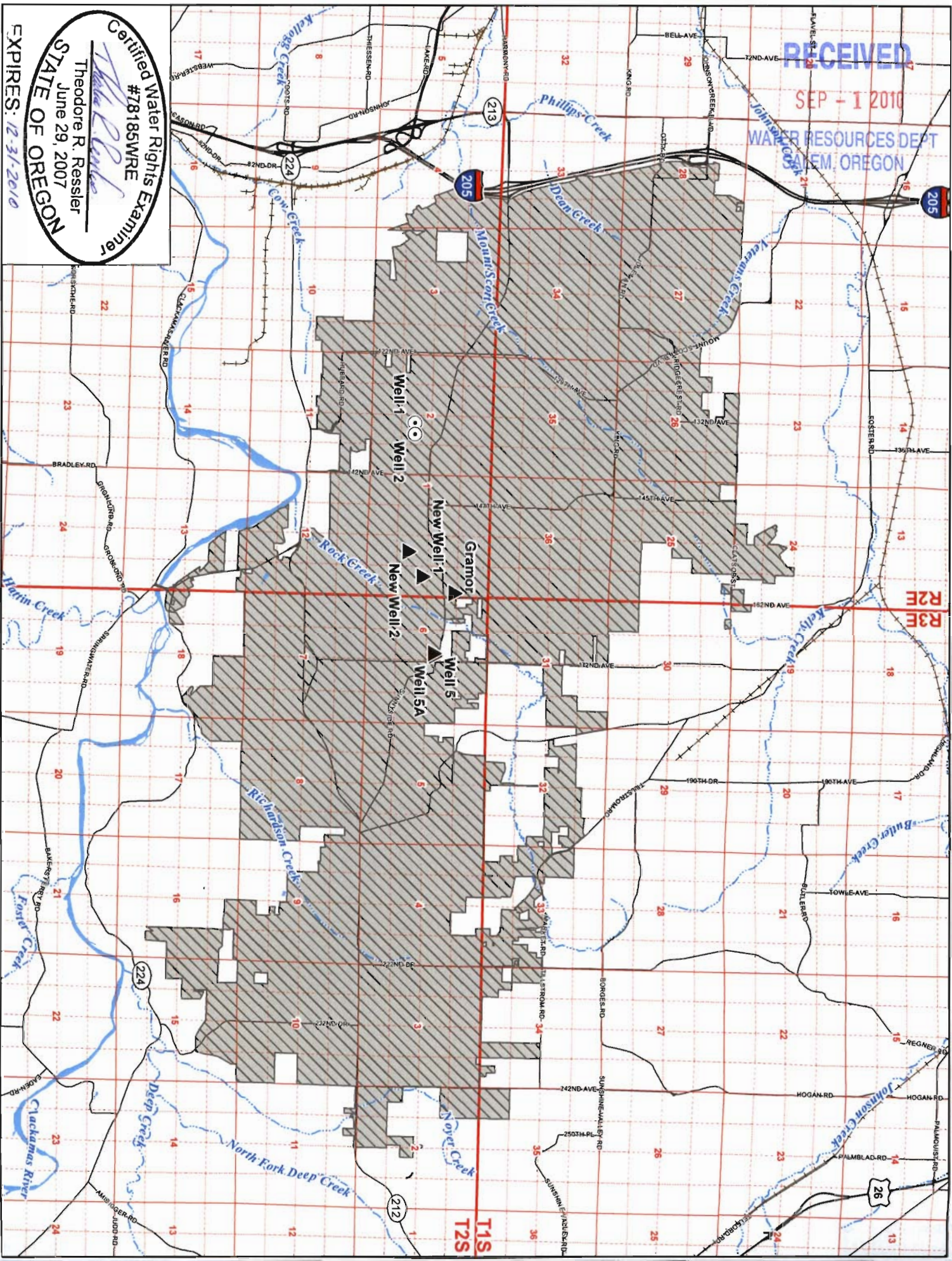

Certified Water Rights Examiner
#78185WRE
Theodore R. Ressler
June 29, 2007
STATE OF OREGON
EXPIRES: 12-31-2010

Application Map for a Water Right Transfer Certificate 45237 (Permit G-5448)

Townships 1 & 2 South, Ranges 2, & 3 East (W.M.)

LEGEND

- ▲ Proposed Point of Appropriation (POA)
- Current Point of Appropriation (POA)
- ▨ Proposed Place of Use (POU)
- ▨ Freeways and Highways
- ▨ Major Roads
- ▨ Railroads
- ▨ Watercourses
- ▨ Waterbodies

CURRENT POA DESCRIPTIONS:

Well 1: Located 776.96 feet South and 372 feet East from the Center of Section 2, Township 2 South, Range 2 East (W.M.)
Well 2: Located 776.96 feet South and 847 feet East from the Center of Section 2, Township 2 South, Range 2 East (W.M.)

PROPOSED POA DESCRIPTIONS:

Gramor: Located 1430 feet South and 175 feet West from the NE corner of Section 1, Township 2 South, Range 2 East (W.M.)
Well 5: Located 2220 feet South and 2950 feet West from the NE corner of Section 6, Township 2 South, Range 3 East (W.M.)
Well 5a: Located 2290 feet South and 2463 feet East from the NW corner of Section 6, Township 2 South, Range 3 East (W.M.)
New Well 1: Located 2468 feet North and 850 feet West from the SE corner of Section 1, Township 2 South, Range 2 East (W.M.)
New Well 2: Located 1880 feet North and 1936 feet West from the SE corner of Section 1, Township 2 South, Range 2 East (W.M.)

CURRENT POU:

See Final Proof Map on file

DISCLAIMER:

This map was prepared for the purpose of identifying the location of a water right only and it is not intended to provide legal dimensions or location of property ownership lines.

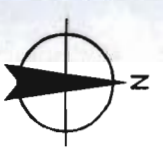

MAP NOTES:

Projection: Oregon State Plane North Zone
Datum: North American Datum of 1983
Date: August 30, 2010
Data Sources: OWRD, METRO RLIS,
Oregon Geospatial Data Clearinghouse

Application Map for a
Water Right Transfer
Certificate 50465 (Permit G-6917)

Townships 1 & 2 South, Ranges 2, & 3 East (W.M.)

LEGEND

- ▲ Proposed Point of Appropriation (POA)
- Current Point of Appropriation (POA)
- ▨ Proposed Place of Use (POU)
- ≡ Freeways and Highways
- ≡ Major Roads
- ≡ Railroads
- ≡ Watercourses
- ≡ Waterbodies

CURRENT POA DESCRIPTIONS:

Well 1: Located 776.96 feet South and 372 feet East from the Center of Section 2, Township 2 South, Range 2 East (W.M.)
Well 2: Located 776.96 feet South and 847 feet East from the Center of Section 2, Township 2 South, Range 2 East (W.M.)

PROPOSED POA DESCRIPTIONS:

Gramor: Located 1430 feet South and 175 feet West from the NE corner of Section 1, Township 2 South, Range 2 East (W.M.)
Well 5: Located 2220 feet South and 2950 feet West from the NE corner of Section 6, Township 2 South, Range 3 East (W.M.)
Well 5A: Located 2290 feet South and 2463 feet East from the NW corner of Section 6, Township 2 South, Range 3 East (W.M.)
New Well 1: Located 2468 feet North and 850 feet West from the SE corner of Section 1, Township 2 South, Range 2 East (W.M.)
New Well 2: Located 1880 feet North and 1936 feet West from the SE corner of Section 1, Township 2 South, Range 2 East (W.M.)

CURRENT POU:

See Final Proof Map on file

DISCLAIMER:

This map was prepared for the purpose of identifying the location of a water right only and it is not intended to provide legal dimensions or location of property ownership lines.

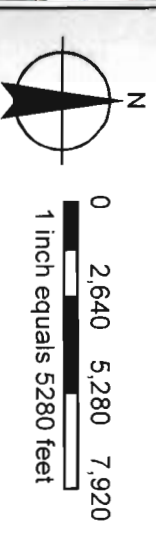

MAP NOTES:

Projection: Oregon State Plane North Zone
Datum: North American Datum of 1983
Date: August 30, 2010
Data Sources: OWRD, METRO RLIS,
Oregon Geospatial Data Clearinghouse

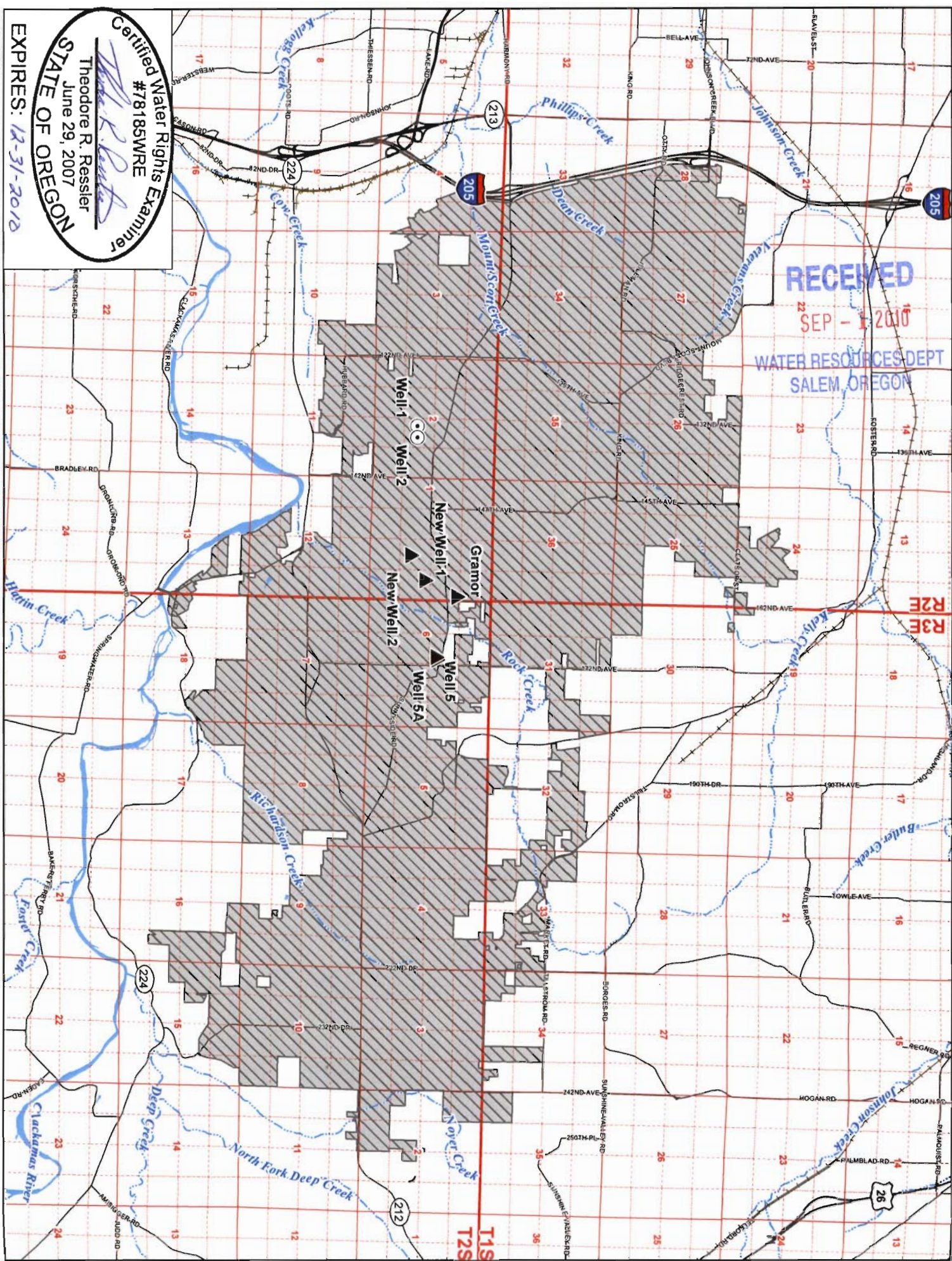

Townships 1 & 2 South, Ranges 2, & 3 East (W.M.)

▲ Proposed Point of Appropriation (POA)

- CURRENT POA DESCRIPTIONS:**

- PROPOSED POA DESCRIPTIONS:**

- See Final Proof Map on file

DISCLAIMER:

dimensions or location of property ownership lines.

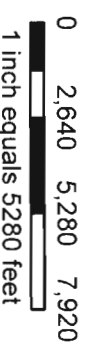

MAP NOTES:

Oregon Geospatial Data Clearinghouse

File Path: P:\Portland\157 - Sunrise Wtr Dist\007-SWA\Transfers\Project_GIS\Project_mxds\Cert65701_POA_Transfer.mxd, Date: August, 30, 2010 10:41:53 AM