

# POD TRANSFER MAP

T. 37 S., R. 2 E., Section 13, Taxlot 4500

Certificate: 17177



WATER RIGHTS FOR NEW POD



REMAINING W.R.

Scale 1" = 1320'

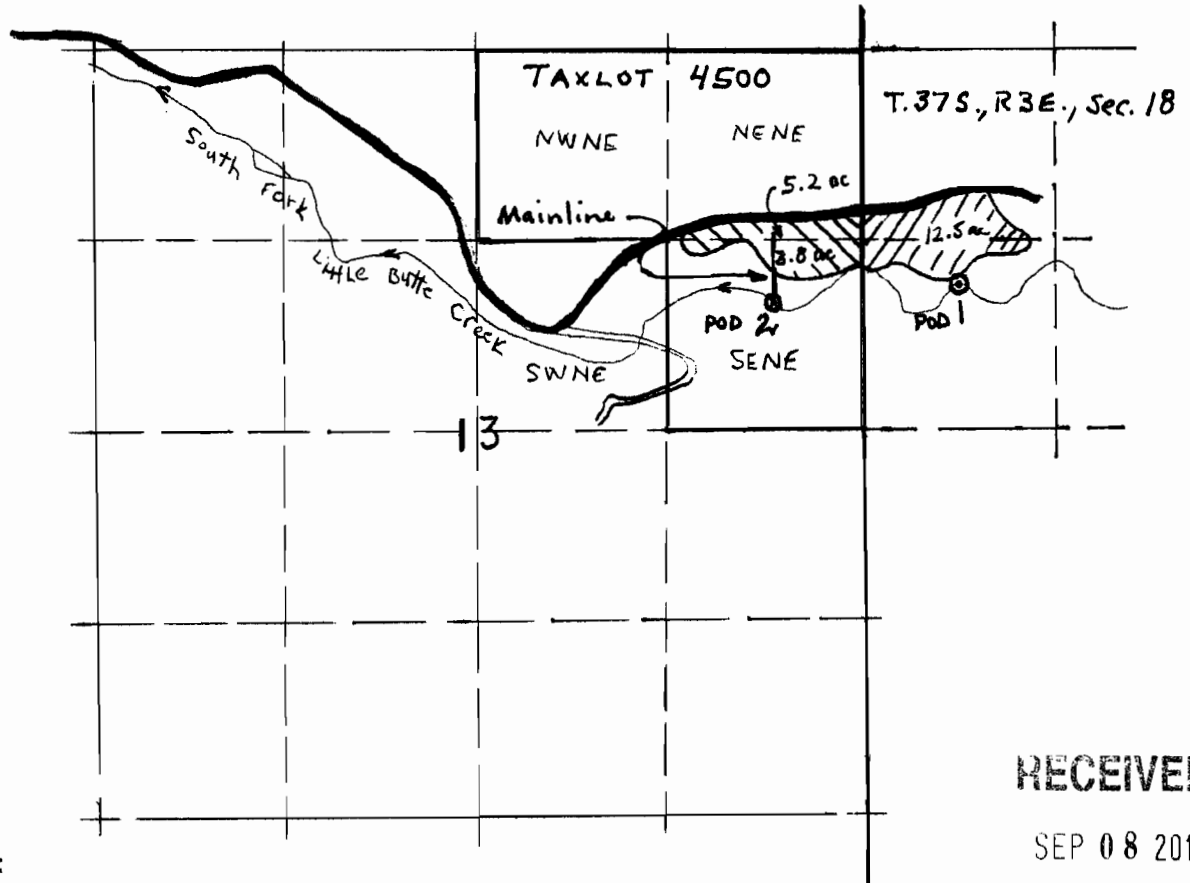

In the name of:

Pat Whitney and Regina Hoffman  
9500 South Fork Little Butte Creek Road  
Eagle Point, OR 97524

RECEIVED

SEP 08 2010

WATER RESOURCES DEPT  
SALEM, OREGON

Source = South Fork Little Butte Creek

New POD (2) is located 1780 feet South and 600 feet West of NE Corner of Section 13.

Old POD (1) is located as shown on map.

**NOTE:** This map is for water rights purposes, not for property boundary locations.

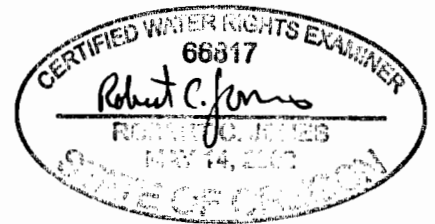

RENEWAL DATE: 6/30/2011

Map by Bob Jones on August 22, 2010