

TRANSFER MAP TO ADD ADDITIONAL POINTS OF DIVERSION ON MILL CREEK IN SECTION 15, T.14S., R.17E., W.M., CROOK COUNTY, OREGON W.O. 10-4008 TAX LOT 1701-14-17

PREPARED FOR

JAMES R. BAUERSFELD, JR.
CHRISTINE R. BAUERSFELD
STEVE MYRIN
MONICA MYRIN
9500 NE MILL CREEK RD.
PRINEVILLE, OR 97754
(541) 410-8752

PREPARED BY

ARMSTRONG SURVEYING
& ENGINEERING, INC.
267 NE SECOND ST. STE. 100
PRINEVILLE, OR 97754
(541) 447-7791

LEGEND

- ◆ 2-1/2" ALUMINUM CAP - CORNER FORM APRIL 29, 1998
- ② ADDITIONAL POINT OF DIVERSION
- ▣ CERTIFICATE 75205

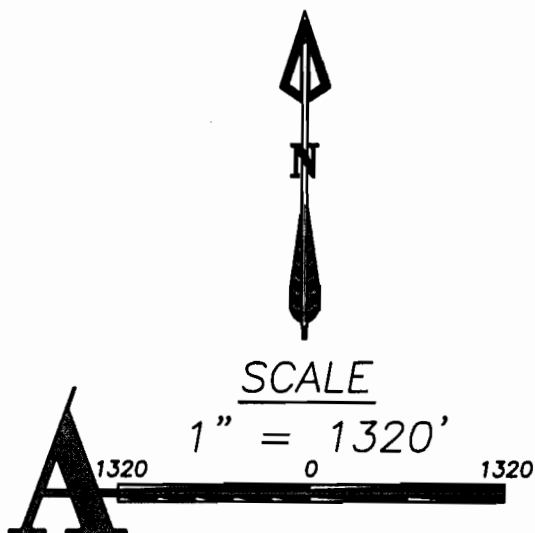

SEPTEMBER 10, 2010

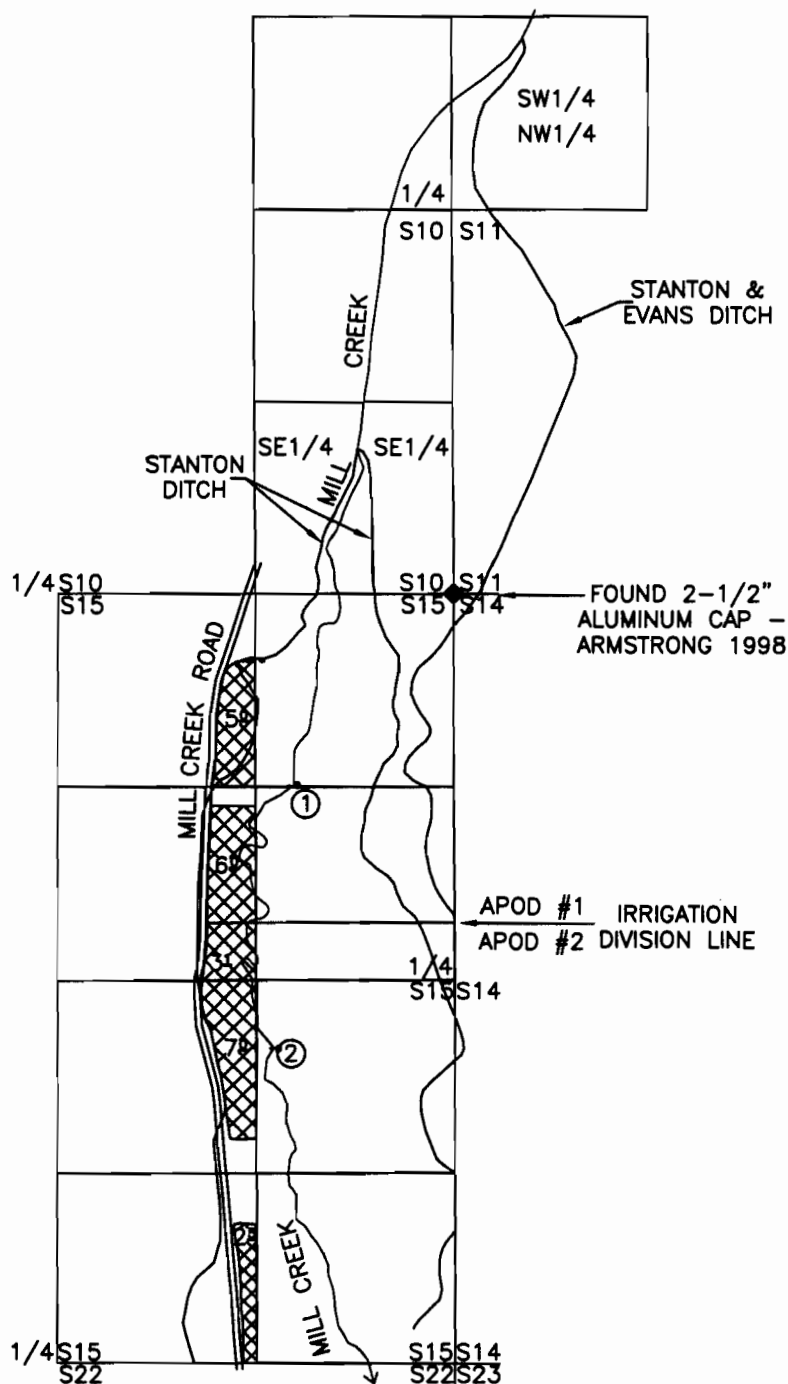
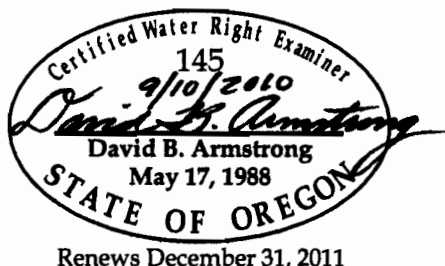

RECEIVED

SEP 22 2010

WATER RESOURCES DEPT
SALEM, OREGON



ADDITIONAL POINTS OF DIVERSION

- NO. 1 - NE1/4 OF THE NE1/4; 1310 FT. SOUTH & 1060 FT. WEST OF NE CORNER SEC. 15, T.14S., R.17E., W.M.
- NO. 2 - NE1/4 OF THE SE1/4; 3120 FT. SOUTH & 1190 FT. WEST OF NE CORNER SEC. 15, T.14S., R.17E., W.M.

SURVEY NOTE

THE PREPARATION OF THIS MAP IS FOR THE PURPOSE OF IDENTIFYING THE LOCATION OF THE WATER RIGHT ONLY AND HAS NO INTENT TO PROVIDE DIMENSIONS OR LOCATIONS OF PROPERTY OWNERSHIP LINES.

T 11135

SHEET 1 OF 4
DRG. NO. 07-3683.DWG

W.O. 10-4008

**TRANSFER MAP TO ADD ADDITIONAL POINTS
OF DIVERSION ON MILL CREEK IN SECTION 15,
T.14S., R.17E., W.M., CROOK COUNTY, OREGON
W.O. 10-4008 TAX LOT 1701-14-17**

PREPARED FOR

JAMES R. BAUERSFELD, JR.
CHRISTINE R. BAUERSFELD
STEVE MYRIN
MONICA MYRIN
9500 NE MILL CREEK RD.
PRINEVILLE, OR 97754
(541) 410-8752

PREPARED BY

ARMSTRONG SURVEYING
& ENGINEERING, INC.
267 NE SECOND ST. STE. 100
PRINEVILLE, OR 97754
(541) 447-7791

LEGEND

- ◆ 2-1/2" ALUMINUM CAP - CORNER FORM
APRIL 29, 1998
- ① ADDITIONAL POINT OF DIVERSION
- ▨ CERTIFICATE 76366

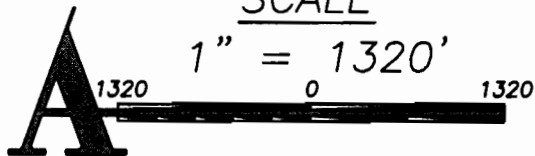

SEPTEMBER 10, 2010

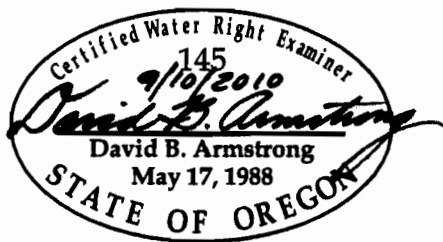

Renews December 31, 2011

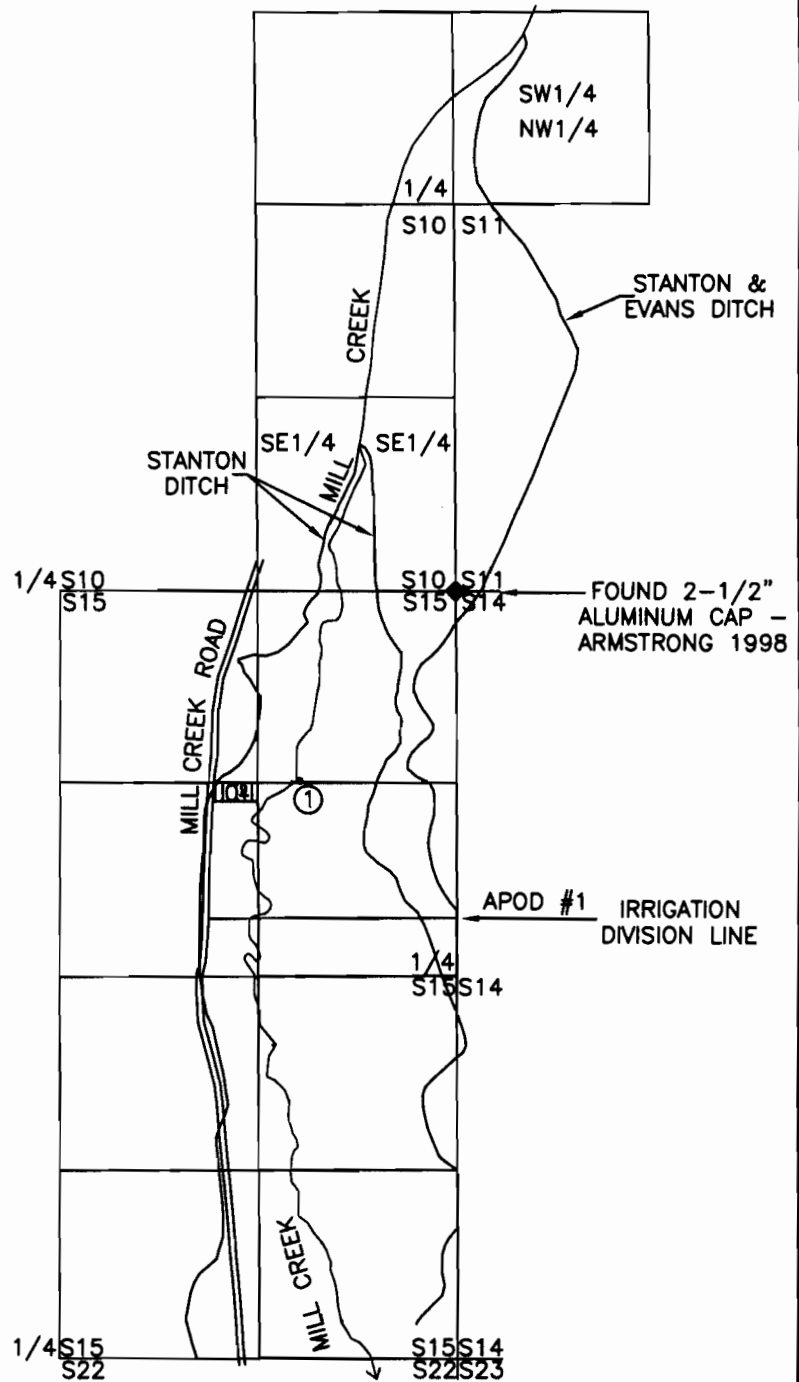

ADDITIONAL POINT OF DIVERSION

NO. 1 - NE1/4 OF THE NE1/4; 1310 FT. SOUTH & 1060 FT. WEST
OF NE CORNER SEC. 15, T.14S., R.17E., W.M.

SURVEY NOTE

THE PREPARATION OF THIS MAP IS FOR THE PURPOSE OF
IDENTIFYING THE LOCATION OF THE WATER RIGHT ONLY AND
HAS NO INTENT TO PROVIDE DIMENSIONS OR LOCATIONS OF
PROPERTY OWNERSHIP LINES.



SHEET 2 OF 4
DRG. NO. 07-3683.DWG

W.O. 10-4008

T 11135

**TRANSFER MAP TO ADD ADDITIONAL POINTS OF DIVERSION ON MILL CREEK IN SECTION 15, T.14S., R.17E., W.M., CROOK COUNTY, OREGON
W.O. 10-4008 TAX LOT 1701-14-17**

PREPARED FOR

JAMES R. BAUERSFELD, JR.
CHRISTINE R. BAUERSFELD
STEVE MYRIN
MONICA MYRIN
9500 NE MILL CREEK RD.
PRINEVILLE, OR 97754
(541) 410-8752

PREPARED BY

ARMSTRONG SURVEYING
& ENGINEERING, INC.
267 NE SECOND ST. STE. 100
PRINEVILLE, OR 97754
(541) 447-7791

LEGEND

- ◆ 2-1/2" ALUMINUM CAP - CORNER FORM
APRIL 29, 1998
- ② ADDITIONAL POINT OF DIVERSION
- ▨ CERTIFICATE 83370

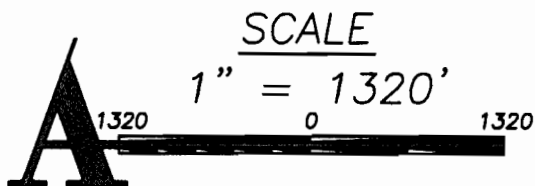

SEPTEMBER 10, 2010

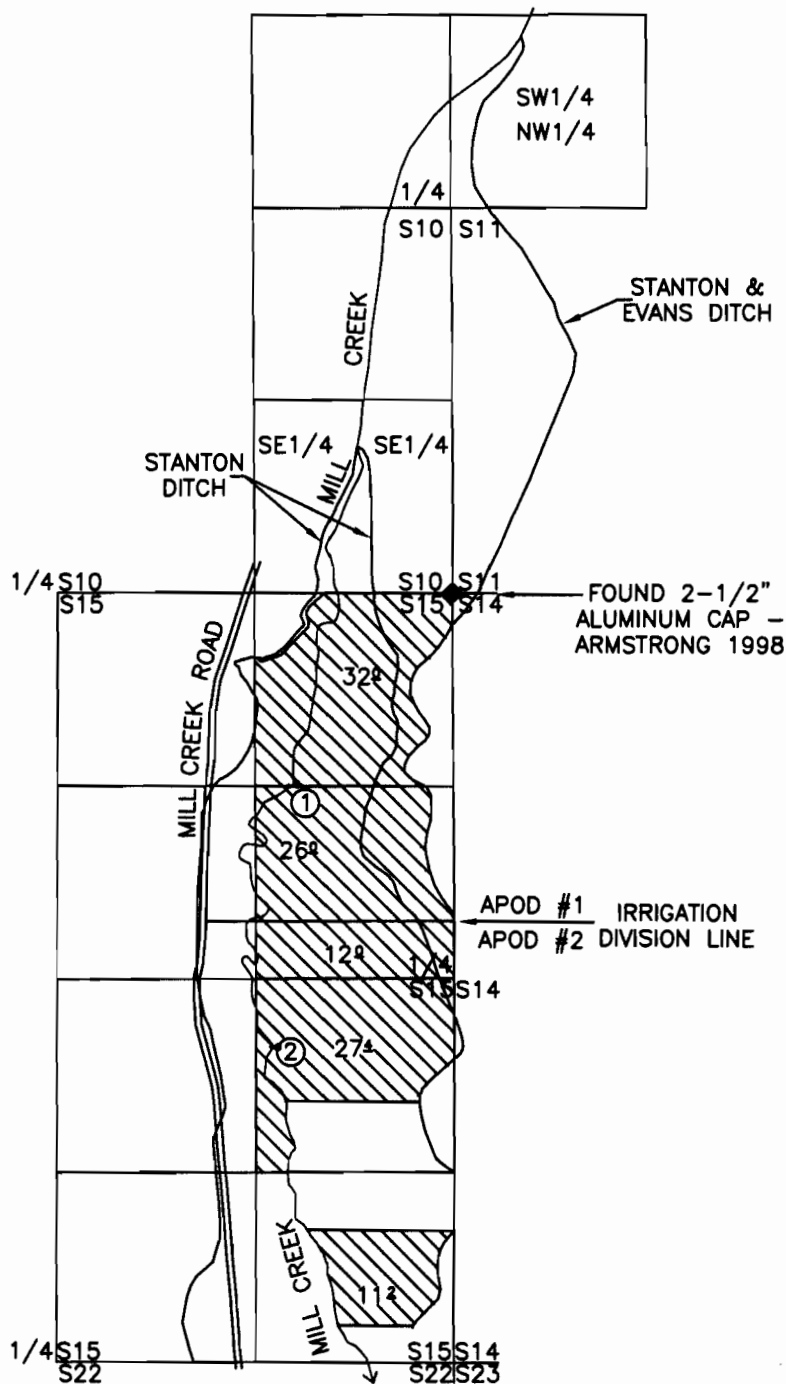
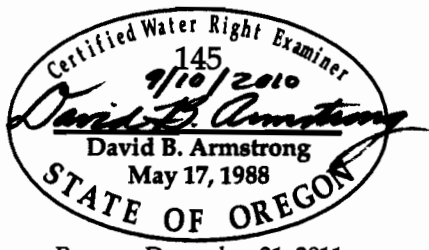

RECEIVED

SEP 22 2010

WATER RESOURCES DEPT
SALEM, OREGON



SHEET 3 OF 4
DRG. NO. 07-3683.DWG

W.O. 10-4008

ADDITIONAL POINTS OF DIVERSION

- NO. 1 - NE1/4 OF THE NE1/4; 1310 FT. SOUTH & 1060 FT. WEST OF NE CORNER SEC. 15, T.14S., R.17E., W.M.
- NO. 2 - NE1/4 OF THE SE1/4; 3120 FT. SOUTH & 1190 FT. WEST OF NE CORNER SEC. 15, T.14S., R.17E., W.M.

SURVEY NOTE

THE PREPARATION OF THIS MAP IS FOR THE PURPOSE OF IDENTIFYING THE LOCATION OF THE WATER RIGHT ONLY AND HAS NO INTENT TO PROVIDE DIMENSIONS OR LOCATIONS OF PROPERTY OWNERSHIP LINES.

T 11135

**TRANSFER MAP TO ADD ADDITIONAL POINTS
OF DIVERSION ON MILL CREEK IN SECTION 15,
T.14S., R.17E., W.M., CROOK COUNTY, OREGON
W.O. 10-4008 TAX LOT 1701-14-17**

PREPARED FOR

JAMES R. BAUERSFELD, JR.
CHRISTINE R. BAUERSFELD
STEVE MYRIN
MONICA MYRIN
9500 NE MILL CREEK RD.
PRINEVILLE, OR 97754
(541) 410-8752

PREPARED BY

ARMSTRONG SURVEYING
& ENGINEERING, INC.
267 NE SECOND ST. STE. 100
PRINEVILLE, OR 97754
(541) 447-7791

LEGEND

- ◆ 2-1/2" ALUMINUM CAP - CORNER FORM
APRIL 29, 1998
- ② ADDITIONAL POINT OF DIVERSION
- ▨ CERTIFICATE 83371



SCALE

1" = 1320'

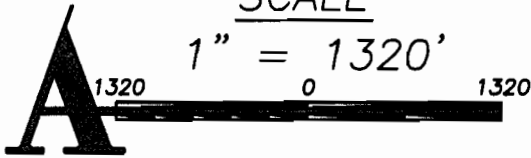

SEPTEMBER 10, 2010

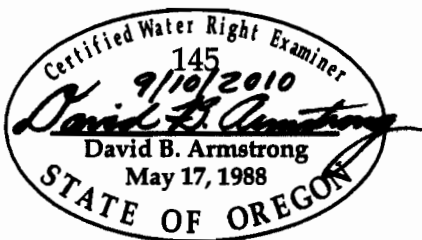

Renews December 31, 2011

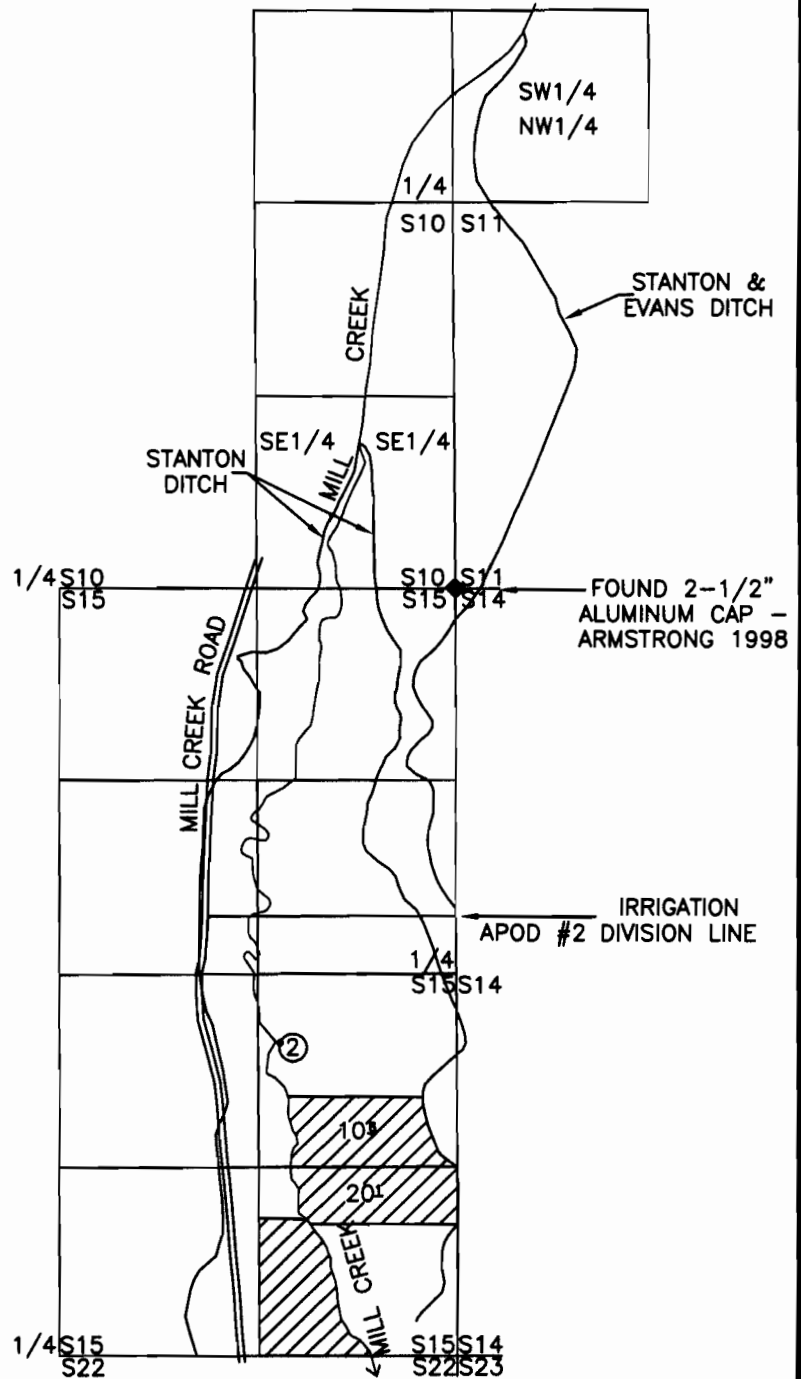

ADDITIONAL POINT OF DIVERSION

NO. 2 - NE1/4 OF THE SE1/4; 3120 FT. SOUTH & 1190 FT. WEST
OF NE CORNER SEC. 15, T.14S., R.17E., W.M.

SURVEY NOTE

THE PREPARATION OF THIS MAP IS FOR THE PURPOSE OF
IDENTIFYING THE LOCATION OF THE WATER RIGHT ONLY AND
HAS NO INTENT TO PROVIDE DIMENSIONS OR LOCATIONS OF
PROPERTY OWNERSHIP LINES.

T 11135
T 11135



SHEET 4 OF 4
DRG. NO. 07-3683.DWG

W.O. 10-4008