

Sec. 10, 15, 22

Tp. 1 N.  
R. 42 E.  
W. 1 Mer.

C. H. Thorp  
Wallowa  
Oregon

T-1

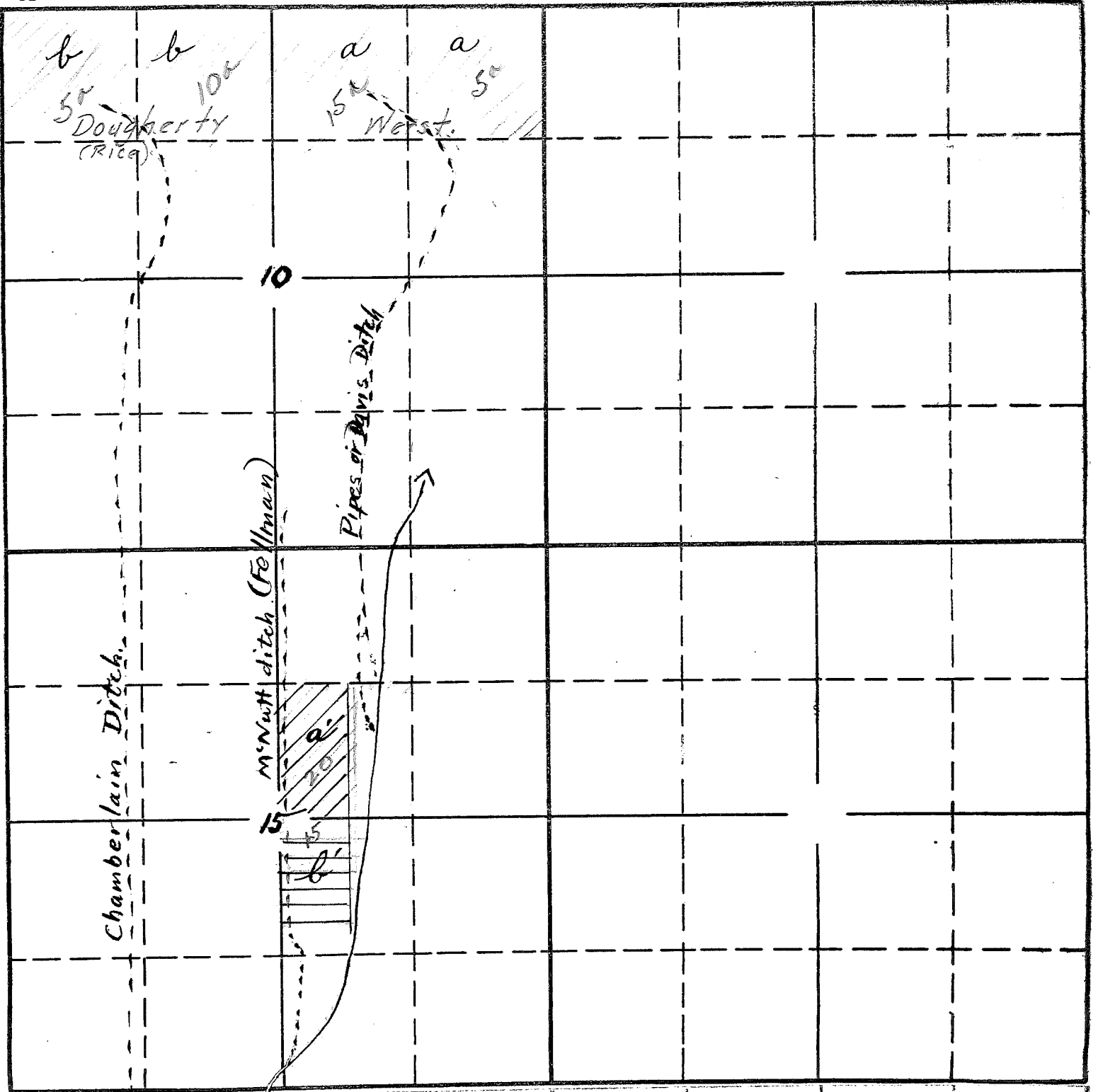

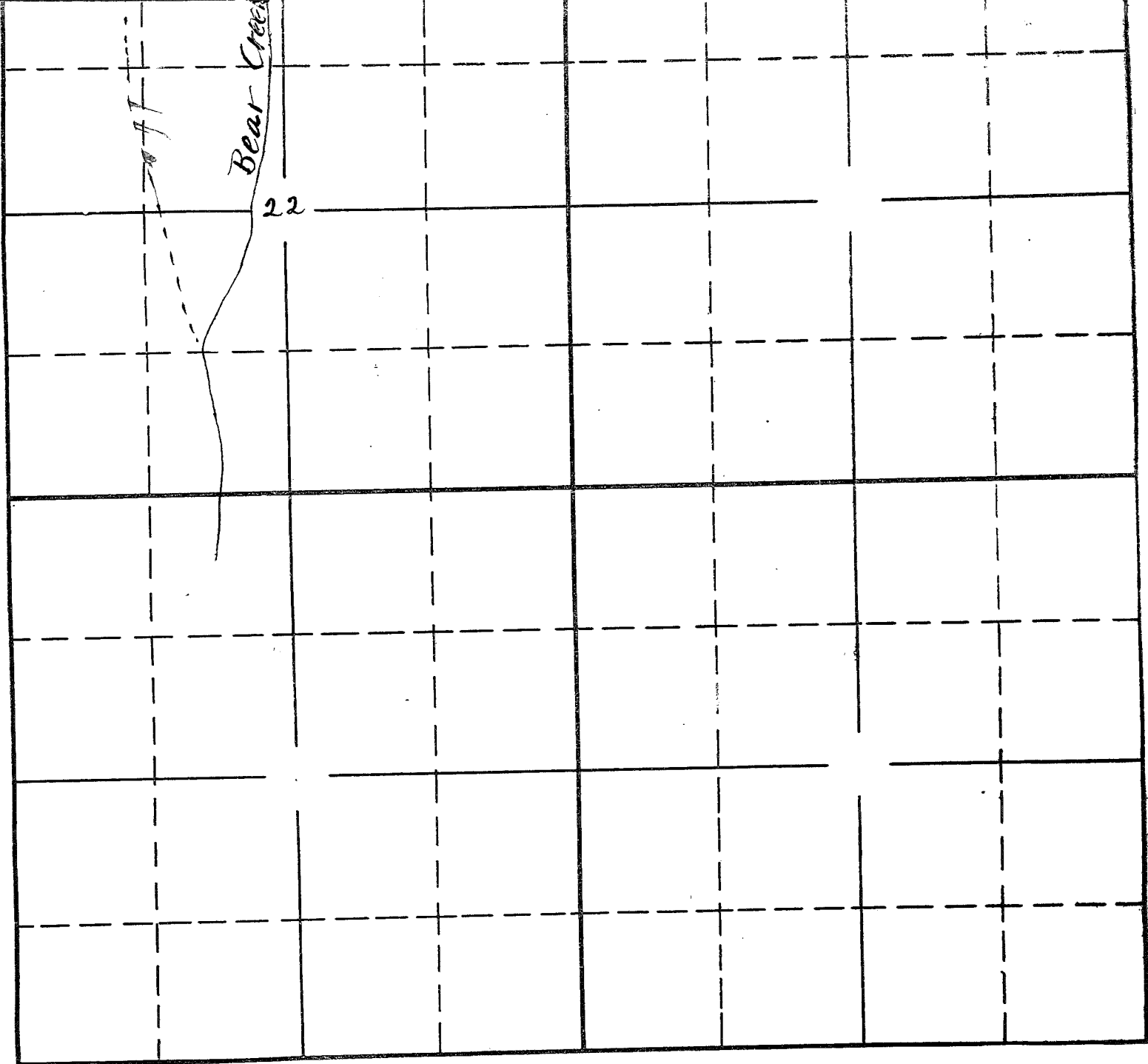

CH Thorp.  
 Wallowa Ore.  
 Appln. for Transfer.  
 a<sup>b</sup> Land from which to be transferred. Sec 10  
 a' b' " to " " " " " 15.

# T. 1 N. R. 42 E. W. M.

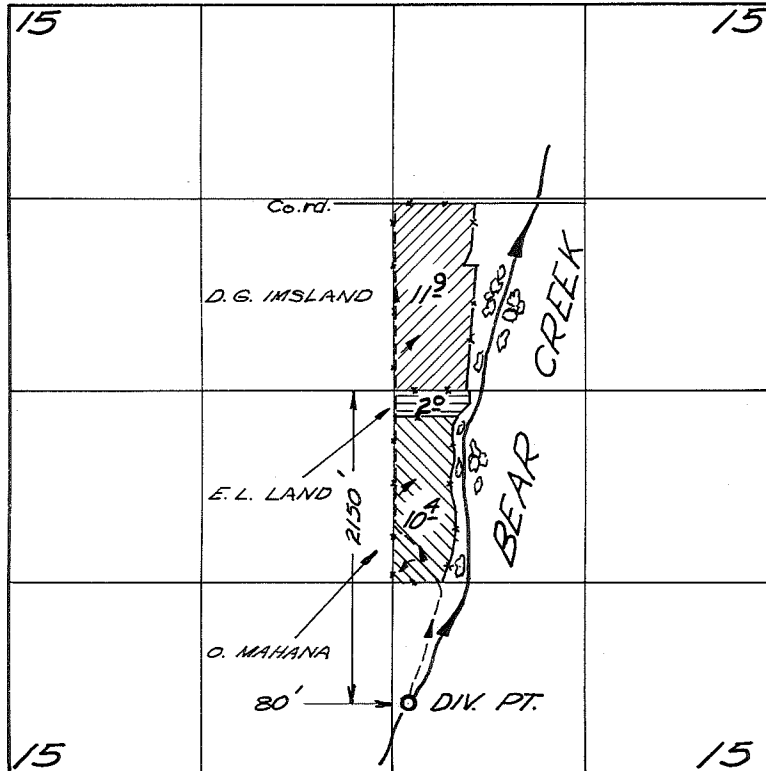

## FINAL PROOF SURVEY UNDER

*TRANSFER - T-1*

Application No. .... Permit No. ....  
IN NAME OF

*DON G. IMSLAND — EARL L. LAND — ORIE MAHANA*

Surveyed *June 24 1966*, by *V. GARNER*