

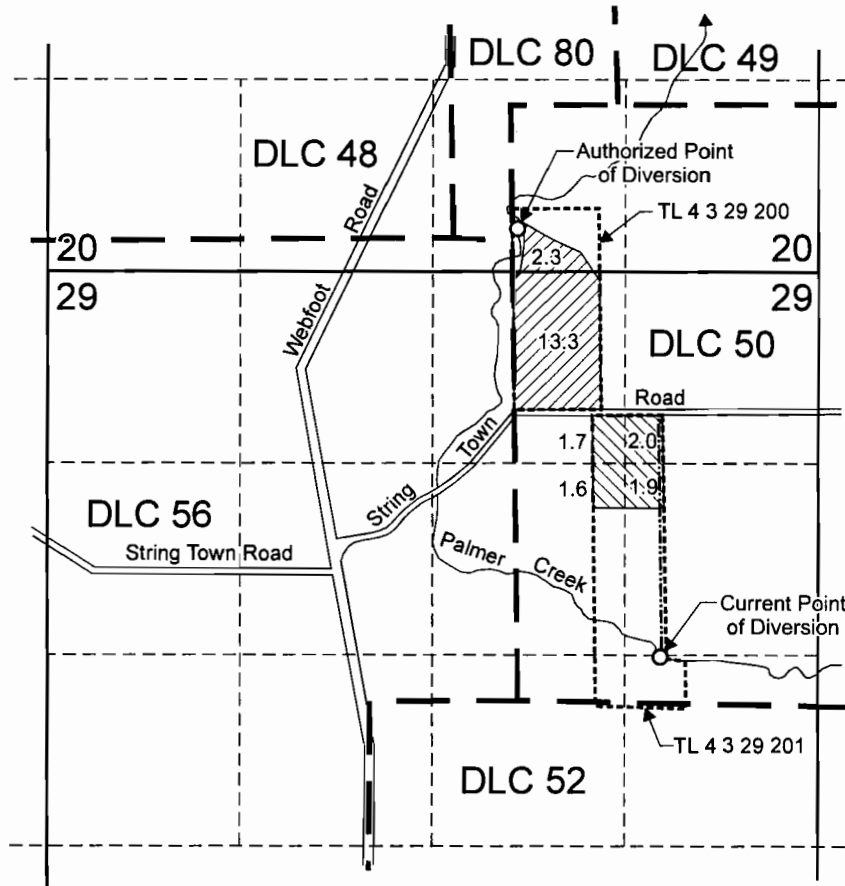

T.4S. R.3W. Section 29, W.M.



Authorized point of diversion is located 850 feet south and 50 feet east from the NW corner, DLC 50.

Current point of diversion is located 300 feet north and 980 feet east from the SW corner, DLC 50.

 Area (7.2 Acres) under Certificate 21924 affected by this transfer (served by current POD).

 Area (15.6 Acres) under Certificate 21924 remaining (served by authorized POD).

----- Tax lot boundary

----- Irrigation mainline

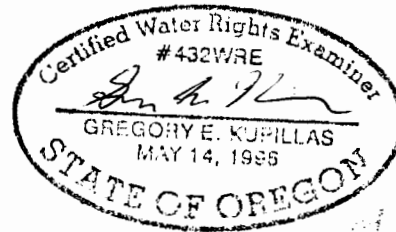

EXPIRATION DATE: 6/30/2011

JAN 26 2011

T 11190

Scale: 1" = 1,320'



This map was prepared for the purpose of identifying the location of a water right only and is not intended to provide legal dimensions or location of property ownership lines.



Water Right Transfer Application Map

Pacific Hydro-Geology Inc.

Steve Edwards
T.4S. R.3W. Section 29, W.M.

12/2010