

N

**SCALE: 1"=1320'**

- Lands with supplemental rights under Certificate 65175, owned by others.
- Lands with supplemental rights under Certificate 65175 to remain in place.
- Lands with Primary rights from Wallowa River Decree and supplemental rights under Certificate 65175 requesting a change of place of use.
- Lands with Primary rights from Wallowa Decree, to receive supplemental rights from Certificate 65175.

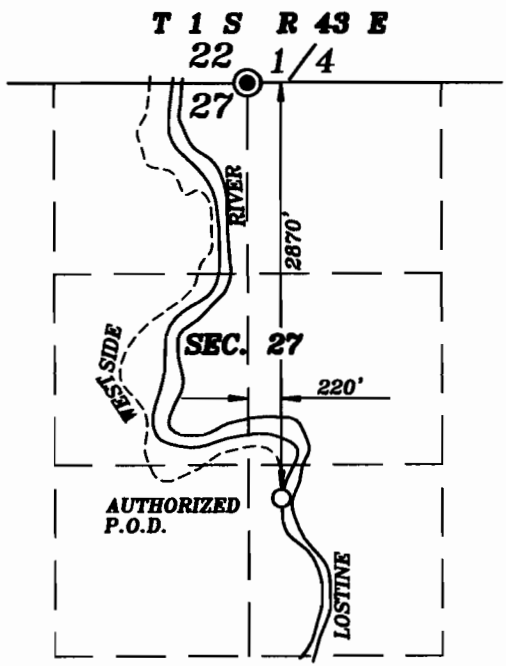

----- Existing mainline

**RECEIVED**

MAR 31 2011

WATER RESOURCES DEPT  
SALEM, OREGON

MARCH 21, 2011

**APPLICATION MAP FOR  
CHANGE OF PLACE OF USE  
FOR  
ROYCE HORTON**

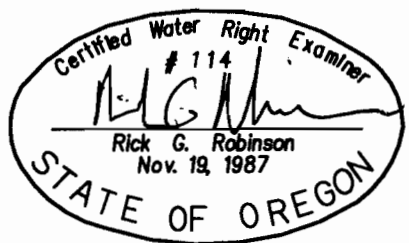

T 11218

NOTE: The preparation of this map was for the purpose of identifying the location of water rights and has no intent to provide dimensions or location of property ownership lines. Location information shown hereon was furnished by the applicant.

BY  
**BAGETT - GRIFFITH & BLACKMAN**  
2006 ADAMS AVENUE  
LAGRANDE, OREGON 97850

APPLICATION NO. \_\_\_\_\_  
PERMIT NUMBER \_\_\_\_\_