

T.5S., R.1W., W.M.

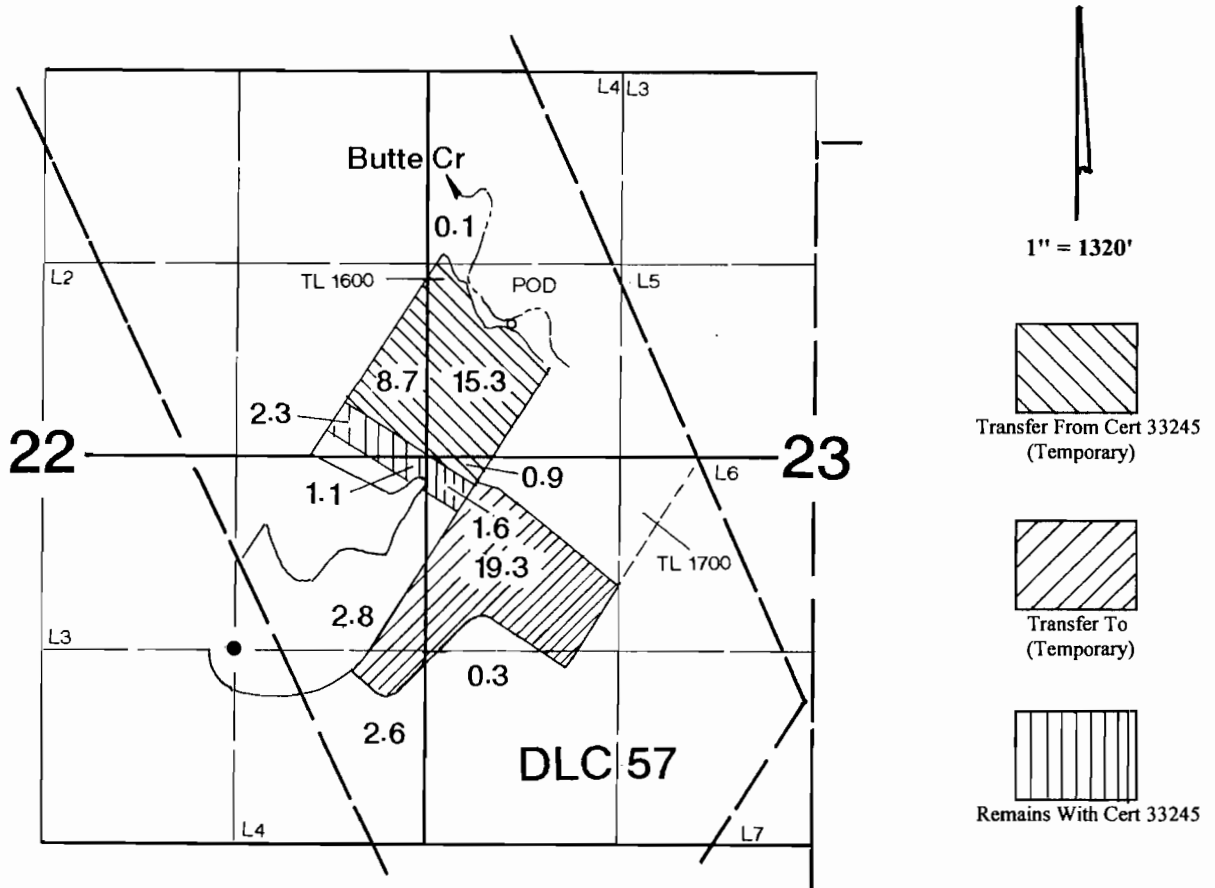

POD is located 2260' N & 1890' E from the NW corner of Lot 4 (SE1/4-SE1/4), Section 22.

Application Map

Chuck Eder Farms Inc.

Transfer (Temporary) #:

This Map was Prepared for the Purpose of Identifying the Location of a Water Right Only and is Not Intended to Provide Legal Dimensions or Location of Property Ownership Lines.

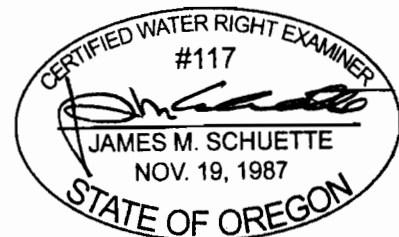

EXPIRES: 6/30/2012

T 11251