

T.6S., R.4W., W.M.

RECEIVED

JUN 27 2011

WATER RESOURCES DEPT
SALEM, OREGON

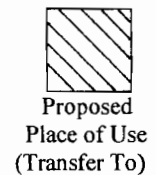
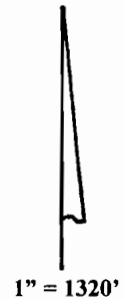
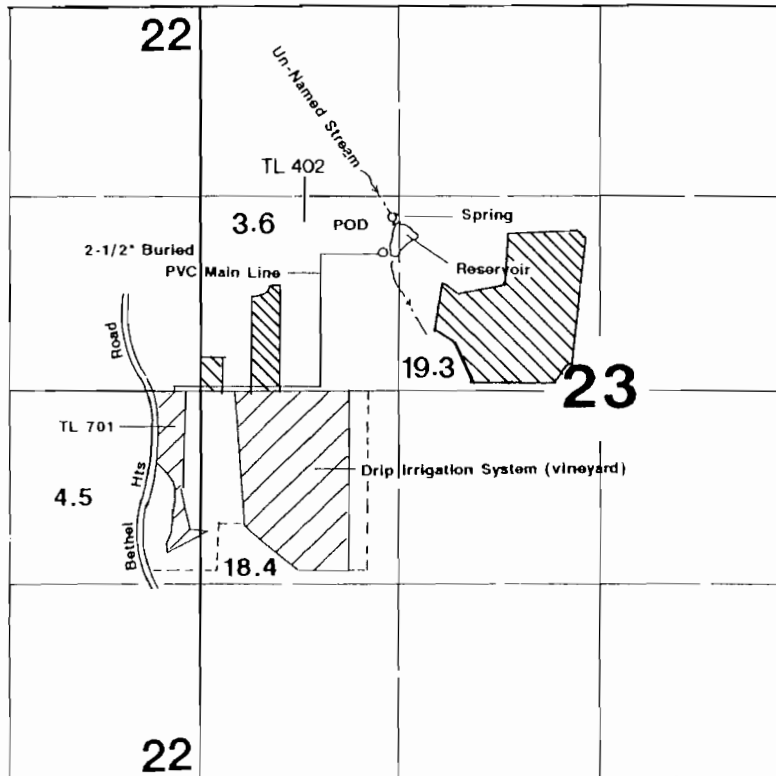

Spring is located 1180' N & 1260' E
POD is located 930' N & 1240' E --both from the W1/4 corner of Section 23.

Application Map

Bethel Heights Vineyard

(Temporary) Transfer #:

This Map was Prepared for the Purpose of Identifying the Location of a Water Right Only and is Not Intended to Provide Legal Dimensions or Location of Property Ownership Lines.

T 11264

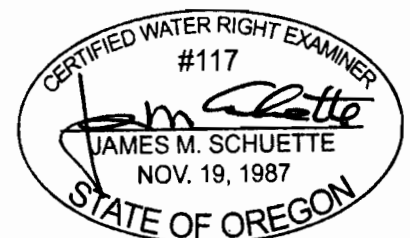

EXPIRES: 6/30/2012