

**Transfer of Water Right
T 39 S, R 19 E, Sec 29 & 32, W.M.**

RECEIVED

SEP 02 2011

WATER RESOURCES DEPT
SALEM, OREGON

RECEIVED

SEP 02 2011

WATER RESOURCES DEPT
SALEM, OREGON

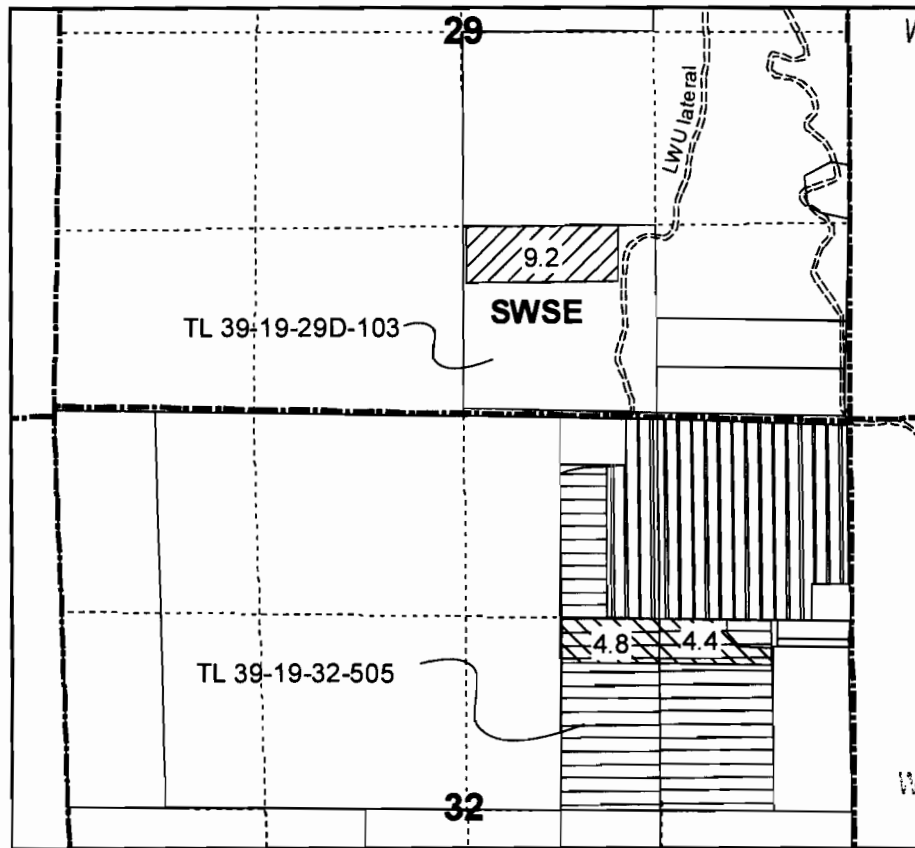





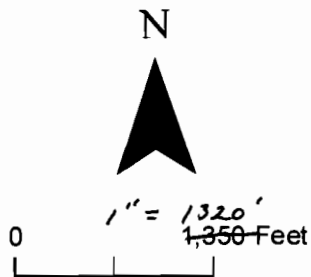

RECEIVED

JAN 07 2010

WATER RESOURCES DEPT
SALEM, OREGON



Legend

-  Existing LWU water right
-  To < 75426
-  From < 75426
-  Certificate 63272 primary
-  LWU system
-  Section line
-  Quarter quarter line

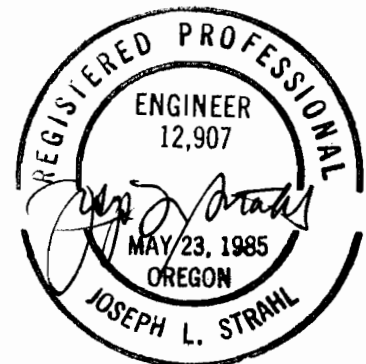

Note: This map is not intended to provide legal dimensions or locations of property ownership lines.

RECEIVED

SEP 02 2011

T 11290

WATER RESOURCES DEPT
SALEM, OREGON

RECEIVED

C75426

JAN 07 2010

Transfer of T-5814
Points of Diversion map

WATER RESOURCES DEPT
SALEM, OREGON

Map 2 of 2

Note: This map is not intended to provide legal dimensions or locations of property ownership lines.

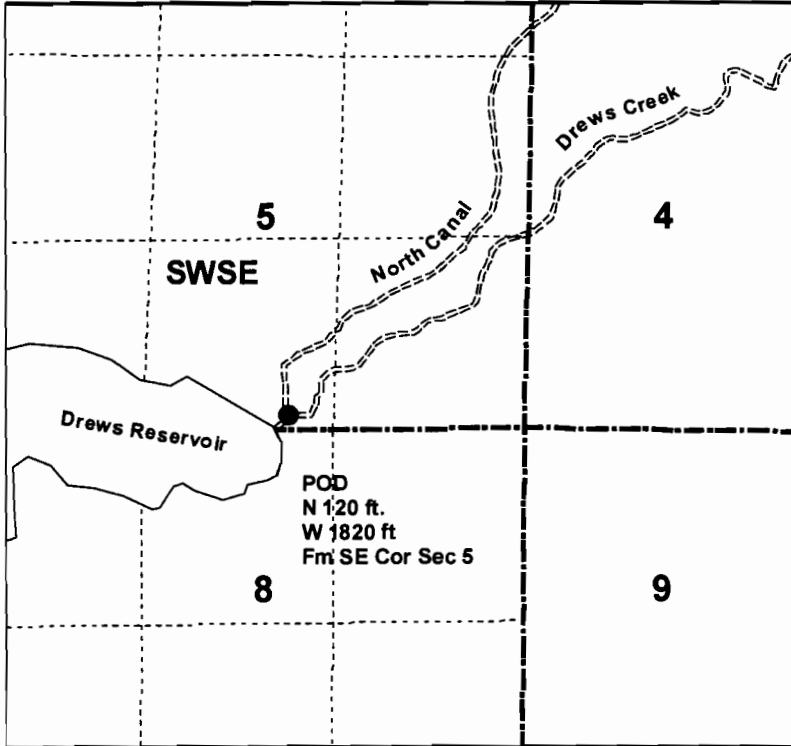

Drows Reservoir POD SWSE, T40S, R18E, Sec 5

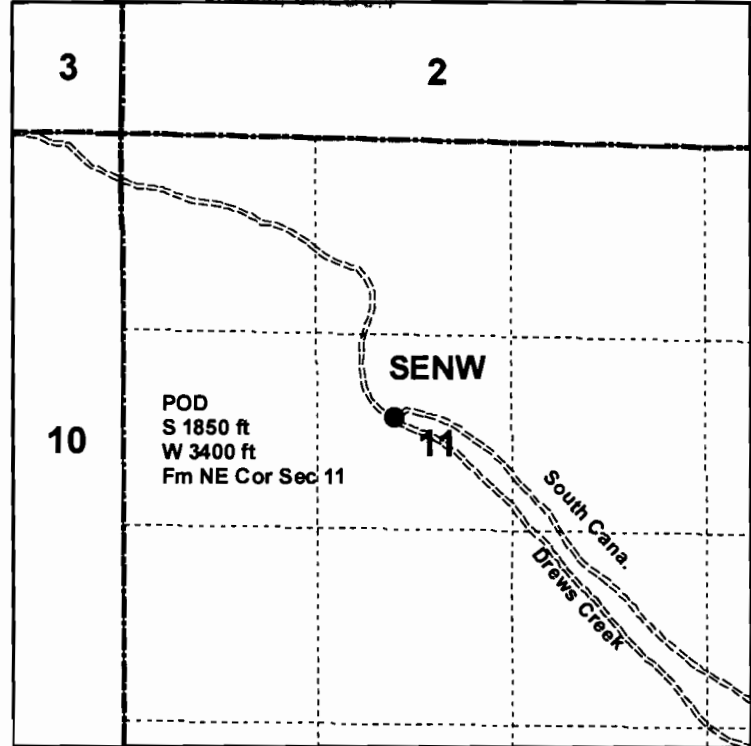

Drows Creek POD SENW, T40S, R18E, Sec 11

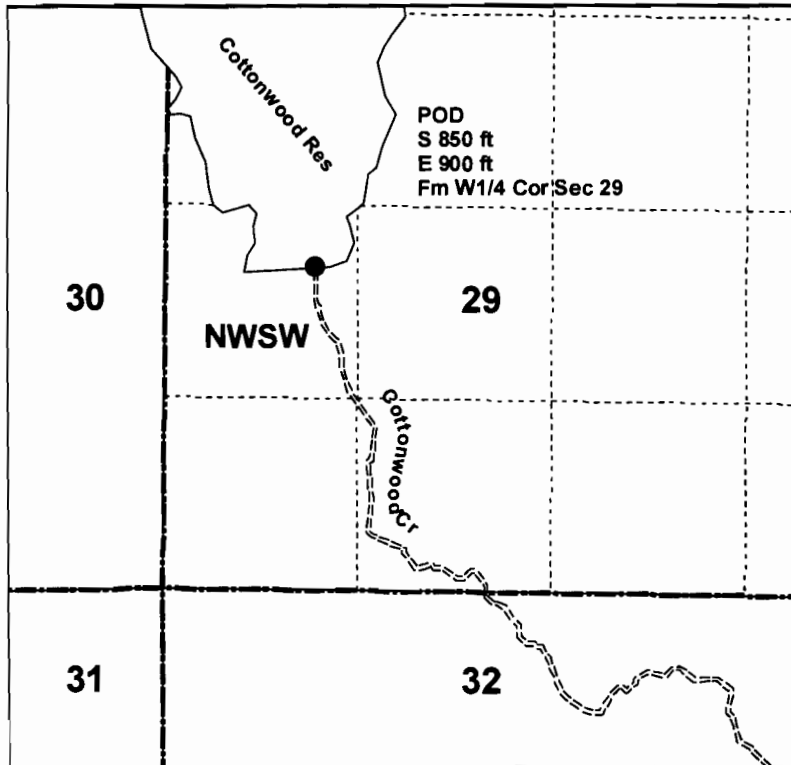

Cottonwood Reservoir POD NWSW, T38S, R19E, Sec 29

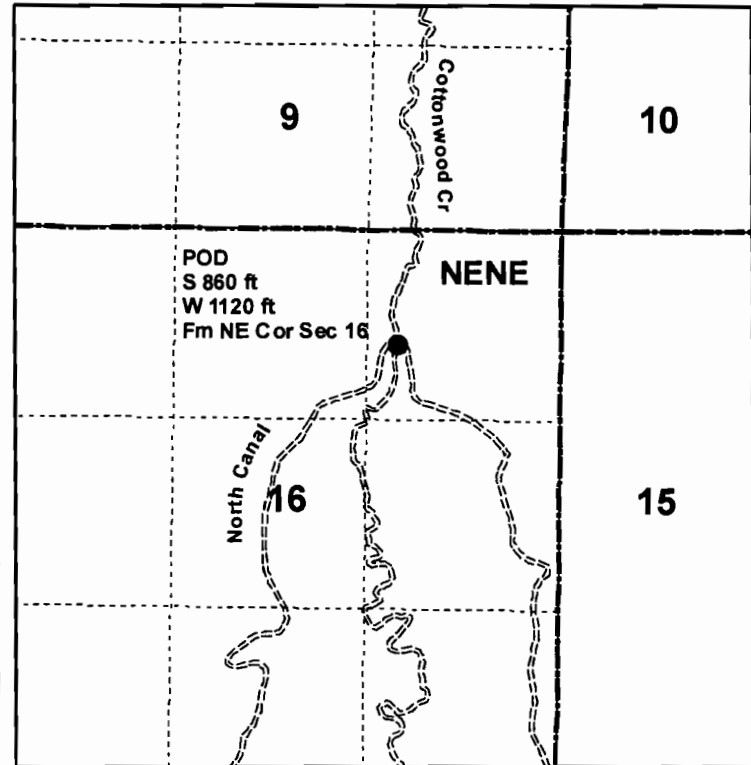

Cottonwood Creek POD NENE, T39S, R19E, Sec 16

Note: T-5814 was for change of place of use only. Surveying of the location of the POD's was not part of this COBU. The POD locations shown hereon are the locations as shown on Certificate 47469. These locations appear to be correct when reviewed with the aerial photo on GIS.

**Diminishment of a Portion Water Right
T 39 S, R 19 E, Sec 32, W.M.
Certificate 63272**



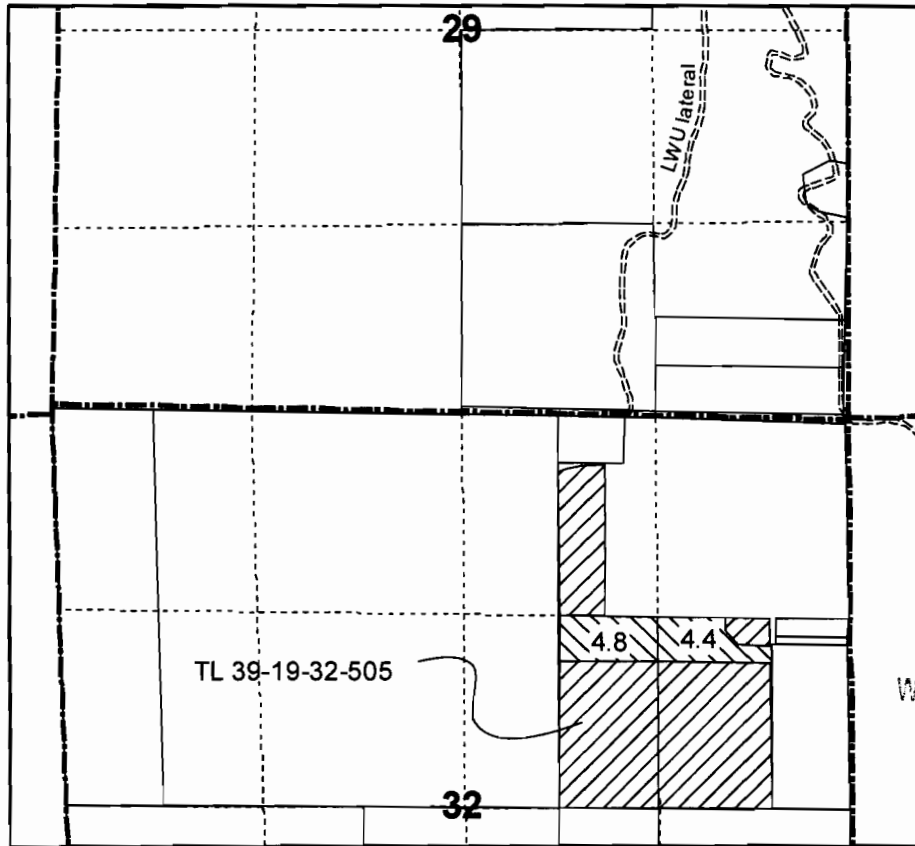

RECEIVED
SEP 02 2011
WATER RESOURCES DEPT
SALEM, OREGON

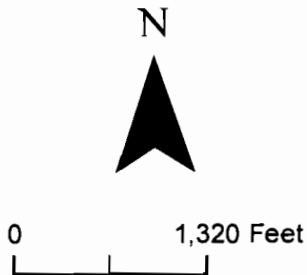

RECEIVED
JAN 07 2010
WATER RESOURCES DEPT
SALEM, OREGON



Legend

-  C 63272 no change
-  C 63272 Diminish to Supplemental
-  LWU system
-  Section line
-  Quarter quarter line



Note: This map is not intended to provide legal dimensions or locations of property ownership lines.