

RECEIVED

FEB 0 1 2010

WATER RESOURCES DEPT

SALEM, OREGON

Application for a Water Right Transfer

Certificate 35590 (Permit G-2061)

Township 1 South, Range 1 East (W.M.)

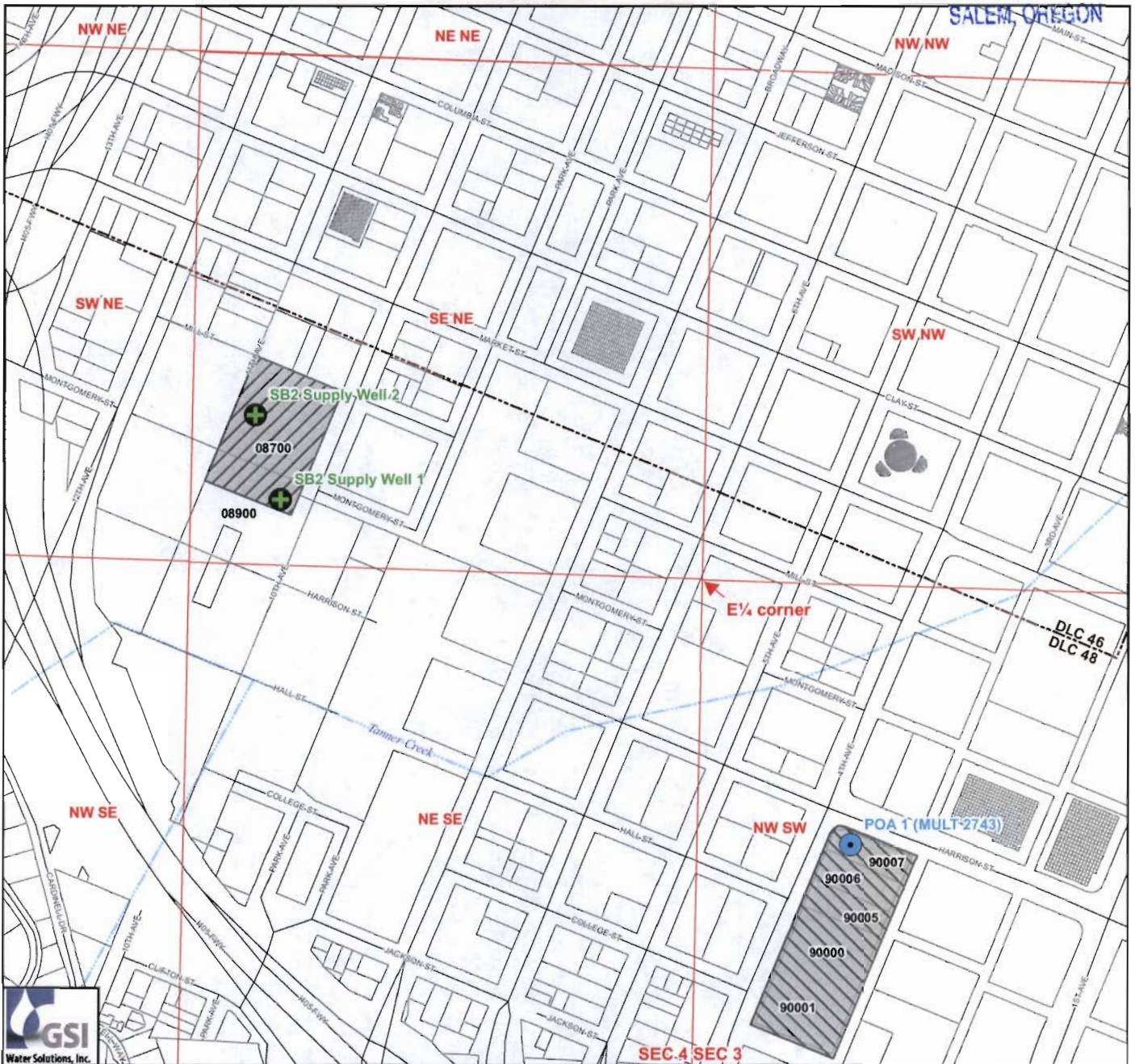

Legend

- Authorized Point of Appropriation (POA)
- Proposed Points of Appropriation (POA)
- Current Place of Use (POU)
- Proposed Place of Use (POU)
- DLC
- Taxlots
- Roads
- Watercourses
- Waterbodies

T 11014

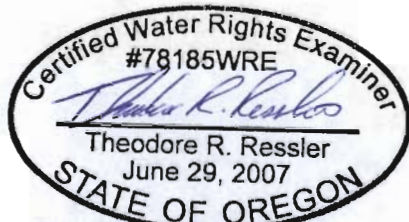

EXPIRES: 12-31-2010

Map Information

Map Projection: Oregon State Plane North
 Map Datum: North American Datum of 1983
 Map Date: January 22, 2010
 Data Sources: METRO, Multnomah County, OWRD

Note

This map was prepared for the purpose of identifying the location of a water right only and it is not intended to provide legal dimensions or location of property ownership lines.

POA Legal Description

- Authorized Point of Appropriation (POA 1)**
Located 687 feet South and 395 feet East from the West quarter corner of Section 3, Township 1 South, Range 1 East
- Proposed Point of Appropriation (SB2 Supply Well 1)**
Located 169 feet North and 1,091 feet West from the East quarter corner of Section 4, Township 1 South, Range 1 East
- Proposed Point of Appropriation (SB2 Supply Well 2)**
Located 392 feet North and 1,148 feet West from the East quarter corner of Section 4, Township 1 South, Range 1 East

Application for a Water Right Transfer

Certificate 44645 (Permit G-3965)

Township 1 South, Range 1 East (W.M.)

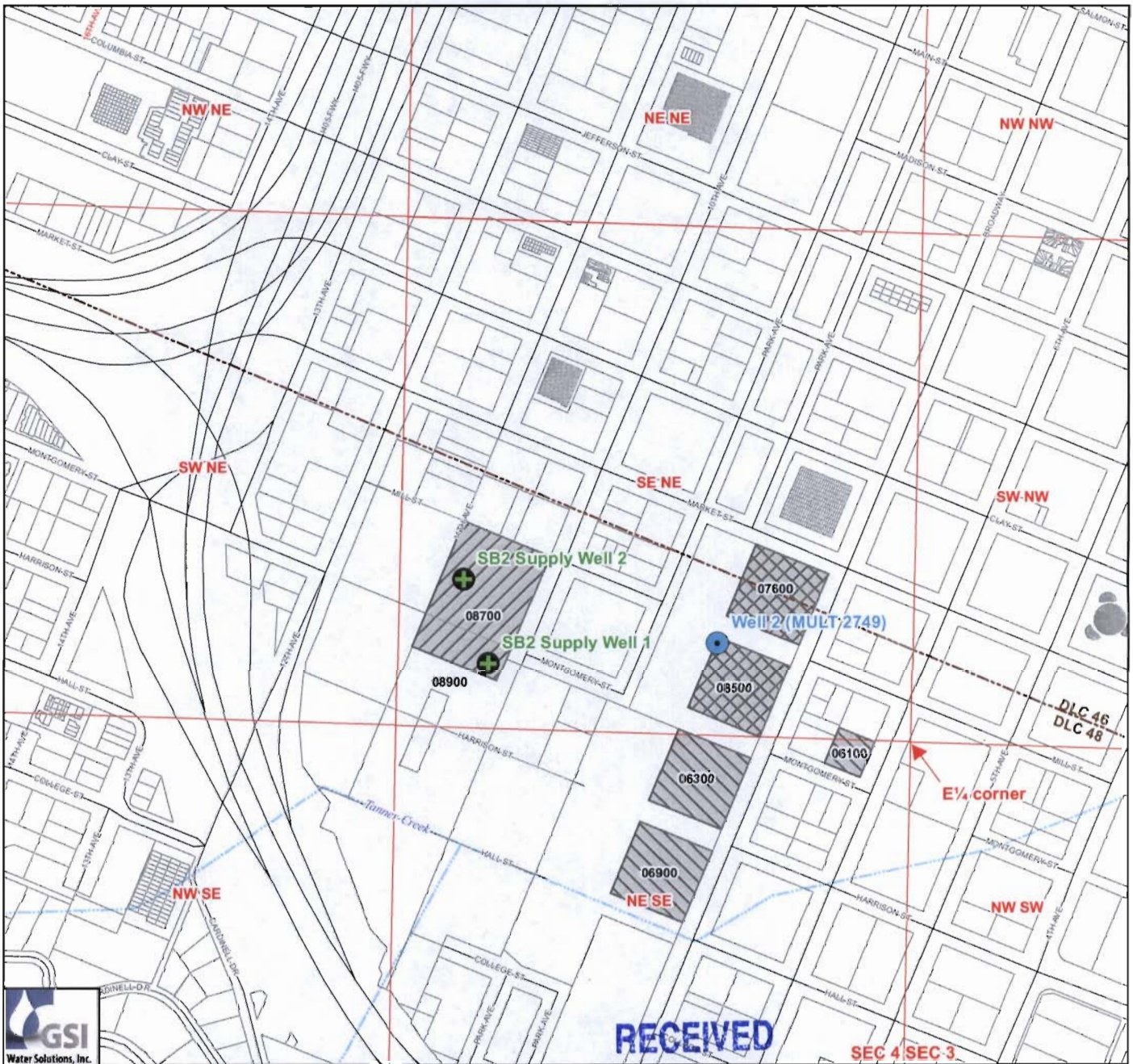

RECEIVED

SEC 4 SEC 3

Legend

- Authorized Point of Appropriation (POA)
- + Proposed Additional Points of Appropriation (POA)
- Current Place of Use (POU)
- Proposed Place of Use (POU)
- - - DLC
- Taxlots
- Roads
- Watercourses

T 11014

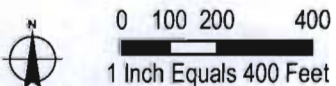

FEB 0 1 2010

WATER RESOURCES DEPT
SALEM, OREGON

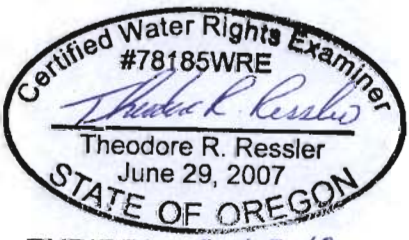

Map Information

Map Projection: Oregon State Plane North
Map Datum: North American Datum of 1983
Map Date: January 29, 2010
Data Sources: METRO, Multnomah County, OWRD

Note

This map was prepared for the purpose of identifying the location of a water right only and it is not intended to provide legal dimensions or location of property ownership lines.

POA Legal Description

Authorized POA (Well 2)

- Located 247 feet North and 492 feet West from the East quarter corner of Section 4, Township 1 South, Range 1 East
- Proposed Additional POA (SB2 Supply Well 1)**
Located 169 feet North and 1,091 feet West from the East quarter corner of Section 4, Township 1 South, Range 1 East
- Proposed Additional POA (SB2 Supply Well 2)**
Located 392 feet North and 1,148 feet West from the East quarter corner of Section 4, Township 1 South, Range 1 East