

T.4S. R.1W. Section 15, W.M. Amended T-11302 Application Map

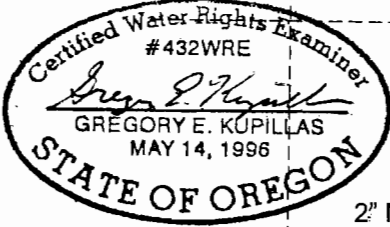

EXPIRATION DATE: 6/30/2013

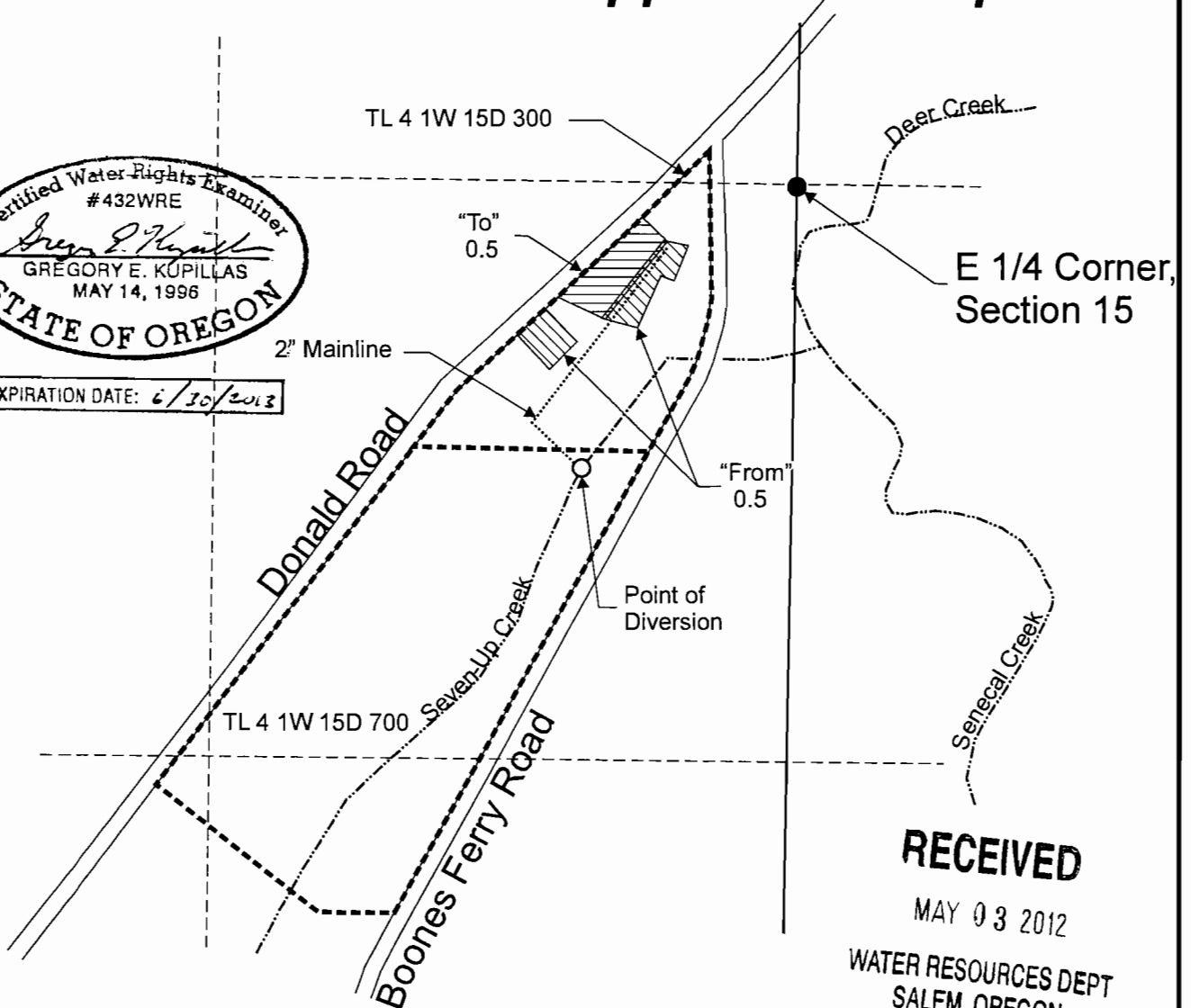

RECEIVED

MAY 03 2012

WATER RESOURCES DEPT
SALEM, OREGON

Point of diversion is located 650 feet south and 500 feet west from the E 1/4 corner of Section 15.

- "From" areas (0.5 acres) irrigated under Certificate 9726 affected by this transfer.
- "To" areas (0.5 acres), to be irrigated under Transfer T-11302.
- Tax lot boundary
- Irrigation Mainlines

Scale: 1" = 400'

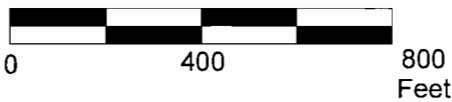

This map was prepared for the purpose of identifying the location of a water right only and is not intended to provide legal dimensions or location of property ownership lines.



Ingle Transfer.cdr

Pacific Hydro-Geology Inc.

Amended T-11302 Application Map
Certificate 9726

Jerry and Jean Ingle
T.4S. R.1W. Section 15, W.M.

5/2011-bgp