

# T.5S., R.5W., W.M.

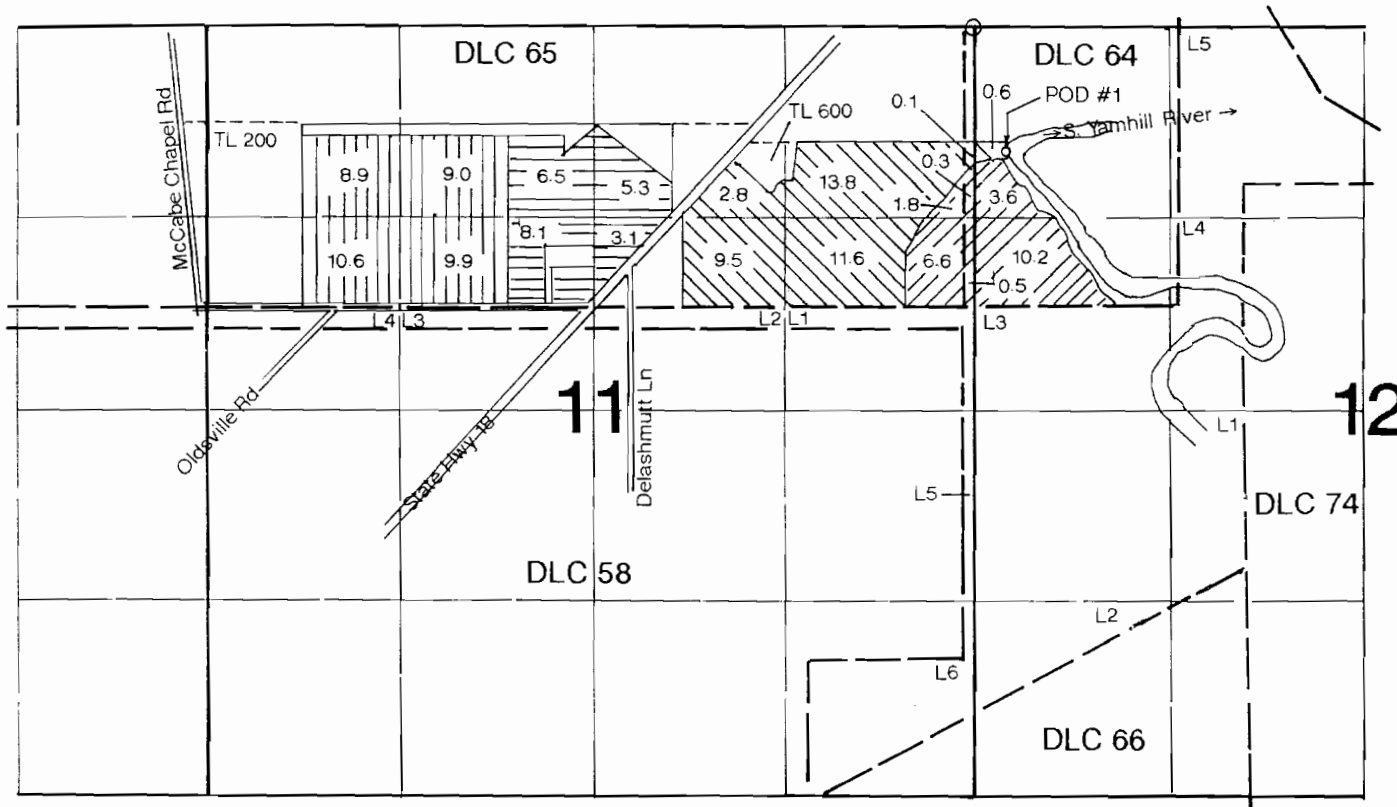

POD #1 is located 850'S & 180'E from NW corner of Section 12.

## Application Map

# John G. Bernards

Transfer #:

**RECEIVED**

MAY 30 2012

WATER RESOURCES DEPT  
SALEM, OREGON

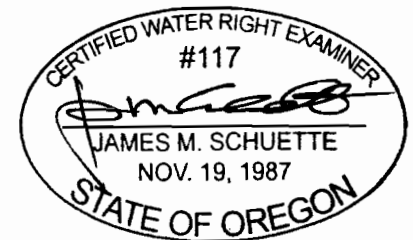

EXPIRES: 6/30/2012

This Map was Prepared for the Purpose of Identifying the Location of a Water Right Only and is Not Intended to Provide Legal Dimensions or Location of Property Ownership Lines.