

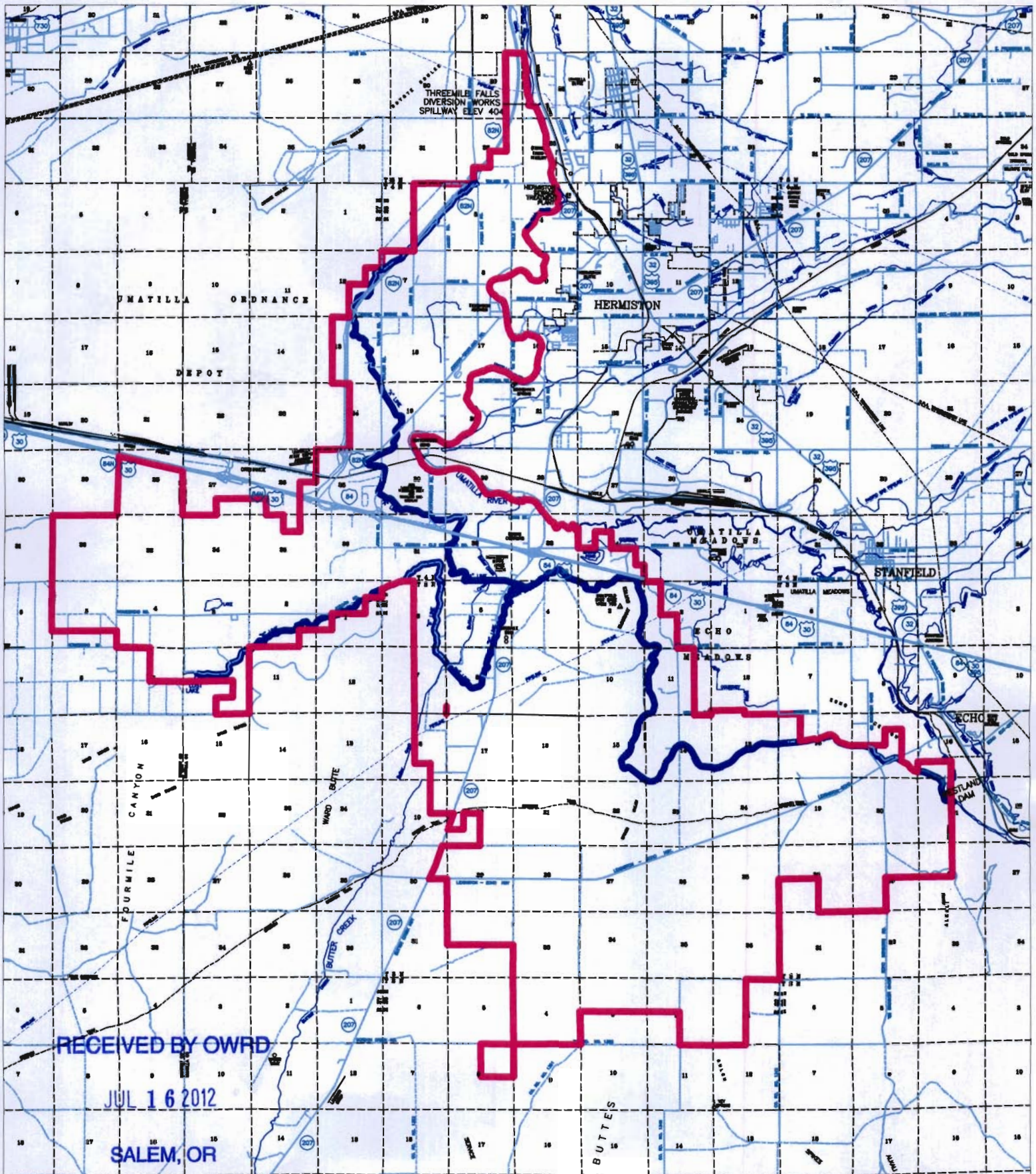

Westland Irrigation District Boundary









LEGION:  DISTRICT BOUNDARY

1011446

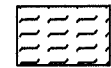

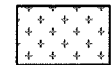
WESTLAND IRRIGATION DISTRICT
SERVICE BOUNDARY

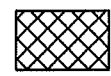
WESTLAND IRRIGATION DISTRICT 2012 TEMPORARY TRANSFER PRIOR-PRIOR 3N 28E & 3N 29E

-  FROM: 98.8 acres primary certificate 76715 & supplemental certificate 79439.
-  TO: 92.5 acres primary certificate 76715 & supplemental certificate 79439. Existing certificates 76050 and 81784 on to ground (see T-9844) diminished to supplemental to incoming certificate 76715 for 2012 season.
-  TO: 5.8 acres primary certificate 76715 & supplemental certificate 79439. Existing certificate 81784 on to ground diminished to supplemental to incoming certificate 76715 for 2012 season.
-  TO: 0.5 acre (NE SE section 15, 3N, 28E) primary certificate 76715 & supplemental certificate 79439.
-  FROM: 1.0 acre primary & supplemental certificate 76799.
-  TO: 1.0 acre primary & supplemental certificate 76799. Existing certificate 81784 on to ground diminished to supplemental to incoming certificate 76799 for 2012 season.
-  Certificates 76715 & 79439 in sections 14 & 15 not involved with this transfer.
-  Certificate 76799 in NE 1/4 SE 1/4 of section 15 not involved with this transfer.

T3N., R 29E., W.M.

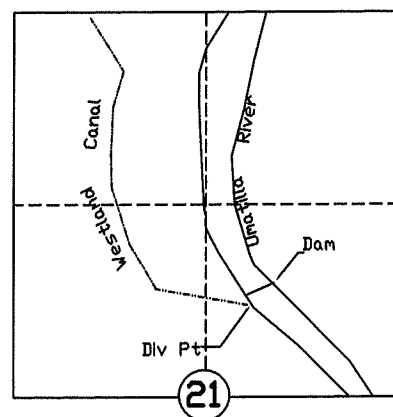

RECEIVED BY OWRD
JUL 16 2012
SALEM, OR

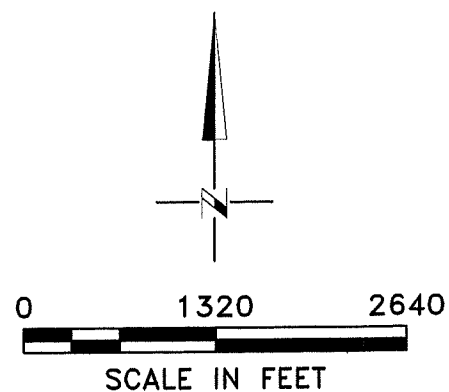





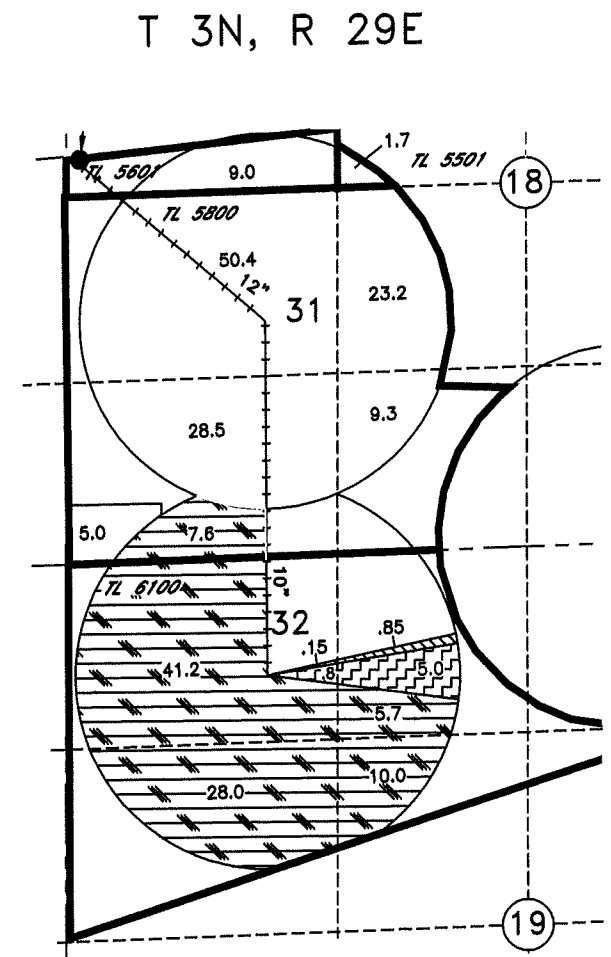
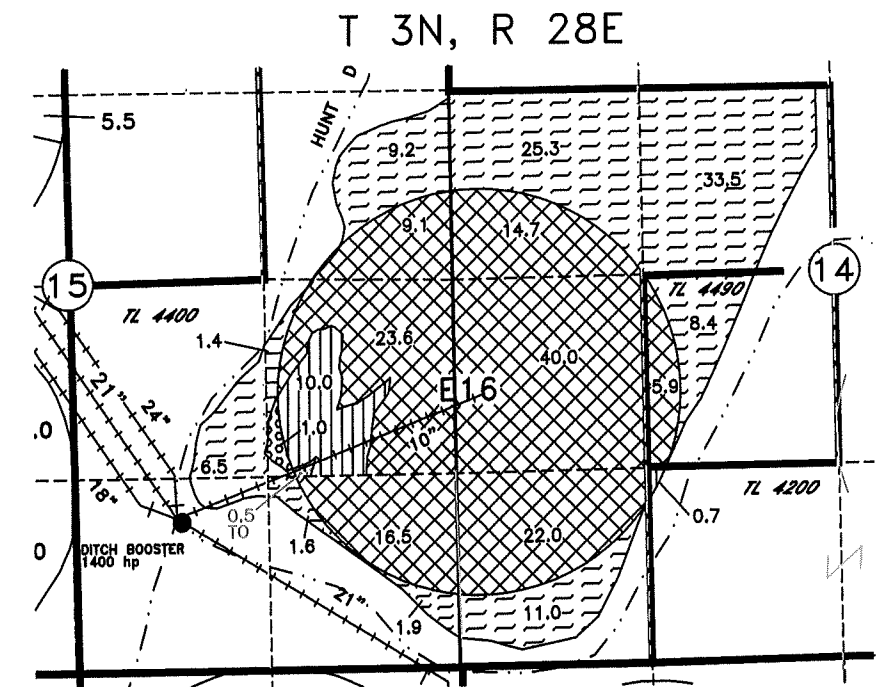

T011446

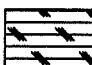
NOTE: THE PURPOSE OF THIS MAP IS TO IDENTIFY THE APPROXIMATE LOCATION OF THE WATER RIGHT. IT IS NOT INTENDED TO PROVIDE INFORMATION RELATIVE TO THE LOCATION OF PROPERTY OWNERSHIP BOUNDARY LINES.

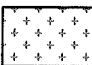

WESTLAND IRRIGATION DISTRICT 2012 TEMPORARY TRANSFER PRIOR-PRIOR 3N 28E & 3N 29E

-  FROM: 98.8 acres primary certificate 76715 & supplemental certificate 79439.
-  TO: 92.5 acres primary certificate 76715 & supplemental certificate 79439. Existing certificates 76050 and 81784 on to ground (see T-9844) diminished to supplemental to incoming certificate 76715 for 2012 season.
-  TO: 5.8 acres primary certificate 76715 & supplemental certificate 79439. Existing certificate 81784 on to ground diminished to supplemental to incoming certificate 76715 for 2012 season.
-  TO: 0.5 acre (NE SE section 15, 3N, 28E) primary certificate 76715 & supplemental certificate 79439.
-  FROM: 1.0 acre primary & supplemental certificate 76799.
-  TO: 1.0 acre primary & supplemental certificate 76799. Existing certificate 81784 on to ground diminished to supplemental to incoming certificate 76799 for 2012 season.
-  Certificates 76715 & 79439 in sections 14 & 15 not involved with this transfer.
-  Certificate 76799 in NE 1/4 SE 1/4 of section 15 not involved with this transfer.

T3N., R 29E., W.M.

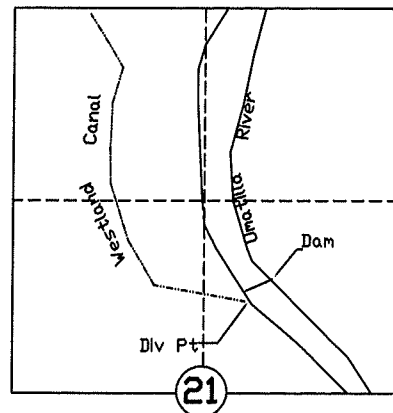

RECEIVED BY OWRD
JUL 16 2012
SALEM, OR

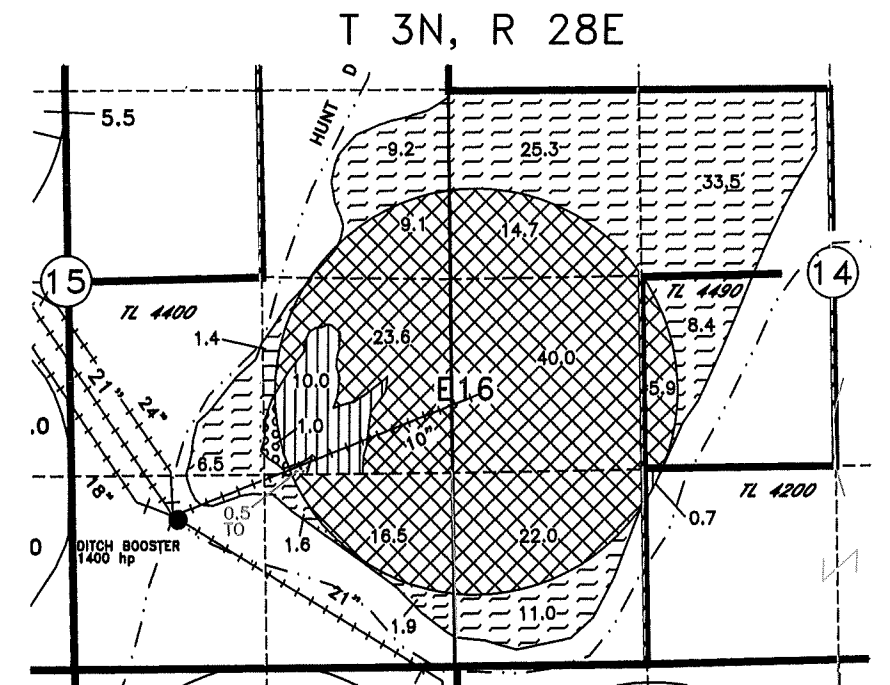
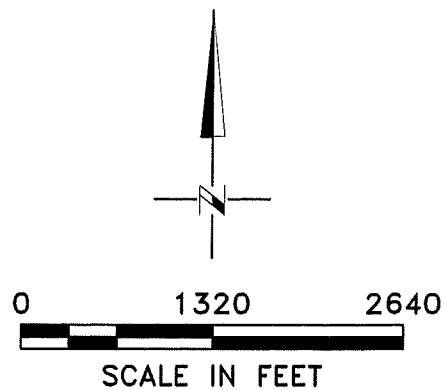

T 3N, R 29E

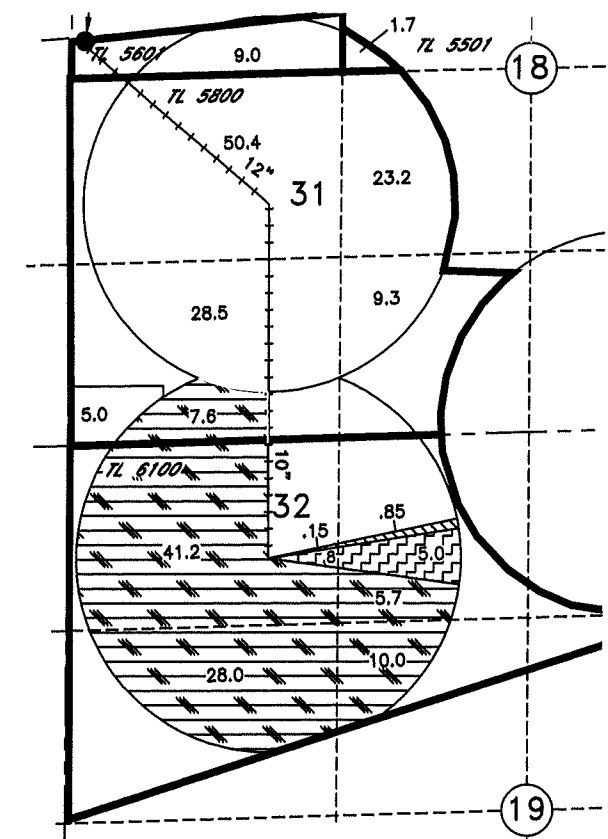

RECEIVED BY OWRD

JUL 16 2012

SALEM, OR

CHESTER PRIOR DBA EAGLE RANCH DISTRIBUTION SYSTEM

T 2N & T 3N RANGE 28 E.W.M.

T.3N., R.29E., W.M.

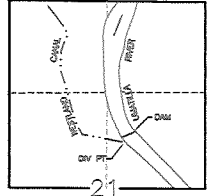

AUTHORIZED P.O.D. PERMIT 25920 CERT 75050
DIV PT LCT N76°45'56"E 2913.19' FROM W1/4 COR SEC 21
AUTHORIZED P.O.D. PERMIT 48450
DIV PT LCT S55°48'W 3237.3' FROM NE COR SEC 21

AUTHORIZED WELLS FOR CERTIFICATE NUMBER 75129 ARE LOCATED AS FOLLOWS:
WELL 2 - 750 FEET SOUTH AND 2620 FEET WEST FROM NE CORNER SECTION 36;
WELL 3 - 1780 FEET NORTH AND 2600 FEET WEST FROM SE CORNER SECTION 36;
WELL 5 - 770 FEET SOUTH AND 2640 FEET EAST FROM NW CORNER SECTION 35;
WELL 6 - 1940 FEET NORTH AND 2540 FEET EAST FROM SW CORNER SECTION 35'

AUTHORIZED WELLS FROM CERTIFICATE NUMBER 75127 ARE LOCATED AS FOLLOWS:
WELL 4 - 2640 FEET SOUTH AND 630 FEET WEST FROM NW1/4 CORNER SECTION 1;
WELL 7 - 2500 FEET SOUTH AND 2580 FEET EAST FROM NW CORNER SECTION 2;
WELL 8 - 2800 FEET SOUTH AND 500 FEET WEST FROM NE CORNER SECTION 2

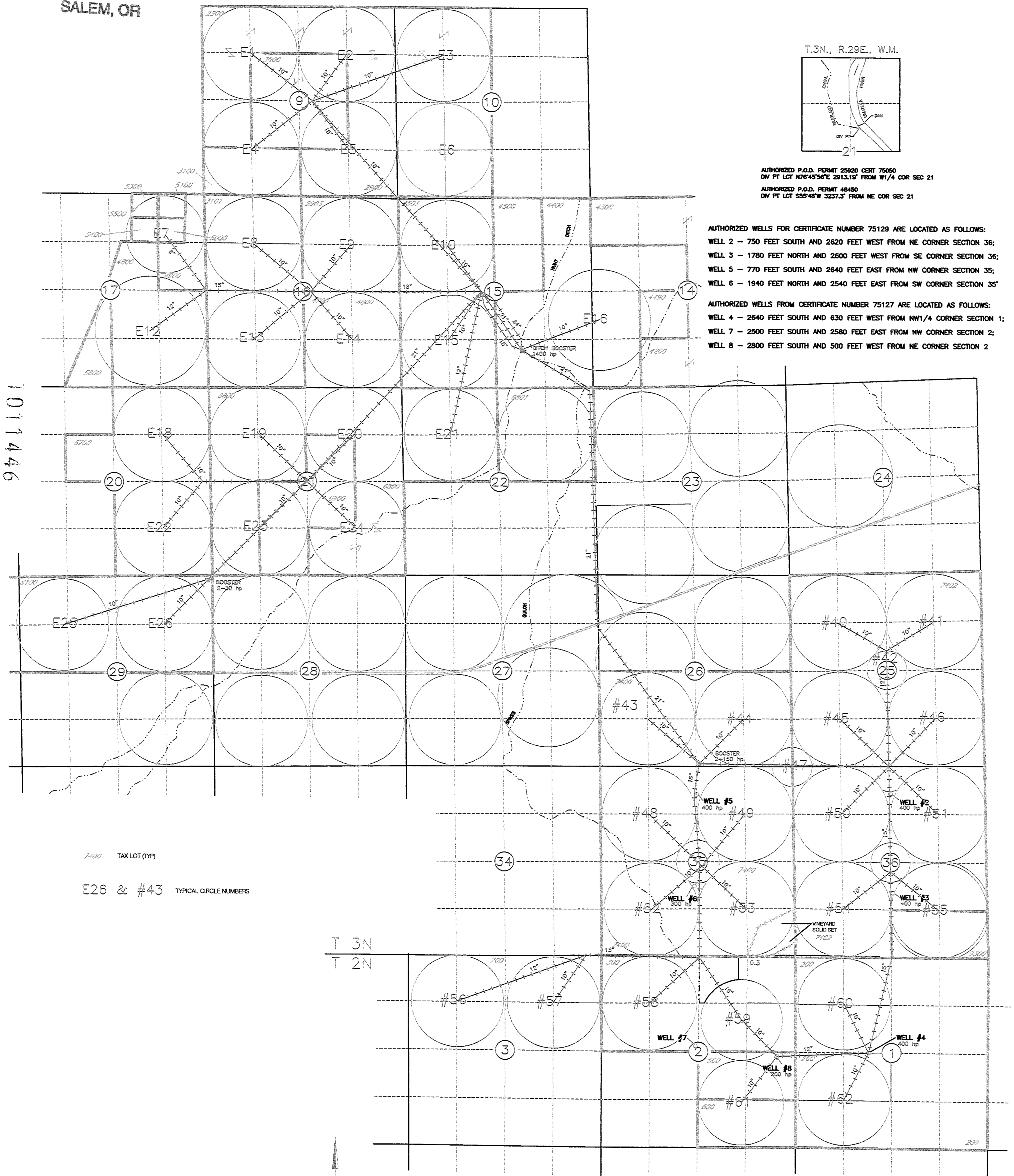

1011446

7400 TAX LOT (TYP)

E26 & #43 TYPICAL CIRCLE NUMBERS

T 3N
T 2N

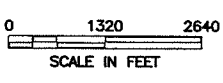

NOTES:
THE PURPOSE OF THIS MAP IS TO IDENTIFY THE APPROXIMATE LOCATION OF THE WATER RIGHT. IT IS NOT INTENDED TO PROVIDE INFORMATION RELATIVE TO THE LOCATION OF PROPERTY OWNERSHIP BOUNDARY LINES.