

T.4S., R.3W., W.M.

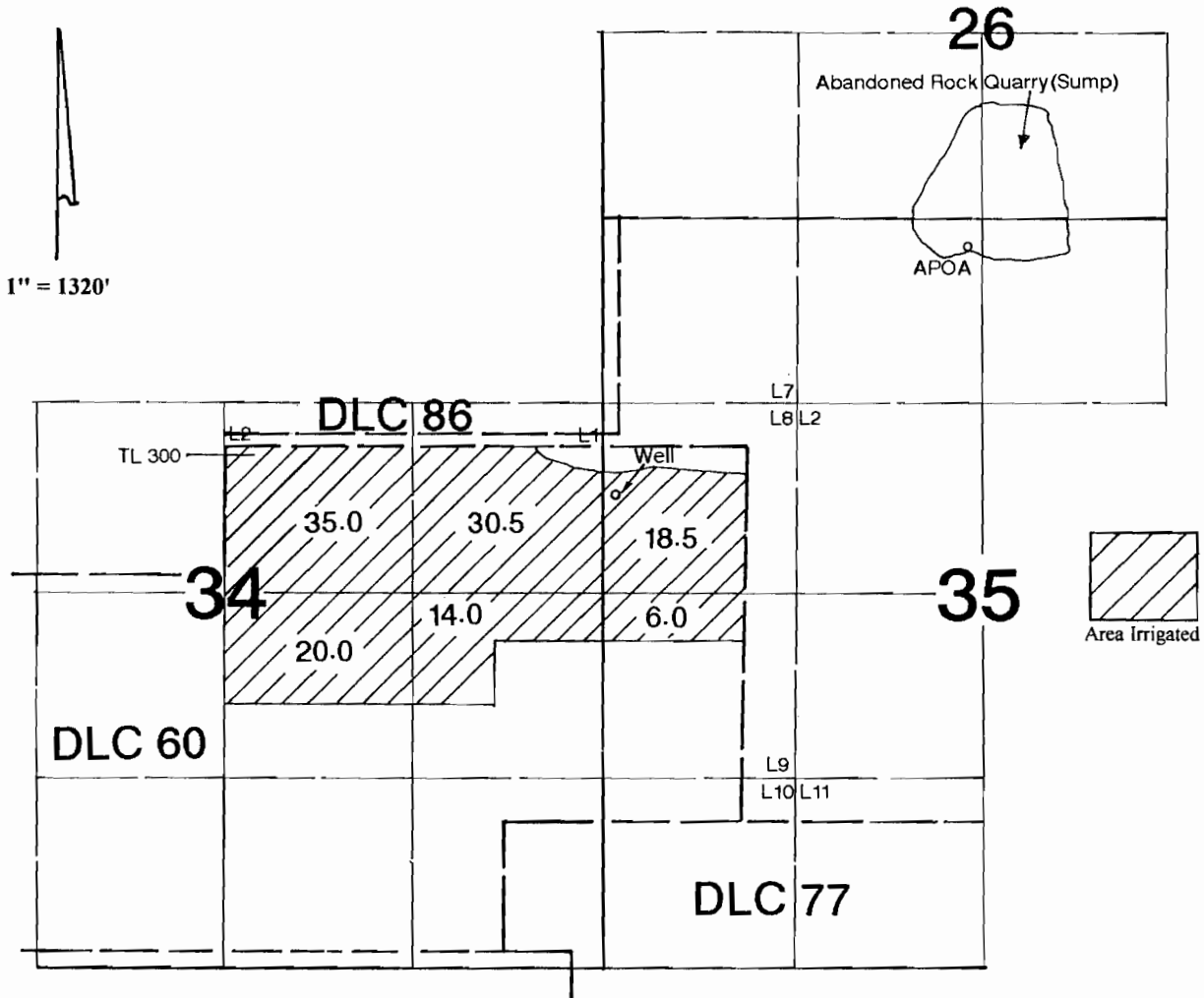

APOA is located 240'S & 2620'E from the NW corner of Section 35.
 Well is located 1915'S & 110'E from the NW corner of Section 35.

Application Map

Slegers, Inc.

Transfer #:

RECEIVED

DEC 07 2012

WATER RESOURCES DEPT
 SALEM, OREGON

This Map was Prepared for the Purpose of Identifying the Location of a Water Right Only and is Not Intended to Provide Legal Dimensions or Location of Property Ownership Lines.

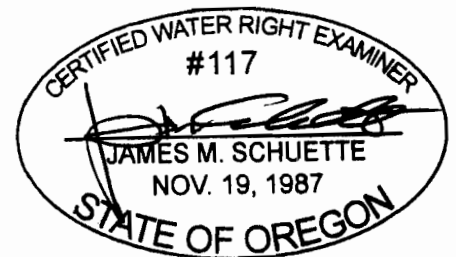

EXPIRES: 6/30/2014