

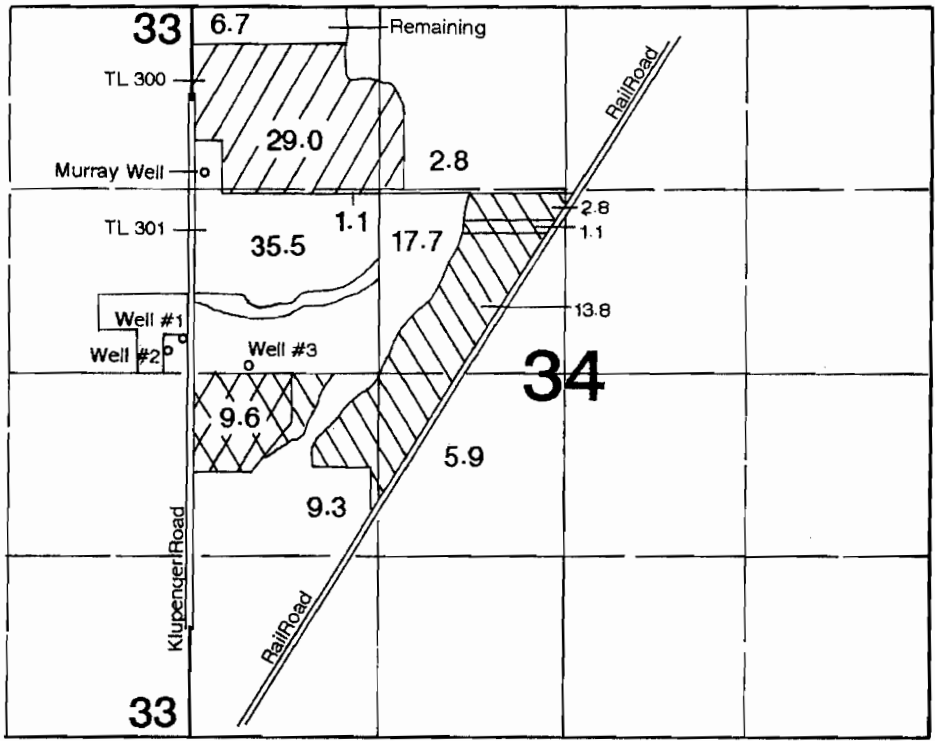



T.3S., R.1W., W.M.



Transfer From
 Cert. #83504 (Well #3)
 Cert. #84230 (Murray Well)

Transfer To
 Cert. #83504 (Well #3)
 Cert. #84230 (Murray Well)

Change in POA
 Cert. #56068
 (Well #1 & #2 to Well #3)

Well #1 is located 260'N & 30'W from the E-1/4 corner of Section 33.
 Well #2 is located 150'N & 190'W from the E-1/4 corner of Section 33.
 Well #3 is located 10'N & 352'E from the W-1/4 corner of Section 34.
 Murray Well is located 147'N & 132'E from the NW corner of SWNW, Section 34.

Application Map

Klupenger Nursery

Transfer #:

RECEIVED

DEC 19 2012

WATER RESOURCES DEPT
 SALEM, OREGON

This map was prepared for the purpose of identifying the location of a water right only and is not intended to provide legal dimensions or location of property ownership lines.

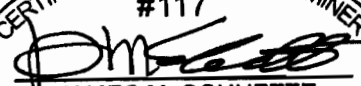
CERTIFIED WATER RIGHT EXAMINER
 #117

 JAMES M. SCHUETTE
 NOV. 19, 1987
 STATE OF OREGON

EXPIRES: 6/30/2014