

T4S, R2W, WM
MARION COUNTY

TAX LOTS:
4 2W 15 200
400
4 2W 15 300

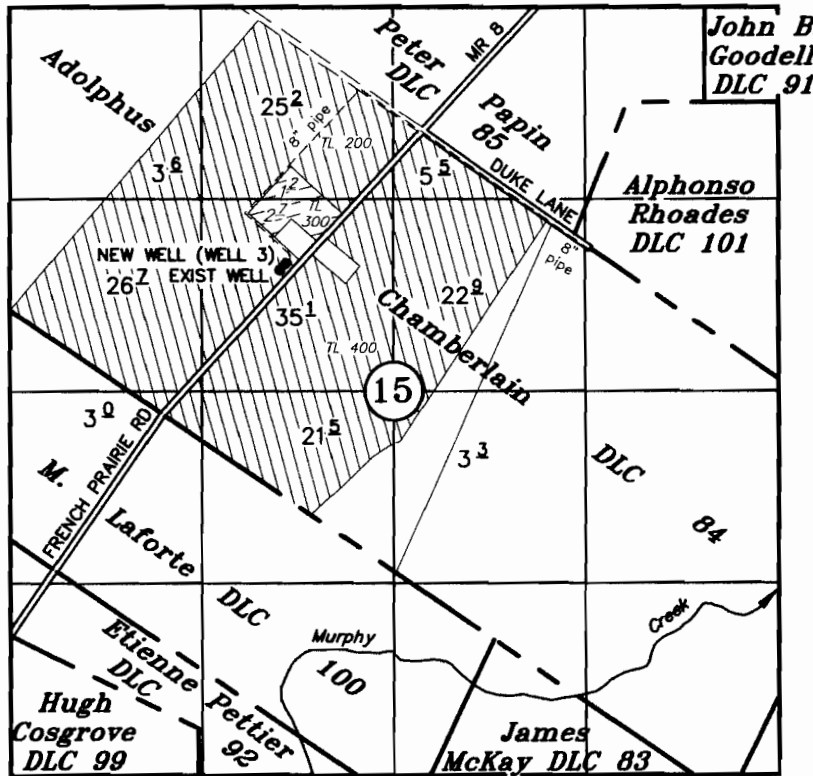

EXISTING WELL: N55°W 1306.8' & S42°35'W 1393.0' & N47°35'W 75.0' FROM S.S.E. COR PETER PAPIN DLC (GR) 1320' N AND 4220' W OF THE NE COR ADOLPHUS CHAMBERLAIN DLC 84 (CBU FILE G-11990)
NEW WELL (WELL 3): 1355' N AND 4180' W OF THE NE COR ADOLPHUS CHAMBERLAIN DLC 84

Groundwater Registration Modification

(Melvin R. DuRette)

UNDER

Registration No. GR-190 Certificate No. GR-176

IN THE NAME OF

A & R Spada Farms, LLC

MARCH 20, 2013

SCALE: 1" = 1320'

RECEIVED

MAR 26 2013

WATER RESOURCES DEPT
SALEM, OREGON

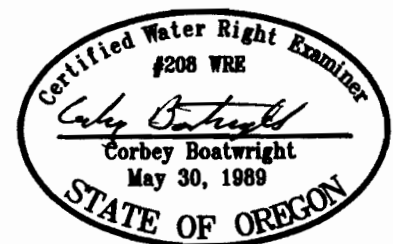

NOTE: This map is not intended to provide legal dimensions or locations of property ownership lines.

Renewal Date: December 31, 2013