

T4S, R2W, WM
MARION COUNTY

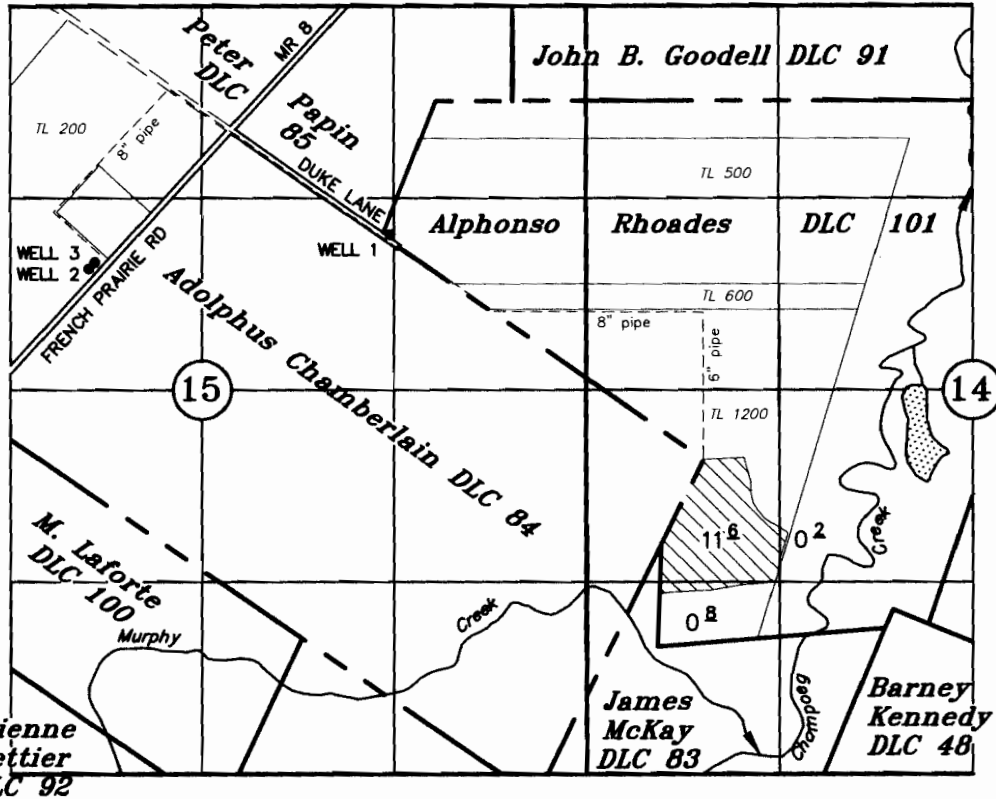

TAX LOTS:
4 2W 15 200
4 2W 14 500
4 2W 14 600
4 2W 14 1200

EXISTING WELL 1: 1545' N AND 2150' W OF THE NE COR ADOLPHUS CHAMBERLAIN DLC 84
EXISTING WELL 2: 1320' N AND 4220' W OF THE NE COR ADOLPHUS CHAMBERLAIN DLC 84
(NEW) WELL 3: 1355' N AND 4180' W OF THE NE COR ADOLPHUS CHAMBERLAIN DLC 84

Application to Transfer a Water Right

Certificate No. 85663 UNDER Transfer No. T-

IN THE NAME OF
A & R Spada Farms, LLC

MARCH 20, 2013
SCALE: 1" = 1320'

RECEIVED

MAR 26 2013

WATER RESOURCES DEPT
SALEM, OREGON

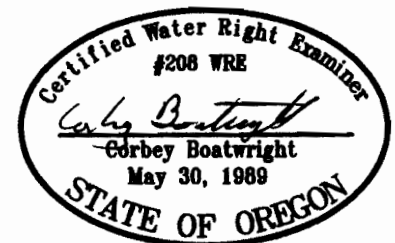

NOTE: This map is not intended to provide legal dimensions or locations of property ownership lines.

Renewal Date: December 31, 2013