

2013 ECHO IRRIGATION DISTRICT - COPPINGER TEMPORARY TRANSFER T3N, R29E & R30E, WM

P.O.A. AS
REFERENCED IN
APPLICATION

WELL LEGEND

AUTHORIZED

C1 (OLD) COPPINGER NO 1 20'N + 1570'W FROM E1/4 COR, SEC 24 T3N R 29E W.M.**

ADDITIONAL

C1 COPPINGER NO 1 20'N + 1490'W FROM E1/4 COR, SEC 24 T3N R 29E W.M.**

D1 DITCHENS NO 1 30'S AND 640'W FROM THE CENTER OF SEC 30 T3N R 30E W.M.

D2 DITCHENS NO 2 80'E FROM THE SW CORNER OF SEC 20 T3N R 30E W.M.

C3 COPPINGER NO 3 3960'N + 1320'W FROM SE COR, SEC 23 T3N R 29E W.M.

** NEW LOCATION OF COPPINGER WELL NO 1
FLOW METERS ARE LOCATED AT THE WELLS

#8 CIRCLE NUMBER (TYPICAL)

8" EXISTING PIPE AND SIZE

(702) TAX LOT NUMBER

— ECHO IRRIGATION DISTRICT BOUNDARY

FROM	TO
227.1 AC FROM COPPINGER PERMIT NO G-6626 CERT 80849 TO COPPINGER AND HALE	 COPPINGER WELLS 1* & 3* DITCHENS WELLS 1* & 2*

* ADDITIONAL P.O.A. THIS TEMPORARY TRANSFER

AREAS OF EXISTING WATER RIGHTS NOT INCLUDED IN THIS TRANSFER

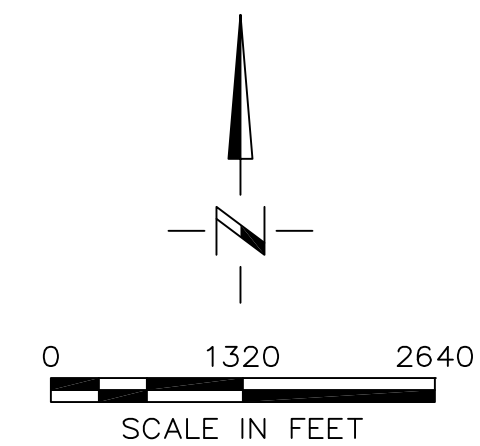

NOTE:
THE PURPOSE OF THIS MAP IS TO IDENTIFY THE APPROXIMATE LOCATION OF THE WATER RIGHT. IT IS NOT INTENDED TO PROVIDE INFORMATION RELATIVE TO THE LOCATION OF PROPERTY OWNERSHIP BOUNDARY LINES.

13.6 ACRES ADDITIONAL WATER RIGHT WILL BE TRANSFERRED TO THIS CIRCLE UNDER A SEPARATE DISTRICT TRANSFER.

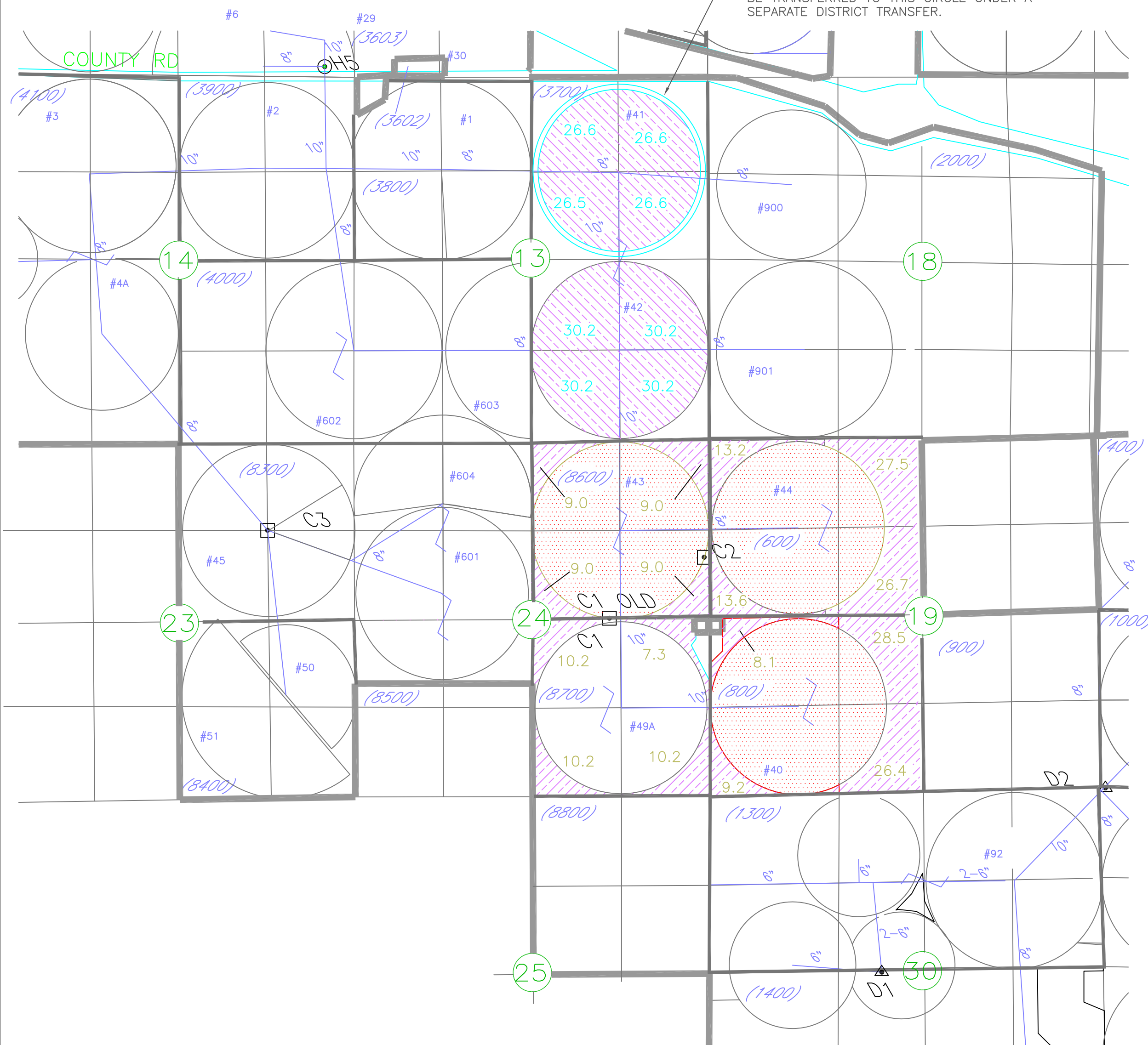

R. 29 E. WM
R. 30 E. WM