



Township 24 South. Range 18 East. W.M.

TRANSFERRED
FROM

 - G-9974

 - G-10326

Well # 1 - Located
SE 1/4 SW 1/4, SEC 35,
T 24S, R 18E, W.M.;
1250' N & 1320' E from the
SW corner, SEC 35.

Well # 2 - Located
NW 1/4 NW 1/4, SEC 35,
T 24S, R 18E, W.M.;
1200' S & 1250' E from the
NW corner, SEC 35.

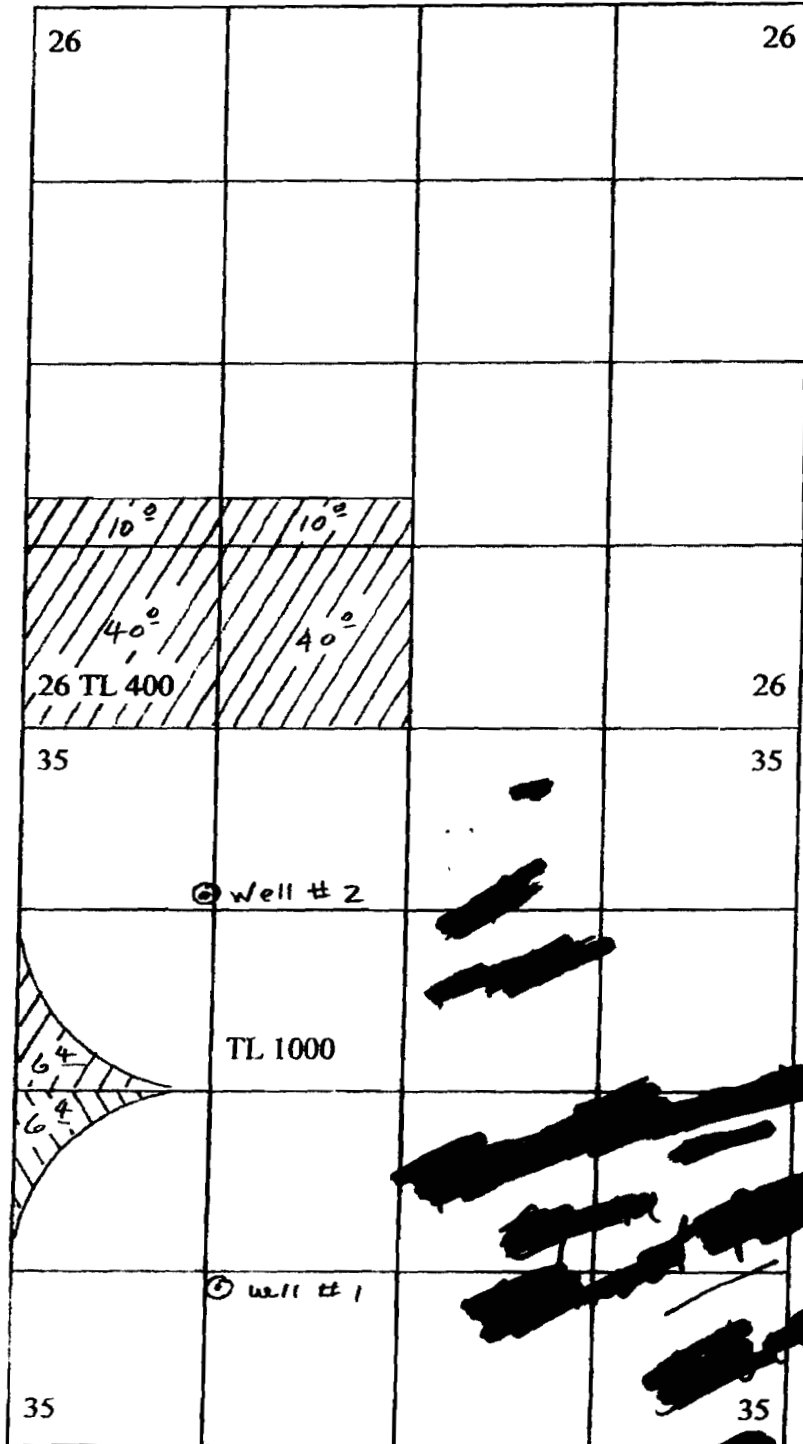

Scale - 1" = 1320'

RECEIVED

APR 22 2013

WATER RESOURCES DEPT
SALEM, OREGON

T011581

T 27 S, R 15 E
SECTION 10
TAX LOT 1300

"TO"

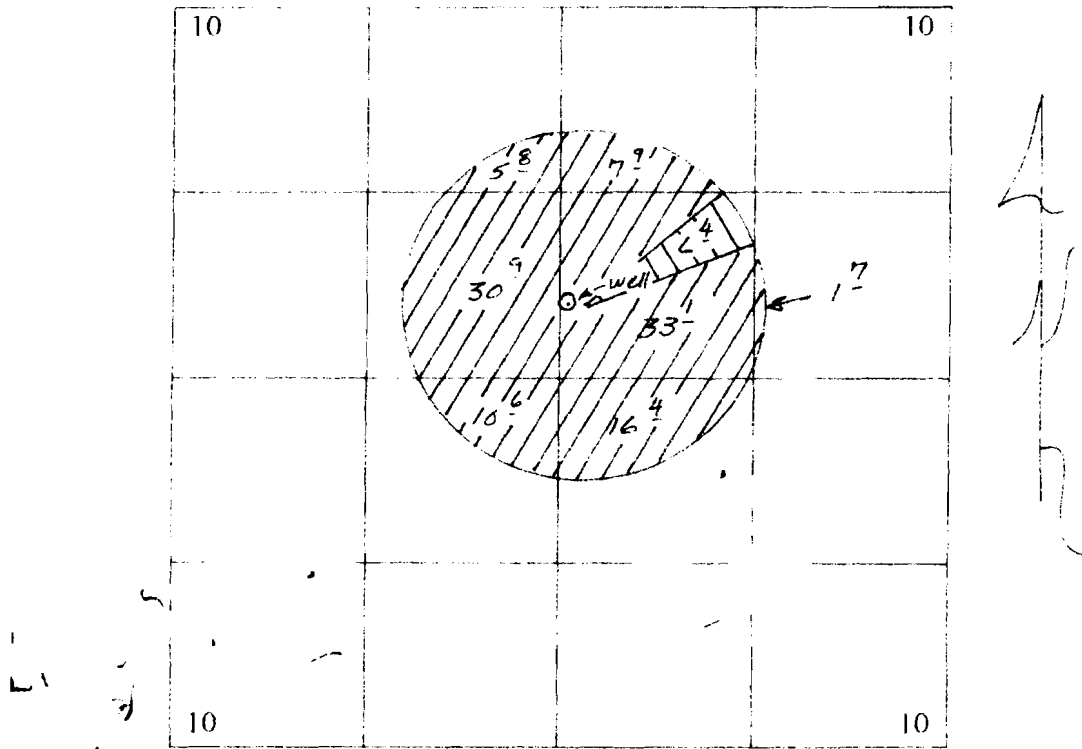

Scale - 1" = 1320'

Proposed POA - 2130' S & 2715' E from the NW Corner, Sec 10
Being in the SW $\frac{1}{4}$ NE $\frac{1}{4}$, Section 10

C 80220 - G-10326 

C 80221 - G-9974 

RECEIVED

APR 22 2013

WATER RESOURCES DEPT
SALEM, OREGON

1011531