

Temporary Transfer Application Map for Howard Brownson, Jr.

Scale: 1" = 1,320 ft.

Permit 6647 - Certificate 39246

T.29S. R.4W. W.M.

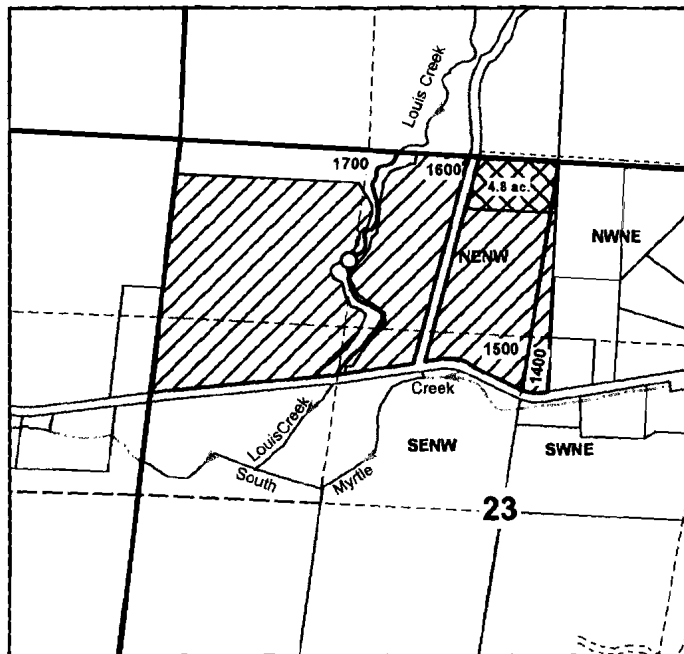
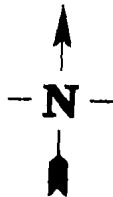

Transfer from



- Point of Diversion
830' South and
1250' East from the
Northwest Corner of
Section 23

T.29S. R.4W. W.M.

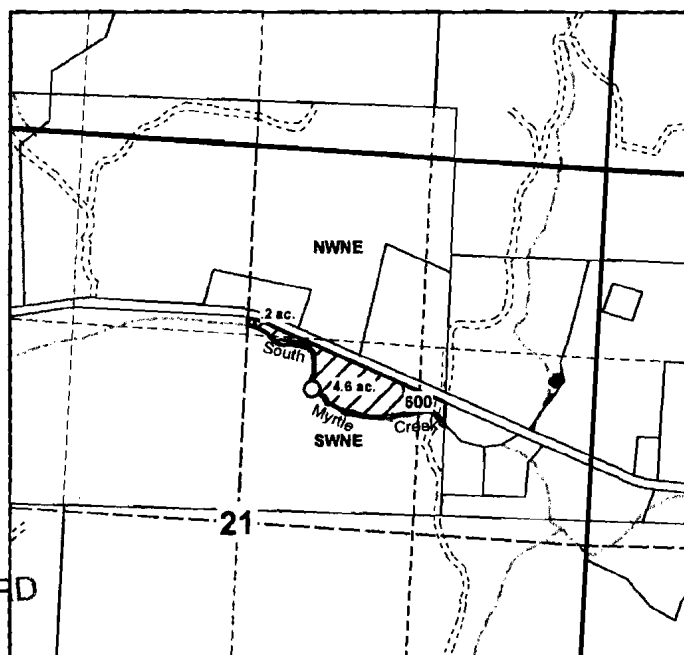
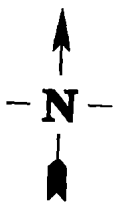

Transfer to

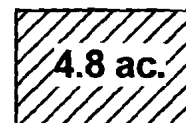

- Point of Diversion
940' North and
460' East from the
Center of Section 21

RECEIVED BY OWRD

APR 23 2013

SALEM, OR

1011583