

0 660 1,320 2,640 3,960 5,280 Feet

1" = 1320'

# T 20 S, R 36 E, WM SECTION 4 HARNEY COUNTY, OREGON

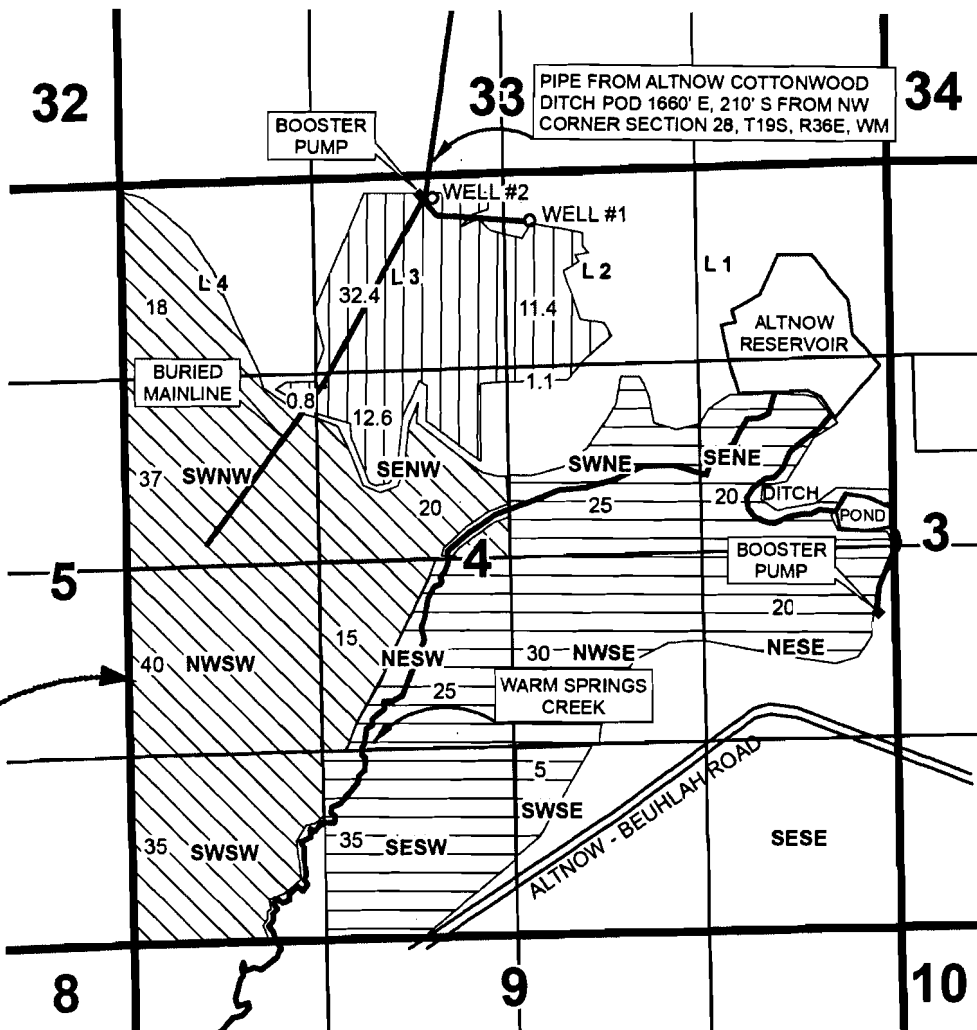

RECEIVED BY OWRD

OCT 21 2013

SALEM, OR

**NOTE: WATER RIGHTS LEFT UNCHANGED IN NWSW QQ OF SECTION 4.**

WELL #1 - 375' S, 200' E FROM SECTION 4 N 1/4 CORNER  
WELL #2 - 180' S, 500' W FROM SECTION 4 N 1/4 CORNER

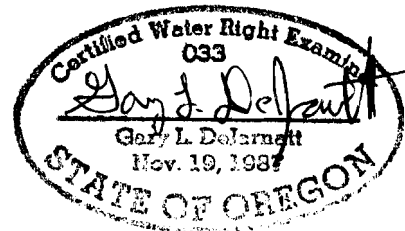

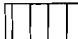
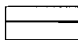
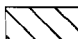
-  26367 - 1946 GROUNDWATER PRIMARY
-  6847 - 1883 WARM SPRINGS SURFACE & STORAGE
-  6847 - 1885 COTTONWOOD CREEK SURFACE

RENEWAL DATE 12-31-2013

1011676

**TRANSFER PRIMARY OFF MAP  
for COTTONWOOD CREEK RANCH**

PROJECT # 13061      JULY 24, 2013

This map is not intended to provide legal dimensions or locations of property ownership lines.

**WATER RIGHT SERVICES, LLC**

PO BOX 1830, BEND, OR 97709

WWW.OREGONWATER.US 541-389-2837

johnshort@usa.com

0 660 1,320 2,640 3,960 5,280 Feet

# T 20 S, R 36 E, WM SECTION 4 HARNEY COUNTY, OREGON

1" = 1320'

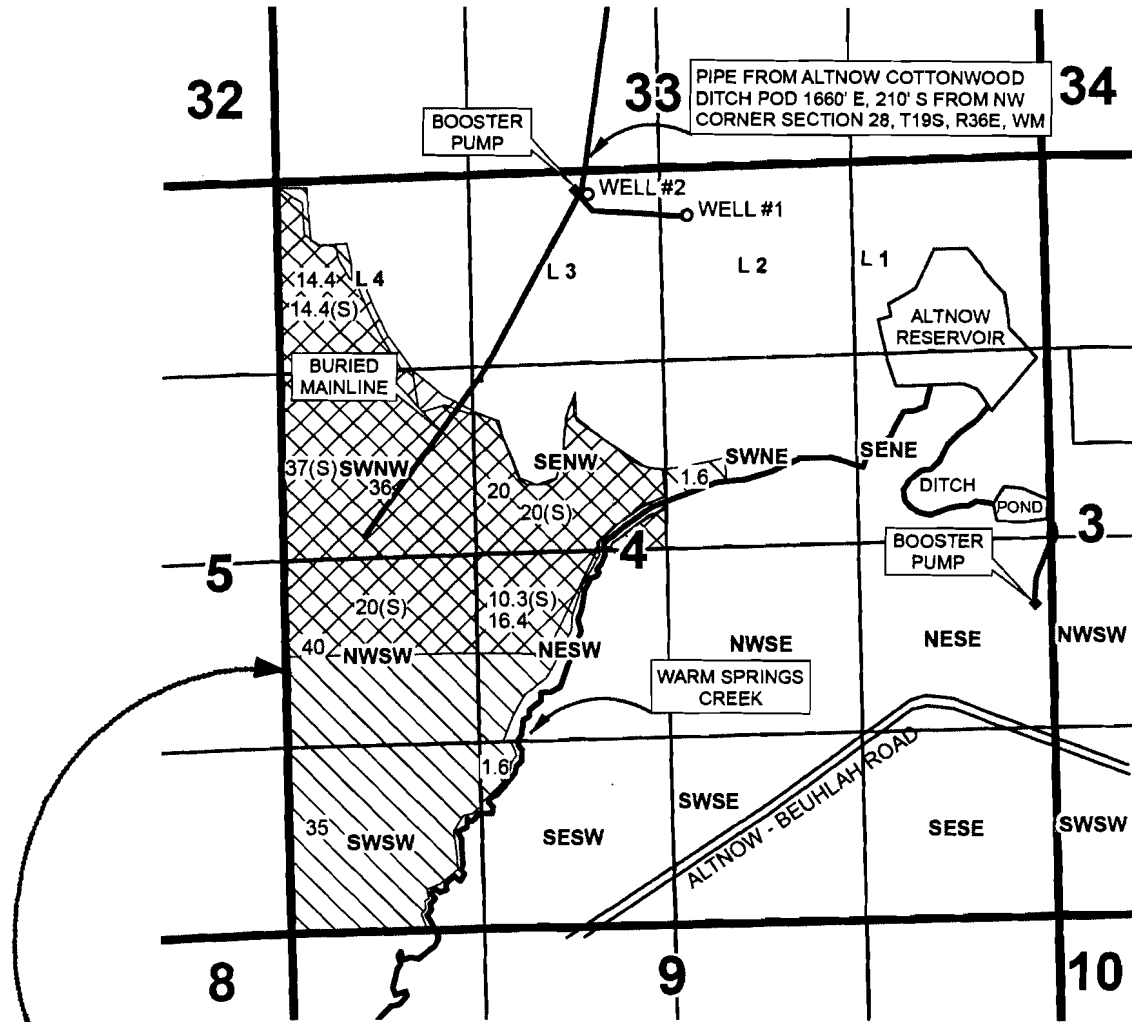

RECEIVED BY OWRD

OCT 21 2013

SALEM, OR

**NOTE: WATER RIGHTS LEFT UNCHANGED IN NWSW QQ OF SECTION 4.**

WELL #1 - 375' S, 200' E FROM SECTION 4 N 1/4 CORNER  
WELL #2 - 180' S, 500' W FROM SECTION 4 N 1/4 CORNER

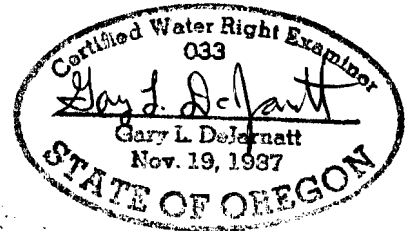

 79377 - 1959 COTTONWOOD CREEK STORAGE

 26367 - 1946 GROUNDWATER SUPPLEMENTAL (S) 011676

**RENEWAL DATE 12-31-2013**

**TRANSFER SUPPLEMENTAL OFF MAP  
for COTTONWOOD CREEK RANCH**

PROJECT # 13061

JULY 24, 2013

This map is not intended to provide legal dimensions or locations of property ownership lines.

**WATER RIGHT SERVICES, LLC**

PO BOX 1830, BEND, OR 97709

WWW.OREGONWATER.US 541-389-2837

johnshort@usa.com

0 660 1,320 2,640 3,960 5,280 Feet

1" = 1320'



# T 20 S, R 36 E, WM SECTIONS 3 & 4 HARNEY COUNTY, OREGON

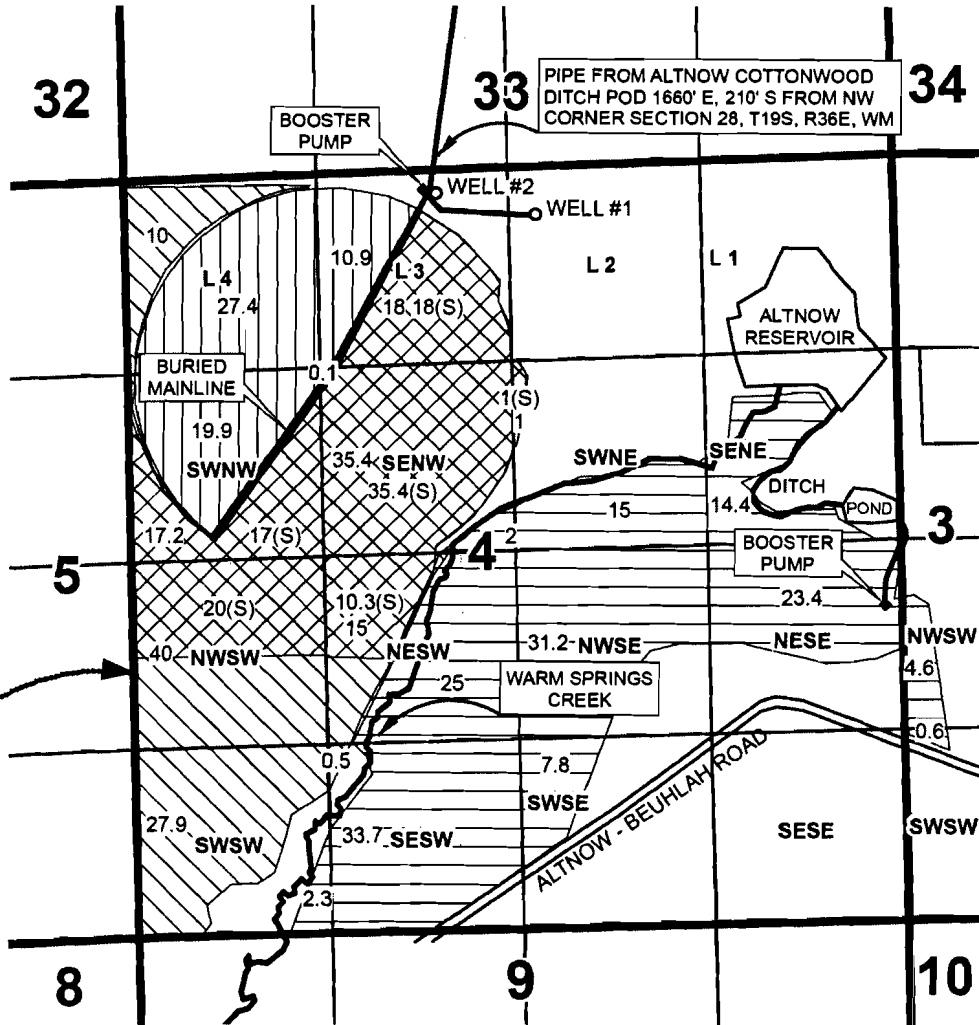

PIPE FROM ALTNOW COTTONWOOD DITCH POD 1660' E, 210' S FROM NW CORNER SECTION 28, T19S, R36E, WM

RECEIVED BY OWRD  
OCT 21 2013  
SALEM, OR

**NOTE: WATER RIGHTS LEFT UNCHANGED IN NWSW QQ OF SECTION 4.**

WELL #1 - 375' S, 200' E FROM SECTION 4 N 1/4 CORNER  
WELL #2 - 180' S, 500' W FROM SECTION 4 N 1/4 CORNER

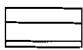
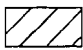
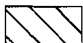
-  26367 - 1946 GROUNDWATER PRIMARY "ON"
-  6847 - 1883 WARM SPRINGS CREEK & STORAGE "ON"
-  26367 - 1946 GROUNDWATER SUPPLEMENTAL "ON"
-  6847 / 79377 - COTTONWOOD 1885 SURFACE / 1959 STORAGE "ON"

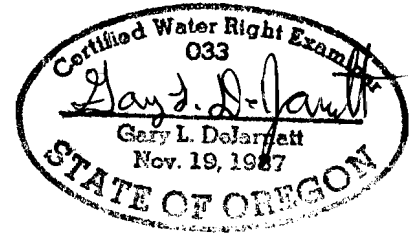

1011676 RENEWAL DATE 12-31-2013

<p><b>TRANSFER "ON" MAP for COTTONWOOD CREEK RANCH</b></p> <p>PROJECT # 13061      JULY 24, 2013</p>	<p>This map is not intended to provide legal dimensions or locations of property ownership lines.</p>	<p><b>WATER RIGHT SERVICES, LLC</b> PO BOX 1830, BEND, OR 97709 <a href="http://WWW.OREGONWATER.US">WWW.OREGONWATER.US</a> 541-389-2837 johnshort@usa.com</p>
--	---	---