

T.3S., R.2W., W.M.

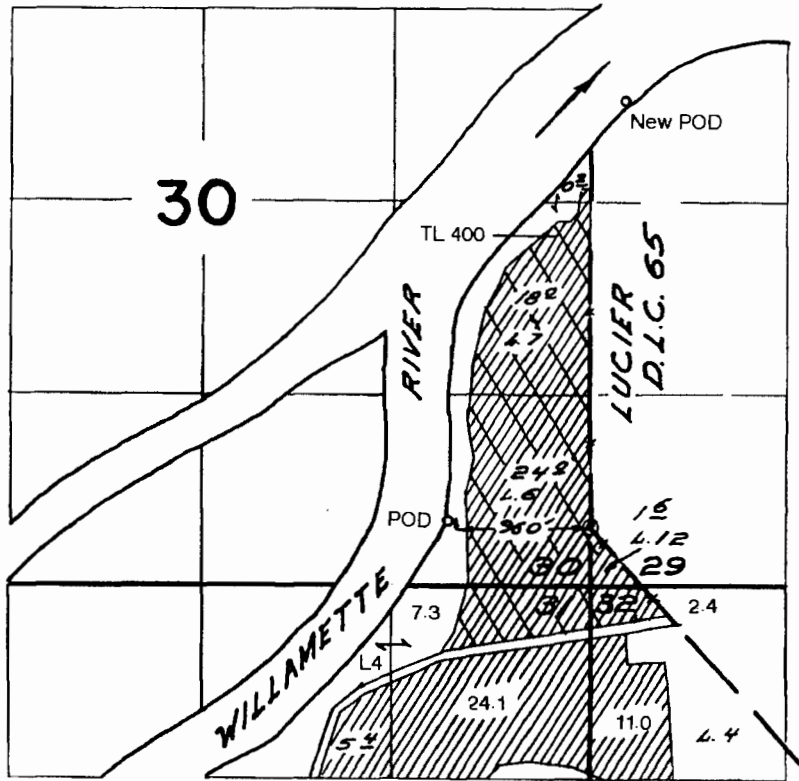

1" = 1320'

Area Involved Under This Transfer

RECEIVED
JAN 29 2014
WATER RESOURCES DEPT
SALEM, OREGON

POD is located 40'N & 960'W from the most-westerly SW corner of DLC 65.
New POD is located 2770'N & 230'E from the NW corner of Lot 12, Section 29.

Application Map

KCK Partners LLC

Transfer #:

This map was prepared for the purpose of identifying the location of a water right only and is not intended to provide legal dimensions or location of property ownership lines.

CERTIFIED WATER RIGHT EXAMINER
#117
James M. Schuette
JAMES M. SCHUETTE
NOV. 19, 1987
STATE OF OREGON

EXPIRES: 6/30/2014