

**RECEIVED**

136S., R.1W., W.M.  
Jackson County, Oregon

SEP 25 1997

WATER RESOURCES DEPT.  
SALEM, OREGON

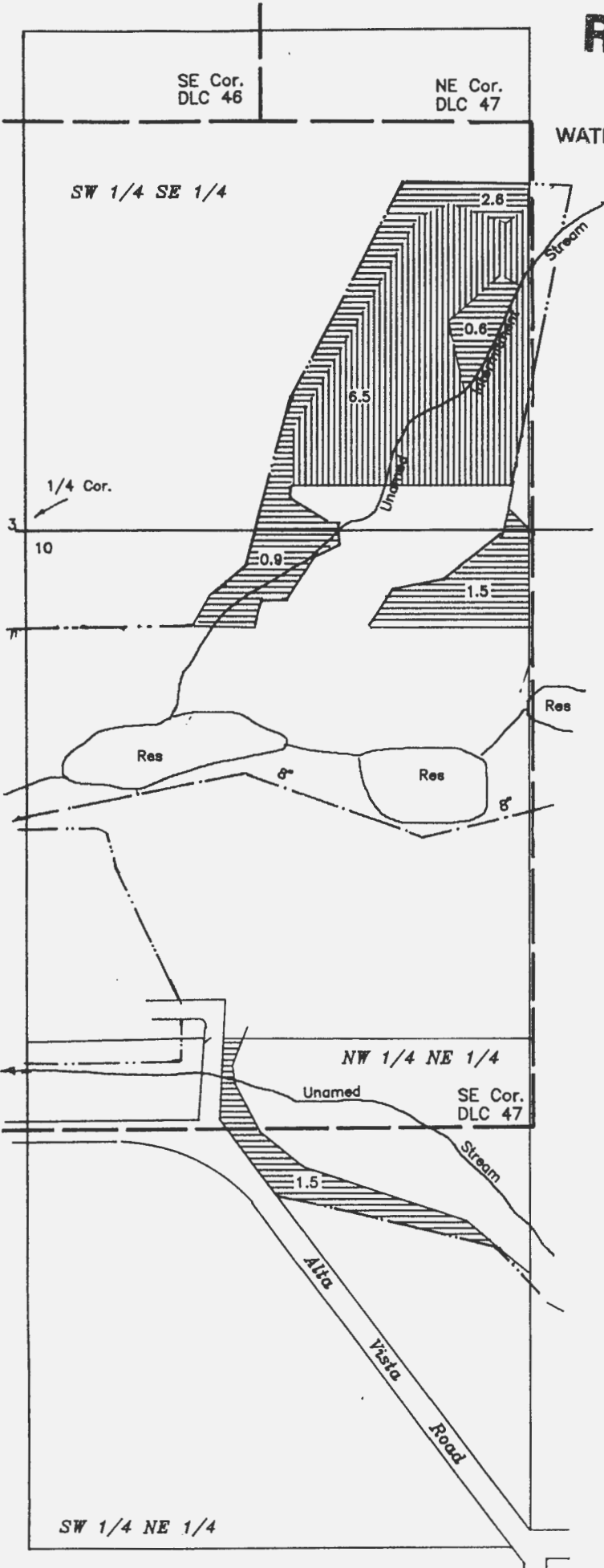

For: EAGLE POINT GOLF CLUB  
100 Eagle Point Drive  
Eagle Point, Oregon 97524

Prepared By: GARY D. KAISER  
Kaiser Surveying  
19440 Highway 62  
Eagle Point, Oregon 97524

April 10, 1996

**RECEIVED**

NOV 17 1997

WATER RESOURCES DEPT.  
SALEM, OREGON



N

Scale: 1" = 400'



Unirrigated portion of E.P.G.C. property receiving E.P.I.D. water by transfer from E.P.G.C. property



Unirrigated portion of E.P.G.C. property receiving E.P.G.C. Cert. 15781 water by transfer

NOTE: MAP PREPARED FOR WATER RIGHT PURPOSES ONLY, NOT FOR PROPERTY BOUNDARY LOCATIONS

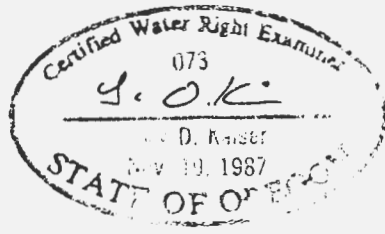

RECEIVED

MMP 4  
T-7662

SW 1/4 SW 1/4

SEP 25 1997 T.36S., R.1W., W.M.

Jackson County, Oregon  
WATER RESOURCES DEPT.  
SALEM, OREGON



Scale: 1" = 400'



Unirrigated portion of E.P.G.C. property receiving E.P.I.D. water by transfer from E.P.G.C. property



Portion of Cert. 15781 within E.P.G.C. property with change in place of use within E.P.G.C. property—also receiving E.P.I.D. water by transfer from E.P.G.C. property



Portion of Cert. 20730 within E.P.G.C. property with change in place of use within E.P.G.C. property—also receiving E.P.I.D. water by transfer from E.P.G.C. property



Unirrigated portion of E.P.G.C. property receiving E.P.G.C. Cert. 20730 water by transfer

NE 1/4 NW 1/4

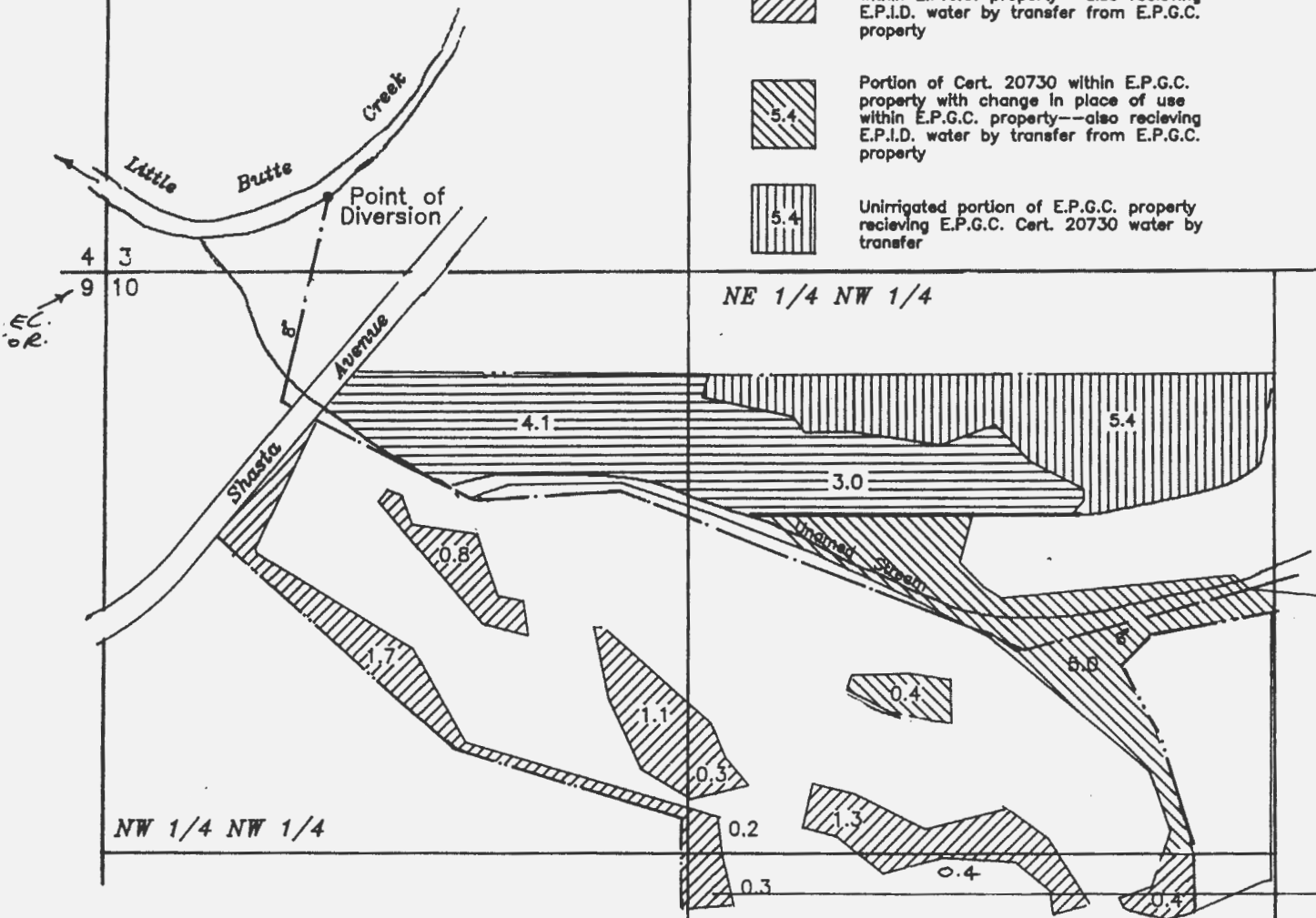

NW 1/4 NW 1/4

Alta Vista Road

SE 1/4 NW 1/4

MAP TO ACCOMPANY A TRANSFER APPLICATION (Change in place of Use)

For: EAGLE POINT GOLF COURSE  
100 Eagle Point, Drive  
Eagle Point, Oregon  
97524

Prepared By: GARY D. KAISER  
Kaiser Surveying  
19440 Highway 62  
Eagle Point, Oregon  
97524

RECEIVED

NOV 17 1997

WATER RESOURCES DEPT.  
SALEM, OREGON

NOTE: MAPS PREPARED FOR WATER RIGHT PURPOSES ONLY, NOT FOR PROPERTY BOUNDARY LOCATIONS

April 10, 1996

