

WATER RIGHT TRANSFER APPLICATION MAP
 FOR A PORTION OF CERTIFICATE 85536 CHANGING 4.3 ACRES
 OF IRRIGATION TO COMMERCIAL USE ASSOCIATED WITH A TRUCK
 STOP AND NEW P.O.A.s FOR LADDI SINGH
 UMATILLA COUNTY T4N, R27E, W.M.

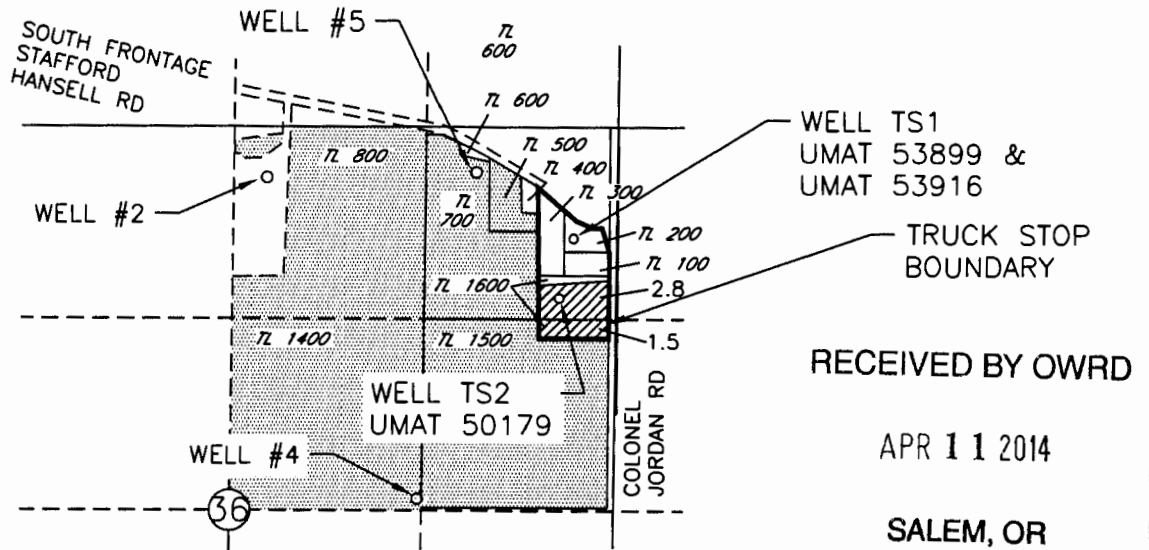

AREA OF WATER RIGHT BEING TRANSFERRED TO COMMERCIAL USE ASSOCIATED WITH A TRUCK STOP

AREA OF WATER RIGHT NOT INVOLVED IN THIS TRANSFER

AUTHORIZED POAs

WELL #2 LOCATED 2400'N AND 330'E FROM THE CENTER $\frac{1}{4}$ CORNER SEC 36

WELL #4 LOCATED 70'N AND 1310'E FROM THE CENTER $\frac{1}{4}$ CORNER SEC 36

WELL #5 LOCATED 270'S AND 990'W FROM THE NE CORNER OF SEC 36

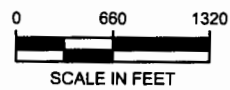

PROPOSED POAs

WELL TS1 LOCATED 1875'N AND 300'W FROM THE E $\frac{1}{4}$ CORNER OF SEC 36

WELL TS2 LOCATED 1460'N AND 380'W FROM THE E $\frac{1}{4}$ CORNER OF SEC 36

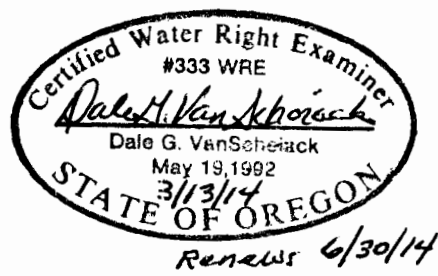

NOTE:
 THE PURPOSE OF THIS MAP IS TO IDENTIFY THE APPROXIMATE LOCATION OF THE WATER RIGHT. IT IS NOT INTENDED TO PROVIDE INFORMATION RELATIVE TO THE LOCATION OF PROPERTY OWNERSHIP BOUNDARY LINES.

