

Application for a Temporary Water Right Transfer In the Name of Olsen Agriculture

FROM LANDS - Certificates 89189 and 42535 (Sperling)

Township 9 South, Range 4 West (W.M.)

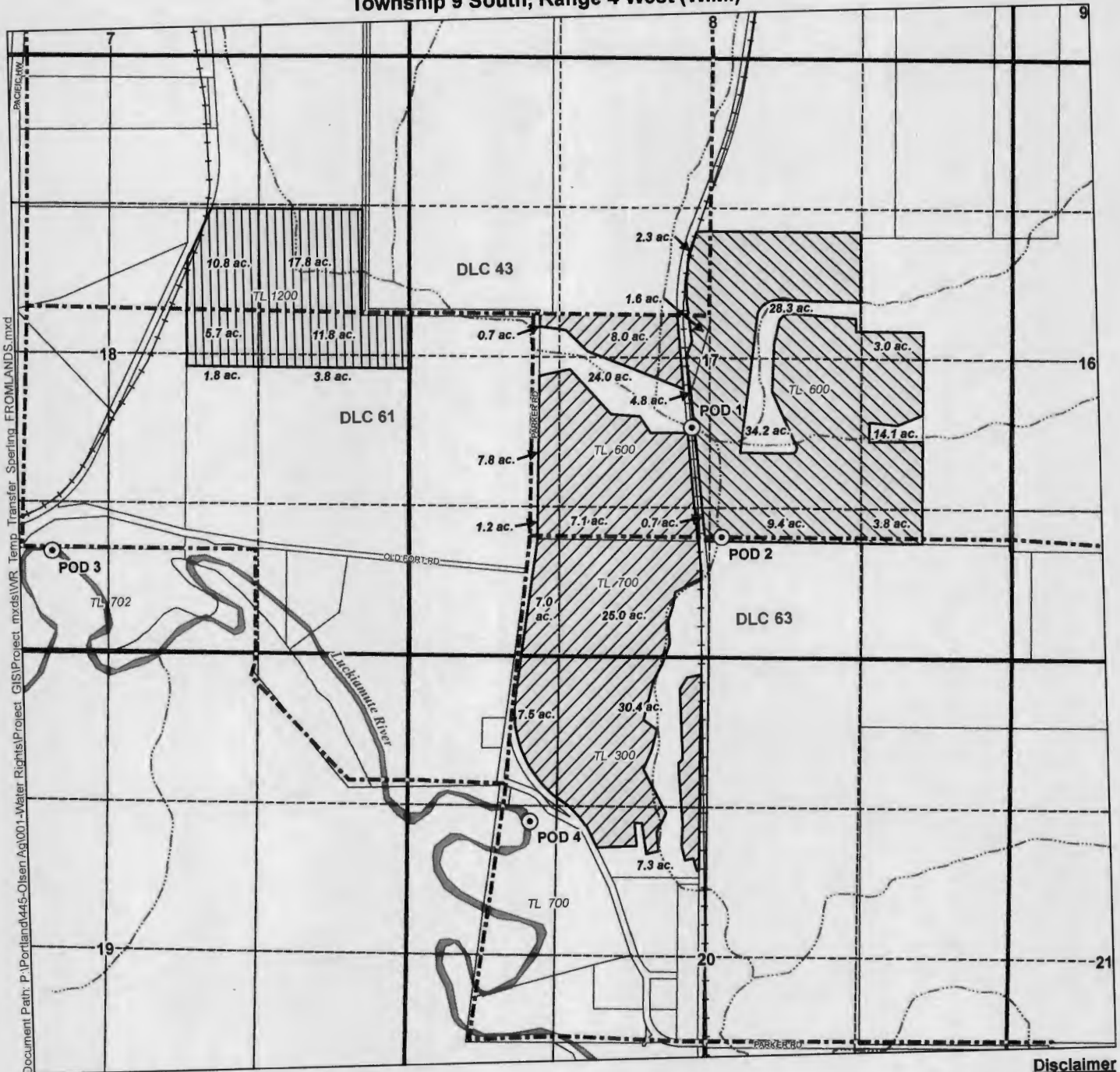

Document Path: P:\Portland\445-Olsen Ag\001-Water Rights\Project GIS\Project.mxd\Temp Transfer_Sperling_FROMLANDS.mxd

LEGEND

- ⊙ Point of Diversion (POD)
- Place of Use (POU)**
- Cert 89189 - From Lands
- Cert 42535 - From Lands
- Cert 42535 - Remaining Lands

All Other Features

- Donation Land Claim (DLC)
- Tax Lot
- Railroads

- Watercourse
- Waterbody

Disclaimer
This map was prepared for the purpose of identifying the location of a water right only and it is not intended to provide legal dimensions or location of property ownership lines.

Map Notes

Date: May 20, 2014
Data Sources: OWRD, Polk County GIS, OGIC, US BLM, USGS
Prepared By: GSI Water Solutions, Inc.

POD Location Descriptions

- POD 1**
Located 1,000 feet South and 1,420 feet East from the NE corner of Steeprow DLC 61, Township 9 South, Range 4 West (W.M.)
- POD 2**
Located 1,980 feet South and 1,670 feet East from the NE corner of Steeprow DLC 61, Township 9 South, Range 4 West (W.M.)

- POD 3**
Located 2,130 feet South and 4,280 feet West from the NE corner of Steeprow DLC 61, Township 9 South, Range 4 West (W.M.)
- POD 4**
Located 4,500 feet South from the NE corner of Steeprow DLC 61 (AND 2530 Feet South and 30 Feet East from the NW Corner, Vanderpool DLC 63), Township 9 South, Range 4 West (W.M.)

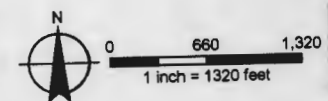

Application for a Temporary Water Right Transfer In the Name of Olsen Agriculture

TO LANDS - Certificates 89189 and 42535 (Mulkey/Kennel)

Township 9 South, Range 4 West (W.M.)

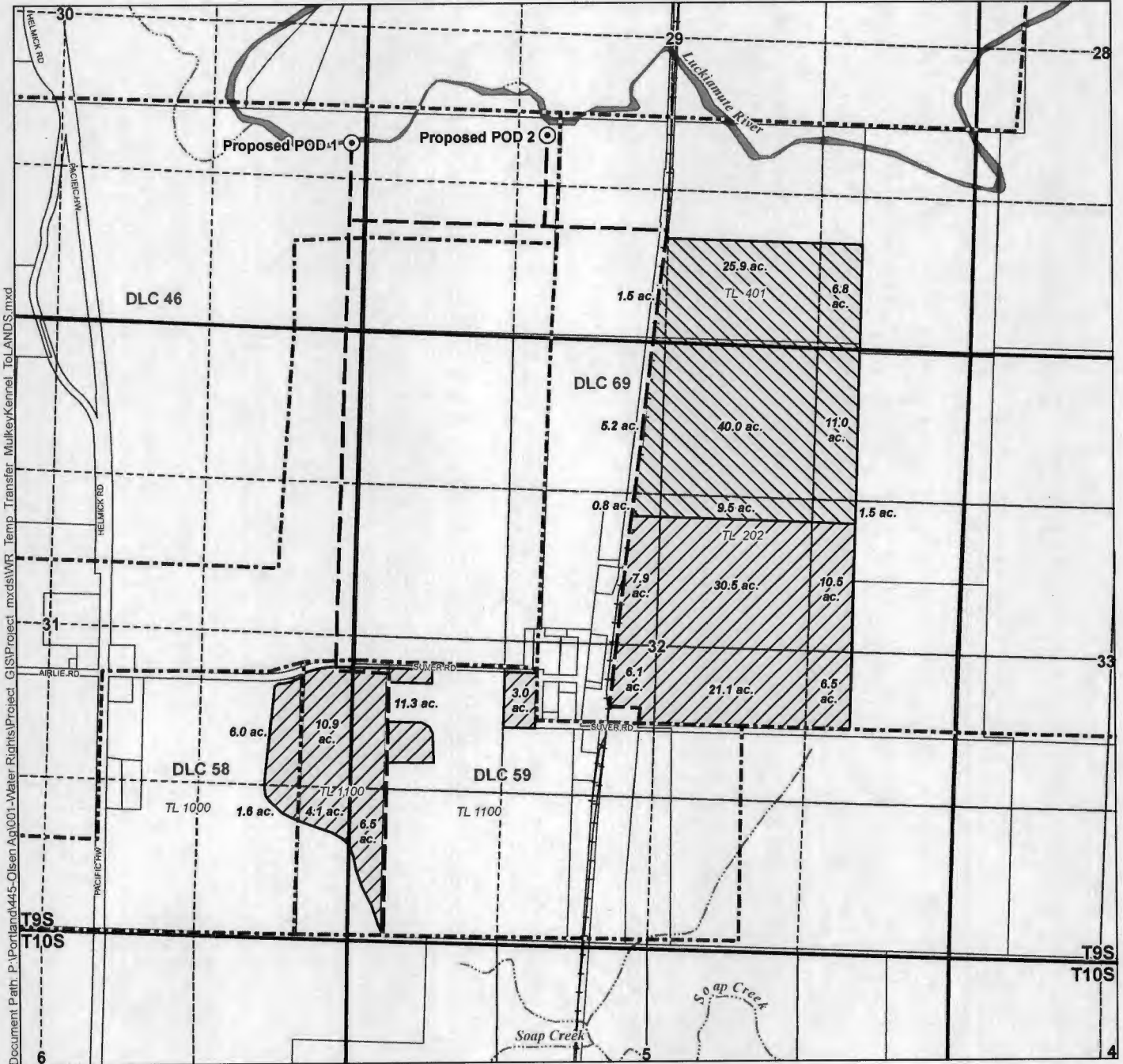

LEGEND

- | | | |
|-------------------------------------|-----------------------------|---------------|
| ⊙ Proposed Point of Diversion (POD) | All Other Features | —+— Railroads |
| Place of Use (POU) | ⊞ Donation Land Claim (DLC) | ~ Watercourse |
| ▨ Certificate 89189 - To Lands | □ Tax Lot | ■ Waterbody |
| ▩ Certificate 42535 - To Lands | — Conveyance System | |

Disclaimer
This map was prepared for the purpose of identifying the location of a water right only and it is not intended to provide legal dimensions or location of property ownership lines.

Map Notes
Date: May 19, 2014
Data Sources: OWRD, Polk County GIS, OGIC, US BLM, USGS
Prepared By: GSI Water Solutions, Inc.

POD Location Descriptions

Proposed POD 1
1,640 feet North and 125 feet West from SE Corner of Section 30, Township 9 South, Range 4 West (W.M.)

Proposed POD 2
1,000 feet North and 100 feet West from SE Corner of DLC 46, Section 29, Township 9 South, Range 4 West (W.M.)

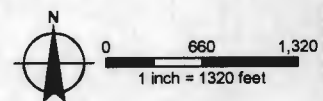

Document Path: P:\Portland\445-Olsen Ag\01-Water Rights\Project_GIS\Project_mxd\WR_Temp_Transfer_MulkeyKennel_ToLANDS.mxd