

**APPLICATION MAP FOR  
5 YEAR TEMPORARY TRANSFER  
JB LAND, LLC - SUPERIOR FARMS  
T5N, R 29E & R30E, WM**

RIVER STATION  
1650hp (900hp,  
500hp & 250hp)

COLUMBIA RIVER

POINT OF DIVERSION  
LOCATED 460' N AND  
1680' E FROM THE  
SW CORNER SECTION 7

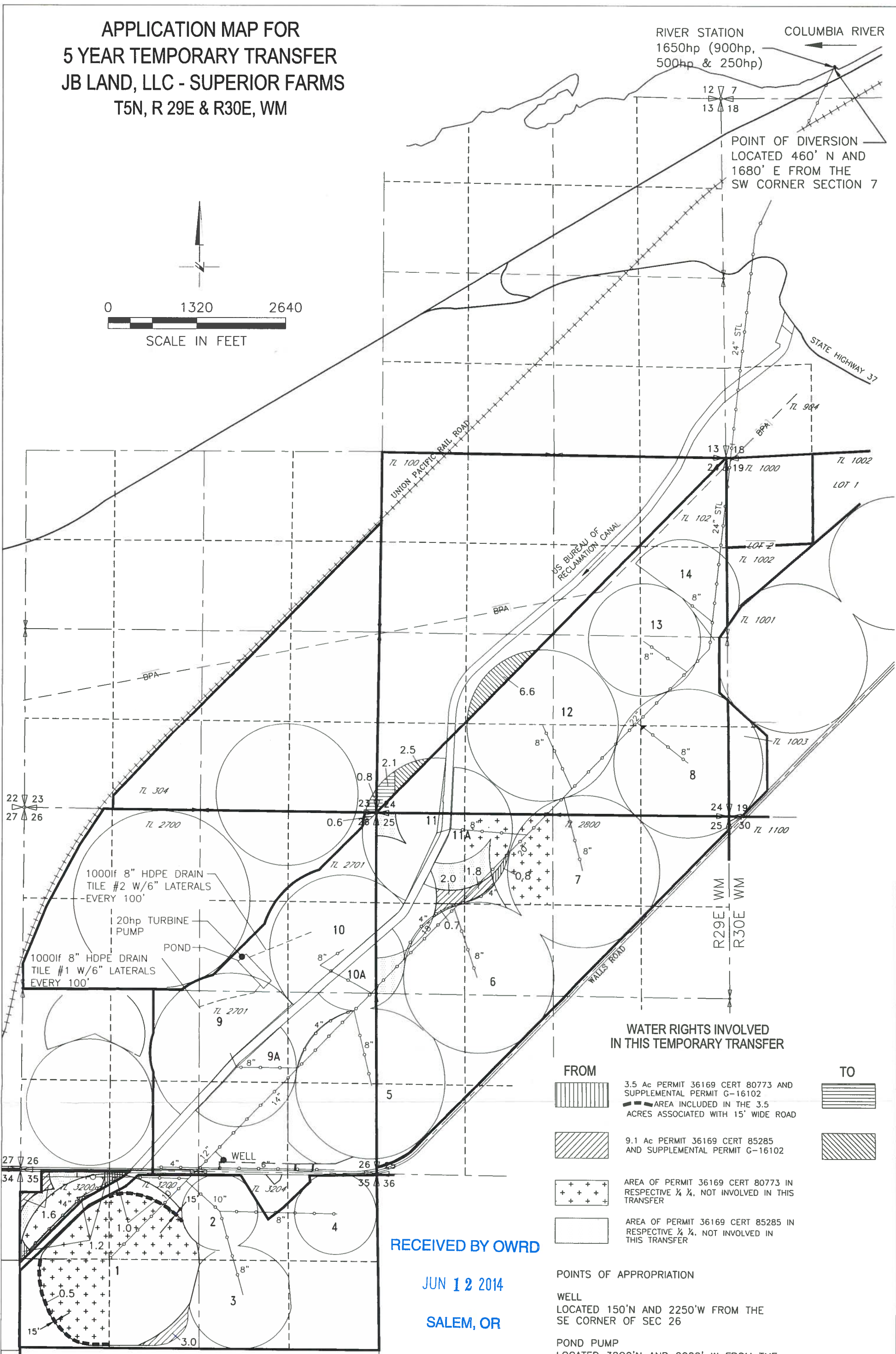
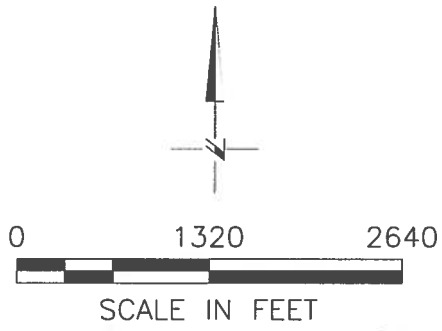

**WATER RIGHTS INVOLVED  
IN THIS TEMPORARY TRANSFER**

FROM	TO
3.5 Ac PERMIT 36169 CERT 80773 AND SUPPLEMENTAL PERMIT G-16102	AREA INCLUDED IN THE 3.5 ACRES ASSOCIATED WITH 15' WIDE ROAD
9.1 Ac PERMIT 36169 CERT 85285 AND SUPPLEMENTAL PERMIT G-16102	
	AREA OF PERMIT 36169 CERT 80773 IN RESPECTIVE 1/4, NOT INVOLVED IN THIS TRANSFER
	AREA OF PERMIT 36169 CERT 85285 IN RESPECTIVE 1/4, NOT INVOLVED IN THIS TRANSFER

RECEIVED BY OWRD  
JUN 12 2014  
SALEM, OR

POINTS OF APPROPRIATION  
WELL  
LOCATED 150'N AND 2250'W FROM THE SE CORNER OF SEC 26  
POND PUMP  
LOCATED 3200'N AND 2000' W FROM THE SE CORNER OF SEC 26

UPDATED BY:  
DGV CONSULTING, PLLC  
MAY 31, 2014

NOTE:  
THE PURPOSE OF THIS MAP IS TO IDENTIFY THE APPROXIMATE LOCATION OF THE WATER RIGHT. IT IS NOT INTENDED TO PROVIDE INFORMATION RELATIVE TO THE LOCATION OF PROPERTY OWNERSHIP BOUNDARY LINES.

