

**Transfer Map
1 of 2**
Certificate 87303 (Application S-38447)

Townships 1 North & 1 South,
Ranges 2, 3, & 4 West (W.M.)

- LEGEND**
- Authorized Place of Use (POU)
 - Proposed POU
 - Point of Diversion (POD)
- All Other Features**
- Counties
 - Cities
 - Major Roads
 - Railroads
 - Watercourses
 - Waterbodies

RECEIVED
AUG 05 2014
OWRD

Certified Water Rights Examiner Stamp

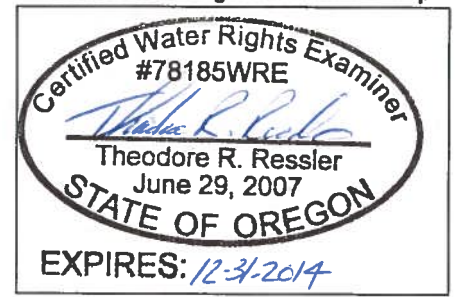

POD LOCATION DESCRIPTIONS
 Scoggins Dam Outlet (Point of Diversion)
 Located 700 feet South and 1,030 feet West from NE corner, Section 20, Township 1 South, Range 4 West, (W.M.)
 Spring Hill Intake (Point of Re-Diversion)
 Located 500 feet North and 410 feet East from SW corner, Section 8, Township 1 South, Range 3 West, (W.M.)

DISCLAIMER:
 This map was prepared for the purpose of identifying the location of a water right only and it is not intended to provide legal dimensions or location of property ownership lines.

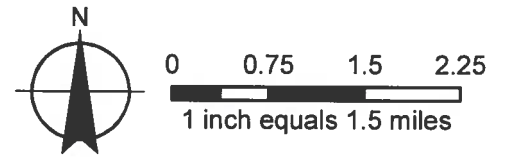

MAP NOTES:
 Date: April 28, 2014
 Data Sources: OWRD, METRO RLIS, OGIC, USGS, ESRI



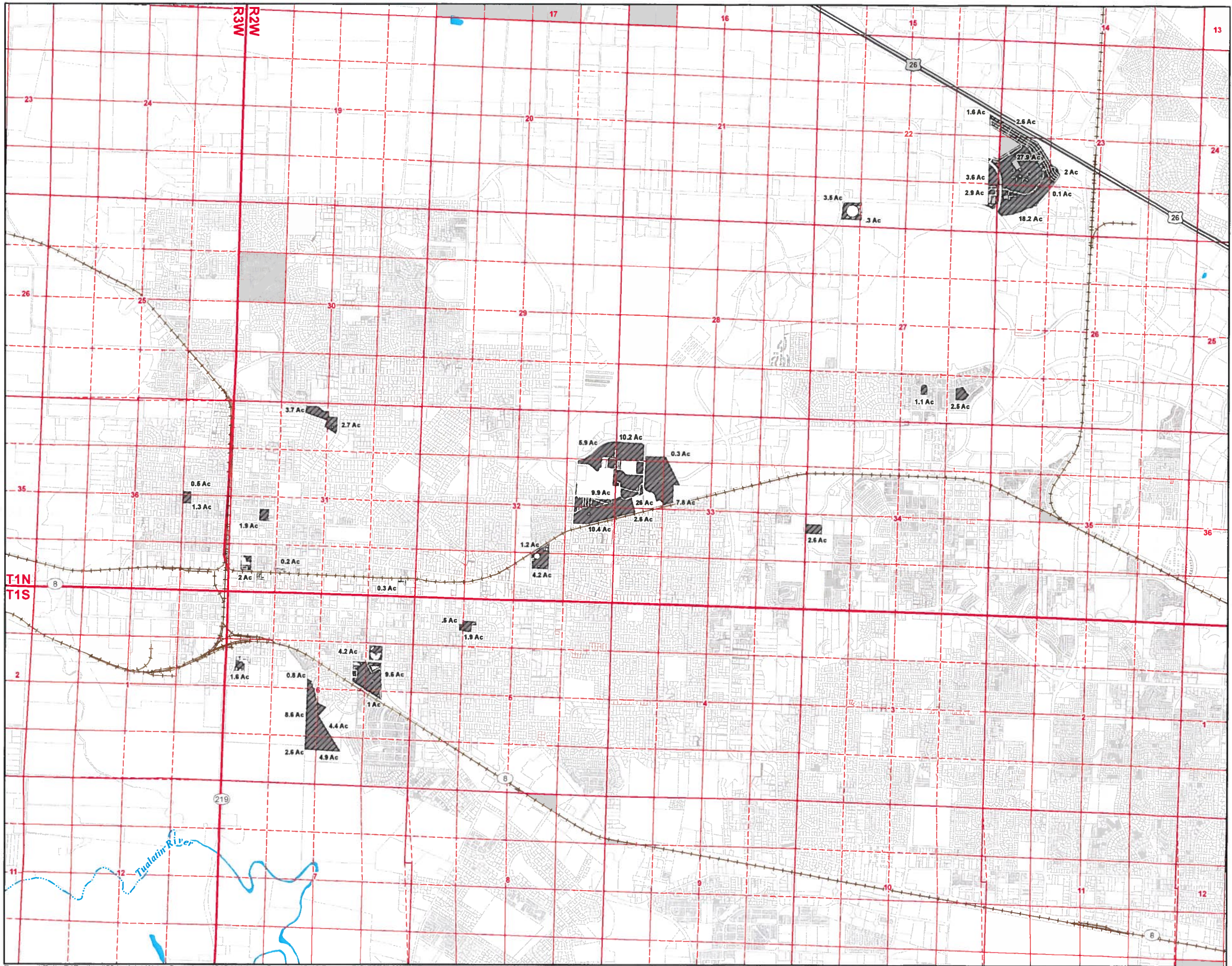

**Transfer Map
2 of 2**

Certificate 87303 (Application S-38477)

**Townships 1 North & 1 South,
Ranges 2 & 3 West (W.M.)**

RECEIVED
AUG 05 2014
OWRD

LEGEND

- Authorized Place of Use
- Tax Lots
- Major Roads
- Railroads
- Watercourses
- Waterbodies

Certified Water Rights Examiner Stamp

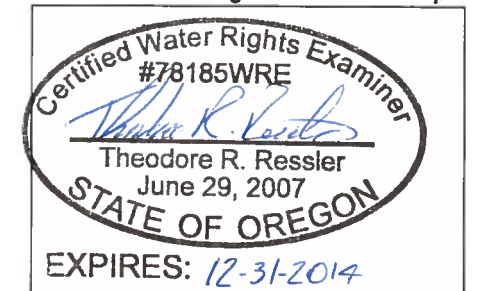

DISCLAIMER:

This map was prepared for the purpose of identifying the location of a water right only and it is not intended to provide legal dimensions or location of property ownership lines.

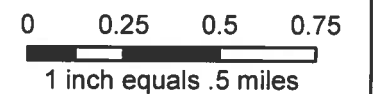
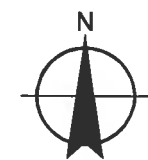

MAP NOTES:

Date: April 28, 2014
Data Sources: OWRD, METRO RLIS, OGIC, USGS, ESRI

