

TRANSFER APPLICATION MAP
 Certificate 62271
 Section 16, T6S, R7W, W.M., Polk County
 Section 33, T5S, R5W, W.M., Yamhill County
 Zach Christensen

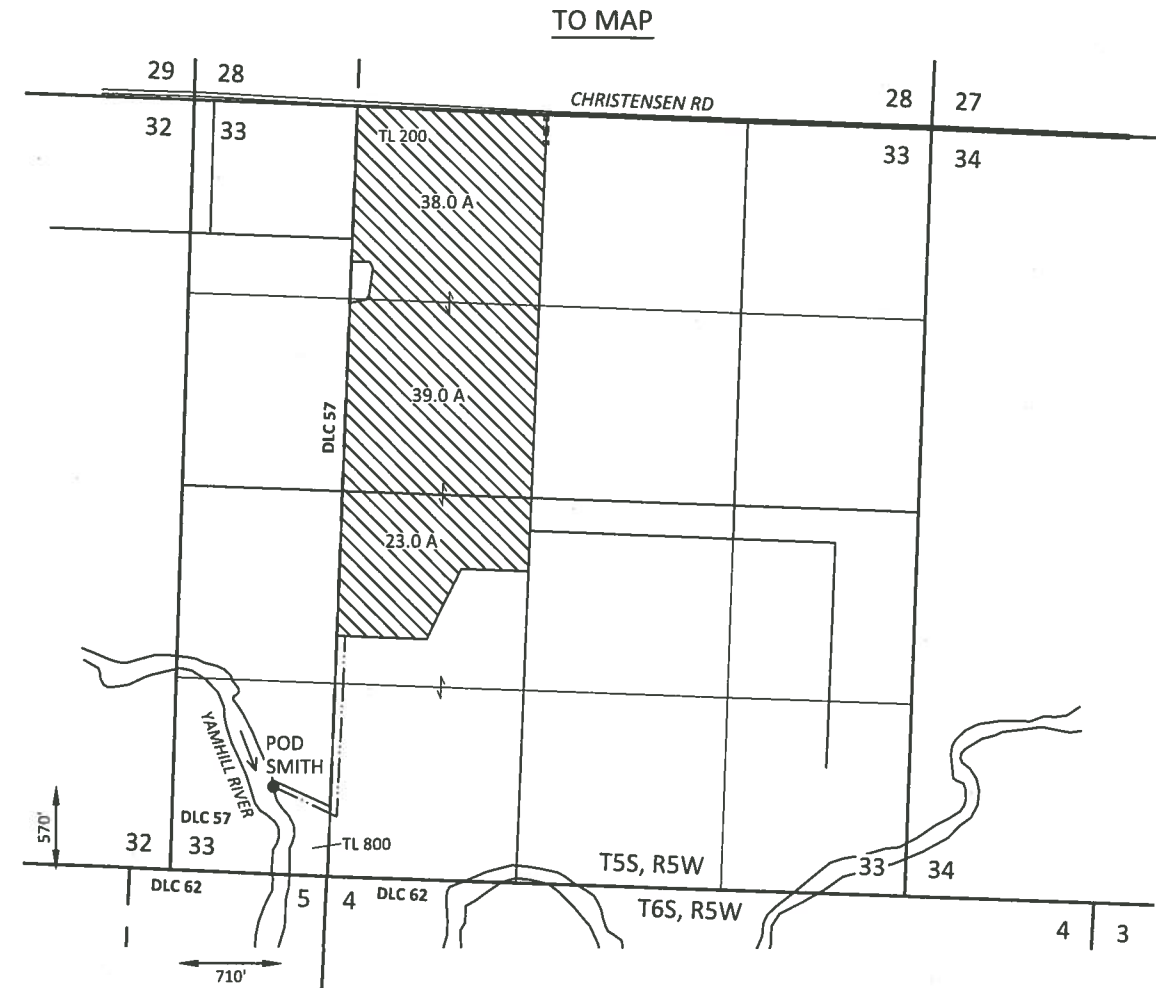

EXPLANATION

FROM LANDS

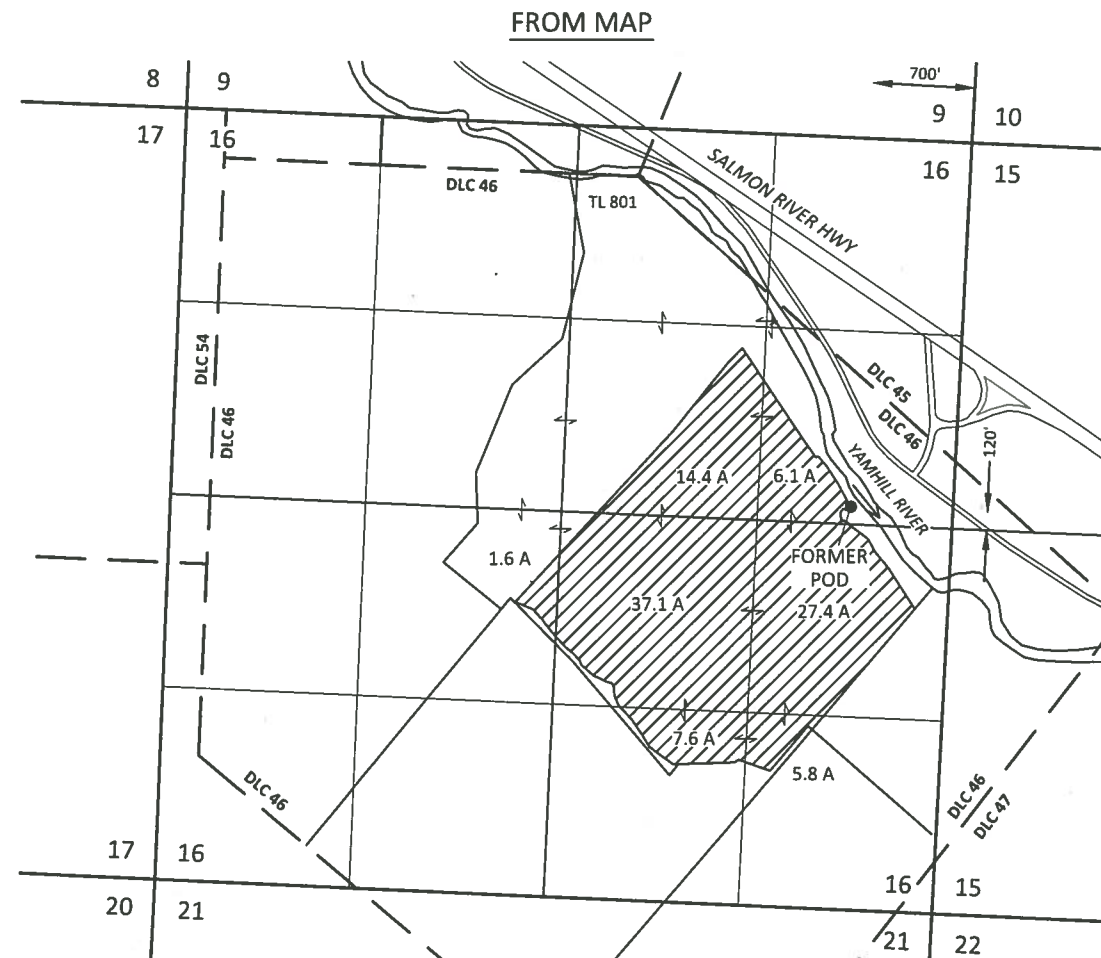

CERTIFICATE 62271 (100.0 AC)
 IRRIGATION - SOUTH YAMHILL RIVER
 PRIORITY: 3/3/1978

TO LANDS



CERTIFICATE 62271 (100.0 AC)
 IRRIGATION - SOUTH YAMHILL RIVER
 PRIORITY: 3/3/1978



POINT OF DIVERSION (POD)



PIPELINE

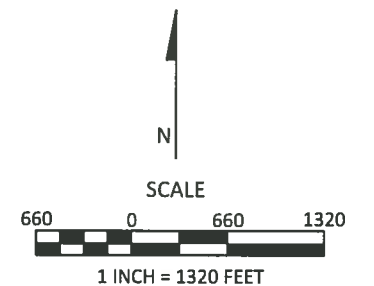

July 23, 2014

This map is not intended to provide legal
 dimensions or locations of property
 ownership lines

FIGURE 1

SKOOKUM
 WATER ASSOCIATES INC

P.O. BOX 80174
 PORTLAND, OR 97280
 (503) 319-8926

RECEIVED

AUG 15 2014

WATER RESOURCES DEPT
 SALEM, OREGON