

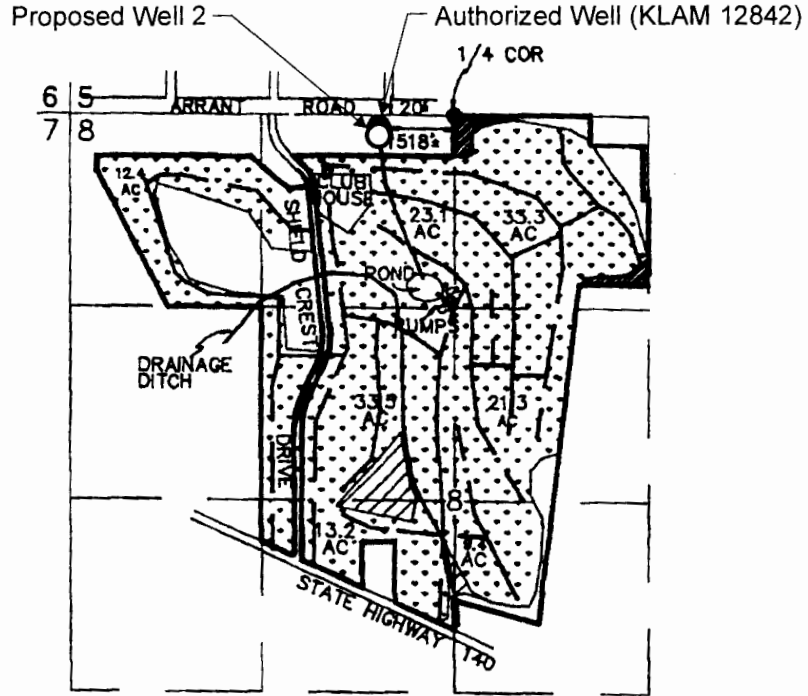





T.39S. R.10E. Section 8, W.M.



Authorized Well (KLAM 12842) is located 20 feet south and 518 feet west from the N 1/4 corner, Section 8.
 Proposed Well 2 is located 65 feet south and 519 feet west from the N 1/4 corner Section 8.

-  AREA IRRIGATED BY HAND SPRINKLERS
-  AREA BEING IRRIGATED BY UNDERGROUND SPRINKLER SYSTEM
-  BURIED MAIN SUPPLY LINE - 8"
-  BURIED DISTRIBUTION LINES - 10", 8" & 6"
-  2" IRON PIPE

RECEIVED

OCT 22 2014

WATER RESOURCES DEPT
 SALEM, OREGON

Scale: 1" = 1,320'

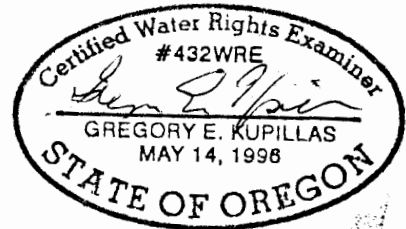

EXPIRATION DATE: 6/30/2015

This map was prepared for the purpose of identifying the location of a water right only and is not intended to provide legal dimensions or location of property ownership lines.



Transfer Application Map
 Application G-12271, Permit G-11263

Shield Crest Golf Course
 T.39S. R.10E. Sec. 8, W.M.

Pacific Hydro-Geology Inc.

4/2014