

Twp. 2 South, Rq. 44 East, W.M.



Proposed POD: 1930' S. & 2081' W.
from the NE cor., Sec. 11

Authorized POD: 1300' N. & 1365' W.
from the SE cor., Sec. 11

This map created by Jason Spriet for reference in file T-10271

1 inch equals 812 feet

10408

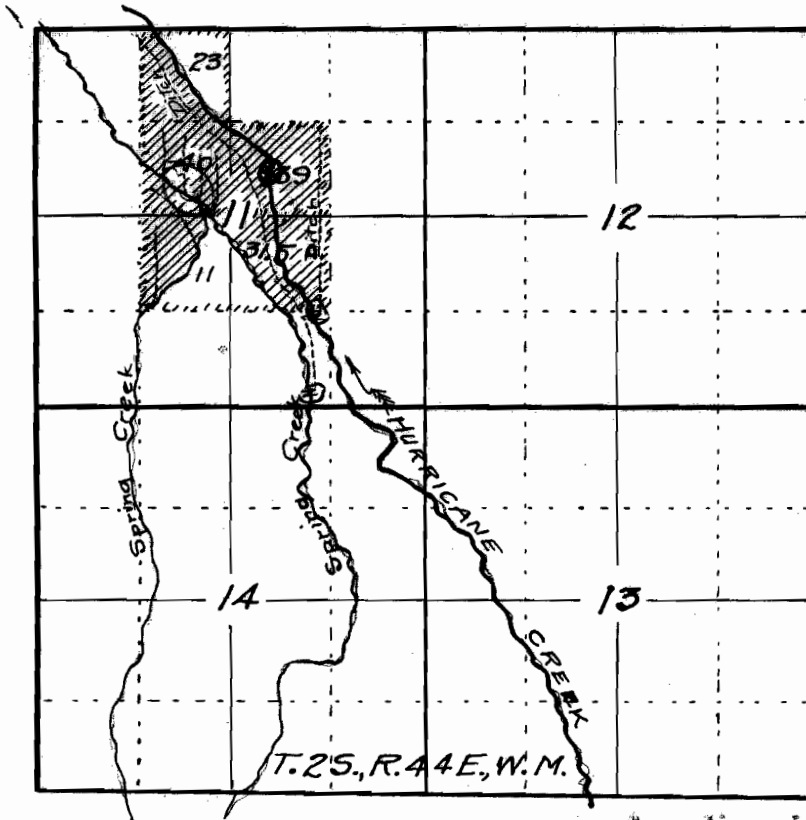

MAP
Accompanying Application
of V. A. Wagner and K. S.
Francis, of Enterprise,
Oregon, for Permit to
Appropriate Water.

STATE ENGINEER
RECEIVED

OCT 1 1925

SALEM, OREGON

Application No. 10408
Permit No. 6925

⊗ proposed
⊙ authorized