

T.3S. R.4E. Sec. 18 & 19, W.M.

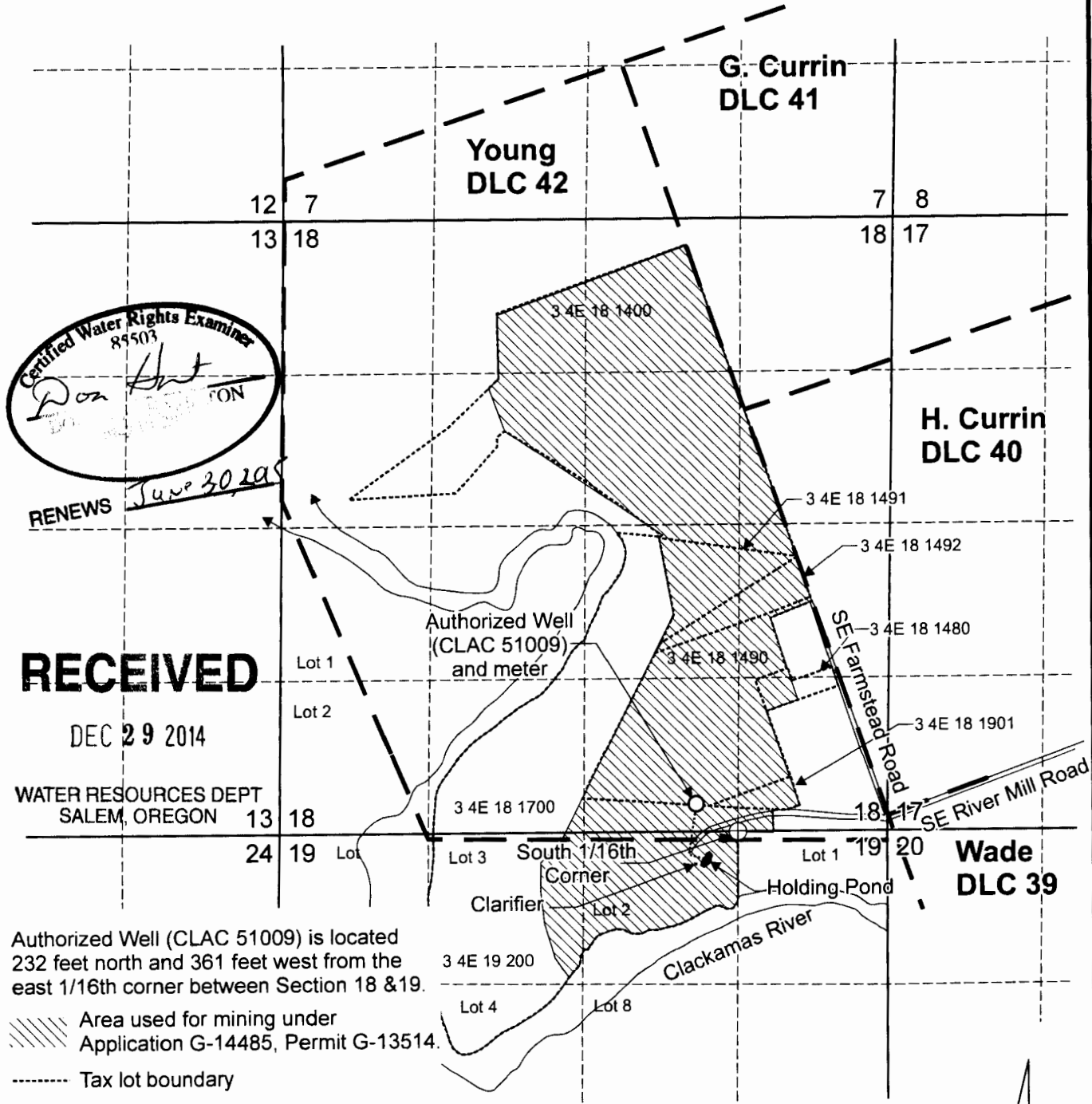

Certified Water Rights Examiner
89503
Don Holt
ON

RECEIVED
DEC 29 2014

WATER RESOURCES DEPT
SALEM, OREGON

Authorized Well (CLAC 51009) is located 232 feet north and 361 feet west from the east 1/16th corner between Section 18 & 19.

- Area used for mining under Application G-14485, Permit G-13514.
- Tax lot boundary
- Donation Land Claim boundary
- Mainlines

Scale: 1" = 1,320'
0 1,320 Feet

This map was prepared for the purpose of identifying the location of a water right only and is not intended to provide legal dimensions or location of property ownership lines.



Permit Amendment Application Map
Application G-14485, Permit G-13514

Estacada Rock Products, Inc.
T.3S. R.4E. Sec. 18 & 19, W.M.

Page 2 of 2

EstacadaPAMap.cdr

Pacific Hydro-Geology Inc.

12/2014

New

T.3S. R.4E. Sec. 18 & 19, W.M.

Certified Water Rights Examiner
85503
Doan Hunt
DOAN M. HAMILTON
May 10, 2012
RENEWS June 30 2014

RECEIVED
DEC 29 2014
WATER RESOURCES DEPT
SALEM, OREGON

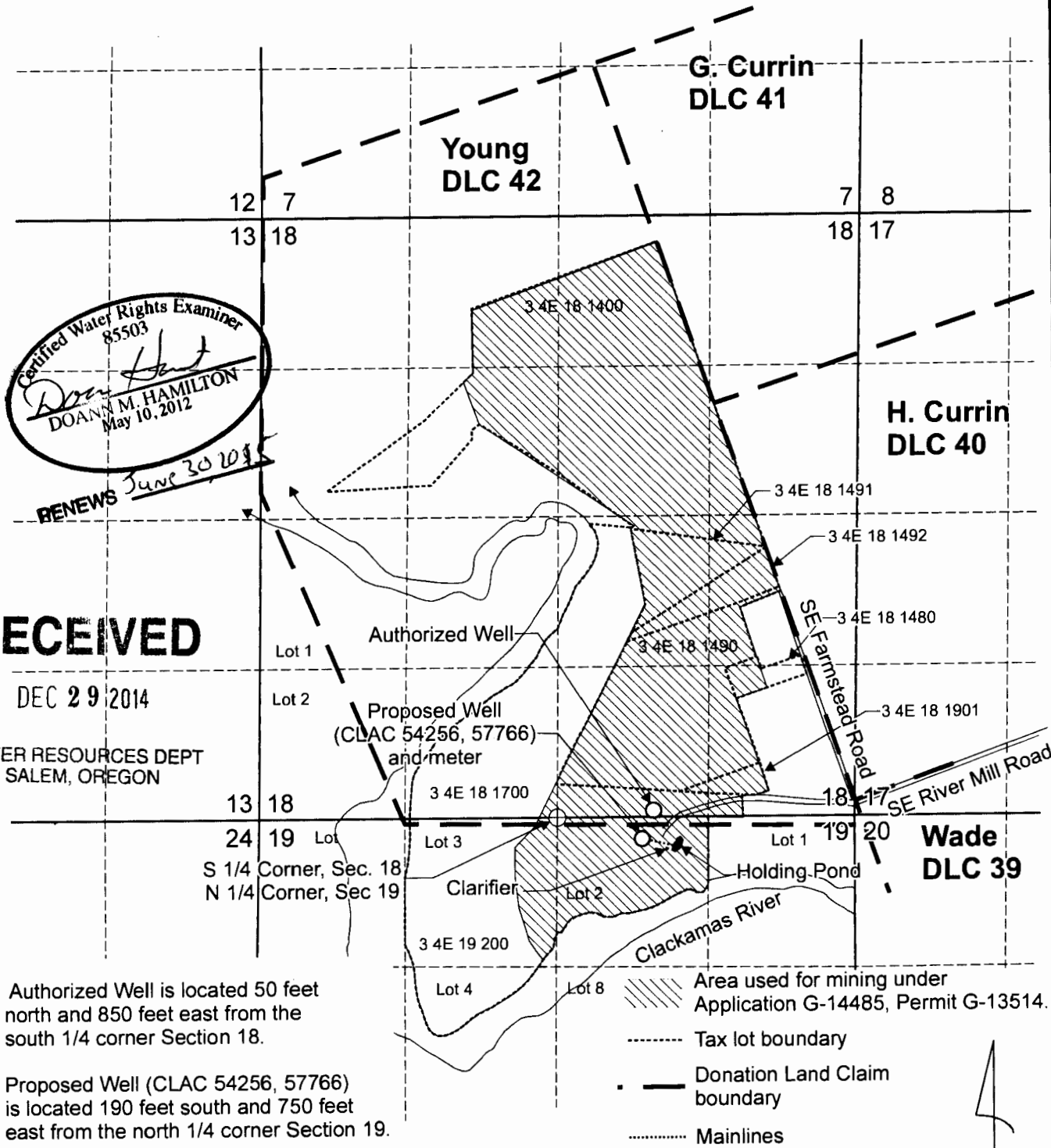

Authorized Well is located 50 feet north and 850 feet east from the south 1/4 corner Section 18.

Proposed Well (CLAC 54256, 57766) is located 190 feet south and 750 feet east from the north 1/4 corner Section 19.

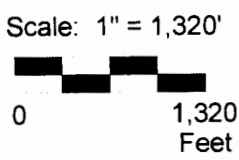

This map was prepared for the purpose of identifying the location of a water right only and is not intended to provide legal dimensions or location of property ownership lines.

Permit Amendment Application Map
Application G-14909, Permit G-13760

Pacific Hydro-Geology Inc.

Estacada Rock Products, Inc.
T.3S. R.4E. Sec. 18 & 19, W.M.

12/2014

Page 1 of 2

EstacadaPAMap.cdr