

T.6S. R.1E. Section 34, W.M.

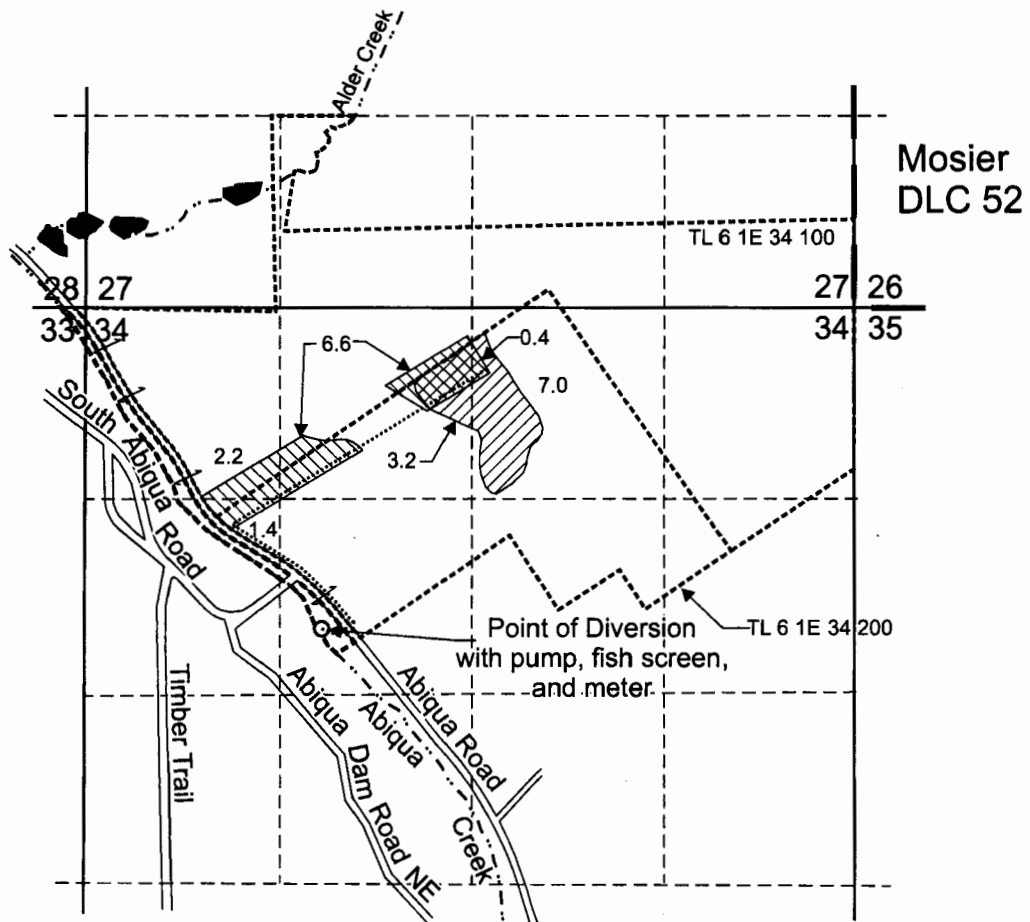

Point of Diversion is located 2,220 feet south and 1,610 feet east from the NW corner, Section 34.

 "From" Area (10.6 Acres) irrigated under Certificate 87536, priority date 9/12/1958.

 "To" Area (10.6 Acres).

----- Tax lot boundary

— — — — — Donation Land Claim boundary

..... Irrigation mainline

RECEIVED

MAR 18 2015

WATER RESOURCES DEPT
SALEM, OREGON



RENEWS JUNE 30, 2015

Scale: 1" = 1,320'

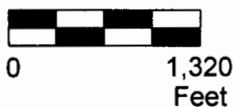

This map was prepared for the purpose of identifying the location of a water right only and is not intended to provide legal dimensions or location of property ownership lines.



Pacific Hydro-Geology Inc.

Transfer Application Map
Certificate 87536

Paul Kraemer
T.6S. R.1E. Section 34, W.M.

03/2015