

RECEIVED BY OWRD
 MAR 16 2015
 SALEM, OR

Sources: Esri, DeLorme, NAVTEQ, USGS, NRCAN, METI, iPC, TomTom

0 1,000 Feet

For more information:
<http://www.wrd.state.or.us> and
<http://apps.wrd.state.or.us/apps/wr/wrinfo/>

This map is for informal purposes only. It is not intended for legal, engineering or surveying purposes. Municipal rights are not included on this map.

Legend

Points of Diversion

- 75030
- 24883
- 24883

Places of Use

- 75030 Storage water
- 24883 Surface water
- 24883 Ground water

◆ Water Rights - Outline to be determined. (Applies to all colors)

Water right labels indicate certificate number or permit letter(s) and number. Municipality uses excluded.

Index Map

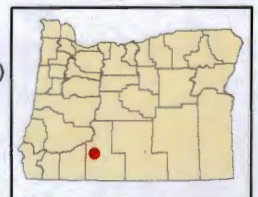

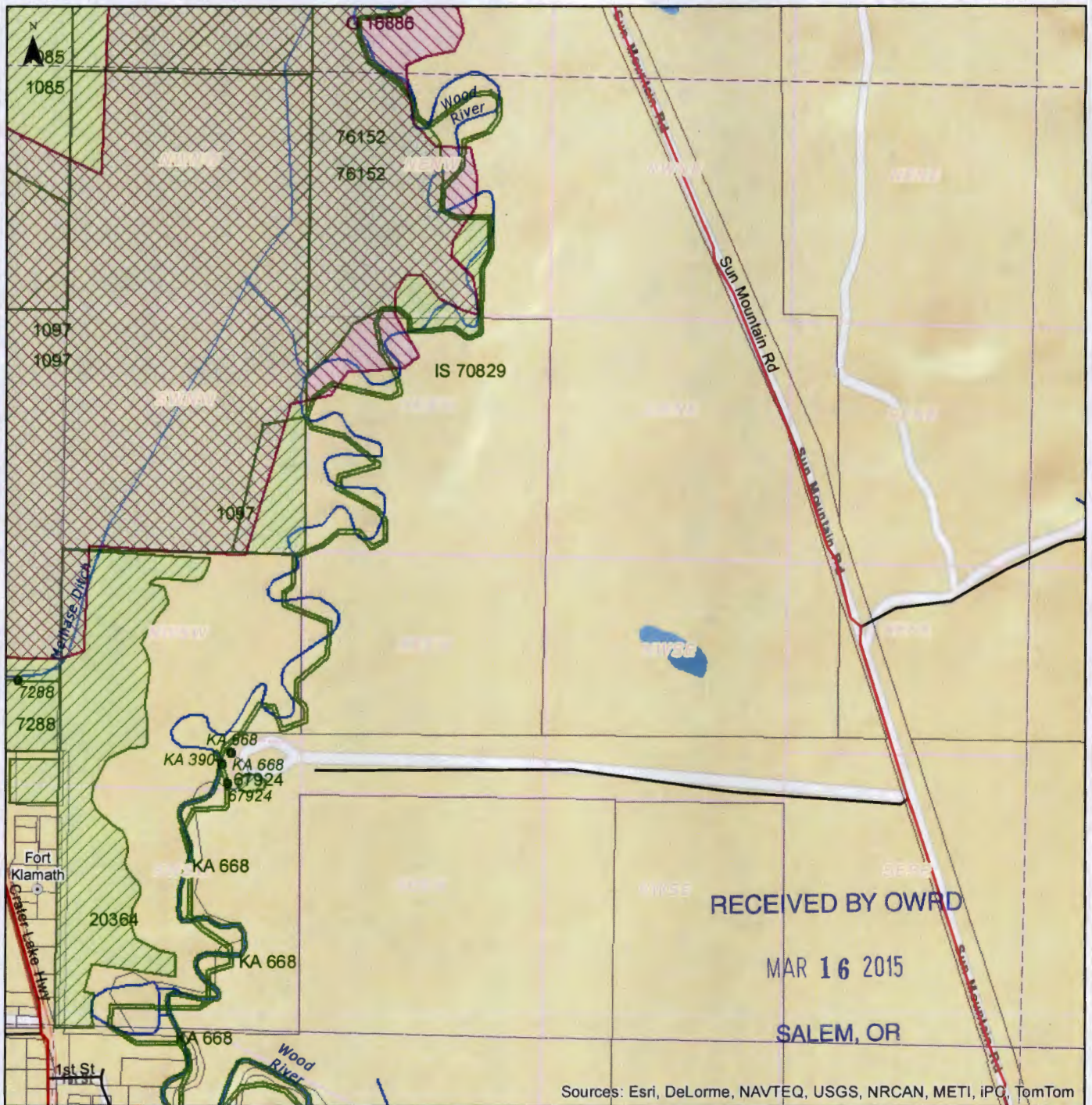

0 1,000 Feet

Legend

Points of Diversion Places of Use

● 75030

● 24883

● 24883

■ 75030

■ 24883

■ 24883

Storage water

Surface water

Ground water

◆ Water Rights - Outline to be determined. (Applies to all colors)

Water right labels indicate certificate number or permit letter(s) and number. Municipality uses excluded.

Index Map

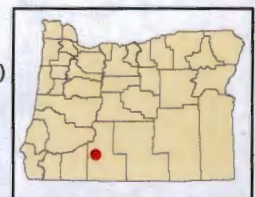

For more information:
<http://www.wrd.state.or.us> and
<http://apps.wrd.state.or.us/apps/wr/wrinfo/>

This map is for informal purposes only. It is not intended for legal, engineering or surveying purposes. Municipal rights are not included on this map.

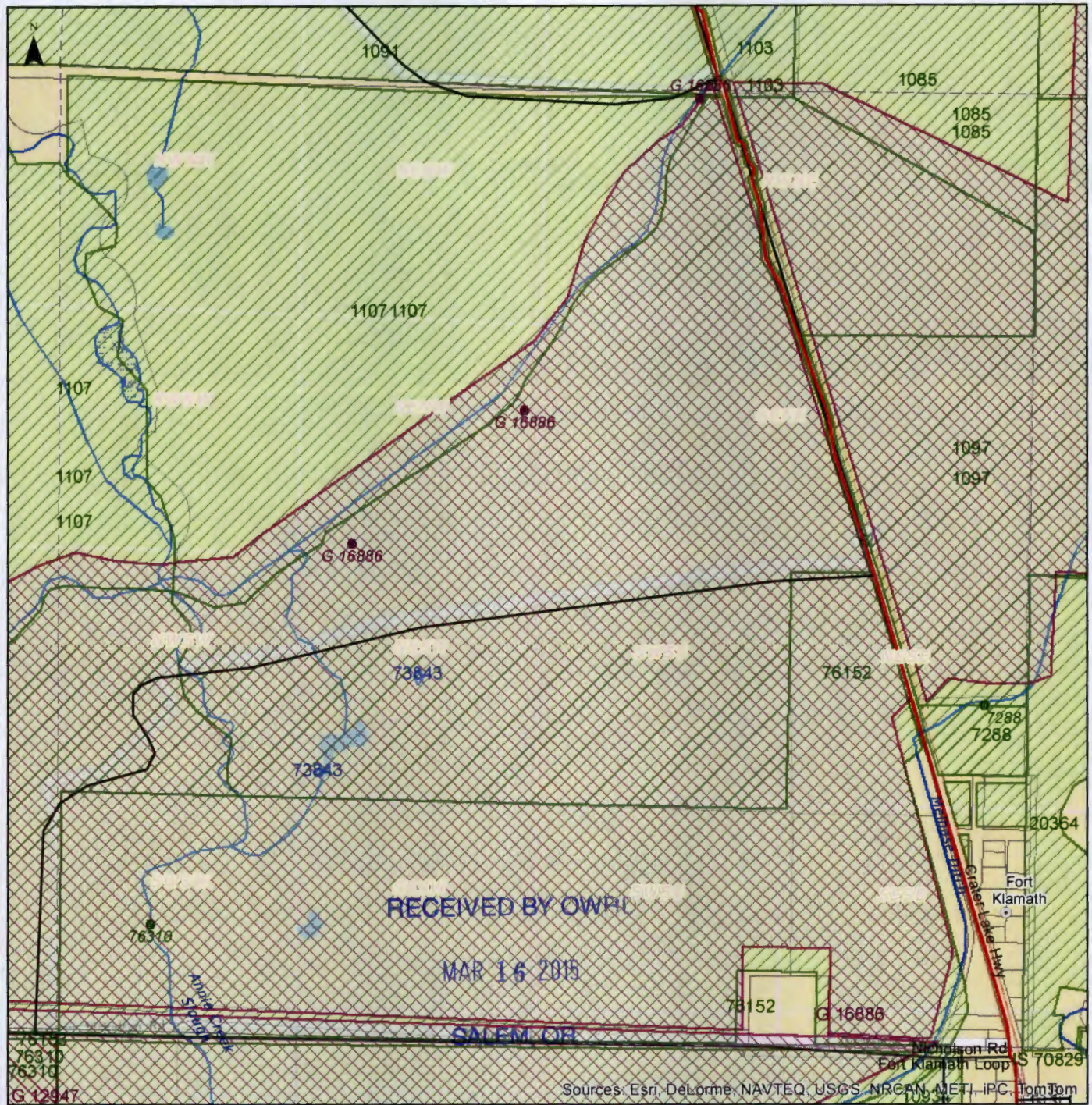

Sources: Esri, DeLorme, NAVTEQ, USGS, NRCAN, METI, IPC, TomTom



For more information:
<http://www.wrd.state.or.us> and
<http://apps.wrd.state.or.us/apps/wr/wrinfo/>

This map is for informal purposes only.
 It is not intended for legal, engineering or
 surveying purposes. Municipal rights are
 not included on this map.

Legend

Points of Diversion	Places of Use
● 75030	75030 Storage water
● 24883	24883 Surface water
● 24883	24883 Ground water

◆ Water Rights - Outline to be determined. (Applies to all colors)

Water right labels indicate certificate number or permit letter(s) and number. Municipality uses excluded.

Index Map

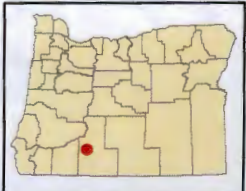

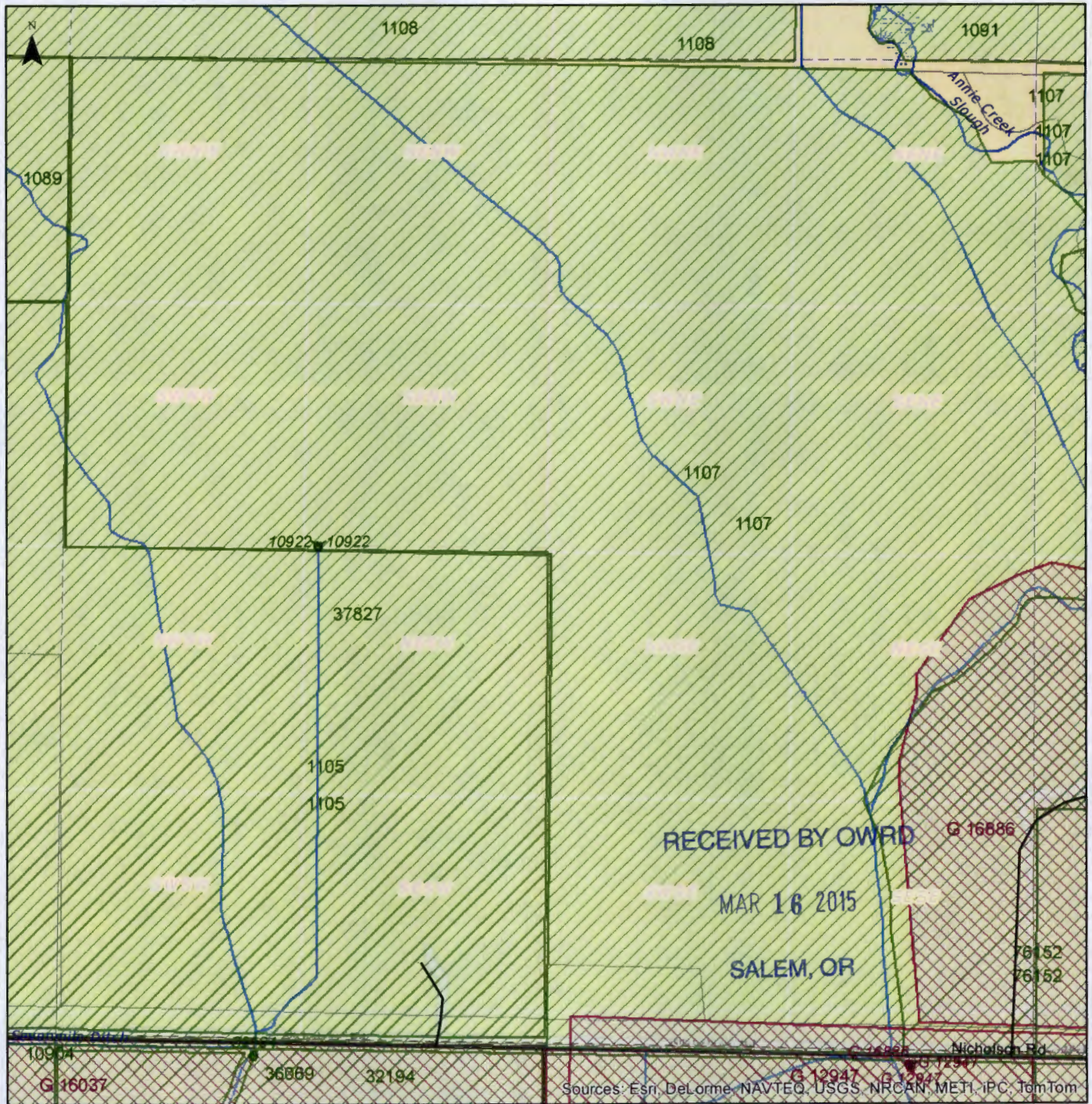

0 1,000 Feet

For more information:
<http://www.wrd.state.or.us> and
<http://apps.wrd.state.or.us/apps/wr/wrinfo/>

This map is for informal purposes only.
 It is not intended for legal, engineering or
 surveying purposes. Municipal rights are
 not included on this map.

Legend

- | Points of Diversion | Places of Use |
|---------------------|---------------------|
| ● 75030 | 75030 Storage water |
| ● 24883 | 24883 Surface water |
| ● 24883 | 24883 Ground water |

◆ Water Rights - Outline to be determined. (Applies to all colors)
 Water right labels indicate certificate number or permit letter(s) and number. Municipality uses excluded.

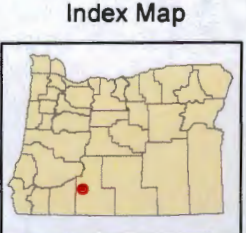

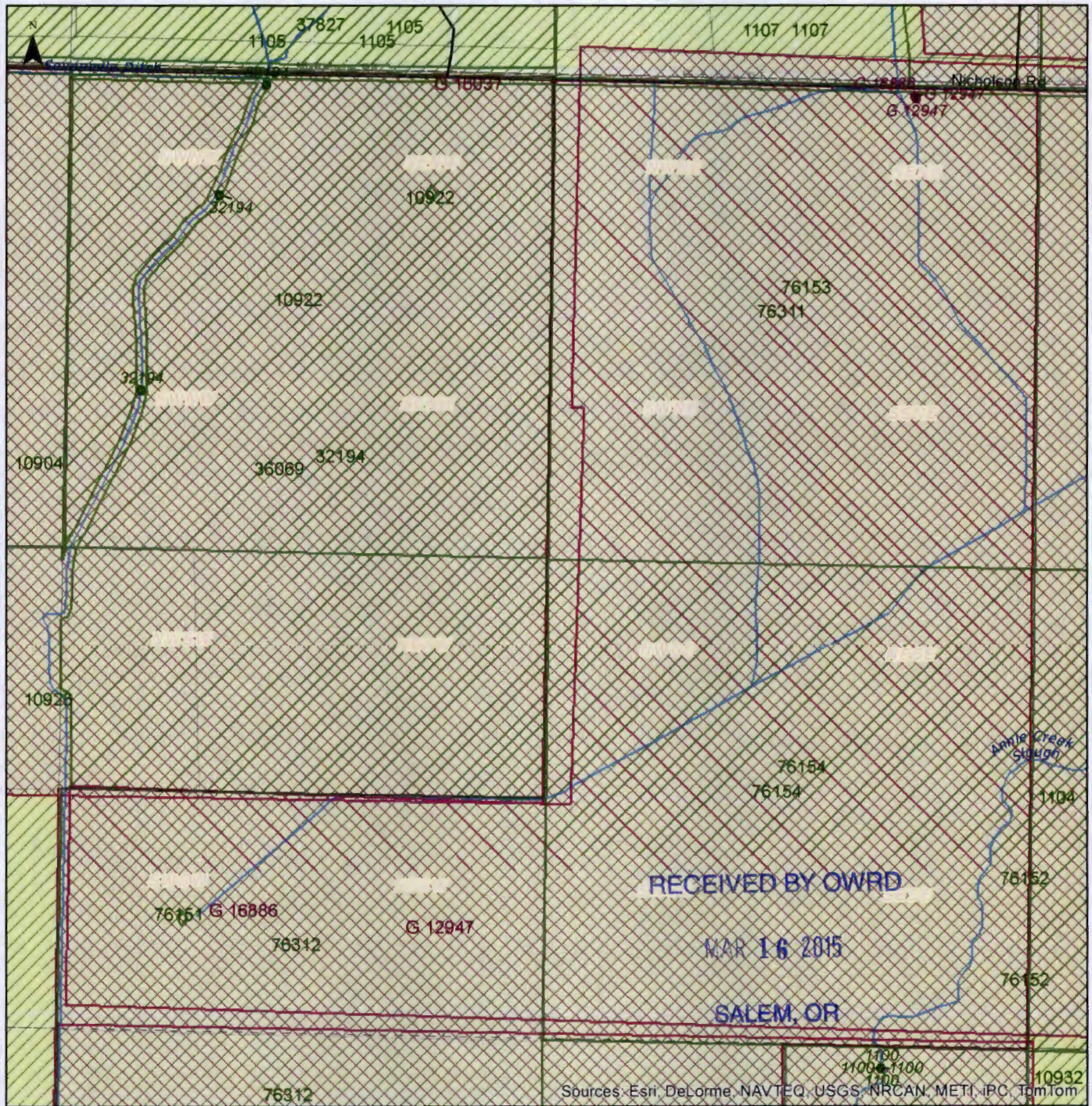

0 1,000 Feet

Legend

Index Map

For more information:
<http://www.wrd.state.or.us> and
<http://apps.wrd.state.or.us/apps/wr/wrinfo/>

This map is for informal purposes only.
 It is not intended for legal, engineering or
 surveying purposes. Municipal rights are
 not included on this map.

Points of Diversion Places of Use

● 75030

● 24883

● 24883

75030

24883

24883

Storage water

Surface water

Ground water

◆ Water Rights - Outline to be determined. (Applies to all colors)

Water right labels indicate certificate number or permit letter(s) and number. Municipality uses excluded.

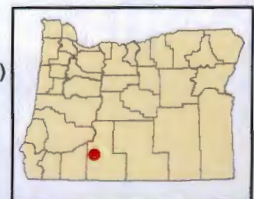

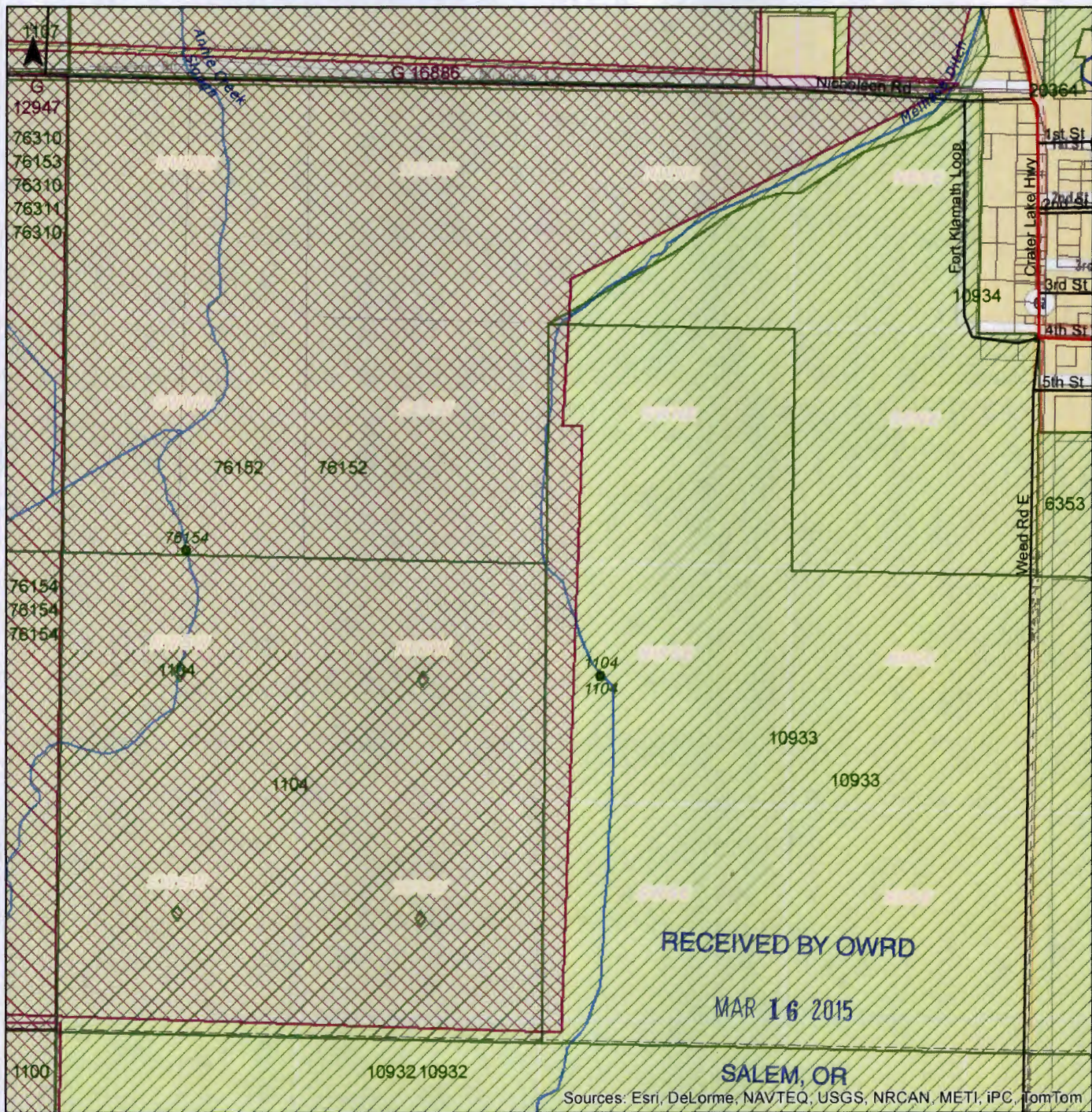

0 1,000 Feet

For more information:
<http://www.wrd.state.or.us> and
<http://apps.wrd.state.or.us/apps/wr/wrinfo/>

This map is for informal purposes only.
 It is not intended for legal, engineering or
 surveying purposes. Municipal rights are
 not included on this map.

Legend

Points of Diversion Places of Use

● 75030

● 24883

● 24883

75030

24883

24883

Storage water

Surface water

Ground water

◆ Water Rights - Outline to be determined. (Applies to all colors)

Water right labels indicate certificate number or permit letter(s) and number. Municipality uses excluded.

Index Map

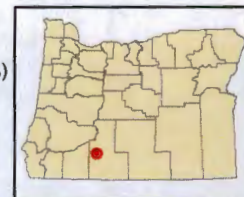

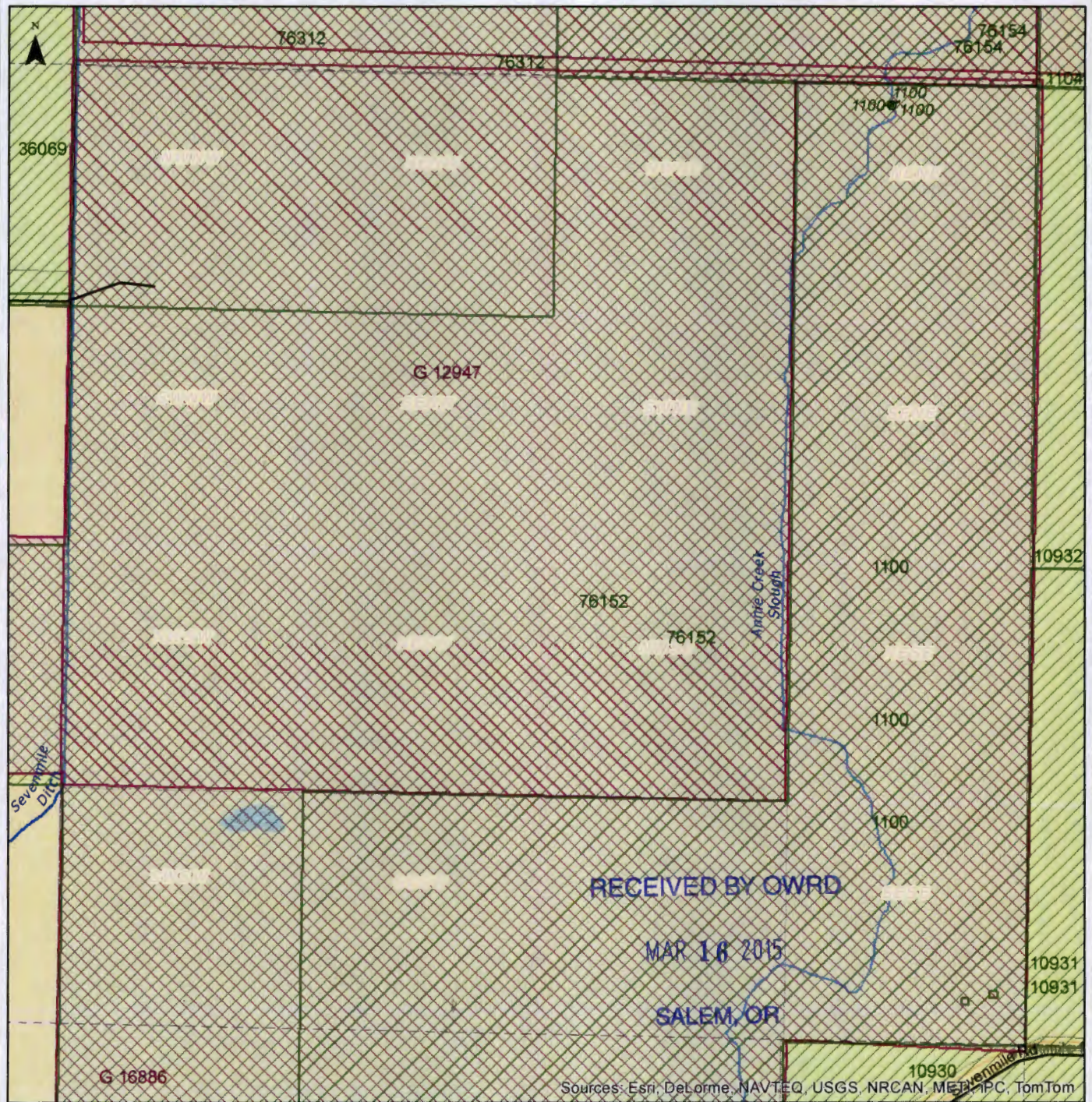

Sources: Esri, DeLorme, NAVTEQ, USGS, NRCAN, METI, IPC, TomTom



For more information:
<http://www.wrd.state.or.us> and
<http://apps.wrd.state.or.us/apps/wr/wrinfo/>

This map is for informal purposes only. It is not intended for legal, engineering or surveying purposes. Municipal rights are not included on this map.

Legend	
Points of Diversion	Places of Use
● 75030	75030 Storage water
● 24883	24883 Surface water
● 24883	24883 Ground water

◆ Water Rights - Outline to be determined. (Applies to all colors)

Water right labels indicate certificate number or permit letter(s) and number. Municipality uses excluded.

Index Map

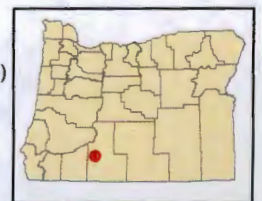

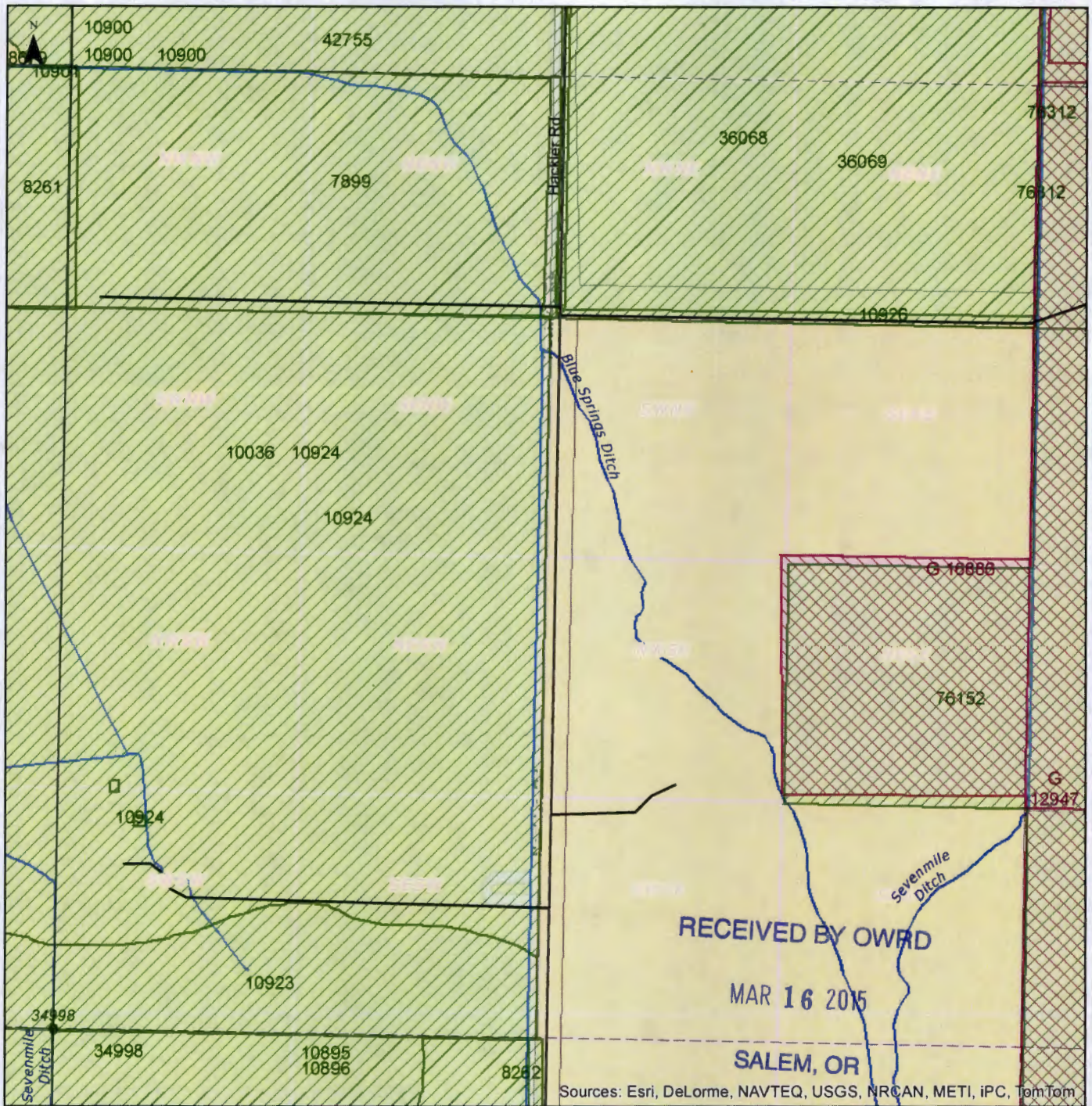

Sources: Esri, DeLorme, NAVTEQ, USGS, NRCAN, METI, IPC, TomTom

0 1,000 Feet

Legend

Index Map

For more information:
<http://www.wrd.state.or.us> and
<http://apps.wrd.state.or.us/apps/wr/wrinfo/>

This map is for informal purposes only.
 It is not intended for legal, engineering or
 surveying purposes. Municipal rights are
 not included on this map.

Points of Diversion

Places of Use

● 75030

● 24883

● 24883

75030

24883

24883

Storage water

Surface water

Ground water

◆ Water Rights - Outline to be determined. (Applies to all colors)

Water right labels indicate certificate number or permit letter(s) and number. Municipality uses excluded.

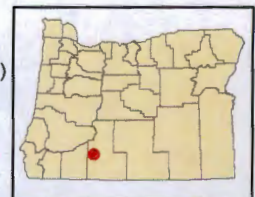

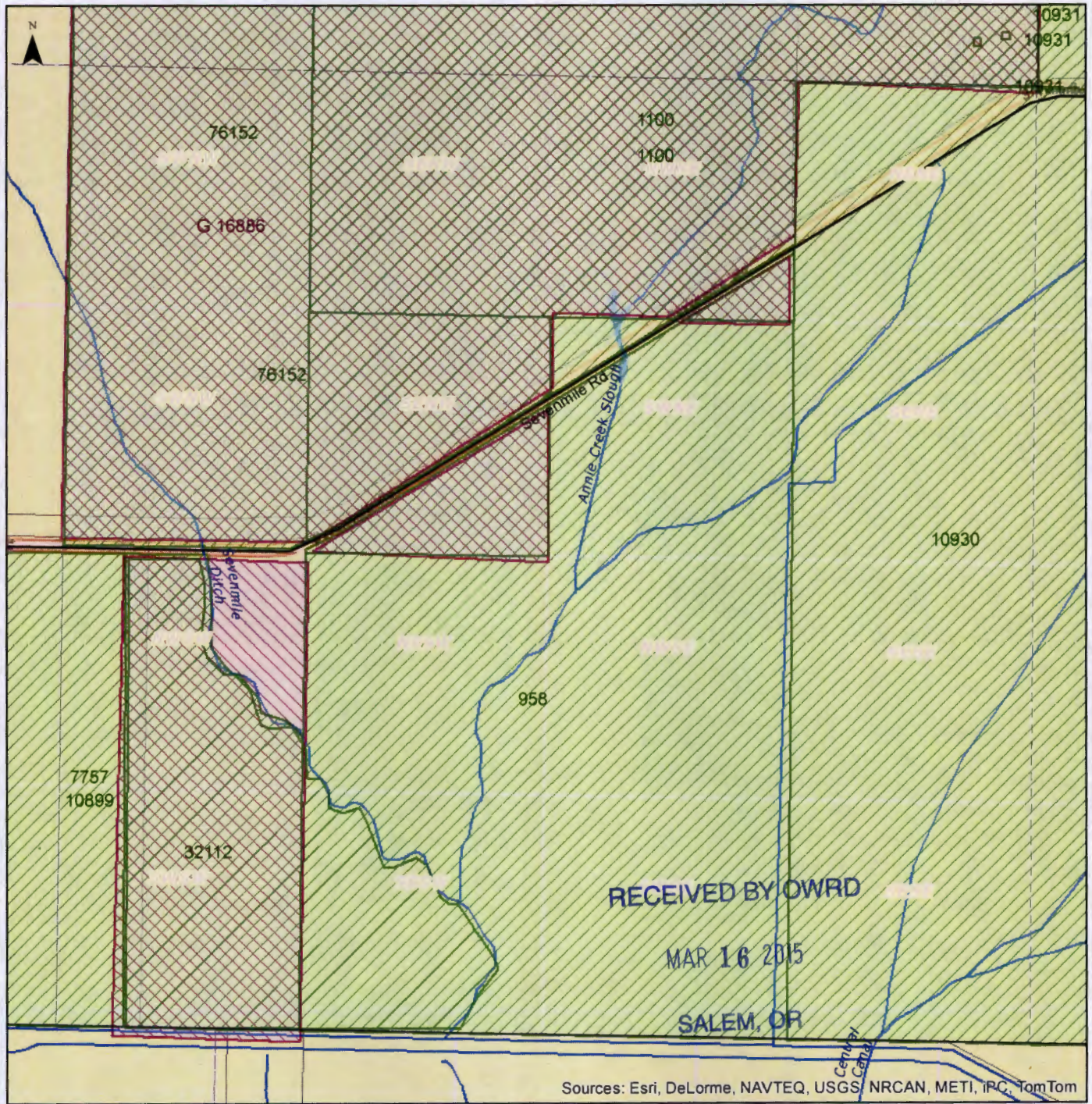

0 1,000 Feet

For more information:
<http://www.wrd.state.or.us> and
<http://apps.wrd.state.or.us/apps/wr/wrinfo/>

This map is for informal purposes only.
 It is not intended for legal, engineering or
 surveying purposes. Municipal rights are
 not included on this map.

Legend

Points of Diversion	Places of Use
● 75030	75030 Storage water
● 24883	24883 Surface water
● 24883	24883 Ground water

◆ Water Rights - Outline to be determined. (Applies to all colors)

Water right labels indicate certificate number or permit letter(s) and number. Municipality uses excluded.

Index Map

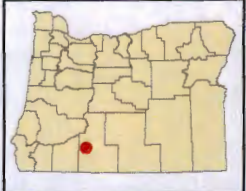

Permit Amendment Map #2
 (Shows entire place of use for Permit G-16886)

RECEIVED
 SEP 05 2002
 WATER RESOURCES DEPT.
 SALEM, OREGON

APPLICATION MAP
 FOR
 SUPPLEMENTAL
 GROUND WATER RIG
 IN THE NAME OF
 WOOD RIVER DISTRICT
 IMPROVEMENT CO
 LOCATED IN SECS. 10, 15, 16, 17, 20,
 T.33 S., R. 07 1/2 E., W.M.
 KLAMATH COUNTY, OREGON

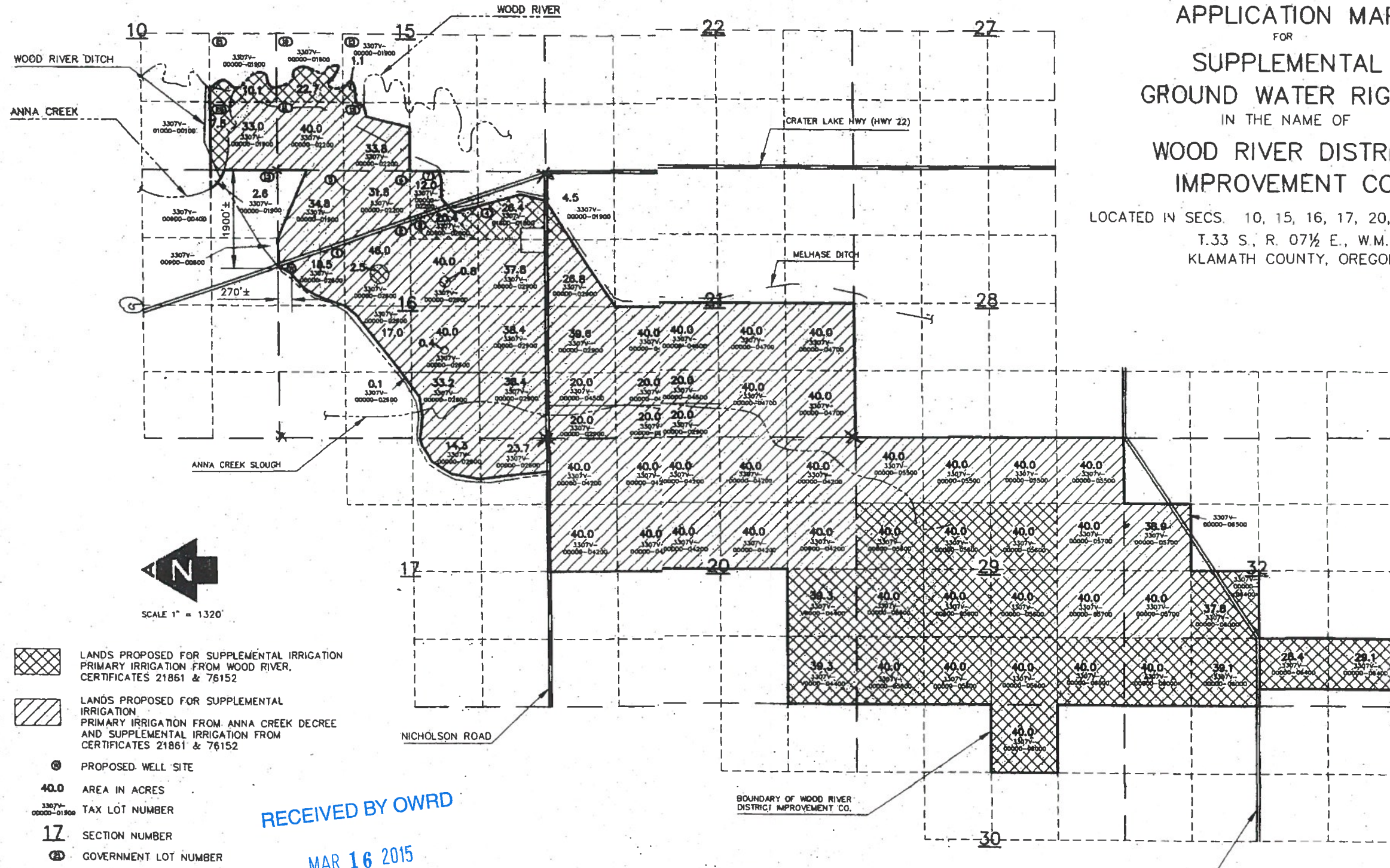

- LANDS PROPOSED FOR SUPPLEMENTAL IRRIGATION PRIMARY IRRIGATION FROM WOOD RIVER, CERTIFICATES 21861 & 76152
- LANDS PROPOSED FOR SUPPLEMENTAL IRRIGATION PRIMARY IRRIGATION FROM ANNA CREEK DECREE AND SUPPLEMENTAL IRRIGATION FROM CERTIFICATES 21861 & 76152
- PROPOSED WELL SITE
- 40.0** AREA IN ACRES
- 3307V-00000-01900** TAX LOT NUMBER
- 17** SECTION NUMBER
- 21** GOVERNMENT LOT NUMBER



RECEIVED BY OWRD
 MAR 16 2015
 SALEM, OR

ADKINS
 ENGINEERS, INC.
 2950 Shields Way Klamath Falls, Oregon 97603 (541) 884-4868 FAX (541) 894-5335
 August 9, 2002 Klamath Falls, OR Medford, OR Astoria, CA JOB No. 1264-0201

THIS MAP IS FOR THE PURPOSE OF IDENTIFYING THE LOCATION OF THE WATER RIGHT ONLY AND HAS NO INTENT TO PROVIDE PROPERTY LINES.

G-15834
 app#
 Permit#
 G-15744

Permit Amendment Map #1
 Change in Point of Appropriation - Well 1A

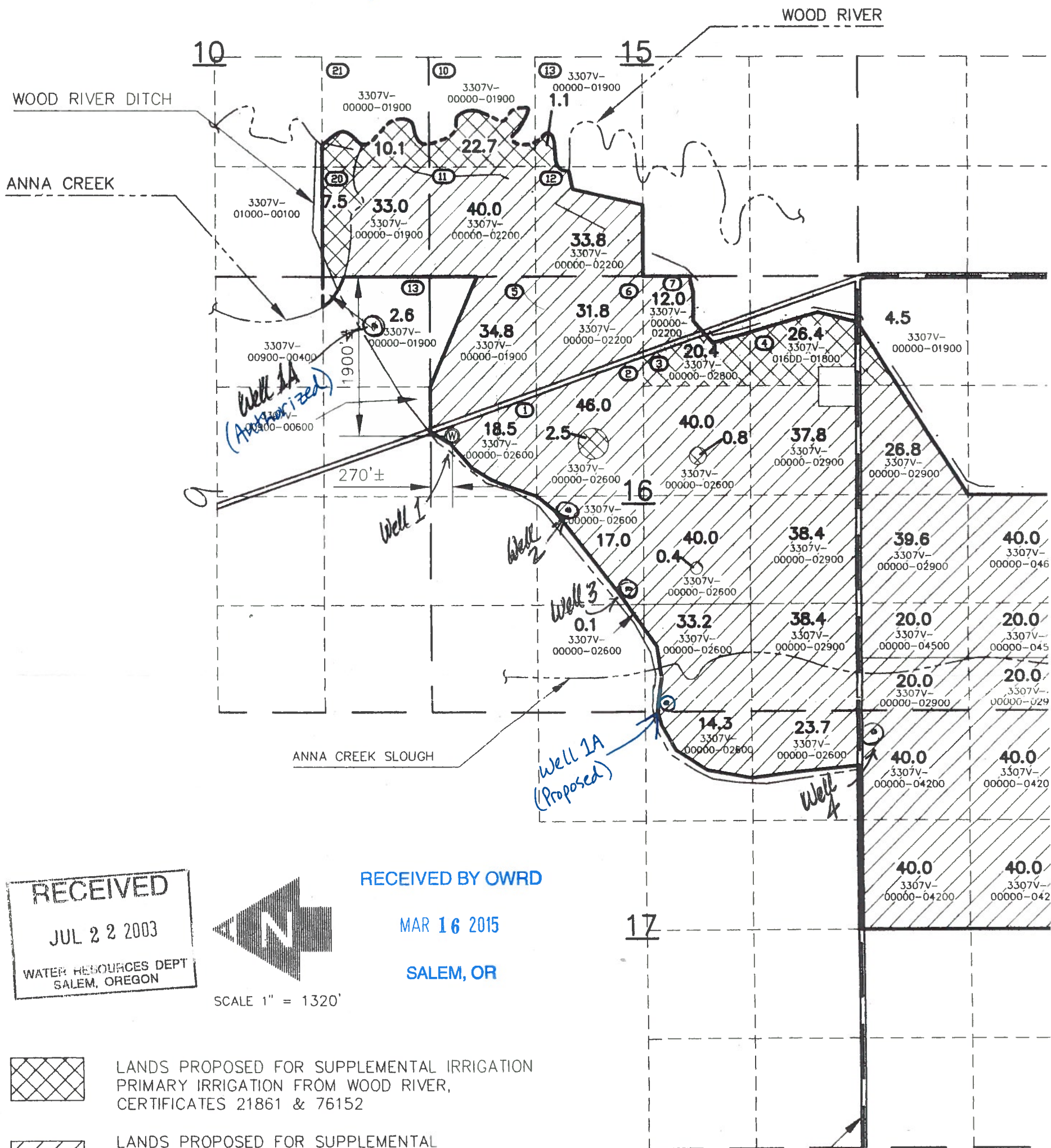

RECEIVED
 JUL 22 2003
 WATER RESOURCES DEPT
 SALEM, OREGON

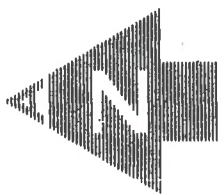

RECEIVED BY OWRD
 MAR 16 2015
 SALEM, OR

SCALE 1" = 1320'

- LANDS PROPOSED FOR SUPPLEMENTAL IRRIGATION
 PRIMARY IRRIGATION FROM WOOD RIVER,
 CERTIFICATES 21861 & 76152
- LANDS PROPOSED FOR SUPPLEMENTAL
 IRRIGATION
 PRIMARY IRRIGATION FROM ANNA CREEK DECREE
 AND SUPPLEMENTAL IRRIGATION FROM
 CERTIFICATES 21861 & 76152

	Well	Location	
⊙	PROPOSED WELL SITE	Proposed - 1A	2856'S. & 122'E. from NW Cor. Sec. 16
40.0	AREA IN ACRES	1	270'S & 1900'W. from NE Cor. Sec. 16
3307V-00000-01900	TAX LOT NUMBER	Authorized - 1A	700'N. & 600'W. " " " "
17	SECTION NUMBER	2	1700'S. & 2800'W. " " " "
Ⓜ	GOVERNMENT LOT NUMBER	3	2450'S. & 3760'W " " " "
		4	200'S. & 200'W. " " " 20

1/4 1/4 - SEC
 NWNE - 16
 SE 56 - 9
 SENW - 16
 SE NW - 16
 NENE - 20

ADKINS
 CONSULTING
 ENGINEERS, INC.

All in T. 33S, R. 7 1/2 E., WM
 (Note: Well 5 shown on Permit Amendment Map #1)
 for Transfer T-11263
 Engineers ▲ Planners ▲ Surveyors

THIS MAP IS FOR THE
 IDENTIFYING THE LOCA
 WATER RIGHT ONLY A
 INTENT TO PROVIDE D
 LOCATION OF PROPER