

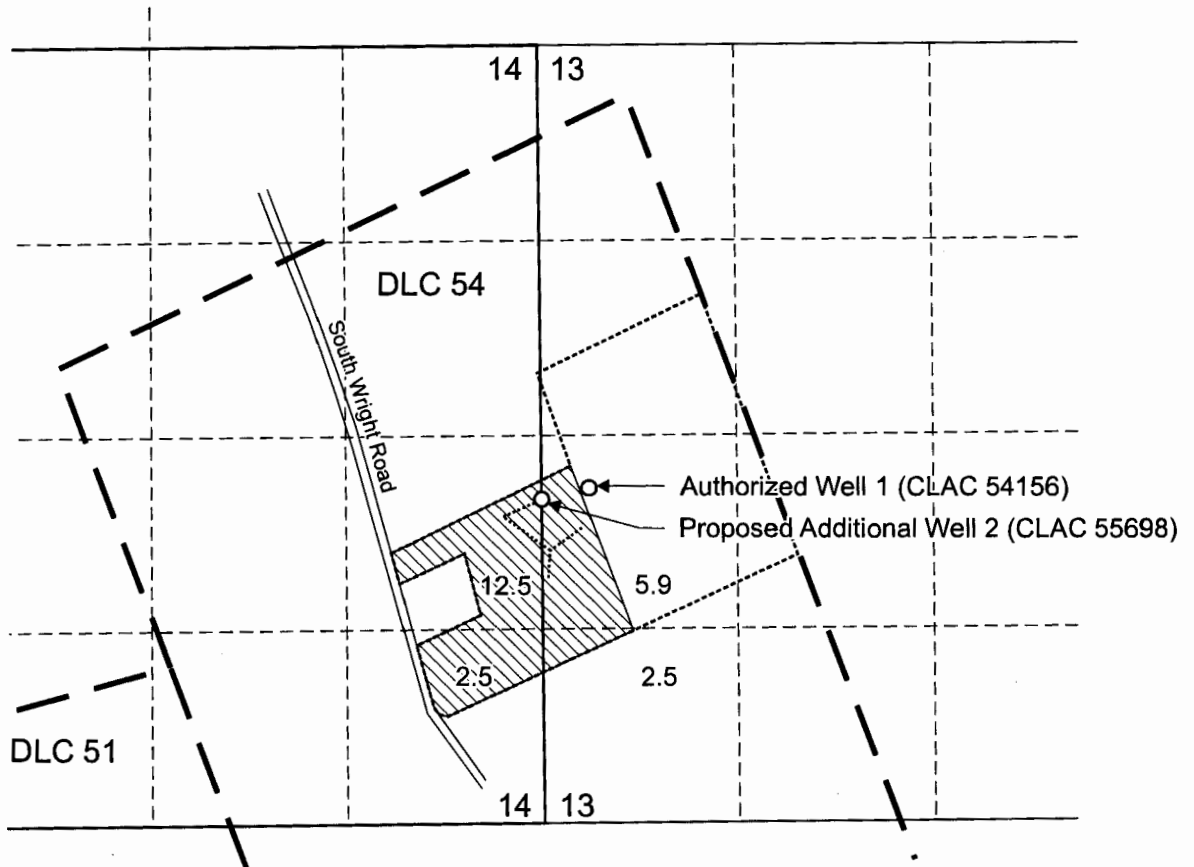



T.5S. R.2E. Sec. 13 & 14, W.M.



Authorized Well 1 (CLAC 54156) is located 2,360 feet north and 390 feet east from SE corner, Section 14.
 Proposed Additional Well 2 (CLAC 55698) is located 2,230 feet north from SE corner, Section 14.

-  Area (23.4 Acres) authorized for nursery use
-  Tax lot boundary
-  Buried 2-inch PVC mainline

RECEIVED

MAY 21 2015

WATER RESOURCES DEPT
 SALEM, OREGON

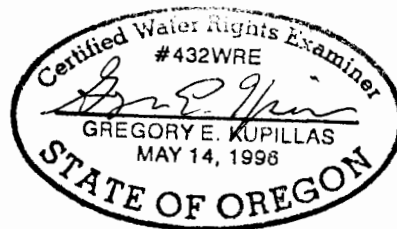

EXPIRATION DATE: 6/30/2015

Scale: 1" = 1,320'

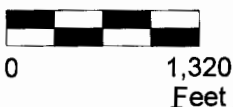

This map was prepared for the purpose of identifying the location of a water right only and is not intended to provide legal dimensions or location of property ownership lines.

Permit Amendment Application Map
 Application G-14684, Permit G-13556
 Priority Date: 2/18/1998

Pacific Hydro-Geology Inc.

2015-bgp

Horst Jeddelloh
 T.5S. R.2E. Sec. 13 & 14, W.M.



12066